

#### LEGEND

- |  |                       |  |                       |
|--|-----------------------|--|-----------------------|
|  | WELL HEAD LOCATION    |  | FORMER FACILITY       |
|  | MONITORING WELL       |  | UNDERGROUND FLOW LINE |
|  | VAPOR EXTRACTION WELL |  |                       |

Figure 2  
SITE MAP

**NOBLE ENERGY, INC. ~ WEEZER G02-32**  
SESW Section 3, T4N, R65W ~ 40.33602°, -104.65135°  
Weld County, Colorado

Project No. <b>C019-078</b>	Prepared by <b>TA</b>	Drawn by <b>TA</b>	
Date <b>12/7/20</b>	Reviewed by <b>PH</b>	Filename <b>19078Q</b>	



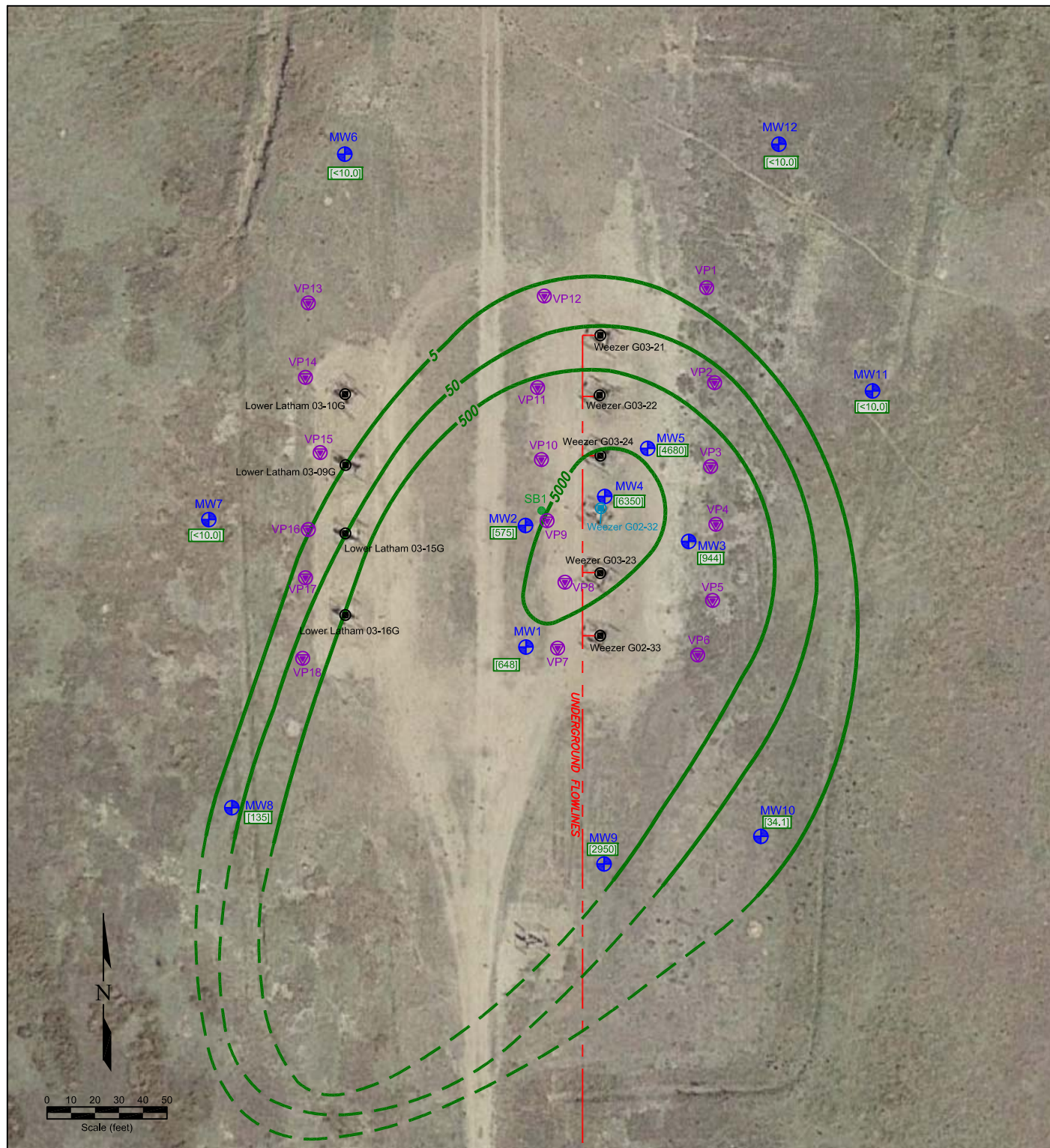

#### LEGEND

- SOIL BORING
- ⊙ WELL HEAD LOCATION
- ⊕ MONITORING WELL
- ⊕ VAPOR EXTRACTION WELL
- FORMER FORMER FACILITY
- UNDERGROUND FLOW LINE

[648] (ug/L)

--- 5000 --- METHANE ISO-CONCENTRATION (dashed where inferred)

Figure 8

#### METHANE ISO-CONCENTRATION MAP July 16, 2020 and August 21, 2020

**NOBLE ENERGY, INC. ~ WEEZER G02-32**  
SESW Section 3, T4N, R65W ~ 40.33602°, -104.65135°  
Weld County, Colorado

Project No.  
**C019-078**

Prepared by

Drawn by  
**TA**

Date  
**9/28/20**

Reviewed by  
**PH**

Filename  
**19078Q**





