





LEGEND

-  PROPOSED ELU O13 496 WELL PAD
-  EXISTING ACCESS & SECONDARY ACCESS (SEE TOPO B)
-  EXISTING ROAD (ROUTE TO PAD)
-  EXISTING ROAD



WASATCH SURVEYING ASSOCIATES
 906 MAIN STREET, EVANSTON, WY 82930
 (307) 789-4545



CAERUS OIL & GAS LLC

ELU O13 496 WELL PAD
 W1/2 SE1/4, SECTION 13, T4S, R96W, 6TH P.M.
 RIO BLANCO COUNTY, COLORADO

ACCESS ROAD MAP

DATE: 6/29/2020 SCALE: 1:100,000
 PROJECT NO: 20-13-05

TOPO A

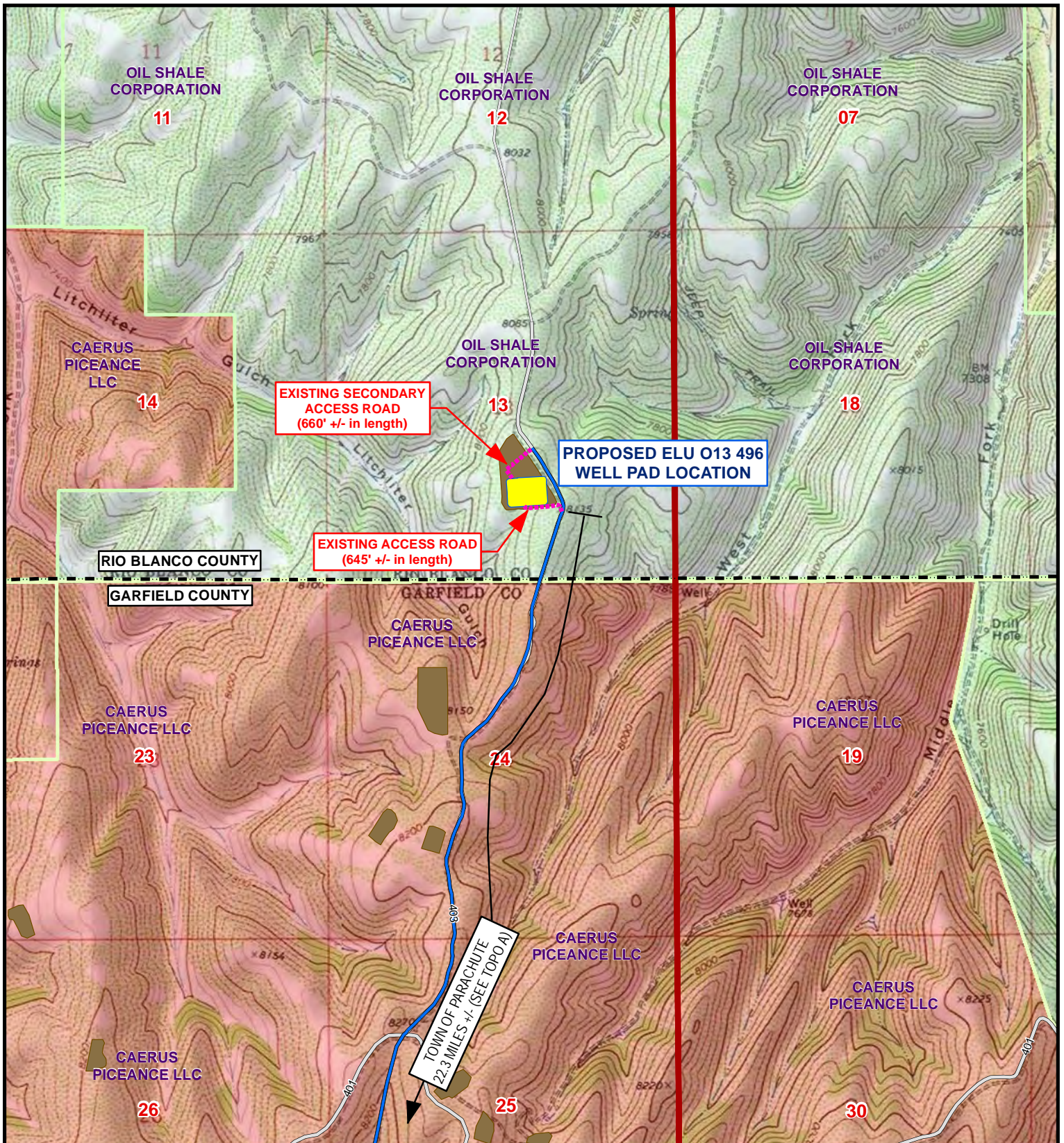

LEGEND

- EXISTING ACCESS ROAD
- PROPOSED WELL PAD
- EXISTING ROAD (ROUTE TO PAD)
- EXISTING LOCATION
- EXISTING ROAD



CAERUS OIL & GAS LLC

ELU O13 496 WELL PAD
W1/2 SE1/4, SECTION 13, T4S, R96W, 6TH P.M.
RIO BLANCO COUNTY, COLORADO

ACCESS ROAD MAP

DATE: 6/29/2020

SCALE: 1:24,000

PROJECT NO: 20-13-05

TOPO B



WASATCH SURVEYING ASSOCIATES
906 MAIN STREET, EVANSTON, WY 82930
(307) 789-4545