

Well Name:  
**BLEHM-7X-HNC-10-07-67**

Project Name:  
**Sec. 9-T7N-R67W**

Pad Name:  
**BLEHM Pad**

ANNOTATIONS									
MD	Inc	Azi	TVD	+N/-S	+E/-W	Vsect	Departure	Annotation	
1500.00	0.00	0.00	1500.00	0.00	0.00	0.00	0.00	Surf Csg	
1600.00	0.00	0.00	1600.00	0.00	0.00	0.00	0.00	Start Build 2.00	
4640.76	60.82	235.99	4101.11	-821.05	-1216.73	-569.15	1467.84	Hold 60.82 Inc, 235.99 Az	
9001.36	60.82	235.99	6227.46	-2950.55	-4372.46	-2045.33	5274.86	KOP 10°/100	
10360.14	89.12	89.80	6938.50	-3636.00	-3982.00	-1343.44	6393.15	LP 89.12 Inc, 89.80 Az	
19854.07	89.12	89.80	7083.81	-3602.62	5509.76	6583.04	15884.97	TD at 19854.07	

Geodetic Datum:				Elevation:				
North American Datum 1983 US State Plane 1983, Colorado Northern Zone				Ground Elevation: 5088.00 KB Elevation: KB @ 5115.00usft				
DESIGN TARGET DETAILS								
Name	TVD	+N/-S	+E/-W	Northing	Easting	Latitude	Longitude	Shape
SHL 7X-HNC 572 FNL 714 FEL	0.00	0.00	0.00	1459956.941	3169069.309	40.594387	-104.891201	Point
LPL 7X-HNC 1076 FSL 460 FWL	6937.00	-3636.31	-4091.14	1456320.630	3164978.164	40.584482	-104.906020	Point
- plan misses target center by 10.39usft at 10251.87usft MD (6929.55 TVD, -3629.26 N, -4089.52 E)								
BHL 7X-HNC 1076 FSL 460 FEL	7084.00	-3602.55	5510.76	1456354.396	3174580.067	40.584393	-104.871450	Point

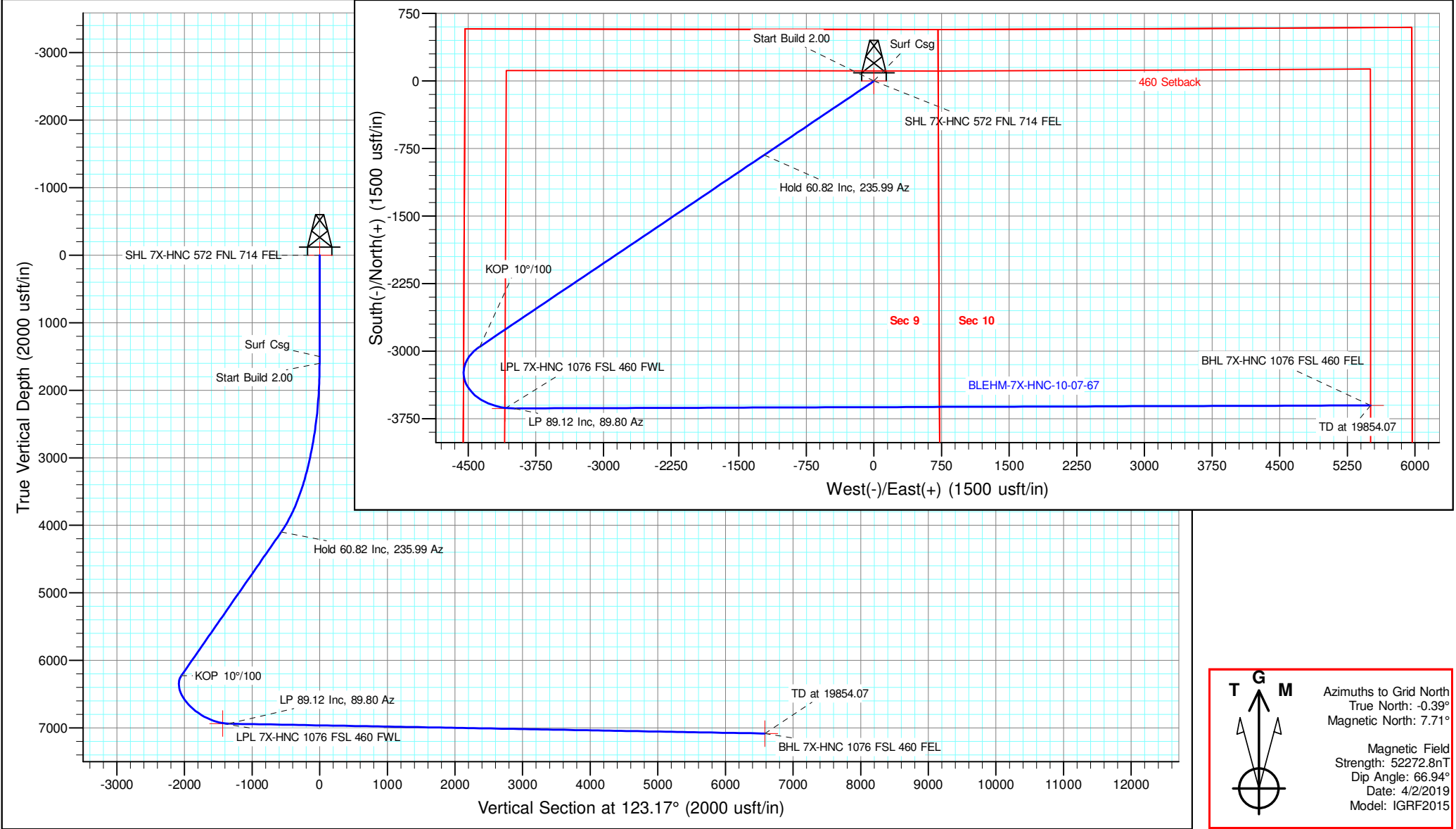

**T G M**

Azimuths to Grid North  
True North: -0.39°  
Magnetic North: 7.71°

Magnetic Field  
Strength: 52272.8nT  
Dip Angle: 66.94°  
Date: 4/2/2019  
Model: IGRF2015



## **Nickel Road Operating**

**Sec. 9-T7N-R67W**

**BLEHM Pad**

**BLEHM-7X-HNC-10-07-67**

**Wellbore #1**

**Plan: Plan #2**

## **Standard Planning Report - Geographic**

**20 July, 2020**

<b>Database:</b>	EDM 5000.15 Single User Db	<b>Local Co-ordinate Reference:</b>	Well BLEHM-7X-HNC-10-07-67
<b>Company:</b>	Nickel Road Operating	<b>TVD Reference:</b>	KB @ 5115.00usft
<b>Project:</b>	Sec. 9-T7N-R67W	<b>MD Reference:</b>	KB @ 5115.00usft
<b>Site:</b>	BLEHM Pad	<b>North Reference:</b>	Grid
<b>Well:</b>	BLEHM-7X-HNC-10-07-67	<b>Survey Calculation Method:</b>	Minimum Curvature
<b>Wellbore:</b>	Wellbore #1		
<b>Design:</b>	Plan #2		

<b>Project</b>	Sec. 9-T7N-R67W, Weld County, CO		
<b>Map System:</b>	US State Plane 1983	<b>System Datum:</b>	Mean Sea Level
<b>Geo Datum:</b>	North American Datum 1983		
<b>Map Zone:</b>	Colorado Northern Zone		

Site	BLEHM Pad				
Site Position:		Northing:	1,458,460.000 usft	Latitude:	40.590318
From:	Lat/Long	Easting:	3,166,936.305 usft	Longitude:	-104.898918
Position Uncertainty:	0.00 usft	Slot Radius:	13-3/16 "	Grid Convergence:	0.39 °

Well	BLEHM-7X-HNC-10-07-67					
Well Position	+N/-S	0.00 usft	Northing:	1,459,956.941 usft	Latitude:	40.594387
	+E/-W	0.00 usft	Easting:	3,169,069.309 usft	Longitude:	-104.891201
Position Uncertainty		0.00 usft	Wellhead Elevation:		Ground Level:	5,088.00 usft

<b>Wellbore</b>	Wellbore #1				
<b>Magnetics</b>	<b>Model Name</b>	<b>Sample Date</b>	<b>Declination (°)</b>	<b>Dip Angle (°)</b>	<b>Field Strength (nT)</b>
	IGRF2015	4/2/2019	8.10	66.94	52,272.76689572

<b>Design</b>	Plan #2			
<b>Audit Notes:</b>				
<b>Version:</b>	<b>Phase:</b>	PLAN	<b>Tie On Depth:</b>	0.00
<b>Vertical Section:</b>	<b>Depth From (TVD) (usft)</b>	<b>+N/-S (usft)</b>	<b>+E/-W (usft)</b>	<b>Direction (°)</b>
	0.00	0.00	0.00	123.17

<b>Plan Survey Tool Program</b>	<b>Date</b>	7/20/2020		
<b>Depth From (usft)</b>	<b>Depth To (usft)</b>	<b>Survey (Wellbore)</b>	<b>Tool Name</b>	<b>Remarks</b>
1	0.00	19,853.51 Plan #2 (Wellbore #1)	MWD	
			OWSG MWD - Standard	

<b>Plan Sections</b>										
<b>Measured Depth (usft)</b>	<b>Inclination (°)</b>	<b>Azimuth (°)</b>	<b>Vertical Depth (usft)</b>	<b>+N/-S (usft)</b>	<b>+E/-W (usft)</b>	<b>Dogleg Rate (°/100usft)</b>	<b>Build Rate (°/100usft)</b>	<b>Turn Rate (°/100usft)</b>	<b>TFO (°)</b>	<b>Target</b>
0.00	0.00	0.00	0.00	0.00	0.00	0.00	0.00	0.00	0.00	
1,600.00	0.00	0.00	1,600.00	0.00	0.00	0.00	0.00	0.00	0.00	
4,640.76	60.82	235.99	4,101.11	-821.05	-1,216.73	2.00	2.00	0.00	235.99	
9,001.36	60.82	235.99	6,227.46	-2,950.55	-4,372.46	0.00	0.00	0.00	0.00	
10,360.14	89.12	89.80	6,938.50	-3,636.00	-3,982.00	10.00	2.08	-10.76	-126.95	
19,854.07	89.12	89.80	7,084.00	-3,602.55	5,510.76	0.00	0.00	0.00	0.00	BHL 7X-HNC 1076 F

<b>Database:</b>	EDM 5000.15 Single User Db	<b>Local Co-ordinate Reference:</b>	Well BLEHM-7X-HNC-10-07-67
<b>Company:</b>	Nickel Road Operating	<b>TVD Reference:</b>	KB @ 5115.00usft
<b>Project:</b>	Sec. 9-T7N-R67W	<b>MD Reference:</b>	KB @ 5115.00usft
<b>Site:</b>	BLEHM Pad	<b>North Reference:</b>	Grid
<b>Well:</b>	BLEHM-7X-HNC-10-07-67	<b>Survey Calculation Method:</b>	Minimum Curvature
<b>Wellbore:</b>	Wellbore #1		
<b>Design:</b>	Plan #2		

Planned Survey									
Measured Depth (usft)	Inclination (°)	Azimuth (°)	Vertical Depth (usft)	+N/-S (usft)	+E/-W (usft)	Map Northing (usft)	Map Easting (usft)	Latitude	Longitude
0.00	0.00	0.00	0.00	0.00	0.00	1,459,956.941	3,169,069.309	40.594387	-104.891201
<b>SHL 7X-HNC 572 FNL 714 FEL</b>									
100.00	0.00	0.00	100.00	0.00	0.00	1,459,956.941	3,169,069.309	40.594387	-104.891201
200.00	0.00	0.00	200.00	0.00	0.00	1,459,956.941	3,169,069.309	40.594387	-104.891201
300.00	0.00	0.00	300.00	0.00	0.00	1,459,956.941	3,169,069.309	40.594387	-104.891201
400.00	0.00	0.00	400.00	0.00	0.00	1,459,956.941	3,169,069.309	40.594387	-104.891201
500.00	0.00	0.00	500.00	0.00	0.00	1,459,956.941	3,169,069.309	40.594387	-104.891201
600.00	0.00	0.00	600.00	0.00	0.00	1,459,956.941	3,169,069.309	40.594387	-104.891201
700.00	0.00	0.00	700.00	0.00	0.00	1,459,956.941	3,169,069.309	40.594387	-104.891201
800.00	0.00	0.00	800.00	0.00	0.00	1,459,956.941	3,169,069.309	40.594387	-104.891201
900.00	0.00	0.00	900.00	0.00	0.00	1,459,956.941	3,169,069.309	40.594387	-104.891201
1,000.00	0.00	0.00	1,000.00	0.00	0.00	1,459,956.941	3,169,069.309	40.594387	-104.891201
1,100.00	0.00	0.00	1,100.00	0.00	0.00	1,459,956.941	3,169,069.309	40.594387	-104.891201
1,200.00	0.00	0.00	1,200.00	0.00	0.00	1,459,956.941	3,169,069.309	40.594387	-104.891201
1,300.00	0.00	0.00	1,300.00	0.00	0.00	1,459,956.941	3,169,069.309	40.594387	-104.891201
1,400.00	0.00	0.00	1,400.00	0.00	0.00	1,459,956.941	3,169,069.309	40.594387	-104.891201
1,500.00	0.00	0.00	1,500.00	0.00	0.00	1,459,956.941	3,169,069.309	40.594387	-104.891201
<b>Surf Csg</b>									
1,600.00	0.00	0.00	1,600.00	0.00	0.00	1,459,956.941	3,169,069.309	40.594387	-104.891201
<b>Start Build 2.00</b>									
1,700.00	2.00	235.99	1,699.98	-0.98	-1.45	1,459,955.965	3,169,067.863	40.594384	-104.891206
1,800.00	4.00	235.99	1,799.84	-3.90	-5.78	1,459,953.037	3,169,063.524	40.594376	-104.891222
1,900.00	6.00	235.99	1,899.45	-8.78	-13.01	1,459,948.163	3,169,056.300	40.594363	-104.891248
2,000.00	8.00	235.99	1,998.70	-15.59	-23.11	1,459,941.346	3,169,046.199	40.594345	-104.891285
2,100.00	10.00	235.99	2,097.47	-24.34	-36.08	1,459,932.596	3,169,033.232	40.594321	-104.891332
2,200.00	12.00	235.99	2,195.62	-35.02	-51.89	1,459,921.924	3,169,017.416	40.594292	-104.891389
2,300.00	14.00	235.99	2,293.06	-47.60	-70.54	1,459,909.341	3,168,998.771	40.594258	-104.891456
2,400.00	16.00	235.99	2,389.64	-62.08	-91.99	1,459,894.865	3,168,977.318	40.594218	-104.891534
2,500.00	18.00	235.99	2,485.27	-78.43	-116.23	1,459,878.511	3,168,953.083	40.594174	-104.891622
2,600.00	20.00	235.99	2,579.82	-96.64	-143.21	1,459,860.301	3,168,926.098	40.594124	-104.891719
2,700.00	22.00	235.99	2,673.17	-116.68	-172.92	1,459,840.257	3,168,896.393	40.594070	-104.891827
2,800.00	24.00	235.99	2,765.21	-138.54	-205.30	1,459,818.402	3,168,864.006	40.594011	-104.891944
2,900.00	26.00	235.99	2,855.84	-162.18	-240.33	1,459,794.763	3,168,828.976	40.593946	-104.892071
3,000.00	28.00	235.99	2,944.94	-187.57	-277.96	1,459,769.370	3,168,791.346	40.593877	-104.892207
3,100.00	30.00	235.99	3,032.39	-214.69	-318.15	1,459,742.253	3,168,751.161	40.593804	-104.892352
3,200.00	32.00	235.99	3,118.11	-243.50	-360.84	1,459,713.446	3,168,708.470	40.593725	-104.892507
3,300.00	34.00	235.99	3,201.97	-273.96	-405.98	1,459,682.982	3,168,663.326	40.593643	-104.892670
3,400.00	36.00	235.99	3,283.88	-306.04	-453.53	1,459,650.900	3,168,615.783	40.593555	-104.892842
3,500.00	38.00	235.99	3,363.74	-339.70	-503.41	1,459,617.239	3,168,565.899	40.593464	-104.893022
3,600.00	40.00	235.99	3,441.45	-374.90	-555.57	1,459,582.039	3,168,513.735	40.593368	-104.893211
3,700.00	42.00	235.99	3,516.92	-411.60	-609.95	1,459,545.343	3,168,459.356	40.593269	-104.893408
3,800.00	44.00	235.99	3,590.05	-449.74	-666.48	1,459,507.197	3,168,402.826	40.593165	-104.893612
3,900.00	46.00	235.99	3,660.76	-489.29	-725.09	1,459,467.646	3,168,344.215	40.593058	-104.893824
4,000.00	48.00	235.99	3,728.95	-530.20	-785.71	1,459,426.739	3,168,283.595	40.592946	-104.894043
4,100.00	50.00	235.99	3,794.56	-572.42	-848.27	1,459,384.526	3,168,221.038	40.592832	-104.894270
4,200.00	52.00	235.99	3,857.48	-615.88	-912.69	1,459,341.057	3,168,156.622	40.592714	-104.894503
4,300.00	54.00	235.99	3,917.66	-660.55	-978.88	1,459,296.387	3,168,090.425	40.592592	-104.894742
4,400.00	56.00	235.99	3,975.02	-706.37	-1,046.78	1,459,250.569	3,168,022.527	40.592468	-104.894988
4,500.00	58.00	235.99	4,029.48	-753.28	-1,116.30	1,459,203.660	3,167,953.011	40.592340	-104.895239
4,600.00	60.00	235.99	4,080.98	-801.23	-1,187.35	1,459,155.716	3,167,881.962	40.592210	-104.895496
4,640.76	60.82	235.99	4,101.11	-821.05	-1,216.73	1,459,135.891	3,167,852.583	40.592156	-104.895603
<b>Hold 60.82 Inc, 235.99 Az</b>									
4,700.00	60.82	235.99	4,130.00	-849.98	-1,259.60	1,459,106.960	3,167,809.710	40.592078	-104.895758
4,800.00	60.82	235.99	4,178.76	-898.82	-1,331.97	1,459,058.125	3,167,737.341	40.591945	-104.896019

<b>Database:</b>	EDM 5000.15 Single User Db	<b>Local Co-ordinate Reference:</b>	Well BLEHM-7X-HNC-10-07-67
<b>Company:</b>	Nickel Road Operating	<b>TVD Reference:</b>	KB @ 5115.00usft
<b>Project:</b>	Sec. 9-T7N-R67W	<b>MD Reference:</b>	KB @ 5115.00usft
<b>Site:</b>	BLEHM Pad	<b>North Reference:</b>	Grid
<b>Well:</b>	BLEHM-7X-HNC-10-07-67	<b>Survey Calculation Method:</b>	Minimum Curvature
<b>Wellbore:</b>	Wellbore #1		
<b>Design:</b>	Plan #2		

Planned Survey									
Measured Depth (usft)	Inclination (°)	Azimuth (°)	Vertical Depth (usft)	+N/-S (usft)	+E/-W (usft)	Map Northing (usft)	Map Easting (usft)	Latitude	Longitude
4,900.00	60.82	235.99	4,227.52	-947.65	-1,404.34	1,459,009.290	3,167,664.972	40.591812	-104.896281
5,000.00	60.82	235.99	4,276.28	-996.49	-1,476.71	1,458,960.455	3,167,592.602	40.591679	-104.896543
5,100.00	60.82	235.99	4,325.05	-1,045.32	-1,549.08	1,458,911.620	3,167,520.233	40.591547	-104.896805
5,200.00	60.82	235.99	4,373.81	-1,094.16	-1,621.44	1,458,862.785	3,167,447.864	40.591414	-104.897067
5,300.00	60.82	235.99	4,422.57	-1,142.99	-1,693.81	1,458,813.950	3,167,375.494	40.591281	-104.897328
5,400.00	60.82	235.99	4,471.34	-1,191.83	-1,766.18	1,458,765.115	3,167,303.125	40.591149	-104.897590
5,500.00	60.82	235.99	4,520.10	-1,240.66	-1,838.55	1,458,716.280	3,167,230.756	40.591016	-104.897852
5,600.00	60.82	235.99	4,568.86	-1,289.50	-1,910.92	1,458,667.445	3,167,158.386	40.590883	-104.898114
5,700.00	60.82	235.99	4,617.62	-1,338.33	-1,983.29	1,458,618.610	3,167,086.017	40.590751	-104.898375
5,800.00	60.82	235.99	4,666.39	-1,387.17	-2,055.66	1,458,569.775	3,167,013.648	40.590618	-104.898637
5,900.00	60.82	235.99	4,715.15	-1,436.00	-2,128.03	1,458,520.940	3,166,941.278	40.590485	-104.898899
6,000.00	60.82	235.99	4,763.91	-1,484.84	-2,200.40	1,458,472.105	3,166,868.909	40.590353	-104.899161
6,100.00	60.82	235.99	4,812.68	-1,533.67	-2,272.77	1,458,423.269	3,166,796.540	40.590220	-104.899422
6,200.00	60.82	235.99	4,861.44	-1,582.51	-2,345.14	1,458,374.434	3,166,724.170	40.590087	-104.899684
6,300.00	60.82	235.99	4,910.20	-1,631.34	-2,417.51	1,458,325.599	3,166,651.801	40.589954	-104.899946
6,400.00	60.82	235.99	4,958.96	-1,680.18	-2,489.88	1,458,276.764	3,166,579.432	40.589822	-104.900208
6,500.00	60.82	235.99	5,007.73	-1,729.01	-2,562.25	1,458,227.929	3,166,507.062	40.589689	-104.900469
6,600.00	60.82	235.99	5,056.49	-1,777.85	-2,634.62	1,458,179.094	3,166,434.693	40.589556	-104.900731
6,700.00	60.82	235.99	5,105.25	-1,826.68	-2,706.98	1,458,130.259	3,166,362.324	40.589424	-104.900993
6,800.00	60.82	235.99	5,154.02	-1,875.52	-2,779.35	1,458,081.424	3,166,289.954	40.589291	-104.901255
6,900.00	60.82	235.99	5,202.78	-1,924.35	-2,851.72	1,458,032.589	3,166,217.585	40.589158	-104.901516
7,000.00	60.82	235.99	5,251.54	-1,973.19	-2,924.09	1,457,983.754	3,166,145.216	40.589026	-104.901778
7,100.00	60.82	235.99	5,300.30	-2,022.02	-2,996.46	1,457,934.919	3,166,072.846	40.588893	-104.902040
7,200.00	60.82	235.99	5,349.07	-2,070.86	-3,068.83	1,457,886.084	3,166,000.477	40.588760	-104.902302
7,300.00	60.82	235.99	5,397.83	-2,119.69	-3,141.20	1,457,837.249	3,165,928.108	40.588627	-104.902563
7,400.00	60.82	235.99	5,446.59	-2,168.53	-3,213.57	1,457,788.414	3,165,855.738	40.588495	-104.902825
7,500.00	60.82	235.99	5,495.36	-2,217.36	-3,285.94	1,457,739.579	3,165,783.369	40.588362	-104.903087
7,600.00	60.82	235.99	5,544.12	-2,266.20	-3,358.31	1,457,690.744	3,165,711.000	40.588229	-104.903349
7,700.00	60.82	235.99	5,592.88	-2,315.03	-3,430.68	1,457,641.908	3,165,638.630	40.588097	-104.903610
7,800.00	60.82	235.99	5,641.64	-2,363.87	-3,503.05	1,457,593.073	3,165,566.261	40.587964	-104.903872
7,900.00	60.82	235.99	5,690.41	-2,412.70	-3,575.42	1,457,544.238	3,165,493.892	40.587831	-104.904134
8,000.00	60.82	235.99	5,739.17	-2,461.54	-3,647.79	1,457,495.403	3,165,421.522	40.587698	-104.904396
8,100.00	60.82	235.99	5,787.93	-2,510.37	-3,720.16	1,457,446.568	3,165,349.153	40.587566	-104.904657
8,200.00	60.82	235.99	5,836.70	-2,559.21	-3,792.52	1,457,397.733	3,165,276.784	40.587433	-104.904919
8,300.00	60.82	235.99	5,885.46	-2,608.04	-3,864.89	1,457,348.898	3,165,204.414	40.587300	-104.905181
8,400.00	60.82	235.99	5,934.22	-2,656.88	-3,937.26	1,457,300.063	3,165,132.045	40.587168	-104.905443
8,500.00	60.82	235.99	5,982.98	-2,705.71	-4,009.63	1,457,251.228	3,165,059.676	40.587035	-104.905704
8,600.00	60.82	235.99	6,031.75	-2,754.55	-4,082.00	1,457,202.393	3,164,987.306	40.586902	-104.905966
8,700.00	60.82	235.99	6,080.51	-2,803.38	-4,154.37	1,457,153.558	3,164,914.937	40.586769	-104.906228
8,800.00	60.82	235.99	6,129.27	-2,852.22	-4,226.74	1,457,104.723	3,164,842.568	40.586637	-104.906490
8,900.00	60.82	235.99	6,178.04	-2,901.05	-4,299.11	1,457,055.888	3,164,770.198	40.586504	-104.906751
9,000.00	60.82	235.99	6,226.80	-2,949.89	-4,371.48	1,457,007.053	3,164,697.829	40.586371	-104.907013
9,001.36	60.82	235.99	6,227.46	-2,950.55	-4,372.46	1,457,006.390	3,164,696.846	40.586370	-104.907017
KOP 10°/100									
9,100.00	55.23	226.39	6,279.77	-3,002.71	-4,437.65	1,456,954.233	3,164,631.656	40.586228	-104.907253
9,200.00	50.44	215.36	6,340.29	-3,062.62	-4,489.83	1,456,894.320	3,164,579.475	40.586064	-104.907442
9,300.00	46.83	202.92	6,406.51	-3,127.81	-4,526.44	1,456,829.134	3,164,542.873	40.585886	-104.907575
9,400.00	44.71	189.26	6,476.43	-3,196.29	-4,546.35	1,456,760.656	3,164,522.961	40.585698	-104.907649
9,500.00	44.31	174.99	6,547.92	-3,265.98	-4,548.96	1,456,690.965	3,164,520.345	40.585507	-104.907660
9,600.00	45.68	160.96	6,618.81	-3,334.76	-4,534.21	1,456,622.181	3,164,535.103	40.585318	-104.907608
9,700.00	48.66	147.92	6,686.95	-3,400.55	-4,502.52	1,456,556.392	3,164,566.789	40.585137	-104.907496
9,800.00	52.96	136.26	6,750.26	-3,461.34	-4,454.87	1,456,495.597	3,164,614.438	40.584969	-104.907326
9,900.00	58.27	125.98	6,806.82	-3,515.30	-4,392.71	1,456,441.645	3,164,676.603	40.584820	-104.907103
10,000.00	64.31	116.88	6,854.91	-3,560.77	-4,317.91	1,456,396.173	3,164,751.396	40.584694	-104.906835

<b>Database:</b>	EDM 5000.15 Single User Db	<b>Local Co-ordinate Reference:</b>	Well BLEHM-7X-HNC-10-07-67
<b>Company:</b>	Nickel Road Operating	<b>TVD Reference:</b>	KB @ 5115.00usft
<b>Project:</b>	Sec. 9-T7N-R67W	<b>MD Reference:</b>	KB @ 5115.00usft
<b>Site:</b>	BLEHM Pad	<b>North Reference:</b>	Grid
<b>Well:</b>	BLEHM-7X-HNC-10-07-67	<b>Survey Calculation Method:</b>	Minimum Curvature
<b>Wellbore:</b>	Wellbore #1		
<b>Design:</b>	Plan #2		

Planned Survey										
Measured Depth (usft)	Inclination (°)	Azimuth (°)	Vertical Depth (usft)	+N/-S (usft)	+E/-W (usft)	Map Northing (usft)	Map Easting (usft)	Latitude	Longitude	
10,100.00	70.86	108.70	6,893.08	-3,596.38	-4,232.77	1,456,360.564	3,164,836.543	40.584594	-104.906529	
10,200.00	77.74	101.16	6,920.16	-3,621.04	-4,139.85	1,456,335.900	3,164,929.458	40.584525	-104.906195	
10,252.33	81.43	97.38	6,929.62	-3,629.32	-4,089.07	1,456,327.621	3,164,980.237	40.584501	-104.906013	
LPL 7X-HNC 1076 FSL 460 FWL										
10,300.00	84.82	94.01	6,935.32	-3,634.01	-4,041.99	1,456,322.930	3,165,027.317	40.584487	-104.905843	
10,360.14	89.12	89.80	6,938.50	-3,636.00	-3,982.00	1,456,320.941	3,165,087.308	40.584481	-104.905627	
LP 89.12 Inc, 89.80 Az										
10,400.00	89.12	89.80	6,939.11	-3,635.86	-3,942.14	1,456,321.081	3,165,127.168	40.584481	-104.905484	
10,500.00	89.12	89.80	6,940.64	-3,635.51	-3,842.15	1,456,321.433	3,165,227.155	40.584480	-104.905124	
10,600.00	89.12	89.80	6,942.17	-3,635.16	-3,742.17	1,456,321.784	3,165,327.143	40.584479	-104.904764	
10,700.00	89.12	89.80	6,943.70	-3,634.81	-3,642.18	1,456,322.136	3,165,427.131	40.584478	-104.904404	
10,800.00	89.12	89.80	6,945.23	-3,634.45	-3,542.19	1,456,322.488	3,165,527.118	40.584477	-104.904044	
10,900.00	89.12	89.80	6,946.76	-3,634.10	-3,442.20	1,456,322.839	3,165,627.106	40.584476	-104.903684	
11,000.00	89.12	89.80	6,948.29	-3,633.75	-3,342.21	1,456,323.191	3,165,727.094	40.584475	-104.903324	
11,100.00	89.12	89.80	6,949.83	-3,633.40	-3,242.23	1,456,323.543	3,165,827.081	40.584474	-104.902964	
11,200.00	89.12	89.80	6,951.36	-3,633.05	-3,142.24	1,456,323.894	3,165,927.069	40.584474	-104.902604	
11,300.00	89.12	89.80	6,952.89	-3,632.70	-3,042.25	1,456,324.246	3,166,027.057	40.584473	-104.902244	
11,400.00	89.12	89.80	6,954.42	-3,632.34	-2,942.26	1,456,324.597	3,166,127.044	40.584472	-104.901884	
11,500.00	89.12	89.80	6,955.95	-3,631.99	-2,842.28	1,456,324.949	3,166,227.032	40.584471	-104.901524	
11,600.00	89.12	89.80	6,957.48	-3,631.64	-2,742.29	1,456,325.301	3,166,327.019	40.584470	-104.901164	
11,700.00	89.12	89.80	6,959.01	-3,631.29	-2,642.30	1,456,325.652	3,166,427.007	40.584469	-104.900804	
11,800.00	89.12	89.80	6,960.54	-3,630.94	-2,542.31	1,456,326.004	3,166,526.995	40.584468	-104.900444	
11,900.00	89.12	89.80	6,962.07	-3,630.59	-2,442.33	1,456,326.355	3,166,626.982	40.584467	-104.900084	
12,000.00	89.12	89.80	6,963.60	-3,630.23	-2,342.34	1,456,326.707	3,166,726.970	40.584466	-104.899724	
12,100.00	89.12	89.80	6,965.13	-3,629.88	-2,242.35	1,456,327.059	3,166,826.958	40.584466	-104.899364	
12,200.00	89.12	89.80	6,966.66	-3,629.53	-2,142.36	1,456,327.410	3,166,926.945	40.584465	-104.899004	
12,300.00	89.12	89.80	6,968.19	-3,629.18	-2,042.38	1,456,327.762	3,167,026.933	40.584464	-104.898644	
12,400.00	89.12	89.80	6,969.73	-3,628.83	-1,942.39	1,456,328.113	3,167,126.921	40.584463	-104.898284	
12,500.00	89.12	89.80	6,971.26	-3,628.48	-1,842.40	1,456,328.465	3,167,226.908	40.584462	-104.897924	
12,600.00	89.12	89.80	6,972.79	-3,628.12	-1,742.41	1,456,328.817	3,167,326.896	40.584461	-104.897564	
12,700.00	89.12	89.80	6,974.32	-3,627.77	-1,642.42	1,456,329.168	3,167,426.884	40.584460	-104.897204	
12,800.00	89.12	89.80	6,975.85	-3,627.42	-1,542.44	1,456,329.520	3,167,526.871	40.584459	-104.896844	
12,900.00	89.12	89.80	6,977.38	-3,627.07	-1,442.45	1,456,329.872	3,167,626.859	40.584458	-104.896484	
13,000.00	89.12	89.80	6,978.91	-3,626.72	-1,342.46	1,456,330.223	3,167,726.847	40.584457	-104.896124	
13,100.00	89.12	89.80	6,980.44	-3,626.37	-1,242.47	1,456,330.575	3,167,826.834	40.584457	-104.895764	
13,200.00	89.12	89.80	6,981.97	-3,626.01	-1,142.49	1,456,330.926	3,167,926.822	40.584456	-104.895404	
13,300.00	89.12	89.80	6,983.50	-3,625.66	-1,042.50	1,456,331.278	3,168,026.810	40.584455	-104.895044	
13,400.00	89.12	89.80	6,985.03	-3,625.31	-942.51	1,456,331.630	3,168,126.797	40.584454	-104.894684	
13,500.00	89.12	89.80	6,986.56	-3,624.96	-842.52	1,456,331.981	3,168,226.785	40.584453	-104.894324	
13,600.00	89.12	89.80	6,988.09	-3,624.61	-742.54	1,456,332.333	3,168,326.773	40.584452	-104.893964	
13,700.00	89.12	89.80	6,989.63	-3,624.26	-642.55	1,456,332.684	3,168,426.760	40.584451	-104.893604	
13,800.00	89.12	89.80	6,991.16	-3,623.91	-542.56	1,456,333.036	3,168,526.748	40.584450	-104.893244	
13,900.00	89.12	89.80	6,992.69	-3,623.55	-442.57	1,456,333.388	3,168,626.737	40.584449	-104.892884	
14,000.00	89.12	89.80	6,994.22	-3,623.20	-342.58	1,456,333.739	3,168,726.724	40.584448	-104.892524	
14,100.00	89.12	89.80	6,995.75	-3,622.85	-242.60	1,456,334.091	3,168,826.712	40.584447	-104.892164	
14,200.00	89.12	89.80	6,997.28	-3,622.50	-142.61	1,456,334.442	3,168,926.700	40.584447	-104.891804	
14,300.00	89.12	89.80	6,998.81	-3,622.15	-42.62	1,456,334.794	3,169,026.687	40.584446	-104.891444	
14,400.00	89.12	89.80	7,000.34	-3,621.80	57.37	1,456,335.146	3,169,126.675	40.584445	-104.891084	
14,500.00	89.12	89.80	7,001.87	-3,621.44	157.35	1,456,335.497	3,169,226.663	40.584444	-104.890724	
14,600.00	89.12	89.80	7,003.40	-3,621.09	257.34	1,456,335.849	3,169,326.650	40.584443	-104.890364	
14,700.00	89.12	89.80	7,004.93	-3,620.74	357.33	1,456,336.201	3,169,426.638	40.584442	-104.890004	
14,800.00	89.12	89.80	7,006.46	-3,620.39	457.32	1,456,336.552	3,169,526.626	40.584441	-104.889644	
14,900.00	89.12	89.80	7,007.99	-3,620.04	557.30	1,456,336.904	3,169,626.613	40.584440	-104.889284	
15,000.00	89.12	89.80	7,009.53	-3,619.69	657.29	1,456,337.255	3,169,726.601	40.584439	-104.888924	

<b>Database:</b>	EDM 5000.15 Single User Db	<b>Local Co-ordinate Reference:</b>	Well BLEHM-7X-HNC-10-07-67
<b>Company:</b>	Nickel Road Operating	<b>TVD Reference:</b>	KB @ 5115.00usft
<b>Project:</b>	Sec. 9-T7N-R67W	<b>MD Reference:</b>	KB @ 5115.00usft
<b>Site:</b>	BLEHM Pad	<b>North Reference:</b>	Grid
<b>Well:</b>	BLEHM-7X-HNC-10-07-67	<b>Survey Calculation Method:</b>	Minimum Curvature
<b>Wellbore:</b>	Wellbore #1		
<b>Design:</b>	Plan #2		

Planned Survey									
Measured Depth (usft)	Inclination (°)	Azimuth (°)	Vertical Depth (usft)	+N/-S (usft)	+E/-W (usft)	Map Northing (usft)	Map Easting (usft)	Latitude	Longitude
15,100.00	89.12	89.80	7,011.06	-3,619.33	757.28	1,456,337.607	3,169,826.589	40.584438	-104.888564
15,200.00	89.12	89.80	7,012.59	-3,618.98	857.27	1,456,337.959	3,169,926.576	40.584437	-104.888204
15,300.00	89.12	89.80	7,014.12	-3,618.63	957.25	1,456,338.310	3,170,026.564	40.584436	-104.887844
15,400.00	89.12	89.80	7,015.65	-3,618.28	1,057.24	1,456,338.662	3,170,126.552	40.584435	-104.887484
15,500.00	89.12	89.80	7,017.18	-3,617.93	1,157.23	1,456,339.013	3,170,226.539	40.584434	-104.887124
15,600.00	89.12	89.80	7,018.71	-3,617.58	1,257.22	1,456,339.365	3,170,326.527	40.584434	-104.886764
15,700.00	89.12	89.80	7,020.24	-3,617.22	1,357.21	1,456,339.717	3,170,426.515	40.584433	-104.886404
15,800.00	89.12	89.80	7,021.77	-3,616.87	1,457.19	1,456,340.068	3,170,526.502	40.584432	-104.886044
15,900.00	89.12	89.80	7,023.30	-3,616.52	1,557.18	1,456,340.420	3,170,626.490	40.584431	-104.885684
16,000.00	89.12	89.80	7,024.83	-3,616.17	1,657.17	1,456,340.771	3,170,726.478	40.584430	-104.885324
16,100.00	89.12	89.80	7,026.36	-3,615.82	1,757.16	1,456,341.123	3,170,826.465	40.584429	-104.884964
16,200.00	89.12	89.80	7,027.89	-3,615.47	1,857.14	1,456,341.475	3,170,926.453	40.584428	-104.884604
16,300.00	89.12	89.80	7,029.43	-3,615.11	1,957.13	1,456,341.826	3,171,026.441	40.584427	-104.884244
16,400.00	89.12	89.80	7,030.96	-3,614.76	2,057.12	1,456,342.178	3,171,126.428	40.584426	-104.883884
16,500.00	89.12	89.80	7,032.49	-3,614.41	2,157.11	1,456,342.530	3,171,226.416	40.584425	-104.883525
16,600.00	89.12	89.80	7,034.02	-3,614.06	2,257.09	1,456,342.881	3,171,326.404	40.584424	-104.883165
16,700.00	89.12	89.80	7,035.55	-3,613.71	2,357.08	1,456,343.233	3,171,426.391	40.584423	-104.882805
16,800.00	89.12	89.80	7,037.08	-3,613.36	2,457.07	1,456,343.584	3,171,526.379	40.584422	-104.882445
16,900.00	89.12	89.80	7,038.61	-3,613.01	2,557.06	1,456,343.936	3,171,626.366	40.584421	-104.882085
17,000.00	89.12	89.80	7,040.14	-3,612.65	2,657.05	1,456,344.288	3,171,726.354	40.584420	-104.881725
17,100.00	89.12	89.80	7,041.67	-3,612.30	2,757.03	1,456,344.639	3,171,826.342	40.584419	-104.881365
17,200.00	89.12	89.80	7,043.20	-3,611.95	2,857.02	1,456,344.991	3,171,926.329	40.584418	-104.881005
17,300.00	89.12	89.80	7,044.73	-3,611.60	2,957.01	1,456,345.342	3,172,026.317	40.584418	-104.880645
17,400.00	89.12	89.80	7,046.26	-3,611.25	3,057.00	1,456,345.694	3,172,126.305	40.584417	-104.880285
17,500.00	89.12	89.80	7,047.79	-3,610.90	3,156.98	1,456,346.046	3,172,226.292	40.584416	-104.879925
17,600.00	89.12	89.80	7,049.32	-3,610.54	3,256.97	1,456,346.397	3,172,326.280	40.584415	-104.879565
17,700.00	89.12	89.80	7,050.86	-3,610.19	3,356.96	1,456,346.749	3,172,426.268	40.584414	-104.879205
17,800.00	89.12	89.80	7,052.39	-3,609.84	3,456.95	1,456,347.100	3,172,526.255	40.584413	-104.878845
17,900.00	89.12	89.80	7,053.92	-3,609.49	3,556.93	1,456,347.452	3,172,626.243	40.584412	-104.878485
18,000.00	89.12	89.80	7,055.45	-3,609.14	3,656.92	1,456,347.804	3,172,726.231	40.584411	-104.878125
18,100.00	89.12	89.80	7,056.98	-3,608.79	3,756.91	1,456,348.155	3,172,826.218	40.584410	-104.877765
18,200.00	89.12	89.80	7,058.51	-3,608.43	3,856.90	1,456,348.507	3,172,926.206	40.584409	-104.877405
18,300.00	89.12	89.80	7,060.04	-3,608.08	3,956.88	1,456,348.859	3,173,026.194	40.584408	-104.877045
18,400.00	89.12	89.80	7,061.57	-3,607.73	4,056.87	1,456,349.210	3,173,126.181	40.584407	-104.876685
18,500.00	89.12	89.80	7,063.10	-3,607.38	4,156.86	1,456,349.562	3,173,226.169	40.584406	-104.876325
18,600.00	89.12	89.80	7,064.63	-3,607.03	4,256.85	1,456,349.913	3,173,326.157	40.584405	-104.875965
18,700.00	89.12	89.80	7,066.16	-3,606.68	4,356.84	1,456,350.265	3,173,426.144	40.584404	-104.875605
18,800.00	89.12	89.80	7,067.69	-3,606.32	4,456.82	1,456,350.617	3,173,526.132	40.584403	-104.875245
18,900.00	89.12	89.80	7,069.22	-3,605.97	4,556.81	1,456,350.968	3,173,626.120	40.584402	-104.874885
19,000.00	89.12	89.80	7,070.76	-3,605.62	4,656.80	1,456,351.320	3,173,726.107	40.584401	-104.874525
19,100.00	89.12	89.80	7,072.29	-3,605.27	4,756.79	1,456,351.671	3,173,826.095	40.584400	-104.874165
19,200.00	89.12	89.80	7,073.82	-3,604.92	4,856.77	1,456,352.023	3,173,926.083	40.584399	-104.873805
19,300.00	89.12	89.80	7,075.35	-3,604.57	4,956.76	1,456,352.375	3,174,026.070	40.584398	-104.873445
19,400.00	89.12	89.80	7,076.88	-3,604.21	5,056.75	1,456,352.726	3,174,126.058	40.584397	-104.873085
19,500.00	89.12	89.80	7,078.41	-3,603.86	5,156.74	1,456,353.078	3,174,226.046	40.584396	-104.872725
19,600.00	89.12	89.80	7,079.94	-3,603.51	5,256.72	1,456,353.429	3,174,326.033	40.584395	-104.872365
19,700.00	89.12	89.80	7,081.47	-3,603.16	5,356.71	1,456,353.781	3,174,426.021	40.584394	-104.872005
19,800.00	89.12	89.80	7,083.00	-3,602.81	5,456.70	1,456,354.133	3,174,526.009	40.584393	-104.871645
19,854.07	89.12	89.80	7,084.00	-3,602.55	5,510.76	1,456,354.395	3,174,580.068	40.584393	-104.871450
TD at 19854.07 - BHL 7X-HNC 1076 FSL 460 FEL									

<b>Database:</b>	EDM 5000.15 Single User Db	<b>Local Co-ordinate Reference:</b>	Well BLEHM-7X-HNC-10-07-67
<b>Company:</b>	Nickel Road Operating	<b>TVD Reference:</b>	KB @ 5115.00usft
<b>Project:</b>	Sec. 9-T7N-R67W	<b>MD Reference:</b>	KB @ 5115.00usft
<b>Site:</b>	BLEHM Pad	<b>North Reference:</b>	Grid
<b>Well:</b>	BLEHM-7X-HNC-10-07-67	<b>Survey Calculation Method:</b>	Minimum Curvature
<b>Wellbore:</b>	Wellbore #1		
<b>Design:</b>	Plan #2		

Design Targets									
Target Name	Dip Angle	Dip Dir.	TVD	+N/-S	+E/-W	Northing	Easting	Latitude	Longitude
- hit/miss target	(°)	(°)	(usft)	(usft)	(usft)	(usft)	(usft)		
- Shape									
SHL 7X-HNC 572 FNL 7	0.00	0.00	0.00	0.00	0.00	1,459,956.941	3,169,069.309	40.594387	-104.891201
- plan hits target center									
- Point									
LPL 7X-HNC 1076 FSL 4	0.00	0.00	6,937.00	-3,636.31	-4,091.14	1,456,320.630	3,164,978.163	40.584482	-104.906020
- plan misses target center by 10.38usft at 10252.33usft MD (6929.62 TVD, -3629.32 N, -4089.07 E)									
- Point									
BHL 7X-HNC 1076 FSL	0.00	0.00	7,084.00	-3,602.55	5,510.76	1,456,354.395	3,174,580.068	40.584393	-104.871450
- plan hits target center									
- Point									

Plan Annotations				
Measured Depth	Vertical Depth	Local Coordinates		Comment
(usft)	(usft)	+N/-S (usft)	+E/-W (usft)	
1,500.00	1,500.00	0.00	0.00	Surf Csg
1,600.00	1,600.00	0.00	0.00	Start Build 2.00
4,640.76	4,101.11	-821.05	-1,216.73	Hold 60.82 Inc, 235.99 Az
9,001.36	6,227.46	-2,950.55	-4,372.46	KOP 10°/100
10,360.14	6,938.50	-3,636.00	-3,982.00	LP 89.12 Inc, 89.80 Az
19,854.07	7,084.00	-3,602.55	5,510.76	TD at 19854.07