

T8N, R60W, 6th P.M.

- NOTE:**
Distances referenced
on plat to section lines
are perpendicular.

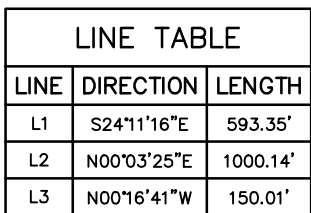

SURFACE LOCATION
545' FSL 2663' FEL
NAD 83 (SURFACE LOCATION)
LATITUDE = 40°39'23.36" (40.656490°)
LONGITUDE = 104°08'04.35" (104.134543°)
NAD 27 (SURFACE LOCATION)
LATITUDE = 40°39'23.41" (40.656504°)
LONGITUDE = 104°08'02.54" (104.134038°)
STATE PLANE NAD 83 (CO. NORTH)
N: 1484918.49' E: 33778840.13'
STATE PLANE NAD 27 (CO. NORTH)
N: 484917.48' E: 2378990.11'

BEG. PROD. INTERVAL
1000' FSL 2846' FWL 2423' FEL
NAD 83 (BEG. PROD. INTERVAL)
LATITUDE = 40°39'27.87" (40.657742°)
LONGITUDE = 104°08'01.13" (104.133647°)
NAD 27 (BEG. PROD. INTERVAL)
LATITUDE = 40°39'27.92" (40.657757°)
LONGITUDE = 104°07'59.31" (104.133143°)
STATE PLANE NAD 83 (CO. NORTH)
N: 1485378.58' E: 3379081.61'
STATE PLANE NAD 27 (CO. NORTH)
N: 485377.55' E: 2379231.59'

ENDING PROD. INTERVAL
1000' FNL 2846' FWL 2475' FEL
NAD 83 (ENDING PROD. INTERVAL)
LATITUDE = 40°40'52.55" (40.681264°)
LONGITUDE = 104°08'00.01" (104.133337°)
NAD 27 (ENDING PROD. INTERVAL)
LATITUDE = 40°40'52.60" (40.681278°)
LONGITUDE = 104°07'58.20" (104.132833°)
STATE PLANE NAD 83 (CO. NORTH)
N: 1493948.38' E: 3379035.49'
STATE PLANE NAD 27 (CO. NORTH)
N: 493947.19' E: 2379185.36'

TARGET BOTTOM HOLE
850' FNL 2846' FWL 2476' FEL
NAD 83 (TARGET BOTTOM HOLE)
LATITUDE = 40°40'54.03" (40.681675°)
LONGITUDE = 104°08'00.00" (104.133335°)
NAD 27 (TARGET BOTTOM HOLE)
LATITUDE = 40°40'54.08" (40.681690°)
LONGITUDE = 104°07'58.19" (104.132830°)
STATE PLANE NAD 83 (CO. NORTH)
N: 1494098.33' E: 3379023.93'
STATE PLANE NAD 27 (CO. NORTH)
N: 494097.14' E: 2379183.79'

PDOP = 1.9



THIS IS TO CERTIFY THAT THE ABOVE DEATH WAS PREPARED FROM FIELD NOTES OF ACTUAL SURVEYS MADE BY ME OR UNDER MY SUPERVISION, AND THAT THE SAME ARE TRUE AND CORRECT TO THE BEST OF MY KNOWLEDGE AND BELIEF.

REGISTERED LAND SURVEYOR
REGISTRATION NO. 28285
STATE OF COLORADO 08-28-20



REV: 1 08-25-20 C.IVIE (BPI & EPI MOVE)

BASIS OF ELEVATION
OPUS SOLUTION GENERATED NAVD 88



UELS, LLC
Corporate Office * 85 South 200 East
Vernal, UT 84078 * (435) 789-1017

BISON OIL & GAS II

ROSS 8-60 18-7-7
SW 1/4 SE 1/4, SECTION 18, T8N, R60W, 6th P.M.
WELD COUNTY, COLORADO

SURVEYED BY	CHAD MEIERS, O.R.	02-25-20	SCALE
DRAWN BY	C.IVIE	05-07-20	1" = 1000'

WELL LOCATION PLAT