

Table 3 Petx-Lowe 1A Tank Battery Sample Results – October 14, 2019

Parameter	Table 910-1 Standards	Sample ID and Depth			
		PLTB-1 (6-10")	PLTB-2 (18-24")	PLTB-3 (0-6")	PLTB-4 (0-6")
TVPH – gasoline range	500 ¹	0.359	<0.1	<0.1	<0.1
TEPH – diesel and motor oil range		69,900	21,200	8.21	12.69
benzene	0.17	<0.0005	<0.0005	<0.0005	<0.0005
toluene	85	<0.005	<0.005	<0.005	<0.005
ethylbenzene	100	<0.0005	<0.0005	<0.0005	<0.0005
xylenes	175	<0.0015	<0.0015	<0.0015	<0.0015
specific conductance (mmhos/cm)	<4.0	0.908	0.479	1.38	0.53
pH (standard units)	6-9	8.39	8.32	8.72	9.61
SAR (ratio)	<12	2.69	4.31	7.45	8.18

¹The standard is 500 for the combined total of TVPH and TEPH. All units in mg/kg except where indicated.
Values in bold type exceed standards.



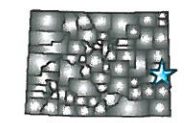

GeoSolutions
NICHOLSON

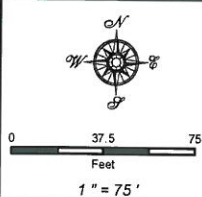

Kit Carson County, CO



Legend

-  Sample Location
-  Impacted Soil

PO&G Resources

Petx-Lowe 1A
Tank Battery
Remote Locations

Figure 3

October 2019