

Nov-6-2018  
EMM-2015 Dip: 66.28 deg Field: 51926.9 nT  
Lat: N39 56 40.5024 Long: W104 48 16.6932 Elev: 5047.00 ft  
Magnetic North is 8.15 deg East of TRUE North  
To correct azimuth from Magnetic to TRUE add 8.15 deg

# Great Western Operating Company, LLC

Location	Colorado	Slot	S19 - Prairie LE 17-018HNX
Field	Wattenburg	Well	- Prairie LE 17-018HNX
Installation	Prairie	Wellbore	S19 - Prairie LE 17-018HNX (PWB)

Scale 1 cm = 400 ft

East (Feet) ->

Created by	mmount
Date plotted	20-Dec-2019
Plot reference is S19 - Prairie LE 17-018HNX (PWB).	
Ref wellpath is S19 - Prairie LE 17-018HNX (PWP#1).	
Coordinates are in Feet reference S19 - Prairie LE 17-018HNX.	
True Vertical Depths are reference Rig Datum.	
Measured Depths are reference Rig Datum.	
Rig Datum: Planned Datum #1	
Rig Datum to Mean Sea Level: 5067.00 ft.	
Plot North is aligned to TRUE North.	

<- True Vertical Depth (Feet)

Scale 1 cm = 800 ft

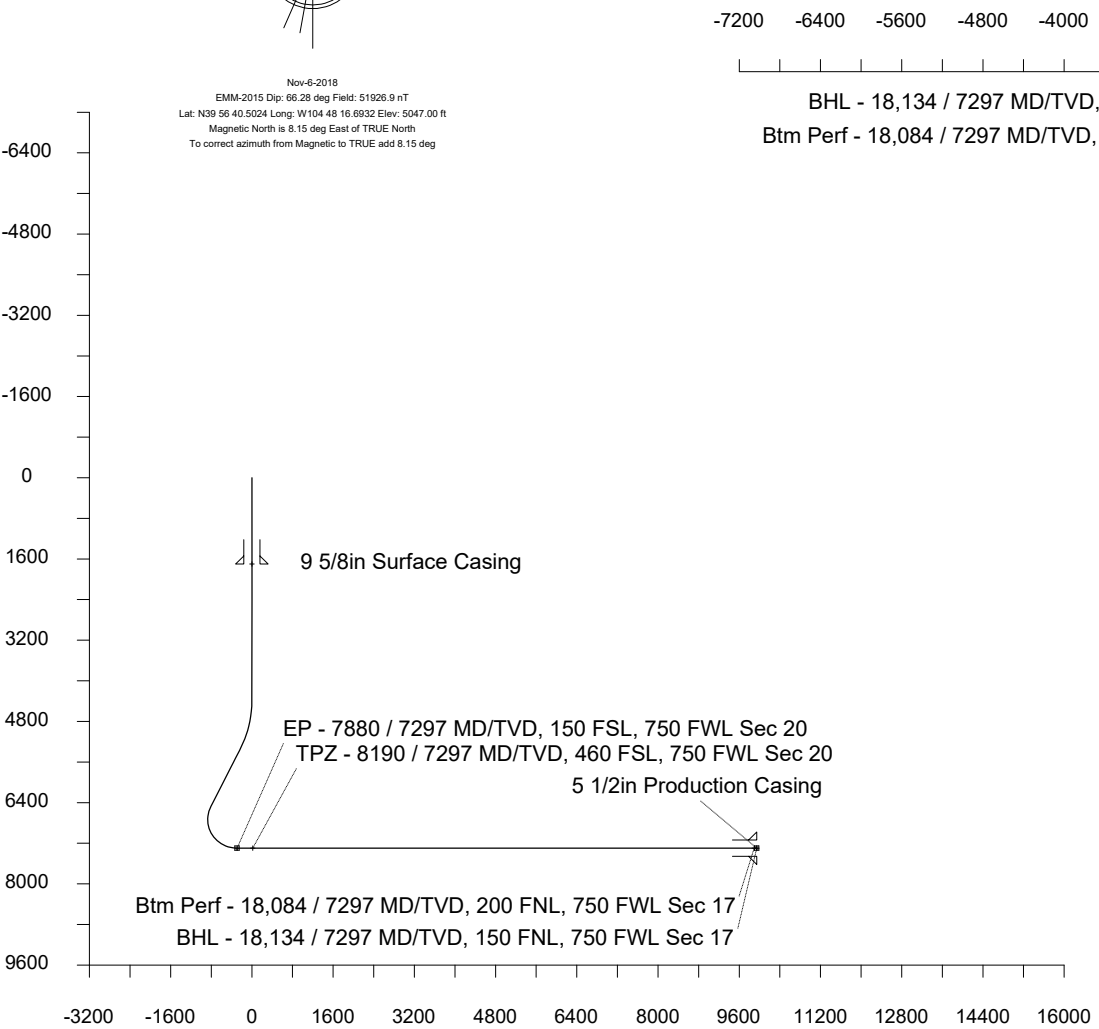

Scale 1 cm = 800 ft

Vertical Section (Feet) ->

Azimuth 356.72 with reference 0.00 N, 0.00 E from S19 - Prairie LE 17-018HNX

## WELL PROFILE DATA

Point	MD	Inc	Azi	TVD	North	East	deg/100ft	
Tie on	0.00	0.00	0.00	0.00	S 0.00	W 0.00		
KOP	4381.50	0.00	204.78	4381.50	S 0.00	W 0.00	0.00	
Target EP - 7...Sec 20	7880.35	90.00	0.06	7297.00	S 324.93	W 580.69	10.00	
Target TPZ - 7...Sec 2	8190.35	90.00	0.06	7297.00	S 14.93	W 580.69	10.00	
Target BTM PERF... 1	18084.22	90.00	0.06	7297.00	N 9878.93	W 569.24	0.00	
T.D. & Target BHL... 17	18134.22	90.00	0.06	7297.00	N 9928.93	W 569.24	0.00	

-7200 -6400 -5600 -4800 -4000 -3200 -2400 -1600 -800 0 800 1600 2400 3200 4000

BHL - 18,134 / 7297 MD/TVD, 150 FNL, 750 FWL Sec 17

Btm Perf - 18,084 / 7297 MD/TVD, 200 FNL, 750 FWL Sec 17

11200

10400

9600

8800

8000

7200

6400

5600

Sec 17, T1S, R66W

4800

4000

3200

2400

1600

800

0

Sec 20, T1S, R66W

Sec 29, T1S, R66W

-800

-1600

<- North(Feet)

TPZ - 8190 / 7297 MD/TVD, 460 FSL, 750 FWL Sec 20

EP - 7880 / 7297 MD/TVD, 150 FSL, 750 FWL Sec 20