

R
67
W

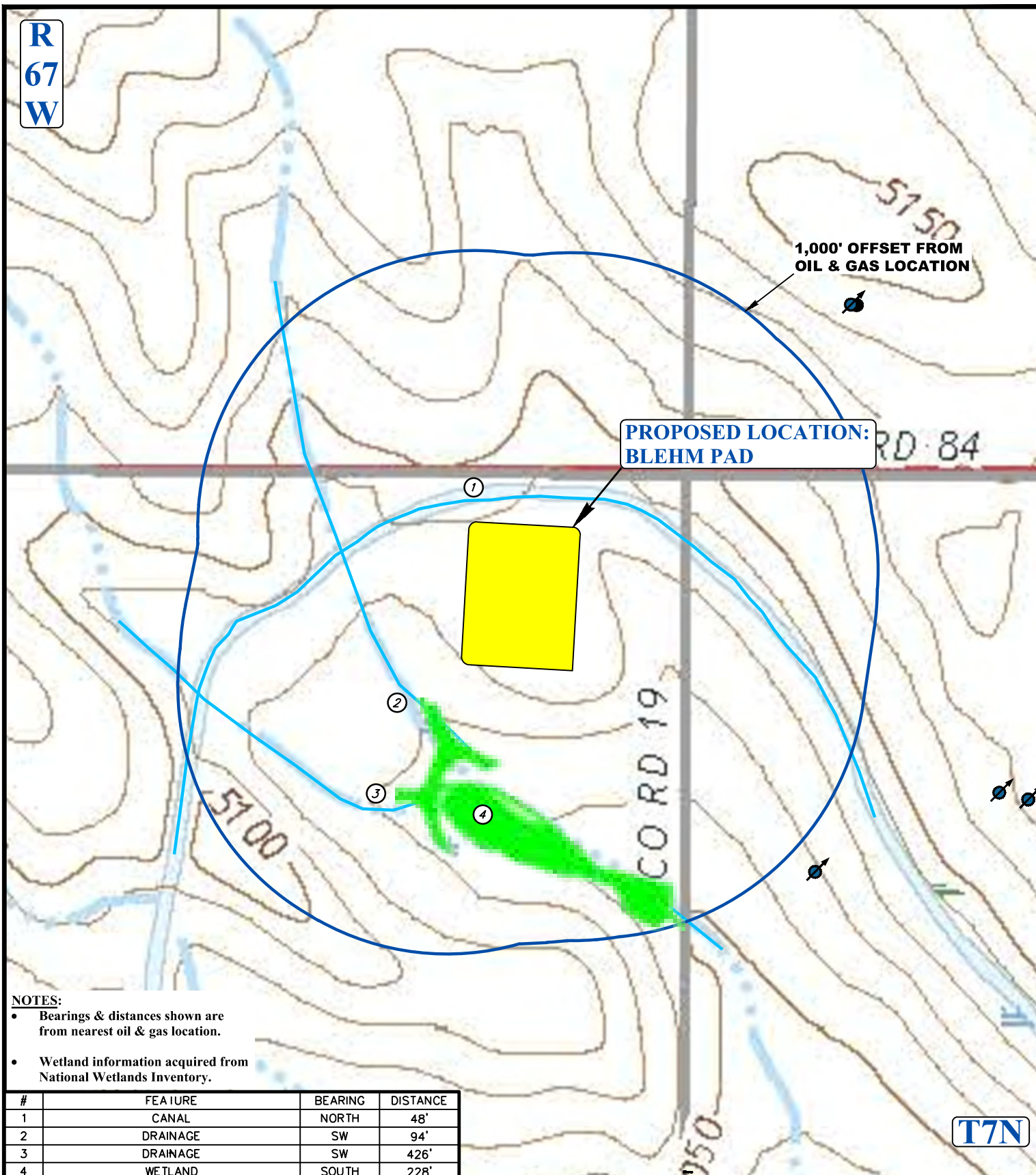

NOTES:

- Bearings & distances shown are from nearest oil & gas location.
- Wetland information acquired from National Wetlands Inventory.

#	FEATURE	BEARING	DISTANCE
1	CANAL	NORTH	48'
2	DRAINAGE	SW	94'
3	DRAINAGE	SW	426'
4	WETLAND	SOUTH	228'

LEGEND:

- 1000' OFFSET BOUNDARY
- OIL & GAS LOCATION
- EXISTING DRAINAGE
- WETLAND



UELS, LLC
Corporate Office * 85 South 200 East
Vernal, UT 84078 * (435) 789-1017



NICKEL ROAD OPERATING

BLEHM PAD
NE 1/4 NE 1/4, SECTION 9, T7N, R67W, 6th P.M.
WELD COUNTY, COLORADO

SURVEYED BY	N.W., A.S.	06-23-20	SCALE
DRAWN BY	C.IVIE	07-28-20	1 : 6,000
HYDROLOGY MAP			TOPO W