

R
66
W

16

T8N R66W

1,000' OFFSET
FROM OIL &
GAS LOCATION

FLOOD PLAINS

PROPOSED LOCATION:
REEMAN PAD

DRAINAGE

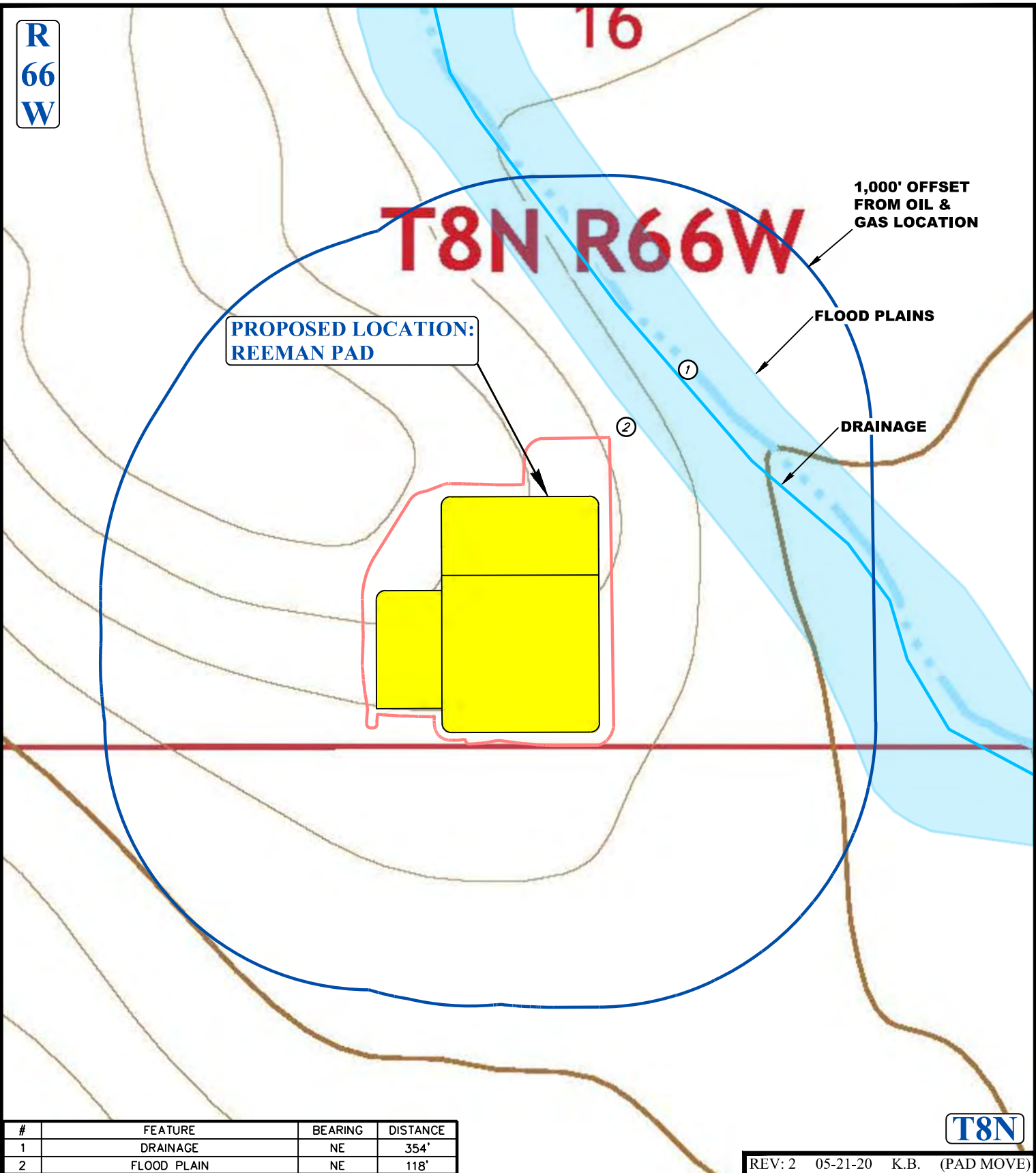

T8N

#	FEATURE	BEARING	DISTANCE
1	DRAINAGE	NE	354'
2	FLOOD PLAIN	NE	118'

REV: 2 05-21-20 K.B. (PAD MOVE)

LEGEND:

-  EXISTING DRAINAGE
-  1000' OFFSET BOUNDARY
-  OIL & GAS LOCATION
-  FLOOD PLAINS



GREAT WESTERN OPERATING COMPANY

REEMAN PAD
 SE 1/4 SW 1/4, SECTION 16, T8N, R66W, 6th P.M.
 WELD COUNTY, COLORADO

SURVEYED BY	M.M.	05-18-20	SCALE
DRAWN BY	J.L.G.	05-06-19	1 : 6,000
HYDROLOGY MAP			TOPO W



UELS, LLC
 Corporate Office * 85 South 200 East
 Vernal, UT 84078 * (435) 789-1017