



Corporate Office

1775 Sherman Street, #3000
Denver, Colorado 80203
303.860.5800
www.pdce.com

August 6, 2020

State of Colorado, Oil & Gas Conservation Commission
Attn: Director
1120 Lincoln Street, Suite 801
Denver, CO 80203

Re: **30 Day Certification Letter – Rule 318Ae**
Stugart 24N (Doc 402437910)
SENW Section 20, T5N-R66W, 6th PM
Weld County, Colorado

Dear Director,

PDC Energy, Inc. ("PDC") hereby certifies to the Director that a thirty (30-day) notice has been given by certified mail to all owners in the proposed wellbore spacing unit consisting of T5N-R66W: Section 20: SESW, S2SE, Section 21: S2S2, Section 28: N2N2, Section 29: NENW, N2NE, 560 acres. We have not received any objections to such well location or proposed spacing unit, therefore, PDC hereby requests the Director to approve the well.

If you should have any questions or concerns regarding this permit, please contact the undersigned at (303) 831-3931.

Sincerely,

A handwritten signature in black ink, appearing to read "Ally Ota".

Ally Ota
Regulatory Analyst
PDC Energy, Inc.

STUGART 16-30N-21C-M WELLBORE SPACING UNIT

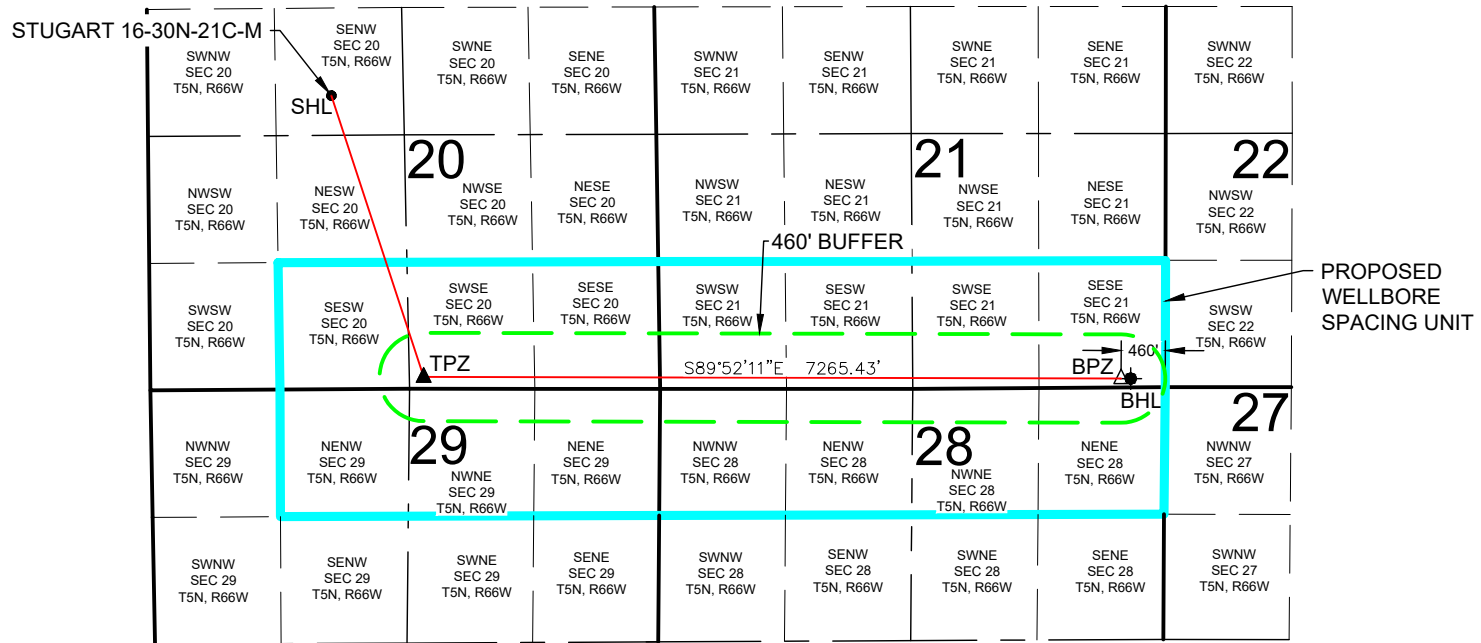

STUGART 16-30N-21C-M WELL TO BE LOCATED 2238' FNL AND 1914' FWL, SEC 20, T5N, R66W

DISTANCE FROM COMPLETED
PORTION OF WELLBORE TO
NEAREST UNIT BOUNDARY = 460'

LEGEND

- = PROPOSED WELL
- = BOTTOM HOLE
- △ = BOTTOM OF PRODUCTION ZONE
- ▲ = TOP OF PRODUCTION ZONE
- SHL = SURFACE HOLE LOCATION
- BHL = BOTTOM HOLE LOCATION
- BPZ = BOTTOM OF PRODUCTION ZONE
- TPZ = TOP OF PRODUCTION ZONE

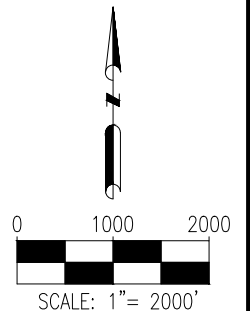

DISCLAIMER:
THIS PLOT DOES NOT REPRESENT A MONUMENTED LAND SURVEY AND
SHOULD NOT BE RELIED UPON TO DETERMINE BOUNDARY LINES, PROPERTY
OWNERSHIP OR OTHER PROPERTY INTERESTS. PARCEL LINES, IF DEPICTED
HAVE NOT BEEN FIELD VERIFIED AND MAY BE BASED UPON PUBLICLY
AVAILABLE DATA THAT ALSO HAS NOT BEEN INDEPENDENTLY VERIFIED.



8620 Wolff Court
Westminster, CO 80031
(303) 928-7128
www.ascentgeomatics.com

FIELD DATE:
11-09-17

DRAWING DATE:
05-09-19

BY:
JDB

CHECKED BY:
IJM

WELL NAME:

STUGART 16-30N-21C-M

SURFACE LOCATION:

SE 1/4 NW 1/4 SEC 20, T5N, R66W, 6TH P.M.
WELD COUNTY, COLORADO

PREPARED FOR:

