

Cub Creek Energy, LLC

| | | | |
|---------------------|------------------------|-----------------|--------------------------|
| Location | Weld County, CO | Slot | KNIGHT 10 |
| Field | WATTENBERG | Well | W KNIGHT 10 |
| Installation | Knight Pad | Wellbore | W KNIGHT 10 (PWB) |

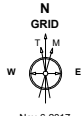

Nov-8-2017
 EMM-2015 Dip: 66.59 deg Field: 52154.0 nT
 Lat: N40 11 52.9440 Long: W105 2 31.0920 Elev: 4993.00 ft
 Magnetic North is 8.54 deg East of True North
 GRID North is 0.30 deg East of True North
 To correct azimuth from True to GRID subtract 0.30 deg
 To correct azimuth from Magnetic to GRID add 8.25 deg

Created by sean.dolfinger
 Date plotted 14-Jul-2020
 Plot reference is W KNIGHT 10 (PWB).
 Ref wellpath is W KNIGHT 10 (PWP#1).
 Coordinates are in Feet reference KNIGHT 10.
 True Vertical Depths are reference Rig Datum.
 Measured Depths are reference Rig Datum.
 Rig Datum: Planned Datum #1
 Rig Datum to Mean Sea Level: 5010.00 ft.
 Plot North is aligned to GRID North.

Scale 1 cm = 400 ft
 East (Feet) ->
 -1600 -800 -0 800

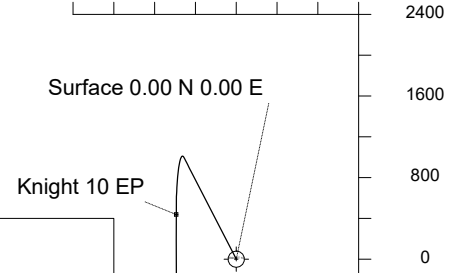

WELL PROFILE DATA

| Point | MD | Inc | Azi | TVD | North | East | deg/100ft | V. Sect |
|-------------------------|----------|-------|--------|---------|------------|----------|-----------|----------|
| Tie on | 17.00 | 0.00 | 0.00 | 17.00 | S 0.00 | W 0.00 | | -0.00 |
| KOP | 1517.00 | 0.00 | 332.77 | 1517.00 | S 0.00 | W 0.00 | 0.00 | -0.00 |
| End of Build | 2205.89 | 13.78 | 332.77 | 2199.27 | N 73.30 | W 37.71 | 2.00 | -71.18 |
| End of Hold | 6572.07 | 13.78 | 332.77 | 6439.81 | N 997.91 | W 513.48 | 0.00 | -969.11 |
| Target Knight 10 EP | 7594.51 | 90.00 | 179.84 | 7130.00 | N 437.77 | W 588.90 | 10.00 | -405.75 |
| T.D. & Target Kni... BH | 18483.42 | 90.00 | 179.84 | 7130.00 | S 10451.10 | W 558.07 | 0.00 | 10465.99 |

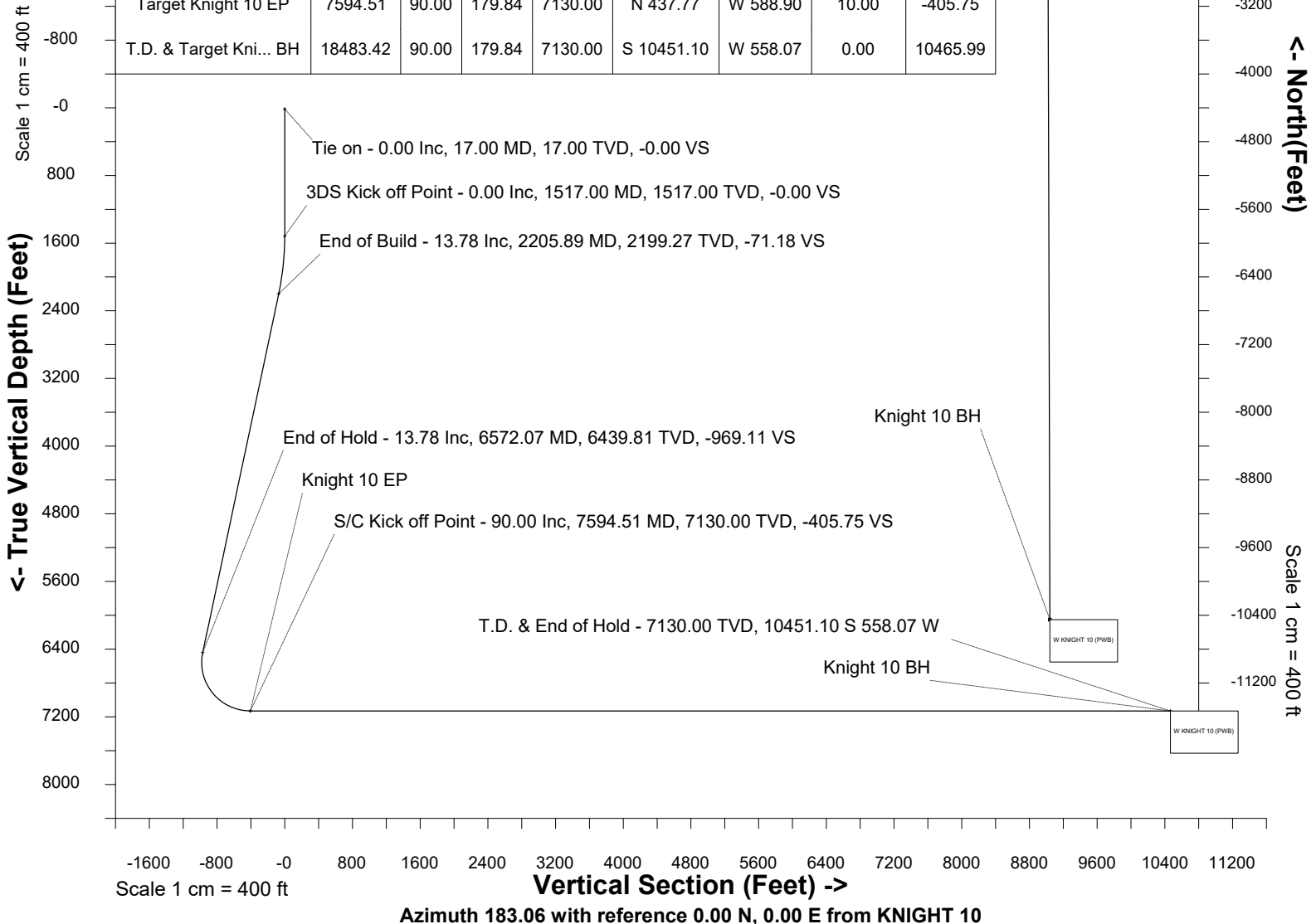

SYSDRILL
Well Design Combined Report
Wellbore: W KNIGHT 10 (PWB)



| Wellhead Details | | | | | | | |
|------------------|-------------|---------------|--------------|--------------|---------|-------|-----------------------------|
| Name | Latitude | Longitude | Northing | Easting | North | East | Slot Elevation Above Ground |
| KNIGHT 10 | 40.19763000 | -105.04197000 | 1315169.5482 | 3127946.3204 | 149.36S | 0.77E | 0.00 |

| Declination | | |
|-------------|----------|-------|
| Date | Source | Time |
| Nov-6-2017 | EMM-2015 | 14:52 |

| Installation Details | | | | | | |
|----------------------|----------------------------------|-----------------------------------|--------------|--------------|---|-----------------|
| Name | Installation Position (Latitude) | Installation Position (Longitude) | Northing | Easting | Coord System Name | North Alignment |
| Knight Pad | 40.19804000 | -105.04197000 | 1315318.9022 | 3127945.5490 | NAD83 Based Colorado State Planes, Northern Zone, US Feet | Grid |

| Summary Wellpath | | | | | | | | |
|------------------|----------|----------|---------|-------------------|-----------|----------|--------------------|----------------------|
| MD[ft] | Inc[deg] | Azi[deg] | TVD[ft] | Vertical Depth SS | North[ft] | East[ft] | Dogleg [deg/100ft] | Vertical Section[ft] |
| 17.00 | 0.00 | 0.00 | 17.00 | -4993.00 | 0.00N | 0.00E | | 0.00 |
| 1517.00 | 0.00 | 332.77 | 1517.00 | -3493.00 | 0.00N | 0.00E | ==> | 0.00 |
| 2205.89 | 13.78 | 332.77 | 2199.27 | -2810.73 | 73.30N | 37.71W | 2.00 | -71.18 |
| 6572.07 | 13.78 | 332.77 | 6439.81 | 1429.81 | 997.91N | 513.48W | ==> | -969.11 |
| 7594.51 | 90.00 | 179.84 | 7130.00 | 2120.00 | 437.77N | 588.90W | 10.00 | -405.75 |
| 18483.42 | 90.00 | 179.84 | 7130.00 | 2120.00 | 10451.10S | 558.07W | ==> | 10465.99 |

| Interpolated Wellpath | | | | | | | | | |
|-----------------------|----------|----------|---------|-----------|----------|--------------------|----------------------|-----------------------------|------------------------------|
| MD[ft] | Inc[deg] | Azi[deg] | TVD[ft] | North[ft] | East[ft] | Dogleg [deg/100ft] | Vertical Section[ft] | Station Position (Latitude) | Station Position (Longitude) |
| 0.00 | 0.00 | 0.00 | 0.00 | 0.00N | 0.00E | | 0.00 | 40.19763000 | -105.04197000 |
| 17.00 | 0.00 | 0.00 | 17.00 | 0.00N | 0.00E | ==> | 0.00 | 40.19763000 | -105.04197000 |
| 100.00 | 0.00 | 0.00 | 100.00 | 0.00N | 0.00E | ==> | 0.00 | 40.19763000 | -105.04197000 |
| 200.00 | 0.00 | 0.00 | 200.00 | 0.00N | 0.00E | ==> | 0.00 | 40.19763000 | -105.04197000 |
| 300.00 | 0.00 | 0.00 | 300.00 | 0.00N | 0.00E | ==> | 0.00 | 40.19763000 | -105.04197000 |
| 400.00 | 0.00 | 0.00 | 400.00 | 0.00N | 0.00E | ==> | 0.00 | 40.19763000 | -105.04197000 |
| 500.00 | 0.00 | 0.00 | 500.00 | 0.00N | 0.00E | ==> | 0.00 | 40.19763000 | -105.04197000 |
| 600.00 | 0.00 | 0.00 | 600.00 | 0.00N | 0.00E | ==> | 0.00 | 40.19763000 | -105.04197000 |
| 700.00 | 0.00 | 0.00 | 700.00 | 0.00N | 0.00E | ==> | 0.00 | 40.19763000 | -105.04197000 |
| 800.00 | 0.00 | 0.00 | 800.00 | 0.00N | 0.00E | ==> | 0.00 | 40.19763000 | -105.04197000 |
| 900.00 | 0.00 | 0.00 | 900.00 | 0.00N | 0.00E | ==> | 0.00 | 40.19763000 | -105.04197000 |
| 1000.00 | 0.00 | 0.00 | 1000.00 | 0.00N | 0.00E | ==> | 0.00 | 40.19763000 | -105.04197000 |
| 1100.00 | 0.00 | 0.00 | 1100.00 | 0.00N | 0.00E | ==> | 0.00 | 40.19763000 | -105.04197000 |
| 1200.00 | 0.00 | 0.00 | 1200.00 | 0.00N | 0.00E | ==> | 0.00 | 40.19763000 | -105.04197000 |
| 1300.00 | 0.00 | 0.00 | 1300.00 | 0.00N | 0.00E | ==> | 0.00 | 40.19763000 | -105.04197000 |
| 1400.00 | 0.00 | 0.00 | 1400.00 | 0.00N | 0.00E | ==> | 0.00 | 40.19763000 | -105.04197000 |
| 1500.00 | 0.00 | 0.00 | 1500.00 | 0.00N | 0.00E | ==> | 0.00 | 40.19763000 | -105.04197000 |
| 1517.00 | 0.00 | 332.77 | 1517.00 | 0.00N | 0.00E | ==> | 0.00 | 40.19763000 | -105.04197000 |
| 1617.00 | 2.00 | 332.77 | 1616.98 | 1.55N | 0.80W | 2.00 | -1.51 | 40.19763427 | -105.04197283 |
| 1717.00 | 4.00 | 332.77 | 1716.84 | 6.21N | 3.19W | 2.00 | -6.03 | 40.19764708 | -105.04198131 |
| 1817.00 | 6.00 | 332.77 | 1816.45 | 13.95N | 7.18W | 2.00 | -13.55 | 40.19766841 | -105.04199545 |
| 1917.00 | 8.00 | 332.77 | 1915.70 | 24.79N | 12.76W | 2.00 | -24.08 | 40.19769823 | -105.04201520 |
| 2017.00 | 10.00 | 332.77 | 2014.47 | 38.70N | 19.91W | 2.00 | -37.58 | 40.19773651 | -105.04204057 |
| 2117.00 | 12.00 | 332.77 | 2112.62 | 55.67N | 28.64W | 2.00 | -54.06 | 40.19778321 | -105.04207150 |
| 2205.89 | 13.78 | 332.77 | 2199.27 | 73.30N | 37.71W | 2.00 | -71.18 | 40.19783173 | -105.04210365 |
| 2217.00 | 13.78 | 332.77 | 2210.06 | 75.65N | 38.93W | ==> | -73.47 | 40.19783820 | -105.04210794 |
| 2317.00 | 13.78 | 332.77 | 2307.18 | 96.83N | 49.82W | ==> | -94.03 | 40.19789649 | -105.04214655 |
| 2417.00 | 13.78 | 332.77 | 2404.31 | 118.00N | 60.72W | ==> | -114.60 | 40.19795477 | -105.04218517 |
| 2517.00 | 13.78 | 332.77 | 2501.43 | 139.18N | 71.61W | ==> | -135.16 | 40.19801306 | -105.04222378 |
| 2617.00 | 13.78 | 332.77 | 2598.55 | 160.36N | 82.51W | ==> | -155.73 | 40.19807134 | -105.04226240 |
| 2717.00 | 13.78 | 332.77 | 2695.67 | 181.53N | 93.41W | ==> | -176.29 | 40.19812962 | -105.04230101 |
| 2817.00 | 13.78 | 332.77 | 2792.80 | 202.71N | 104.30W | ==> | -196.86 | 40.19818791 | -105.04233963 |

All data is in Feet unless otherwise stated
Coordinates are from Slot MD's are from Rig and TVD's are from Rig (Planned Datum #1 5010.0ft above Mean Sea Level)
Vertical Section is from 0.00N 0.00E on azimuth 183.06 degrees
Bottom hole distance is 10465.99 Feet on azimuth 183.06 degrees from Wellhead
Calculation method uses Minimum Curvature method
Prepared by
Date Printed: 14-Jul-2020

SYSDRILL
Well Design Combined Report
Wellbore: W KNIGHT 10 (PWB)



| Interpolated Wellpath | | | | | | | | | |
|-----------------------|----------|----------|---------|-----------|----------|-----------------------|-------------------------|-----------------------------------|------------------------------------|
| MD[ft] | Inc[deg] | Azi[deg] | TVD[ft] | North[ft] | East[ft] | Dogleg [deg/100ft] | Vertical Section[ft] | Station Position (Latitude) | Station Position (Longitude) |
| 2917.00 | 13.78 | 332.77 | 2889.92 | 223.89N | 115.20W | ==> | -217.43 | 40.19824619 | -105.04237824 |
| 3017.00 | 13.78 | 332.77 | 2987.04 | 245.06N | 126.10W | ==> | -237.99 | 40.19830448 | -105.04241686 |
| 3117.00 | 13.78 | 332.77 | 3084.16 | 266.24N | 136.99W | ==> | -258.56 | 40.19836276 | -105.04245547 |
| 3217.00 | 13.78 | 332.77 | 3181.29 | 287.42N | 147.89W | ==> | -279.12 | 40.19842104 | -105.04249409 |
| 3317.00 | 13.78 | 332.77 | 3278.41 | 308.59N | 158.79W | ==> | -299.69 | 40.19847933 | -105.04253270 |
| 3417.00 | 13.78 | 332.77 | 3375.53 | 329.77N | 169.68W | ==> | -320.25 | 40.19853761 | -105.04257132 |
| 3517.00 | 13.78 | 332.77 | 3472.65 | 350.95N | 180.58W | ==> | -340.82 | 40.19859589 | -105.04260993 |
| 3617.00 | 13.78 | 332.77 | 3569.78 | 372.12N | 191.48W | ==> | -361.38 | 40.19865418 | -105.04264855 |
| 3717.00 | 13.78 | 332.77 | 3666.90 | 393.30N | 202.37W | ==> | -381.95 | 40.19871246 | -105.04268717 |
| 3817.00 | 13.78 | 332.77 | 3764.02 | 414.48N | 213.27W | ==> | -402.52 | 40.19877075 | -105.04272578 |
| 3917.00 | 13.78 | 332.77 | 3861.15 | 435.65N | 224.17W | ==> | -423.08 | 40.19882903 | -105.04276440 |
| 4017.00 | 13.78 | 332.77 | 3958.27 | 456.83N | 235.06W | ==> | -443.65 | 40.19888731 | -105.04280301 |
| 4117.00 | 13.78 | 332.77 | 4055.39 | 478.01N | 245.96W | ==> | -464.21 | 40.19894560 | -105.04284163 |
| 4217.00 | 13.78 | 332.77 | 4152.51 | 499.19N | 256.86W | ==> | -484.78 | 40.19900388 | -105.04288024 |
| 4317.00 | 13.78 | 332.77 | 4249.64 | 520.36N | 267.75W | ==> | -505.34 | 40.19906217 | -105.04291886 |
| 4417.00 | 13.78 | 332.77 | 4346.76 | 541.54N | 278.65W | ==> | -525.91 | 40.19912045 | -105.04295748 |
| 4517.00 | 13.78 | 332.77 | 4443.88 | 562.72N | 289.55W | ==> | -546.48 | 40.19917873 | -105.04299609 |
| 4617.00 | 13.78 | 332.77 | 4541.00 | 583.89N | 300.44W | ==> | -567.04 | 40.19923702 | -105.04303471 |
| 4717.00 | 13.78 | 332.77 | 4638.13 | 605.07N | 311.34W | ==> | -587.61 | 40.19929530 | -105.04307333 |
| 4817.00 | 13.78 | 332.77 | 4735.25 | 626.25N | 322.24W | ==> | -608.17 | 40.19935358 | -105.04311194 |
| 4917.00 | 13.78 | 332.77 | 4832.37 | 647.42N | 333.13W | ==> | -628.74 | 40.19941187 | -105.04315056 |
| 5017.00 | 13.78 | 332.77 | 4929.49 | 668.60N | 344.03W | ==> | -649.30 | 40.19947015 | -105.04318917 |
| 5117.00 | 13.78 | 332.77 | 5026.62 | 689.78N | 354.93W | ==> | -669.87 | 40.19952843 | -105.04322779 |
| 5217.00 | 13.78 | 332.77 | 5123.74 | 710.95N | 365.82W | ==> | -690.44 | 40.19958672 | -105.04326641 |
| 5317.00 | 13.78 | 332.77 | 5220.86 | 732.13N | 376.72W | ==> | -711.00 | 40.19964500 | -105.04330502 |
| 5417.00 | 13.78 | 332.77 | 5317.98 | 753.31N | 387.62W | ==> | -731.57 | 40.19970329 | -105.04334364 |
| 5517.00 | 13.78 | 332.77 | 5415.11 | 774.48N | 398.51W | ==> | -752.13 | 40.19976157 | -105.04338226 |
| 5617.00 | 13.78 | 332.77 | 5512.23 | 795.66N | 409.41W | ==> | -772.70 | 40.19981985 | -105.04342087 |
| 5717.00 | 13.78 | 332.77 | 5609.35 | 816.84N | 420.31W | ==> | -793.26 | 40.19987814 | -105.04345949 |
| 5817.00 | 13.78 | 332.77 | 5706.47 | 838.01N | 431.20W | ==> | -813.83 | 40.19993642 | -105.04349811 |
| 5917.00 | 13.78 | 332.77 | 5803.60 | 859.19N | 442.10W | ==> | -834.40 | 40.19999470 | -105.04353673 |
| 6017.00 | 13.78 | 332.77 | 5900.72 | 880.37N | 453.00W | ==> | -854.96 | 40.20005299 | -105.04357534 |
| 6117.00 | 13.78 | 332.77 | 5997.84 | 901.55N | 463.89W | ==> | -875.53 | 40.20011127 | -105.04361396 |
| 6217.00 | 13.78 | 332.77 | 6094.97 | 922.72N | 474.79W | ==> | -896.09 | 40.20016955 | -105.04365258 |
| 6317.00 | 13.78 | 332.77 | 6192.09 | 943.90N | 485.69W | ==> | -916.66 | 40.20022784 | -105.04369119 |
| 6417.00 | 13.78 | 332.77 | 6289.21 | 965.08N | 496.58W | ==> | -937.22 | 40.20028612 | -105.04372981 |
| 6517.00 | 13.78 | 332.77 | 6386.33 | 986.25N | 507.48W | ==> | -957.79 | 40.20034440 | -105.04376843 |
| 6572.07 | 13.78 | 332.77 | 6439.81 | 997.91N | 513.48W | ==> | -969.11 | 40.20037650 | -105.04378969 |
| 6617.00 | 10.02 | 320.67 | 6483.78 | 1005.70N | 518.41W | 10.00 | -976.63 | 40.20039794 | -105.04380719 |
| 6717.00 | 6.75 | 250.33 | 6582.93 | 1010.46N | 529.48W | 10.00 | -980.79 | 40.20041116 | -105.04384675 |
| 6817.00 | 13.78 | 206.89 | 6681.39 | 997.83N | 540.43W | 10.00 | -967.59 | 40.20037664 | -105.04388618 |
| 6917.00 | 23.10 | 195.00 | 6776.18 | 968.18N | 550.93W | 10.00 | -937.43 | 40.20029541 | -105.04392429 |
| 7017.00 | 32.81 | 189.81 | 6864.42 | 922.42N | 560.64W | 10.00 | -891.22 | 40.20016995 | -105.04395992 |
| 7117.00 | 42.64 | 186.80 | 6943.43 | 861.95N | 569.29W | 10.00 | -830.37 | 40.20000407 | -105.04399197 |
| 7217.00 | 52.52 | 184.75 | 7010.81 | 788.59N | 576.60W | 10.00 | -756.72 | 40.19980280 | -105.04401949 |
| 7317.00 | 62.44 | 183.18 | 7064.51 | 704.58N | 582.35W | 10.00 | -672.52 | 40.19957227 | -105.04404163 |
| 7417.00 | 72.36 | 181.87 | 7102.89 | 612.46N | 586.37W | 10.00 | -580.32 | 40.19931948 | -105.04405773 |
| 7517.00 | 82.30 | 180.70 | 7124.80 | 515.04N | 588.54W | 10.00 | -482.93 | 40.19905210 | -105.04406728 |
| 7594.51 | 90.00 | 179.84 | 7130.00 | 437.77N | 588.90W | 10.00 | -405.75 | 40.19884000 | -105.04407000 |
| 7617.00 | 90.00 | 179.84 | 7130.00 | 415.28N | 588.84W | ==> | -383.29 | 40.19877825 | -105.04407019 |
| 7717.00 | 90.00 | 179.84 | 7130.00 | 315.28N | 588.56W | ==> | -283.45 | 40.19850376 | -105.04407101 |
| 7817.00 | 90.00 | 179.84 | 7130.00 | 215.28N | 588.27W | ==> | -183.61 | 40.19822926 | -105.04407184 |
| 7917.00 | 90.00 | 179.84 | 7130.00 | 115.28N | 587.99W | ==> | -83.76 | 40.19795476 | -105.04407267 |
| 8017.00 | 90.00 | 179.84 | 7130.00 | 15.28N | 587.71W | ==> | 16.08 | 40.19768026 | -105.04407349 |
| 8117.00 | 90.00 | 179.84 | 7130.00 | 84.72S | 587.42W | ==> | 115.92 | 40.19740576 | -105.04407432 |
| 8217.00 | 90.00 | 179.84 | 7130.00 | 184.72S | 587.14W | ==> | 215.76 | 40.19713126 | -105.04407515 |
| 8317.00 | 90.00 | 179.84 | 7130.00 | 284.72S | 586.86W | ==> | 315.61 | 40.19685676 | -105.04407597 |
| 8417.00 | 90.00 | 179.84 | 7130.00 | 384.72S | 586.57W | ==> | 415.45 | 40.19658226 | -105.04407680 |

All data is in Feet unless otherwise stated
Coordinates are from Slot MD's are from Rig and TVD's are from Rig (Planned Datum #1 5010.0ft above Mean Sea Level)
Vertical Section is from 0.00N 0.00E on azimuth 183.06 degrees
Bottom hole distance is 10465.99 Feet on azimuth 183.06 degrees from Wellhead
Calculation method uses Minimum Curvature method
Prepared by
Date Printed: 14-Jul-2020

SYSDRILL
Well Design Combined Report
Wellbore: W KNIGHT 10 (PWB)



| Interpolated Wellpath | | | | | | | | | |
|-----------------------|----------|----------|---------|-----------|----------|-----------------------|-------------------------|-----------------------------------|------------------------------------|
| MD[ft] | Inc[deg] | Azi[deg] | TVD[ft] | North[ft] | East[ft] | Dogleg [deg/100ft] | Vertical Section[ft] | Station Position (Latitude) | Station Position (Longitude) |
| 8517.00 | 90.00 | 179.84 | 7130.00 | 484.72S | 586.29W | ==> | 515.29 | 40.19630776 | -105.04407763 |
| 8617.00 | 90.00 | 179.84 | 7130.00 | 584.72S | 586.01W | ==> | 615.13 | 40.19603327 | -105.04407845 |
| 8717.00 | 90.00 | 179.84 | 7130.00 | 684.72S | 585.72W | ==> | 714.97 | 40.19575877 | -105.04407928 |
| 8817.00 | 90.00 | 179.84 | 7130.00 | 784.72S | 585.44W | ==> | 814.82 | 40.19548427 | -105.04408011 |
| 8917.00 | 90.00 | 179.84 | 7130.00 | 884.72S | 585.16W | ==> | 914.66 | 40.19520977 | -105.04408094 |
| 9017.00 | 90.00 | 179.84 | 7130.00 | 984.72S | 584.87W | ==> | 1014.50 | 40.19493527 | -105.04408176 |
| 9117.00 | 90.00 | 179.84 | 7130.00 | 1084.71S | 584.59W | ==> | 1114.34 | 40.19466077 | -105.04408259 |
| 9217.00 | 90.00 | 179.84 | 7130.00 | 1184.71S | 584.31W | ==> | 1214.19 | 40.19438627 | -105.04408342 |
| 9317.00 | 90.00 | 179.84 | 7130.00 | 1284.71S | 584.02W | ==> | 1314.03 | 40.19411177 | -105.04408424 |
| 9417.00 | 90.00 | 179.84 | 7130.00 | 1384.71S | 583.74W | ==> | 1413.87 | 40.19383727 | -105.04408507 |
| 9517.00 | 90.00 | 179.84 | 7130.00 | 1484.71S | 583.46W | ==> | 1513.71 | 40.19356278 | -105.04408590 |
| 9617.00 | 90.00 | 179.84 | 7130.00 | 1584.71S | 583.18W | ==> | 1613.55 | 40.19328828 | -105.04408672 |
| 9717.00 | 90.00 | 179.84 | 7130.00 | 1684.71S | 582.89W | ==> | 1713.40 | 40.19301378 | -105.04408755 |
| 9817.00 | 90.00 | 179.84 | 7130.00 | 1784.71S | 582.61W | ==> | 1813.24 | 40.19273928 | -105.04408838 |
| 9917.00 | 90.00 | 179.84 | 7130.00 | 1884.71S | 582.33W | ==> | 1913.08 | 40.19246478 | -105.04408920 |
| 10017.00 | 90.00 | 179.84 | 7130.00 | 1984.71S | 582.04W | ==> | 2012.92 | 40.19219028 | -105.04409003 |
| 10117.00 | 90.00 | 179.84 | 7130.00 | 2084.71S | 581.76W | ==> | 2112.77 | 40.19191578 | -105.04409086 |
| 10217.00 | 90.00 | 179.84 | 7130.00 | 2184.71S | 581.48W | ==> | 2212.61 | 40.19164128 | -105.04409168 |
| 10317.00 | 90.00 | 179.84 | 7130.00 | 2284.71S | 581.19W | ==> | 2312.45 | 40.19136678 | -105.04409251 |
| 10417.00 | 90.00 | 179.84 | 7130.00 | 2384.71S | 580.91W | ==> | 2412.29 | 40.19109228 | -105.04409334 |
| 10517.00 | 90.00 | 179.84 | 7130.00 | 2484.71S | 580.63W | ==> | 2512.13 | 40.19081778 | -105.04409416 |
| 10617.00 | 90.00 | 179.84 | 7130.00 | 2584.71S | 580.34W | ==> | 2611.98 | 40.19054329 | -105.04409499 |
| 10717.00 | 90.00 | 179.84 | 7130.00 | 2684.71S | 580.06W | ==> | 2711.82 | 40.19026879 | -105.04409582 |
| 10817.00 | 90.00 | 179.84 | 7130.00 | 2784.71S | 579.78W | ==> | 2811.66 | 40.18999429 | -105.04409664 |
| 10917.00 | 90.00 | 179.84 | 7130.00 | 2884.71S | 579.49W | ==> | 2911.50 | 40.18971979 | -105.04409747 |
| 11017.00 | 90.00 | 179.84 | 7130.00 | 2984.71S | 579.21W | ==> | 3011.35 | 40.18944529 | -105.04409830 |
| 11117.00 | 90.00 | 179.84 | 7130.00 | 3084.71S | 578.93W | ==> | 3111.19 | 40.18917079 | -105.04409912 |
| 11217.00 | 90.00 | 179.84 | 7130.00 | 3184.71S | 578.64W | ==> | 3211.03 | 40.18889629 | -105.04409995 |
| 11317.00 | 90.00 | 179.84 | 7130.00 | 3284.71S | 578.36W | ==> | 3310.87 | 40.18862179 | -105.04410078 |
| 11417.00 | 90.00 | 179.84 | 7130.00 | 3384.71S | 578.08W | ==> | 3410.71 | 40.18834729 | -105.04410160 |
| 11517.00 | 90.00 | 179.84 | 7130.00 | 3484.71S | 577.80W | ==> | 3510.56 | 40.18807279 | -105.04410243 |
| 11617.00 | 90.00 | 179.84 | 7130.00 | 3584.70S | 577.51W | ==> | 3610.40 | 40.18779829 | -105.04410326 |
| 11717.00 | 90.00 | 179.84 | 7130.00 | 3684.70S | 577.23W | ==> | 3710.24 | 40.18752379 | -105.04410408 |
| 11817.00 | 90.00 | 179.84 | 7130.00 | 3784.70S | 576.95W | ==> | 3810.08 | 40.18724930 | -105.04410491 |
| 11917.00 | 90.00 | 179.84 | 7130.00 | 3884.70S | 576.66W | ==> | 3909.93 | 40.18697480 | -105.04410574 |
| 12017.00 | 90.00 | 179.84 | 7130.00 | 3984.70S | 576.38W | ==> | 4009.77 | 40.18670030 | -105.04410656 |
| 12117.00 | 90.00 | 179.84 | 7130.00 | 4084.70S | 576.10W | ==> | 4109.61 | 40.18642580 | -105.04410739 |
| 12217.00 | 90.00 | 179.84 | 7130.00 | 4184.70S | 575.81W | ==> | 4209.45 | 40.18615130 | -105.04410822 |
| 12317.00 | 90.00 | 179.84 | 7130.00 | 4284.70S | 575.53W | ==> | 4309.29 | 40.18587680 | -105.04410904 |
| 12417.00 | 90.00 | 179.84 | 7130.00 | 4384.70S | 575.25W | ==> | 4409.14 | 40.18560230 | -105.04410987 |
| 12517.00 | 90.00 | 179.84 | 7130.00 | 4484.70S | 574.96W | ==> | 4508.98 | 40.18532780 | -105.04411070 |
| 12617.00 | 90.00 | 179.84 | 7130.00 | 4584.70S | 574.68W | ==> | 4608.82 | 40.18505330 | -105.04411152 |
| 12717.00 | 90.00 | 179.84 | 7130.00 | 4684.70S | 574.40W | ==> | 4708.66 | 40.18477880 | -105.04411235 |
| 12817.00 | 90.00 | 179.84 | 7130.00 | 4784.70S | 574.11W | ==> | 4808.51 | 40.18450430 | -105.04411318 |
| 12917.00 | 90.00 | 179.84 | 7130.00 | 4884.70S | 573.83W | ==> | 4908.35 | 40.18422980 | -105.04411400 |
| 13017.00 | 90.00 | 179.84 | 7130.00 | 4984.70S | 573.55W | ==> | 5008.19 | 40.18395530 | -105.04411483 |
| 13117.00 | 90.00 | 179.84 | 7130.00 | 5084.70S | 573.26W | ==> | 5108.03 | 40.18368080 | -105.04411565 |
| 13217.00 | 90.00 | 179.84 | 7130.00 | 5184.70S | 572.98W | ==> | 5207.88 | 40.18340630 | -105.04411648 |
| 13317.00 | 90.00 | 179.84 | 7130.00 | 5284.70S | 572.70W | ==> | 5307.72 | 40.18313181 | -105.04411731 |
| 13417.00 | 90.00 | 179.84 | 7130.00 | 5384.70S | 572.42W | ==> | 5407.56 | 40.18285731 | -105.04411813 |
| 13517.00 | 90.00 | 179.84 | 7130.00 | 5484.70S | 572.13W | ==> | 5507.40 | 40.18258281 | -105.04411896 |
| 13617.00 | 90.00 | 179.84 | 7130.00 | 5584.70S | 571.85W | ==> | 5607.24 | 40.18230831 | -105.04411979 |
| 13717.00 | 90.00 | 179.84 | 7130.00 | 5684.70S | 571.57W | ==> | 5707.09 | 40.18203381 | -105.04412061 |
| 13817.00 | 90.00 | 179.84 | 7130.00 | 5784.70S | 571.28W | ==> | 5806.93 | 40.18175931 | -105.04412144 |
| 13917.00 | 90.00 | 179.84 | 7130.00 | 5884.70S | 571.00W | ==> | 5906.77 | 40.18148481 | -105.04412227 |
| 14017.00 | 90.00 | 179.84 | 7130.00 | 5984.70S | 570.72W | ==> | 6006.61 | 40.18121031 | -105.04412309 |
| 14117.00 | 90.00 | 179.84 | 7130.00 | 6084.69S | 570.43W | ==> | 6106.46 | 40.18093581 | -105.04412392 |
| 14217.00 | 90.00 | 179.84 | 7130.00 | 6184.69S | 570.15W | ==> | 6206.30 | 40.18066131 | -105.04412475 |
| 14317.00 | 90.00 | 179.84 | 7130.00 | 6284.69S | 569.87W | ==> | 6306.14 | 40.18038681 | -105.04412557 |

All data is in Feet unless otherwise stated
Coordinates are from Slot MD's are from Rig and TVD's are from Rig (Planned Datum #1 5010.0ft above Mean Sea Level)
Vertical Section is from 0.00N 0.00E on azimuth 183.06 degrees
Bottom hole distance is 10465.99 Feet on azimuth 183.06 degrees from Wellhead
Calculation method uses Minimum Curvature method
Prepared by
Date Printed: 14-Jul-2020

SYSDRILL
Well Design Combined Report
Wellbore: W KNIGHT 10 (PWB)



| Interpolated Wellpath | | | | | | | | | |
|-----------------------|----------|----------|---------|-----------|----------|-----------------------|-------------------------|-----------------------------------|------------------------------------|
| MD[ft] | Inc[deg] | Azi[deg] | TVD[ft] | North[ft] | East[ft] | Dogleg [deg/100ft] | Vertical Section[ft] | Station Position (Latitude) | Station Position (Longitude) |
| 14417.00 | 90.00 | 179.84 | 7130.00 | 6384.69S | 569.58W | ==> | 6405.98 | 40.18011231 | -105.04412640 |
| 14517.00 | 90.00 | 179.84 | 7130.00 | 6484.69S | 569.30W | ==> | 6505.82 | 40.17983781 | -105.04412723 |
| 14617.00 | 90.00 | 179.84 | 7130.00 | 6584.69S | 569.02W | ==> | 6605.67 | 40.17956331 | -105.04412805 |
| 14717.00 | 90.00 | 179.84 | 7130.00 | 6684.69S | 568.73W | ==> | 6705.51 | 40.17928881 | -105.04412888 |
| 14817.00 | 90.00 | 179.84 | 7130.00 | 6784.69S | 568.45W | ==> | 6805.35 | 40.17901431 | -105.04412970 |
| 14917.00 | 90.00 | 179.84 | 7130.00 | 6884.69S | 568.17W | ==> | 6905.19 | 40.17873981 | -105.04413053 |
| 15017.00 | 90.00 | 179.84 | 7130.00 | 6984.69S | 567.88W | ==> | 7005.04 | 40.17846531 | -105.04413136 |
| 15117.00 | 90.00 | 179.84 | 7130.00 | 7084.69S | 567.60W | ==> | 7104.88 | 40.17819081 | -105.04413218 |
| 15217.00 | 90.00 | 179.84 | 7130.00 | 7184.69S | 567.32W | ==> | 7204.72 | 40.17791631 | -105.04413301 |
| 15317.00 | 90.00 | 179.84 | 7130.00 | 7284.69S | 567.03W | ==> | 7304.56 | 40.17764181 | -105.04413384 |
| 15417.00 | 90.00 | 179.84 | 7130.00 | 7384.69S | 566.75W | ==> | 7404.40 | 40.17736731 | -105.04413466 |
| 15517.00 | 90.00 | 179.84 | 7130.00 | 7484.69S | 566.47W | ==> | 7504.25 | 40.17709281 | -105.04413549 |
| 15617.00 | 90.00 | 179.84 | 7130.00 | 7584.69S | 566.19W | ==> | 7604.09 | 40.17681831 | -105.04413632 |
| 15717.00 | 90.00 | 179.84 | 7130.00 | 7684.69S | 565.90W | ==> | 7703.93 | 40.17654382 | -105.04413714 |
| 15817.00 | 90.00 | 179.84 | 7130.00 | 7784.69S | 565.62W | ==> | 7803.77 | 40.17626932 | -105.04413797 |
| 15917.00 | 90.00 | 179.84 | 7130.00 | 7884.69S | 565.34W | ==> | 7903.62 | 40.17599482 | -105.04413879 |
| 16017.00 | 90.00 | 179.84 | 7130.00 | 7984.69S | 565.05W | ==> | 8003.46 | 40.17572032 | -105.04413962 |
| 16117.00 | 90.00 | 179.84 | 7130.00 | 8084.69S | 564.77W | ==> | 8103.30 | 40.17544582 | -105.04414045 |
| 16217.00 | 90.00 | 179.84 | 7130.00 | 8184.69S | 564.49W | ==> | 8203.14 | 40.17517132 | -105.04414127 |
| 16317.00 | 90.00 | 179.84 | 7130.00 | 8284.69S | 564.20W | ==> | 8302.98 | 40.17489682 | -105.04414210 |
| 16417.00 | 90.00 | 179.84 | 7130.00 | 8384.69S | 563.92W | ==> | 8402.83 | 40.17462232 | -105.04414293 |
| 16517.00 | 90.00 | 179.84 | 7130.00 | 8484.69S | 563.64W | ==> | 8502.67 | 40.17434782 | -105.04414375 |
| 16617.00 | 90.00 | 179.84 | 7130.00 | 8584.68S | 563.35W | ==> | 8602.51 | 40.17407332 | -105.04414458 |
| 16717.00 | 90.00 | 179.84 | 7130.00 | 8684.68S | 563.07W | ==> | 8702.35 | 40.17379882 | -105.04414541 |
| 16817.00 | 90.00 | 179.84 | 7130.00 | 8784.68S | 562.79W | ==> | 8802.20 | 40.17352432 | -105.04414623 |
| 16917.00 | 90.00 | 179.84 | 7130.00 | 8884.68S | 562.50W | ==> | 8902.04 | 40.17324982 | -105.04414706 |
| 17017.00 | 90.00 | 179.84 | 7130.00 | 8984.68S | 562.22W | ==> | 9001.88 | 40.17297532 | -105.04414788 |
| 17117.00 | 90.00 | 179.84 | 7130.00 | 9084.68S | 561.94W | ==> | 9101.72 | 40.17270082 | -105.04414871 |
| 17217.00 | 90.00 | 179.84 | 7130.00 | 9184.68S | 561.65W | ==> | 9201.56 | 40.17242632 | -105.04414954 |
| 17317.00 | 90.00 | 179.84 | 7130.00 | 9284.68S | 561.37W | ==> | 9301.41 | 40.17215182 | -105.04415036 |
| 17417.00 | 90.00 | 179.84 | 7130.00 | 9384.68S | 561.09W | ==> | 9401.25 | 40.17187732 | -105.04415119 |
| 17517.00 | 90.00 | 179.84 | 7130.00 | 9484.68S | 560.81W | ==> | 9501.09 | 40.17160282 | -105.04415202 |
| 17617.00 | 90.00 | 179.84 | 7130.00 | 9584.68S | 560.52W | ==> | 9600.93 | 40.17132832 | -105.04415284 |
| 17717.00 | 90.00 | 179.84 | 7130.00 | 9684.68S | 560.24W | ==> | 9700.78 | 40.17105382 | -105.04415367 |
| 17817.00 | 90.00 | 179.84 | 7130.00 | 9784.68S | 559.96W | ==> | 9800.62 | 40.17077932 | -105.04415449 |
| 17917.00 | 90.00 | 179.84 | 7130.00 | 9884.68S | 559.67W | ==> | 9900.46 | 40.17050482 | -105.04415532 |
| 18017.00 | 90.00 | 179.84 | 7130.00 | 9984.68S | 559.39W | ==> | 10000.30 | 40.17023032 | -105.04415615 |
| 18117.00 | 90.00 | 179.84 | 7130.00 | 10084.68S | 559.11W | ==> | 10100.14 | 40.16995582 | -105.04415697 |
| 18217.00 | 90.00 | 179.84 | 7130.00 | 10184.68S | 558.82W | ==> | 10199.99 | 40.16968132 | -105.04415780 |
| 18317.00 | 90.00 | 179.84 | 7130.00 | 10284.68S | 558.54W | ==> | 10299.83 | 40.16940682 | -105.04415863 |
| 18417.00 | 90.00 | 179.84 | 7130.00 | 10384.68S | 558.26W | ==> | 10399.67 | 40.16913232 | -105.04415945 |
| 18483.42 | 90.00 | 179.84 | 7130.00 | 10451.10S | 558.07W | ==> | 10465.99 | 40.16895000 | -105.04416000 |

All data is in Feet unless otherwise stated
Coordinates are from Slot MD's are from Rig and TVD's are from Rig (Planned Datum #1 5010.0ft above Mean Sea Level)
Vertical Section is from 0.00N 0.00E on azimuth 183.06 degrees
Bottom hole distance is 10465.99 Feet on azimuth 183.06 degrees from Wellhead
Calculation method uses Minimum Curvature method
Prepared by
Date Printed: 14-Jul-2020



All data is in Feet unless otherwise stated
 Coordinates are from Slot MD's are from Rig and TVD's are from Rig (Planned Datum #1 5010.0ft above Mean Sea Level)
 Vertical Section is from 0.00N 0.00E on azimuth 183.06 degrees
 Bottom hole distance is 10465.99 Feet on azimuth 183.06 degrees from Wellhead
 Calculation method uses Minimum Curvature method
 Prepared by
 Date Printed: 14-Jul-2020