

LEGEND:

 **PROPOSED LOCATION**



BISON OIL & GAS II

ROSS 8-60 18 PAD
SE 1/4 SW 1/4 & SW 1/4 SE 1/4,
SECTION 18, T8N, R60W, 6th P.M.
WELD COUNTY, COLORADO

SURVEYED BY	C.M., O.R.	02-25-20	SCALE
DRAWN BY	J.J.	05-07-20	1 : 100,000
ACCESS ROAD MAP			TOPO A



UELS, LLC
 Corporate Office * 85 South 200 East
 Vernal, UT 84078 * (435) 789-1017

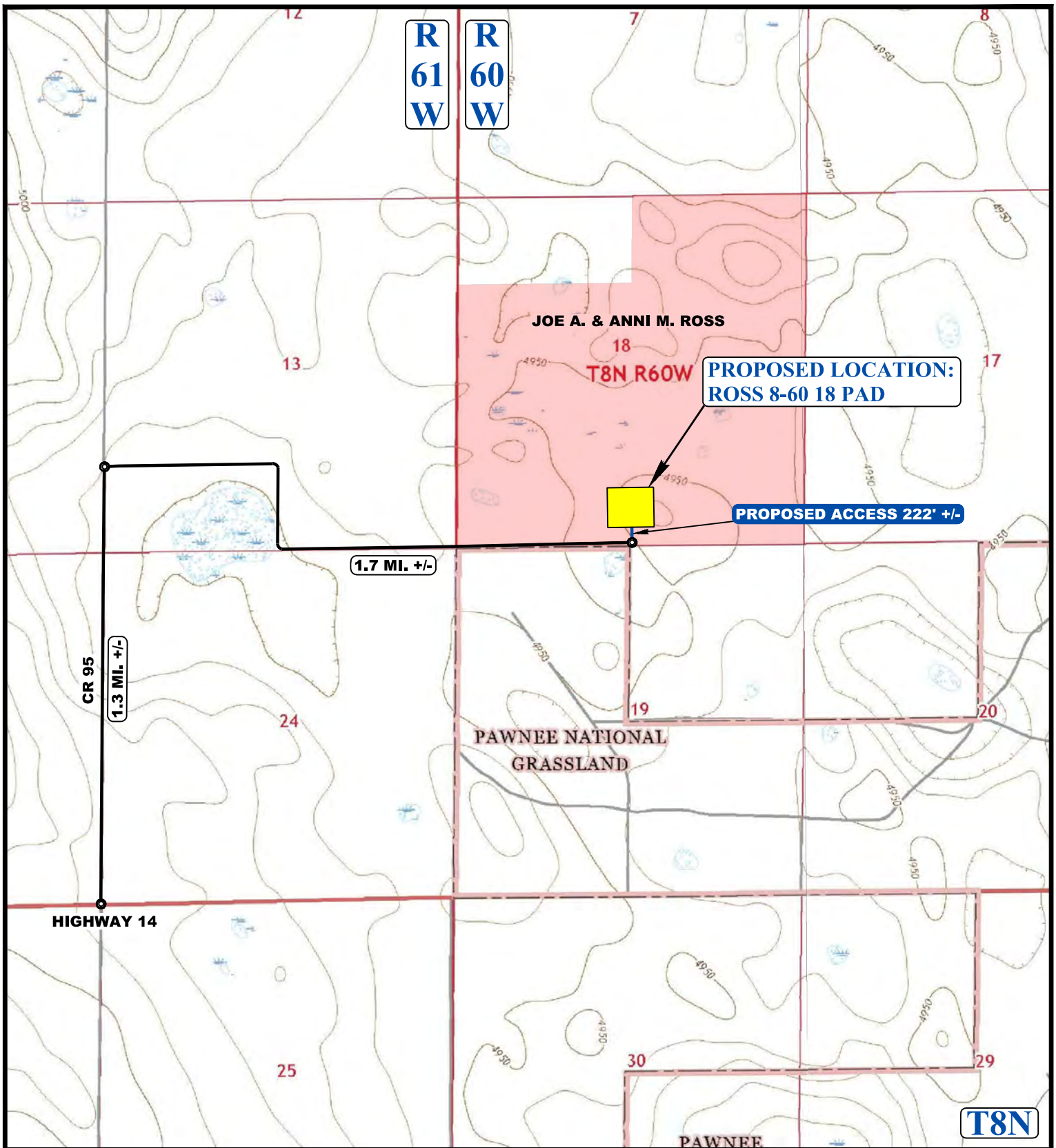

NOTE: PARCEL DATA SHOWN HAS BEEN OBTAINED FROM VARIOUS SOURCES AND SHOULD BE USED FOR MAPPING, GRAPHIC AND PLANNING PURPOSES ONLY. NO WARRANTY IS MADE BY UINTAH ENGINEERING AND LAND SURVEYING (UELS) FOR ACCURACY OF THE PARCEL DATA.

LEGEND:

— EXISTING ROAD
 - - - PROPOSED ROAD



BISON OIL & GAS II

ROSS 8-60 18 PAD
 SE 1/4 SW 1/4 & SW 1/4 SE 1/4,
 SECTION 18, T8N, R60W, 6th P.M.
 WELD COUNTY, COLORADO

SURVEYED BY	C.M., O.R.	02-25-20	SCALE
DRAWN BY	J.J.	05-07-20	1 : 24,000
ACCESS ROAD MAP			TOPO B



UELS, LLC
 Corporate Office * 85 South 200 East
 Vernal, UT 84078 * (435) 789-1017