

Great Western Operating Company, LLC

Created by	mmount
Date plotted	21-Apr-2020
Plot reference is Seltzer LD 09-371HN (AWB).	
Ref wellpath is Seltzer LD 09-371HN (AWP#1).	
Coordinates are in Feet reference Slot W15 - Seltzer LD 09-371HN.	
True Vertical Depths are reference Rg Datum.	
Measured Depths are reference Rg Datum.	
Rg Datum: Actual Datum #1	
Rg Datum to Mean Sea Level: 5146.00 ft.	
Plot North is aligned to TRUE North.	

Location	Colorado	Slot	Slot W15 - Seltzer LD 09-371HN
Field	Wattenburg	Well	Seltzer LD 09-371HN
Installation	Seltzer	Wellbore	Seltzer LD 09-371HN (AWB)

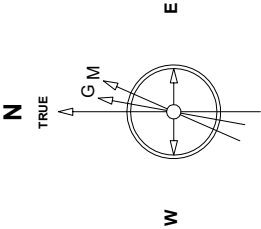

Jun-17-2017  
IGRF-12 Dat: 66.52 deg Field: 62215.1 n T  
Lat: N19 59 58 7262 Long: W104 53 32 3592 Elev: 5140.00 ft  
Magnetic North is 8.29 deg East of TRUE North.  
To correct azimuth from Magnetic to TRUE add 8.29 deg

East (Feet) ->

Scale 1 cm = 25 ft

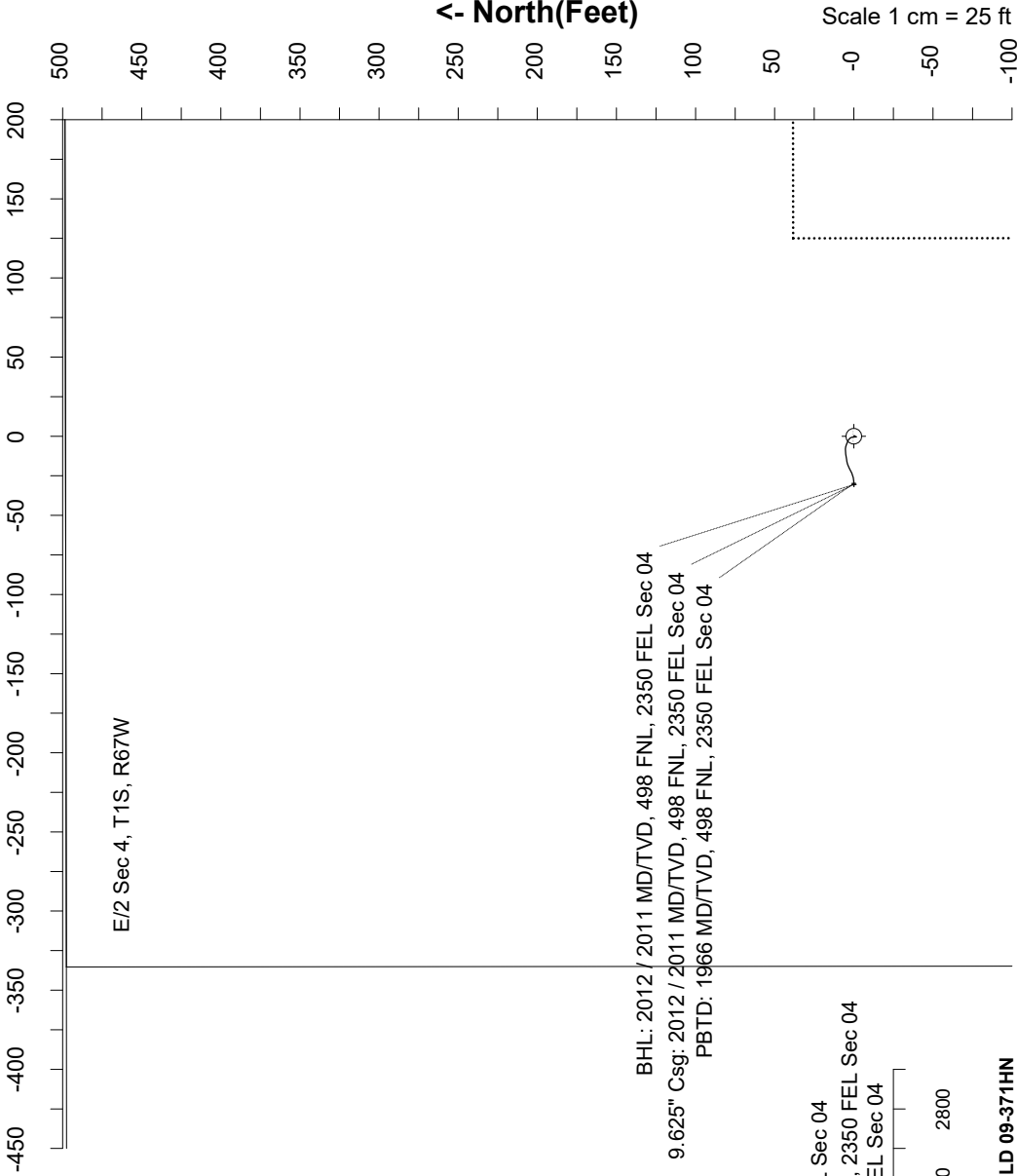

True Vertical Depth (Feet)

Scale 1 cm = 200 ft

Vertical Section (Feet) ->

Scale 1 cm = 200 ft

Azimuth 269.86 with reference 0.00 N, 0.00 E from Slot W15 - Seltzer LD 09-371HN

Great Western Operating Co, LLC  
 Directional Survey Report  
 Wellpath: Seltzer LD 09-371HN  
 MDs and TVDs are from Rig Floor 5146.0ft above Mean Sea Level

MD[ft]	Inc[deg]	Azi[deg]	TVD[ft]	North[ft]	East[ft]	DLS [deg/100ft]	Vertical Section[ft]
0.00	0.00	0.00	0.00	0.00	0.00		0.00
84.00	0.28	117.28	84.00	-0.09	0.18	0.33	-0.18
172.00	0.03	159.13	172.00	-0.21	0.38	0.29	-0.38
261.00	0.32	202.71	261.00	-0.47	0.29	0.34	-0.29
354.00	0.24	277.85	354.00	-0.68	0.00	0.37	0.00
443.00	0.44	221.06	443.00	-0.91	-0.41	0.41	0.41
533.00	0.46	151.73	532.99	-1.49	-0.46	0.57	0.47
623.00	0.31	346.94	622.99	-1.57	-0.35	0.85	0.35
713.00	0.42	354.66	712.99	-1.00	-0.43	0.13	0.44
803.00	0.86	356.28	802.99	0.00	-0.51	0.49	0.51
893.00	0.77	347.75	892.98	1.26	-0.68	0.17	0.68
983.00	1.11	321.84	982.96	2.54	-1.35	0.60	1.34
1073.00	1.33	294.31	1072.95	3.65	-2.84	0.69	2.83
1163.00	1.93	293.23	1162.91	4.68	-5.18	0.67	5.17
1253.00	1.97	273.22	1252.86	5.37	-8.12	0.75	8.11
1343.00	2.08	258.22	1342.80	5.12	-11.26	0.60	11.25
1433.00	2.55	264.01	1432.73	4.58	-14.85	0.58	14.84
1523.00	2.40	248.54	1522.65	3.68	-18.60	0.76	18.59
1612.00	2.17	237.29	1611.57	2.09	-21.75	0.57	21.74
1702.00	1.70	257.35	1701.52	0.87	-24.49	0.91	24.48
1792.00	1.37	253.81	1791.49	0.28	-26.82	0.38	26.82
1882.00	0.91	270.90	1881.47	-0.01	-28.57	0.63	28.57
1957.00	0.79	266.53	1956.47	-0.03	-29.68	0.18	29.68
2012.00	0.79	266.53	2011.46	-0.07	-30.44	0.00	30.44