

Great Western Operating Company, LLC

Created by: mmount Date plotted: 21-Apr-2020	
Plot reference is Seltzer LD 09-378HN (AWB).	
Ref wellpath is Seltzer LD 09-378HN (AW/P#1).	
Coordinates are in Feet reference Slot W06 - Seltzer LD 09-378HN.	
True Vertical Depths are reference Rg Datum.	
Measured Depths are reference Rg Datum.	
Rg Datum: Actual Datum #1	
Rg Datum to Mean Sea Level: 5146.00 ft.	
Plot North is aligned to TRUE North.	

Location	Colorado	Slot	Slot W06 - Seltzer LD 09-378HN
Field	Wattenburg	Well	Seltzer LD 09-378HN
Installation	Seltzer	Wellbore	Seltzer LD 09-378HN (AWB)

Scale 1 cm = 25 ft

East (Feet) ->

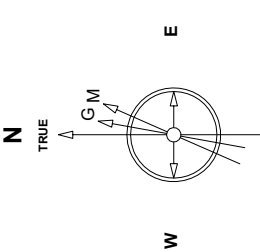
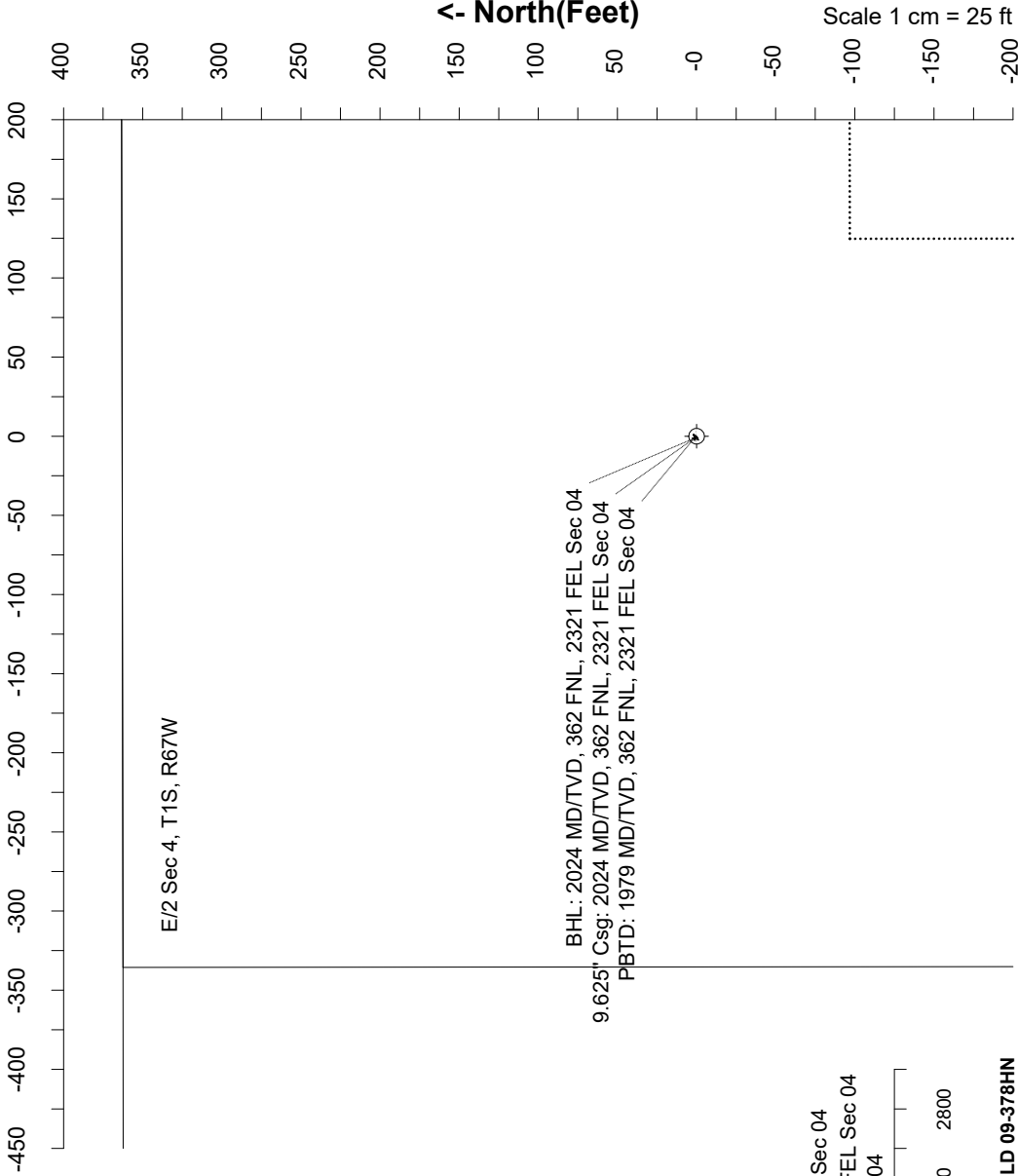

Jun-17-2017  
IGRF-12 Dat: 66.52 deg Field: 62215.1 nT  
Lat: N39 59 58 7262 Long: W104 53 32 3592 Elev: 5140.00 ft  
Magnetic North is 8.29 deg East of TRUE North.  
To correct azimuth from Magnetic to TRUE add 8.29 deg

Scale 1 cm = 200 ft

<- True Vertical Depth (Feet)

PBD: 1979 MD/TVD, 362 FNL, 2321 FEL Sec 04  
9.625" Csg: 2024 MD/TVD, 362 FNL, 2321 FEL Sec 04  
BHL: 2024 MD/TVD, 362 FNL, 2321 FEL Sec 04

Scale 1 cm = 200 ft

Vertical Section (Feet) ->

Azimuth 315.35 with reference 0.00 N, 0.00 E from Slot W06 - Seltzer LD 09-378HN

Great Western Operating Co, LLC  
 Directional Survey Report  
 Wellpath: Seltzer LD 09-378HN  
 MDs and TVDs are from Rig Floor 5146.0ft above Mean Sea Level

MD[ft]	Inc[deg]	Azi[deg]	TVD[ft]	North[ft]	East[ft]	DLS [deg/100ft]	Vertical Section[ft]
0.00	0.00	0.00	0.00	0.00	0.00		0.00
84.00	0.24	65.87	84.00	0.07	0.16	0.29	-0.06
172.00	0.36	2.33	172.00	0.42	0.34	0.38	0.06
261.00	0.52	15.07	261.00	1.09	0.46	0.21	0.46
354.00	0.03	100.07	353.99	1.50	0.59	0.56	0.65
443.00	0.44	89.15	442.99	1.50	0.95	0.46	0.39
533.00	0.54	353.20	532.99	1.92	1.25	0.81	0.49
623.00	0.50	234.11	622.99	2.11	0.88	1.00	0.88
713.00	0.50	249.56	712.99	1.75	0.20	0.15	1.11
803.00	0.55	218.13	802.98	1.27	-0.44	0.32	1.21
893.00	0.27	170.09	892.98	0.72	-0.67	0.47	0.98
983.00	0.55	167.42	982.98	0.09	-0.54	0.31	0.44
1073.00	0.35	221.67	1072.98	-0.54	-0.63	0.50	0.06
1163.00	0.29	244.90	1162.97	-0.84	-1.02	0.16	0.12
1253.00	0.57	270.67	1252.97	-0.93	-1.67	0.37	0.51
1343.00	0.34	245.99	1342.97	-1.03	-2.36	0.33	0.93
1433.00	0.24	95.32	1432.97	-1.16	-2.42	0.62	0.87
1523.00	0.12	51.76	1522.97	-1.12	-2.16	0.19	0.72
1612.00	0.51	1.98	1611.97	-0.66	-2.07	0.50	0.98
1702.00	0.60	22.77	1701.96	0.17	-1.87	0.24	1.44
1792.00	0.30	358.27	1791.96	0.84	-1.70	0.39	1.79
1882.00	0.44	58.51	1881.96	1.26	-1.41	0.43	1.88
1969.00	0.12	218.11	1968.96	1.36	-1.18	0.64	1.80
2024.00	0.12	218.11	2023.96	1.27	-1.25	0.00	1.78