

Great Western Operating Company, LLC

Created by	mmount
Date plotted	21-Apr-2020
Plot reference is Seltzer LD 09-379HC (AWB).	
Ref wellpath is Seltzer LD 09-379HC (AWP#1).	
Coordinates are in Feet reference Slot W04 - Seltzer LD 09-379HC.	
True Vertical Depths are reference Rg Datum.	
Measured Depths are reference Rg Datum.	
Rg Datum: Actual Datum #1	
Rg Datum to Mean Sea Level: 5146.00 ft.	
Plot North is aligned to TRUE North.	

Location	Colorado	Slot	Slot W04 - Seltzer LD 09-379HC
Field	Wattenburg	Well	Seltzer LD 09-379HC
Installation	Seltzer	Wellbore	Seltzer LD 09-379HC (AWB)

Scale 1 cm = 25 ft

East (Feet) ->

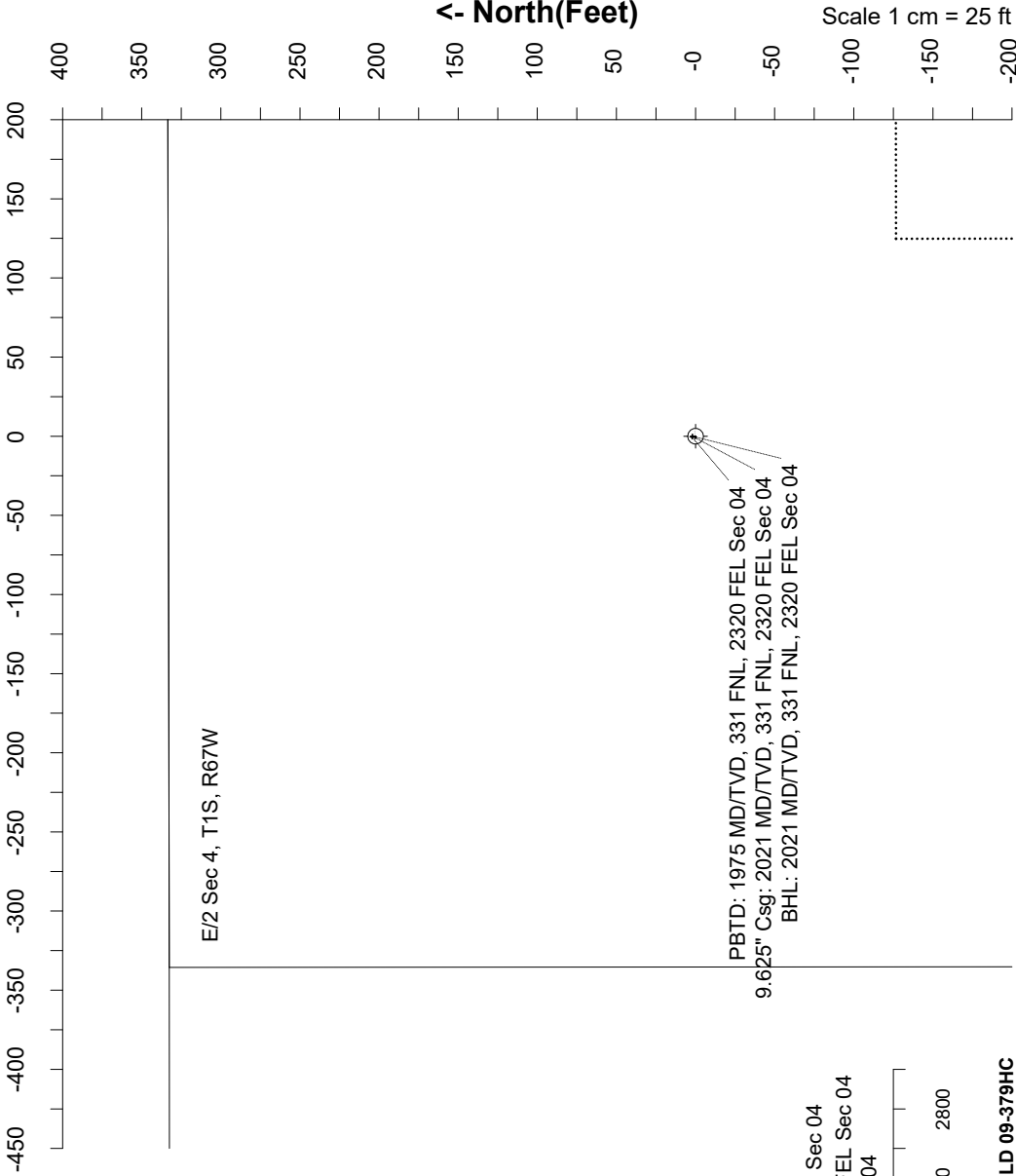

Jun-17-2017  
IGRF-12 Dir: 66.52 deg Field: 62215.1 nT  
Lat: N39 59 58 7262 Long: W104 53 32 3592 Elev: 5140.00 ft  
Magnetic North is 8.29 deg East of TRUE North.  
To correct azimuth from Magnetic to TRUE add 8.29 deg

<- True Vertical Depth (Feet)

<- North(Feet)

Scale 1 cm = 25 ft

PBTD: 1975 MD/TVD, 331 FNL, 2320 FEL Sec 04  
9.625" Csg: 2021 MD/TVD, 331 FNL, 2320 FEL Sec 04  
BHL: 2021 MD/TVD, 331 FNL, 2320 FEL Sec 04

Vertical Section (Feet) ->

Scale 1 cm = 200 ft

Azimuth 359.20 with reference 0.00 N, 0.00 E from Slot W04 - Seltzer LD 09-379HC

Great Western Operating Co, LLC  
Directional Survey Report  
Wellpath: Seltzer LD 09-379HC  
MDs and TVDs are from Rig Floor 5146.0ft above Mean Sea Level

MD[ft]	Inc[deg]	Azi[deg]	TVD[ft]	North[ft]	East[ft]	DLS [deg/100ft]	Vertical Section[ft]
0.00	0.00	0.00	0.00	0.00	0.00		0.00
84.00	0.07	311.47	84.00	0.03	-0.04	0.08	0.03
172.00	0.68	322.82	172.00	0.49	-0.39	0.69	0.49
261.00	0.44	156.34	261.00	0.59	-0.58	1.25	0.60
354.00	0.07	208.74	354.00	0.22	-0.46	0.43	0.22
443.00	0.54	176.66	442.99	-0.25	-0.46	0.54	-0.24
533.00	0.43	322.91	532.99	-0.40	-0.64	1.03	-0.39
623.00	0.40	288.56	622.99	-0.03	-1.14	0.27	-0.02
713.00	0.15	272.58	712.99	0.07	-1.56	0.29	0.09
803.00	0.27	48.43	802.99	0.22	-1.52	0.44	0.24
893.00	0.03	95.80	892.99	0.36	-1.33	0.28	0.37
983.00	0.38	133.95	982.99	0.15	-1.10	0.40	0.16
1073.00	0.12	177.25	1072.99	-0.16	-0.88	0.34	-0.14
1163.00	0.03	329.26	1162.99	-0.23	-0.88	0.16	-0.22
1253.00	0.18	168.72	1252.99	-0.35	-0.87	0.23	-0.34
1343.00	0.27	82.73	1342.99	-0.46	-0.63	0.35	-0.45
1433.00	0.24	41.63	1432.99	-0.29	-0.30	0.20	-0.29
1523.00	0.38	3.53	1522.98	0.15	-0.15	0.27	0.15
1612.00	0.56	349.48	1611.98	0.87	-0.21	0.24	0.87
1702.00	0.54	356.74	1701.98	1.72	-0.32	0.08	1.73
1792.00	0.23	305.25	1791.97	2.25	-0.49	0.48	2.26
1882.00	0.24	295.43	1881.97	2.44	-0.81	0.05	2.45
1966.00	0.64	120.00	1965.97	2.28	-0.56	1.05	2.29
2021.00	0.64	120.00	2020.97	1.97	-0.03	0.00	1.97