

Great Western Operating Company, LLC

Location	Colorado	Slot	N06 - Tollway LC 24-363HNX
Field	Wattenburg	Well	Tollway LC 24-363HNX
Installation	Tollway	Wellbore	Tollway LC 24-363HNX - Surface Hole

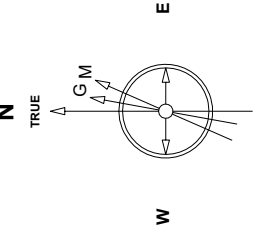

May 4, 2019
EMA-2015 Dir: 66.20 deg Field: 51928.4 nT
Lat: N39.58 40.3032 Long: W104.56 19.7304 Elev: 5155.00 ft
Magnetic North is 8.14 deg East of TRUE North
To correct azimuth from Magnetic to TRUE add 8.14 deg

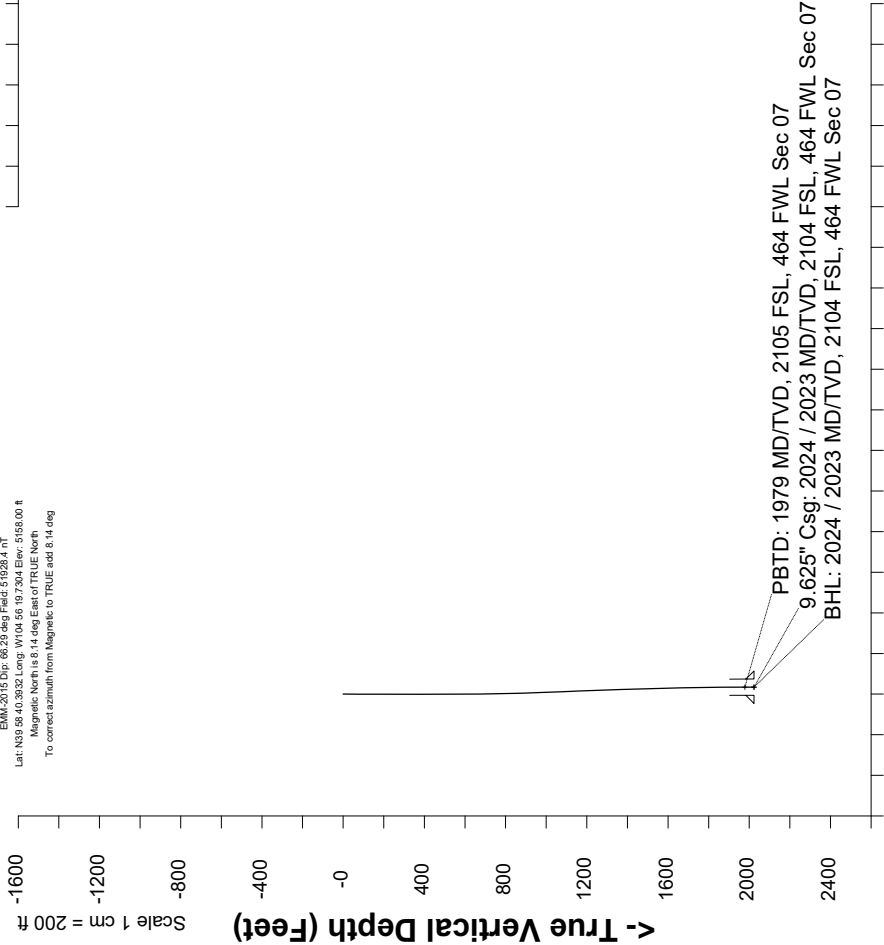

Scale 1 cm = 200 ft
Vertical Section (Feet) ->
Azimuth 205.16 with reference 0.00 N, 0.00 E from N06 - Tollway LC 24-363HNX

Scale 1 cm = 2 ft
East (Feet) ->

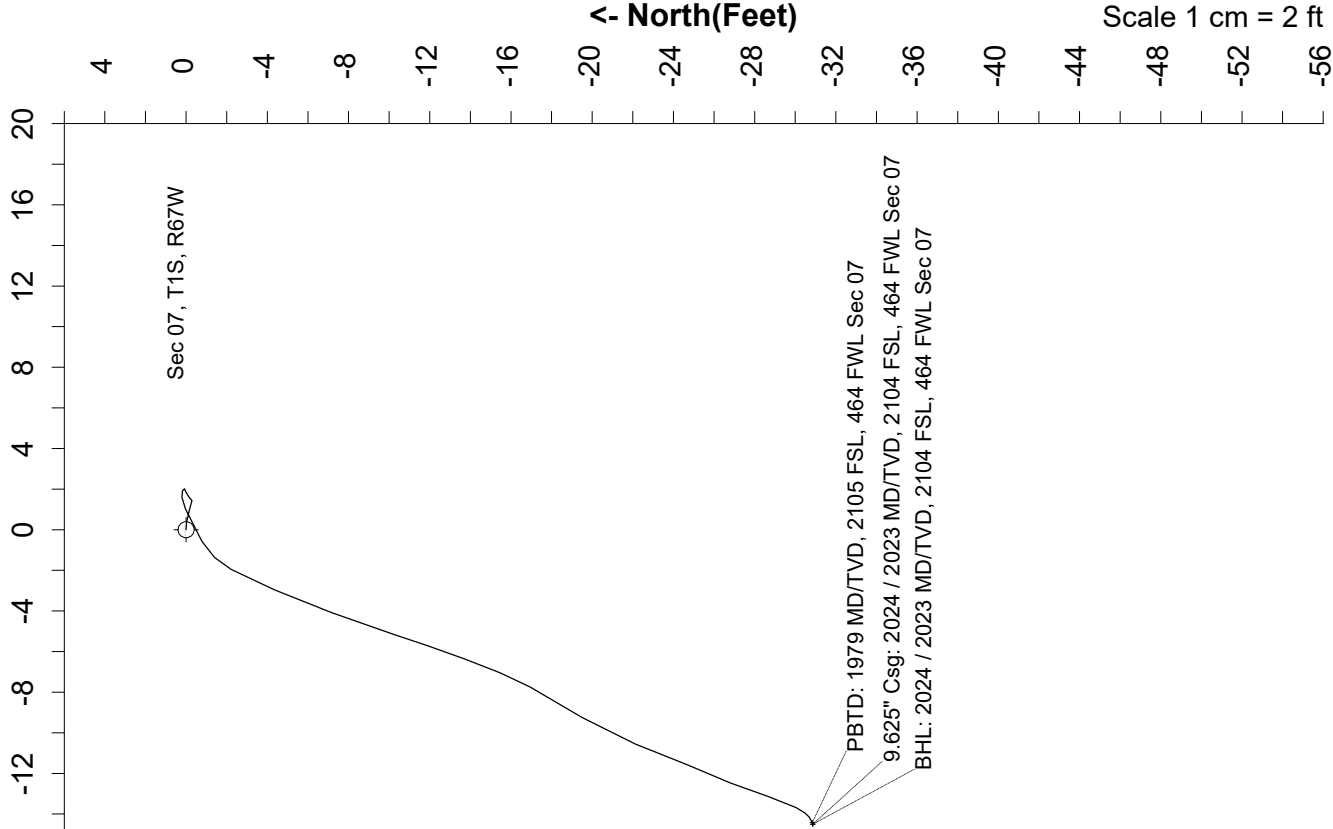

Scale 1 cm = 2 ft
<- North(Feet)

Header Information		measured depth (ft)	inclination (°)	azimuth (°)	true vertical depth (ft)	northing +N/-S (ft)	easting +E/-W (ft)
Operator Name		0	0.00	0.00	0	0.00	0.00
Great Western Oil & Gas Company LLC		84	0.50	93.86	84	-0.02	0.37
Operator Number		170	0.40	114.76	170	-0.18	1.01
10110		260	0.17	83.03	260	-0.29	1.43
Well Name and Number		353	0.20	21.39	353	-0.12	1.63
Tollway LC 24-363HNX		442	0.28	88.00	442	0.03	1.90
API Number (if available)		532	0.30	305.56	532	0.17	1.93
05-001-10447		622	0.97	248.34	622	0.03	1.03
Location: QQ SEC TWP RGE		712	1.32	239.43	712	-0.78	-0.57
NWSW Sec 7 1S 67W		802	1.31	208.34	802	-2.21	-1.95
Citing Type: Planned or Actual		892	1.70	202.90	892	-4.35	-2.96
Actual		982	2.15	200.69	982	-7.16	-4.08
Deviation Indicator		1072	2.06	197.99	1072	-10.27	-5.17
Horizontal ▼		1162	2.57	199.93	1162	-13.71	-6.36
North Reference		1252	1.93	207.62	1252	-16.95	-7.75
True ▼		1342	1.84	213.39	1342	-19.50	-9.25
Grid Type		1432	1.92	199.69	1432	-22.12	-10.55
▼		1522	1.58	204.41	1522	-24.67	-11.57
		1611	1.39	201.36	1610	-26.80	-12.47
		1701	1.12	197.49	1700	-28.65	-13.13
		1791	0.78	207.76	1790	-30.03	-13.68
		1881	0.28	237.88	1880	-30.69	-14.16
		1968	0.10	250.20	1967	-30.83	-14.41
		2024	0.10	250.20	2023	-30.86	-14.50