



# Kerr-McGee Oil & Gas Onshore LP

1099 18<sup>th</sup> Street  
Denver, CO 80202  
720-929-6000

June 9, 2020

Jeff Robbins  
Director, Colorado Oil and Gas Conservation Commission  
Department of Natural Resources – The Chancery Building  
1120 Lincoln Street, Suite 801  
Denver, CO 80203

Re: **30 Day Certification Letter - 318A.e**  
NELSON 35-15HZ (Doc No. 402385100)  
Township 2 North, Range 68 West  
Section 35: NENW  
Unit Acreage: 320 Acres  
Proposed Spacing Unit:  
02N68W SEC 23: SWNW, W2SW;  
02N68W SEC 26: W2W2;  
02N68W SEC 35: NWNW  
Weld County, Colorado

Dear Director Robbins:

Kerr-McGee Oil and Gas Onshore LP (“KMG”) hereby certifies that a thirty (30) day notice has been given by certified mail to all mineral owners in the proposed wellbore spacing unit. We have not received any objections to such well location, proposed spacing unit, or additional producing formation. KMG hereby respectfully requests approval of this boundary well.

If you have any questions or issues regarding this permit, please contact me at (720) 929-3167.

Sincerely,

**Kerr-McGee Oil and Gas Onshore LP**

A handwritten signature in black ink that reads 'Samantha Petite'.

Samantha Petite  
Regulatory Analyst

Enclosure

DISTANCE FROM COMPLETED  
PORTION OF WELLBORE TO  
NEAREST UNIT BOUNDARY= 584'

## NELSON 35-15HZ WELLBORE SPACING UNIT

**SURFACE LOCATION: NAD 83**  
GROUND ELEVATION= 4953.2'  
LATITUDE= 40.101355°  
LONGITUDE= -104.972602°  
LATITUDE= 40°06'04.879"  
LONGITUDE= -104°58'21.367"  
**HEEL LOCATION: NAD 83**  
LATITUDE= 40.102411°  
LONGITUDE= -104.977673°  
LATITUDE= 40°06'08.680"  
LONGITUDE= -104°58'39.623"  
**BOTTOM HOLE LOCATION: NAD 83**  
LATITUDE= 40.125115°  
LONGITUDE= -104.977691°  
LATITUDE= 40°07'30.414"  
LONGITUDE= -104°58'39.688"

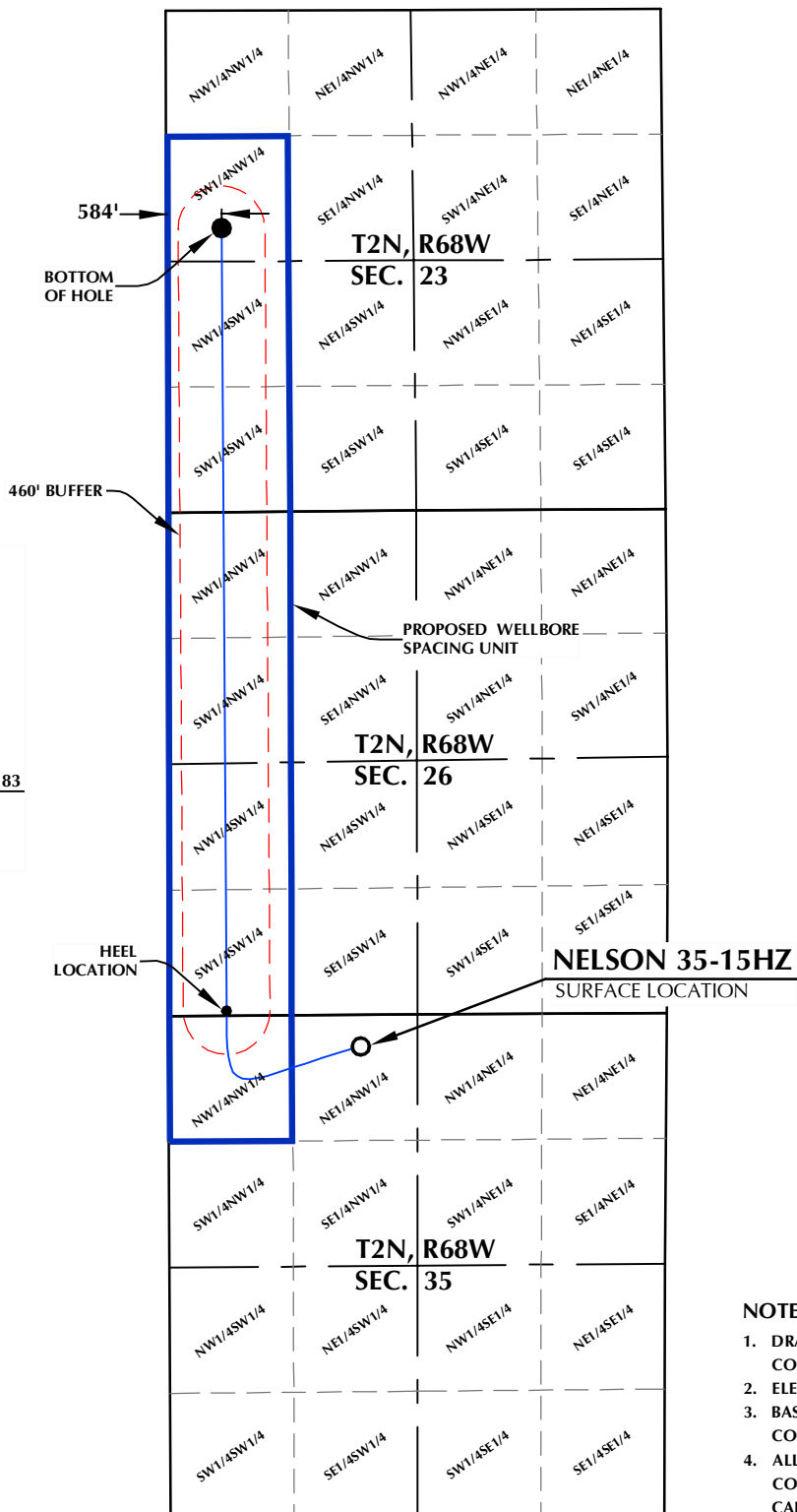
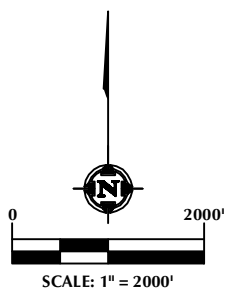

### NOTES:

1. DRAWING LATITUDE AND LONGITUDE COORDINATES ARE NAD 83 (2011)(EPOCH:2010).
2. ELEVATION BASED ON NAVD88 (GEOID12B).
3. BASIS OF BEARING DERIVED FROM COLORADO COORDINATE SYSTEM OF 1983 NORTH ZONE.
4. ALL MEASURED DISTANCES ARE GRID. COMBINED SCALE FACTOR: .99972700 CALCULATED FROM THE N. 1/4 CORNER OF SECTION 26, T2N, R68W.

### WELL PAD - NELSON 28-35HZ

NELSON 35-15HZ  
WELLBORE SPACING UNIT  
336' FNL & 2039' FWL NENW (SURFACE)  
LOCATED IN SECTION 35  
50' FSL & 620' FWL SWSW (HEEL)  
LOCATED IN SECTION 26  
2311' FNL & 584' FWL SWNW (BOTTOM)  
LOCATED IN SECTION 23  
T2N, R68W, 6TH P.M.  
WELD COUNTY, COLORADO

**Kerr-McGee Oil &  
Gas Onshore L.P.**  
1099 18th Street  
Denver, Colorado 80202



### CONSULTING, LLC

SHERIDAN OFFICE  
1095 Saberton Avenue  
Sheridan, Wyoming 82801  
Phone 307-674-0609

LOVELAND OFFICE  
6706 North Franklin Avenue  
Loveland, Colorado 80538  
Phone 970-776-4331

DRAFTED BY:	LMO	CHECKED BY:	RKF
DATE DRAFTED:	2/12/19	DATE SURVEYED:	12/9/19
REVISED:	1/10/2020	FILE NAME:	16-193