

# KERR-MCGEE OIL & GAS ONSHORE LP (WA)

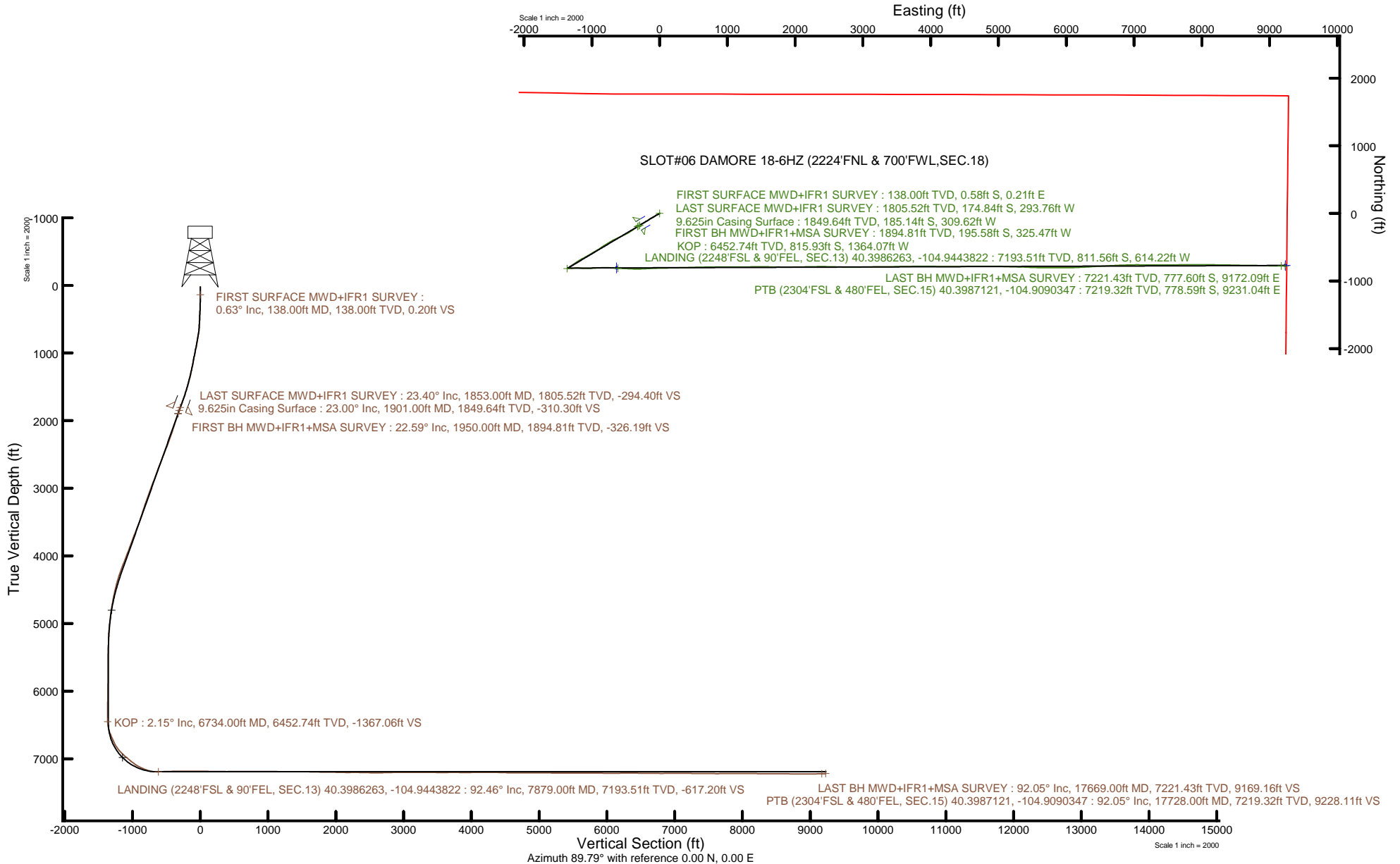

Location: COLORADO Slot: SLOT#06 DAMORE 18-6HZ (2224'FNL & 700'FWL,SEC.18)  
 Field: WELD COUNTY (UTM/TRUE NORTH) Well: DAMORE 18-6HZ  
 Facility: SEC.18-T5N-R67W Wellbore: DAMORE 18-6HZ PWB

Plot reference wellpath is DAMORE 18-6HZ PWP Rev-B.1	Grid System: NAD83 / UTM Zone 13 North, US feet
True vertical depths are referenced to PD564 (26) (RT)	North Reference: True north
Reference wellpath measured depths are referenced to PD564 (26) (RT)	Scale: True distance
PD564 (26) (RT) to Mean Sea Level: 4948 feet	Coordinates are in feet referenced to Slot
Mean Sea Level to Mud line (At Slot: SLOT#06 DAMORE 18-6HZ (2224'FNL & 700'FWL,SEC.18)): 0 feet	Depths are in feet
Offset wellpath MDs are referenced to each path's default MD datum	Created by: ragyos on 2020-04-08, Database: WellArchitectDB



REFERENCE WELLPATH IDENTIFICATION			
Operator	KERR-MCGEE OIL & GAS ONSHORE LP (WA)	Well	DAMORE 18-6HZ
Field	WELD COUNTY (UTM/TRUE NORTH)	API/Legal	
Facility	SEC.18-T5N-R67W	Wellbore	DAMORE 18-6HZ AWB
Slot	SLOT#06 DAMORE 18-6HZ (2224'FNL & 700'FWL,SEC.18)		

REPORT SETUP INFORMATION			
Projection System	NAD83 / UTM Zone 13 North, US feet	Software System	WellArchitect® 6.0
North Reference	True	User	Ragbyos
Scale	0.999600	Report Generated	4/8/2020 at 1:29:06 PM
Convergence at slot	0.04° East	Database	WellArchitectDB

WELLPATH LOCATION						
	Local coordinates		Grid coordinates		Geographic coordinates	
	North[ft]	East[ft]	Easting[US ft]	Northing[US ft]	Latitude	Longitude
Slot Location	-57.74	47.87	1656514.97	14672710.95	40.4008540°	-104.9421770°
Facility Reference Pt			1656467.07	14672768.64	40.4010125°	-104.9423489°
Field Reference Pt			1698235.31	14552047.82	40.0693333°	-104.7933333°

WELLPATH DATUM			
Calculation method	Minimum curvature	PD564 (26') (RT) to Facility Vertical Datum	4948.00ft
Horizontal Reference Pt	Slot	PD564 (26') (RT) to Mean Sea Level	4948.00ft
Vertical Reference Pt	PD564 (26') (RT)	PD564 (26') (RT) to Mud Line at Slot (SLOT#06 DAMORE 18-6HZ (2224'FNL & 700'FWL,SEC.18))	4948.00ft
MD Reference Pt	PD564 (26') (RT)	Section Origin	N 0.00, E 0.00 ft
Field Vertical Reference	Mean Sea Level	Section Azimuth	89.79°

REFERENCE WELLPATH IDENTIFICATION			
Operator	KERR-MCGEE OIL & GAS ONSHORE LP (WA)	Well	DAMORE 18-6HZ
Field	WELD COUNTY (UTM/TRUE NORTH)	API/Legal	
Facility	SEC.18-T5N-R67W	Wellbore	DAMORE 18-6HZ AWB
Slot	SLOT#06 DAMORE 18-6HZ (2224'FNL & 700'FWL, SEC.18)		

WELLPATH DATA (200 stations) † = interpolated, ‡ = extrapolated station												
MD [ft]	Inclination [°]	Azimuth [°]	TVD [ft]	Vert Sect [ft]	North [ft]	East [ft]	Grid East [US ft]	Grid North [US ft]	Latitude	Longitude	DLS [°/100ft]	Comments
0.00†	0.000	160.410	0.00	0.00	0.00	0.00	1656514.97	14672710.95	40.4008540	-104.9421770	0.00	
26.00	0.000	160.410	26.00	0.00	0.00	0.00	1656514.97	14672710.95	40.4008540	-104.9421770	0.00	
138.00	0.630	160.410	138.00	0.20	-0.58	0.21	1656515.17	14672710.37	40.4008524	-104.9421763	0.56	FIRST SURFACE MWD+IFR1 SURVEY
233.00	1.480	205.040	232.98	-0.15	-2.18	-0.14	1656514.83	14672708.76	40.4008480	-104.9421775	1.18	
328.00	2.940	223.890	327.91	-2.36	-5.05	-2.35	1656512.62	14672705.90	40.4008401	-104.9421854	1.70	
423.00	2.960	242.040	422.79	-6.23	-7.96	-6.20	1656508.77	14672702.99	40.4008322	-104.9421993	0.98	
518.00	2.740	247.960	517.67	-10.51	-9.96	-10.47	1656504.50	14672700.98	40.4008267	-104.9422146	0.39	
613.00	4.040	252.670	612.50	-15.82	-11.81	-15.77	1656499.21	14672699.13	40.4008216	-104.9422336	1.40	
708.00	8.180	248.170	706.94	-25.30	-15.32	-25.25	1656489.74	14672695.62	40.4008119	-104.9422676	4.38	
803.00	12.330	242.730	800.41	-40.62	-22.48	-40.54	1656474.46	14672688.45	40.4007923	-104.9423226	4.48	
899.00	12.960	234.980	894.08	-58.59	-33.36	-58.47	1656456.54	14672677.56	40.4007624	-104.9423869	1.88	
993.00	13.450	236.880	985.60	-76.43	-45.38	-76.26	1656438.77	14672665.53	40.4007294	-104.9424508	0.70	
1089.00	12.330	241.880	1079.18	-94.86	-56.31	-94.65	1656420.39	14672654.59	40.4006994	-104.9425168	1.65	
1184.00	12.400	241.480	1171.98	-112.80	-65.96	-112.56	1656402.50	14672644.94	40.4006729	-104.9425811	0.12	
1279.00	14.720	239.680	1264.32	-132.22	-76.93	-131.94	1656383.13	14672633.96	40.4006428	-104.9426507	2.48	
1373.00	15.620	235.230	1355.05	-152.98	-90.18	-152.65	1656362.44	14672620.71	40.4006065	-104.9427251	1.57	
1468.00	18.240	239.580	1445.93	-176.37	-105.00	-175.98	1656339.13	14672605.87	40.4005658	-104.9428088	3.06	
1562.00	18.650	238.900	1535.10	-201.98	-120.21	-201.54	1656313.59	14672590.65	40.4005240	-104.9429006	0.49	
1658.00	20.800	240.240	1625.46	-229.98	-136.60	-229.48	1656285.67	14672574.25	40.4004790	-104.9430009	2.29	
1753.00	22.990	239.880	1713.60	-260.74	-154.29	-260.17	1656255.00	14672556.55	40.4004305	-104.9431111	2.31	
1853.00	23.400	237.210	1805.52	-294.40	-174.84	-293.76	1656221.44	14672535.98	40.4003741	-104.9432317	1.13	LAST SURFACE MWD+IFR1 SURVEY
1950.00	22.590	236.400	1894.81	-326.19	-195.58	-325.47	1656189.76	14672515.23	40.4003171	-104.9433456	0.90	FIRST BH MWD+IFR1+MSA SURVEY
2040.00	21.690	234.810	1978.18	-354.25	-214.73	-353.46	1656161.79	14672496.07	40.4002646	-104.9434461	1.20	
2130.00	21.110	233.100	2061.97	-380.87	-234.05	-380.01	1656135.26	14672476.74	40.4002115	-104.9435414	0.95	
2219.00	21.780	236.270	2144.81	-407.49	-252.84	-406.56	1656108.73	14672457.94	40.4001600	-104.9436367	1.50	
2308.00	22.810	239.240	2227.16	-436.12	-270.84	-435.12	1656080.20	14672439.94	40.4001106	-104.9437393	1.71	
2398.00	22.610	238.610	2310.18	-465.94	-288.77	-464.88	1656050.46	14672421.99	40.4000613	-104.9438461	0.35	
2487.00	23.750	243.590	2392.01	-496.66	-305.65	-495.54	1656019.82	14672405.09	40.4000150	-104.9439562	2.55	
2576.00	23.750	243.730	2473.47	-528.85	-321.56	-527.66	1655987.72	14672389.17	40.3999713	-104.9440715	0.06	
2666.00	22.210	243.250	2556.32	-560.35	-337.24	-559.11	1655956.30	14672373.48	40.3999283	-104.9441844	1.72	
2755.00	23.780	245.270	2638.25	-591.72	-352.32	-590.43	1655925.00	14672358.39	40.3998869	-104.9442969	1.97	
2845.00	22.950	244.740	2720.87	-624.13	-367.39	-622.78	1655892.68	14672343.29	40.3998455	-104.9444130	0.95	
2934.00	21.660	244.570	2803.21	-654.71	-381.85	-653.31	1655862.17	14672328.82	40.3998058	-104.9445226	1.45	
3024.00	22.740	244.080	2886.54	-685.41	-396.59	-683.95	1655831.55	14672314.07	40.3997654	-104.9446326	1.22	
3113.00	23.890	238.760	2968.28	-716.36	-413.46	-714.84	1655800.69	14672297.19	40.3997191	-104.9447435	2.69	
3202.00	22.270	239.110	3050.15	-746.30	-431.46	-744.72	1655770.83	14672279.17	40.3996696	-104.9448508	1.83	
3292.00	22.570	237.710	3133.35	-775.61	-449.44	-773.96	1655741.62	14672261.18	40.3996203	-104.9449558	0.68	
3382.00	23.160	238.070	3216.28	-805.30	-468.03	-803.58	1655712.02	14672242.58	40.3995693	-104.9450621	0.67	
3471.00	20.850	237.780	3298.79	-833.62	-485.74	-831.83	1655683.78	14672224.86	40.3995207	-104.9451636	2.60	
3561.00	20.870	234.050	3382.89	-860.21	-503.69	-858.36	1655657.28	14672206.90	40.3994714	-104.9452588	1.48	
3650.00	21.740	237.120	3465.81	-886.96	-521.94	-885.04	1655630.62	14672188.63	40.3994213	-104.9453546	1.59	
3740.00	24.210	239.790	3548.67	-916.97	-540.28	-914.99	1655600.70	14672170.29	40.3993709	-104.9454621	2.98	
3829.00	24.480	240.030	3629.75	-948.79	-558.67	-946.74	1655568.98	14672151.88	40.3993204	-104.9455761	0.32	
3918.00	24.390	239.630	3710.78	-980.68	-577.18	-978.56	1655537.17	14672133.36	40.3992697	-104.9456904	0.21	
4008.00	23.640	238.860	3792.99	-1012.23	-595.90	-1010.04	1655505.72	14672114.62	40.3992182	-104.9458034	0.90	

REFERENCE WELLPATH IDENTIFICATION			
Operator	KERR-MCGEE OIL & GAS ONSHORE LP (WA)	Well	DAMORE 18-6HZ
Field	WELD COUNTY (UTM/TRUE NORTH)	API/Legal	
Facility	SEC.18-T5N-R67W	Wellbore	DAMORE 18-6HZ AWB
Slot	SLOT#06 DAMORE 18-6HZ (2224'FNL & 700'FWL, SEC.18)		

WELLPATH DATA (200 stations) † = interpolated, ‡ = extrapolated station												
MD [ft]	Inclination [°]	Azimuth [°]	TVD [ft]	Vert Sect [ft]	North [ft]	East [ft]	Grid East [US ft]	Grid North [US ft]	Latitude	Longitude	DLS ["/100ft]	Comments
4097.00	22.890	238.730	3874.75	-1042.36	-614.12	-1040.11	1655475.68	14672096.40	40.3991683	-104.9459113	0.84	
4187.00	22.830	240.140	3957.69	-1072.53	-631.89	-1070.21	1655445.60	14672078.61	40.3991195	-104.9460194	0.61	
4277.00	24.470	241.640	4040.12	-1104.14	-649.44	-1101.76	1655414.07	14672061.05	40.3990713	-104.9461327	1.94	
4366.00	23.010	241.300	4121.59	-1135.69	-666.55	-1133.24	1655382.62	14672043.92	40.3990243	-104.9462457	1.65	
4456.00	23.280	239.880	4204.35	-1166.56	-683.92	-1164.05	1655351.83	14672026.54	40.3989766	-104.9463563	0.69	
4545.00	21.820	239.000	4286.54	-1196.02	-701.27	-1193.44	1655322.46	14672009.18	40.3989290	-104.9464619	1.68	
4634.00	18.520	237.290	4370.07	-1222.16	-717.43	-1219.52	1655296.40	14671993.01	40.3988846	-104.9465555	3.77	
4724.00	16.610	235.590	4455.87	-1244.85	-732.43	-1242.16	1655273.78	14671978.00	40.3988435	-104.9466368	2.20	
4814.00	14.900	235.750	4542.49	-1265.08	-746.21	-1262.34	1655253.62	14671964.21	40.3988056	-104.9467092	1.90	
4903.00	13.760	234.860	4628.72	-1283.24	-758.74	-1280.46	1655235.52	14671951.67	40.3987712	-104.9467742	1.30	
4993.00	12.170	232.850	4716.42	-1299.60	-770.63	-1296.77	1655219.22	14671939.78	40.3987386	-104.9468328	1.84	
5082.00	10.020	231.170	4803.75	-1313.15	-781.15	-1310.28	1655205.72	14671929.25	40.3987097	-104.9468813	2.44	
5171.00	7.840	230.590	4891.67	-1323.91	-789.86	-1321.01	1655195.01	14671920.54	40.3986858	-104.9469198	2.45	
5261.00	6.380	239.600	4980.98	-1332.99	-796.29	-1330.06	1655185.96	14671914.11	40.3986682	-104.9469523	2.04	
5350.00	5.160	237.750	5069.53	-1340.65	-800.93	-1337.71	1655178.32	14671909.47	40.3986554	-104.9469798	1.39	
5465.00	3.850	234.290	5184.17	-1348.18	-805.94	-1345.22	1655170.81	14671904.45	40.3986417	-104.9470068	1.16	
5554.00	2.420	287.040	5273.05	-1352.41	-807.14	-1349.45	1655166.59	14671903.25	40.3986384	-104.9470219	3.44	
5644.00	2.320	298.980	5362.97	-1355.81	-805.70	-1352.86	1655163.18	14671904.69	40.3986423	-104.9470342	0.56	
5733.00	2.020	308.950	5451.91	-1358.60	-803.84	-1355.65	1655160.39	14671906.55	40.3986474	-104.9470442	0.54	
5822.00	0.480	185.270	5540.89	-1359.85	-803.22	-1356.91	1655159.13	14671907.16	40.3986491	-104.9470487	2.61	
5912.00	0.450	196.700	5630.89	-1359.99	-803.94	-1357.04	1655159.00	14671906.45	40.3986472	-104.9470492	0.11	
6001.00	0.560	215.330	5719.89	-1360.35	-804.63	-1357.39	1655158.64	14671905.76	40.3986453	-104.9470505	0.22	
6091.00	0.800	223.850	5809.88	-1361.04	-805.44	-1358.08	1655157.96	14671904.94	40.3986430	-104.9470529	0.29	
6180.00	0.750	228.670	5898.87	-1361.91	-806.27	-1358.95	1655157.09	14671904.11	40.3986408	-104.9470561	0.09	
6270.00	1.010	225.000	5988.86	-1362.92	-807.22	-1359.95	1655156.09	14671903.16	40.3986382	-104.9470597	0.30	
6359.00	1.090	227.310	6077.84	-1364.10	-808.35	-1361.13	1655154.91	14671902.03	40.3986351	-104.9470639	0.10	
6448.00	1.010	222.970	6166.83	-1365.26	-809.50	-1362.29	1655153.76	14671900.88	40.3986319	-104.9470680	0.13	
6538.00	1.100	225.230	6256.81	-1366.42	-810.69	-1363.44	1655152.60	14671899.70	40.3986286	-104.9470722	0.11	
6627.00	1.980	179.270	6345.78	-1367.01	-812.83	-1364.03	1655152.02	14671897.56	40.3986228	-104.9470743	1.63	
6716.00	1.540	194.040	6434.74	-1367.29	-815.52	-1364.30	1655151.75	14671894.86	40.3986154	-104.9470753	0.71	
6734.00†	2.150	121.160	6452.74	-1367.06	-815.93	-1364.07	1655151.98	14671894.45	40.3986142	-104.9470744	12.48	KOP
6806.00	10.700	87.710	6524.23	-1359.22	-816.37	-1356.22	1655159.83	14671894.02	40.3986131	-104.9470462	12.48	
6895.00	19.840	86.770	6610.00	-1335.83	-815.18	-1332.83	1655183.20	14671895.22	40.3986163	-104.9469623	10.27	
6985.00	24.390	84.780	6693.36	-1302.05	-812.63	-1299.06	1655216.96	14671897.80	40.3986233	-104.9468410	5.12	
7074.00	25.580	82.140	6774.03	-1264.69	-808.33	-1261.73	1655254.28	14671902.12	40.3986351	-104.9467070	1.83	
7164.00	36.960	91.920	6850.88	-1218.22	-806.57	-1215.26	1655300.73	14671903.90	40.3986400	-104.9465401	13.81	
7253.00	46.250	95.350	6917.36	-1159.35	-810.47	-1156.37	1655359.59	14671900.04	40.3986293	-104.9463287	10.74	
7342.00	49.220	90.770	6977.23	-1093.63	-813.93	-1090.64	1655425.30	14671896.63	40.3986198	-104.9460927	5.06	
7432.00	50.250	88.150	7035.40	-1024.97	-813.27	-1021.98	1655493.93	14671897.34	40.3986216	-104.9458462	2.50	
7521.00	57.390	85.440	7087.92	-953.29	-809.18	-950.32	1655565.56	14671901.47	40.3986328	-104.9455889	8.39	
7611.00	64.200	88.170	7131.81	-874.89	-804.86	-871.93	1655643.91	14671905.84	40.3986447	-104.9453075	8.02	
7700.00	70.720	90.240	7165.91	-792.74	-803.76	-789.79	1655726.02	14671906.99	40.3986477	-104.9450126	7.63	
7789.00	80.510	93.260	7188.00	-706.70	-806.44	-703.74	1655812.04	14671904.37	40.3986404	-104.9447036	11.48	
7879.00	92.460	93.290	7193.51	-617.20	-811.56	-614.22	1655901.53	14671899.31	40.3986263	-104.9443822	13.28	LANDING (2248'FSL & 90'FEL, SEC.13) 40.3986263, -104.9443822
7968.00	92.180	92.430	7189.90	-528.40	-816.00	-525.40	1655990.31	14671894.93	40.3986142	-104.9440633	1.02	

REFERENCE WELLPATH IDENTIFICATION			
Operator	KERR-MCGEE OIL & GAS ONSHORE LP (WA)	Well	DAMORE 18-6HZ
Field	WELD COUNTY (UTM/TRUE NORTH)	API/Legal	
Facility	SEC.18-T5N-R67W	Wellbore	DAMORE 18-6HZ AWB
Slot	SLOT#06 DAMORE 18-6HZ (2224'FNL & 700'FWL, SEC.18)		

WELLPATH DATA (200 stations)												
MD [ft]	Inclination [°]	Azimuth [°]	TVD [ft]	Vert Sect [ft]	North [ft]	East [ft]	Grid East [US ft]	Grid North [US ft]	Latitude	Longitude	DLS [*/100ft]	Comments
8057.00	91.520	92.340	7187.03	-439.54	-819.70	-436.52	1656079.15	14671891.29	40.3986040	-104.9437443	0.75	
8147.00	90.720	90.590	7185.27	-349.60	-822.00	-346.57	1656169.07	14671889.05	40.3985977	-104.9434213	2.14	
8237.00	89.720	87.500	7184.93	-259.62	-820.50	-256.60	1656259.01	14671890.61	40.3986018	-104.9430983	3.61	
8326.00	90.610	86.910	7184.67	-170.71	-816.16	-167.71	1656347.86	14671895.01	40.3986137	-104.9427791	1.20	
8415.00	89.040	88.260	7184.94	-81.78	-812.41	-78.79	1656436.74	14671898.81	40.3986240	-104.9424599	2.33	
8504.00	90.220	88.690	7185.52	7.19	-810.04	10.17	1656525.67	14671901.24	40.3986305	-104.9421405	1.41	
8594.00	88.710	89.070	7186.36	97.17	-808.28	100.15	1656615.60	14671903.06	40.3986353	-104.9418174	1.73	
8683.00	89.870	89.100	7187.46	186.16	-806.86	189.13	1656704.55	14671904.53	40.3986392	-104.9414980	1.30	
8773.00	88.580	88.360	7188.68	276.13	-804.87	279.10	1656794.48	14671906.59	40.3986447	-104.9411750	1.65	
8862.00	89.700	88.550	7190.01	365.10	-802.47	368.05	1656883.40	14671909.04	40.3986513	-104.9408556	1.28	
8952.00	91.020	88.350	7189.45	455.07	-800.03	458.02	1656973.32	14671911.53	40.3986580	-104.9405326	1.48	
9041.00	90.320	87.930	7188.41	544.02	-797.14	546.96	1657062.23	14671914.48	40.3986659	-104.9402132	0.92	
9130.00	88.990	89.120	7188.94	633.00	-794.85	635.93	1657151.16	14671916.83	40.3986722	-104.9399838	2.01	
9220.00	90.160	89.610	7189.61	722.99	-793.86	725.92	1657241.11	14671917.88	40.3986749	-104.9395707	1.41	
9309.00	91.500	89.410	7188.32	811.98	-793.10	814.90	1657330.06	14671918.70	40.3986770	-104.9392512	1.52	
9399.00	89.530	89.560	7187.51	901.97	-792.29	904.89	1657420.01	14671919.57	40.3986792	-104.9389282	2.20	
9488.00	90.580	90.480	7187.43	990.96	-792.32	993.89	1657508.97	14671919.60	40.3986791	-104.9386086	1.57	
9578.00	88.080	90.040	7188.48	1080.95	-792.73	1083.87	1657598.92	14671919.25	40.3986780	-104.9382856	2.82	
9667.00	88.650	89.760	7191.02	1169.91	-792.57	1172.84	1657687.85	14671919.46	40.3986784	-104.9379661	0.71	
9757.00	89.450	89.570	7192.51	1259.90	-792.04	1262.82	1657777.80	14671920.05	40.3986798	-104.9376431	0.91	
9846.00	89.990	88.960	7192.95	1348.89	-790.90	1351.81	1657866.75	14671921.25	40.3986829	-104.9373236	0.92	
9936.00	90.820	89.080	7192.31	1438.88	-789.36	1441.80	1657956.70	14671922.84	40.3986872	-104.9370005	0.93	
10025.00	89.760	91.130	7191.86	1527.87	-789.53	1530.79	1658045.66	14671922.74	40.3986867	-104.9366810	2.59	
10114.00	88.080	91.140	7193.54	1616.83	-791.29	1619.75	1658134.59	14671921.03	40.3986818	-104.9363616	1.89	
10204.00	88.880	91.440	7195.92	1706.77	-793.31	1709.70	1658224.50	14671919.07	40.3986763	-104.9360387	0.95	
10293.00	89.520	90.460	7197.17	1795.74	-794.79	1798.68	1658313.44	14671917.65	40.3986722	-104.9357192	1.32	
10382.00	90.070	89.940	7197.48	1884.73	-795.10	1887.67	1658402.40	14671917.40	40.3986713	-104.9353997	0.85	
10472.00	87.730	89.150	7199.21	1974.71	-794.39	1977.65	1658492.34	14671918.17	40.3986733	-104.9350766	2.74	
10561.00	88.560	88.890	7202.09	2063.65	-792.87	2066.59	1658581.24	14671919.75	40.3986774	-104.9347573	0.98	
10651.00	89.700	88.880	7203.46	2153.63	-791.11	2156.56	1658671.18	14671921.56	40.3986822	-104.9344343	1.27	
10740.00	90.790	89.550	7203.08	2242.62	-789.89	2245.55	1658760.13	14671922.84	40.3986855	-104.9341148	1.44	
10829.00	89.010	87.800	7203.23	2331.60	-787.84	2334.52	1658849.06	14671924.95	40.3986912	-104.9337954	2.80	
10918.00	88.760	91.080	7204.97	2420.57	-786.97	2423.48	1658937.99	14671925.88	40.3986935	-104.9334759	3.70	
11008.00	88.960	91.250	7206.76	2510.53	-788.80	2513.45	1659027.92	14671924.11	40.3986885	-104.9331529	0.29	
11097.00	89.920	91.800	7207.63	2599.48	-791.17	2602.41	1659116.85	14671921.80	40.3986820	-104.9328335	1.24	
11187.00	90.890	92.780	7206.99	2689.39	-794.76	2692.33	1659206.74	14671918.27	40.3986721	-104.9325107	1.53	
11276.00	91.950	90.420	7204.79	2778.31	-797.25	2781.26	1659295.63	14671915.84	40.3986652	-104.9321914	2.91	
11366.00	90.180	89.040	7203.11	2868.29	-796.82	2871.24	1659385.58	14671916.32	40.3986663	-104.9318684	2.49	
11456.00	91.070	88.620	7202.13	2958.27	-794.98	2961.22	1659475.51	14671918.22	40.3986714	-104.9315453	1.09	
11545.00	89.580	89.020	7201.63	3047.25	-793.15	3050.19	1659564.45	14671920.11	40.3986764	-104.9312259	1.73	
11634.00	90.440	88.640	7201.61	3136.24	-791.33	3139.17	1659653.40	14671921.98	40.3986813	-104.9309064	1.06	
11724.00	89.560	89.550	7201.61	3226.23	-789.91	3229.16	1659743.35	14671923.46	40.3986852	-104.9305833	1.41	
11813.00	90.530	89.660	7201.54	3315.23	-789.30	3318.16	1659832.31	14671924.14	40.3986868	-104.9302638	1.10	
11903.00	88.840	89.340	7202.04	3405.22	-788.51	3408.15	1659922.26	14671924.98	40.3986890	-104.9299407	1.91	
11993.00	89.110	88.900	7203.65	3495.20	-787.13	3498.12	1660012.20	14671926.42	40.3986927	-104.9296176	0.57	

REFERENCE WELLPATH IDENTIFICATION			
Operator	KERR-MCGEE OIL & GAS ONSHORE LP (WA)	Well	DAMORE 18-6HZ
Field	WELD COUNTY (UTM/TRUE NORTH)	API/Legal	
Facility	SEC.18-T5N-R67W	Wellbore	DAMORE 18-6HZ AWB
Slot	SLOT#06 DAMORE 18-6HZ (2224'FNL & 700'FWL, SEC.18)		

WELLPATH DATA (200 stations)												
MD [ft]	Inclination [°]	Azimuth [°]	TVD [ft]	Vert Sect [ft]	North [ft]	East [ft]	Grid East [US ft]	Grid North [US ft]	Latitude	Longitude	DLS [*/100ft]	Comments
12082.00	90.300	89.500	7204.10	3584.19	-785.89	3587.11	1660101.15	14671927.72	40.3986961	-104.9292982	1.50	
12171.00	90.990	89.350	7203.10	3673.19	-785.00	3676.10	1660190.10	14671928.67	40.3986985	-104.9289787	0.79	
12261.00	89.300	89.880	7202.87	3763.18	-784.39	3766.10	1660280.06	14671929.33	40.3987001	-104.9286555	1.97	
12350.00	89.650	89.820	7203.69	3852.18	-784.16	3855.09	1660369.02	14671929.62	40.3987007	-104.9283360	0.40	
12440.00	90.210	90.090	7203.80	3942.18	-784.09	3945.09	1660458.98	14671929.75	40.3987009	-104.9280129	0.69	
12530.00	90.810	90.260	7203.00	4032.17	-784.36	4035.09	1660548.94	14671929.54	40.3987001	-104.9276898	0.69	
12619.00	89.450	90.110	7202.80	4121.17	-784.65	4124.08	1660637.91	14671929.31	40.3986993	-104.9273703	1.54	
12709.00	89.980	90.280	7203.24	4211.16	-784.96	4214.08	1660727.87	14671929.06	40.3986984	-104.9270471	0.62	
12798.00	90.840	90.060	7202.61	4300.16	-785.22	4303.08	1660816.83	14671928.86	40.3986976	-104.9267276	1.00	
12887.00	88.240	89.890	7203.32	4389.15	-785.18	4392.07	1660905.78	14671928.95	40.3986977	-104.9264081	2.93	
12977.00	88.420	89.690	7205.94	4479.11	-784.85	4482.03	1660995.71	14671929.34	40.3986985	-104.9260851	0.30	
13066.00	89.040	89.070	7207.92	4568.08	-783.89	4571.00	1661084.64	14671930.36	40.3987011	-104.9257657	0.99	
13156.00	90.070	89.200	7208.62	4658.07	-782.53	4660.99	1661174.59	14671931.78	40.3987048	-104.9254426	1.15	
13245.00	91.250	89.580	7207.59	4747.06	-781.58	4749.97	1661263.54	14671932.78	40.3987074	-104.9251231	1.39	
13335.00	89.560	90.180	7206.96	4837.06	-781.39	4839.97	1661353.50	14671933.03	40.3987078	-104.9248000	1.99	
13424.00	90.210	90.240	7207.13	4926.05	-781.72	4928.97	1661442.46	14671932.76	40.3987069	-104.9244805	0.73	
13514.00	89.870	91.620	7207.07	5016.03	-783.18	5018.95	1661532.41	14671931.36	40.3987028	-104.9241574	1.58	
13603.00	88.730	91.900	7208.16	5104.97	-785.91	5107.90	1661621.33	14671928.69	40.3986953	-104.9238380	1.32	
13693.00	88.610	91.650	7210.25	5194.89	-788.70	5197.83	1661711.23	14671925.96	40.3986876	-104.9235152	0.31	
13782.00	89.750	91.690	7211.52	5283.84	-791.29	5286.79	1661800.15	14671923.43	40.3986804	-104.9231958	1.28	
13872.00	89.640	92.100	7212.00	5373.77	-794.27	5376.74	1661890.06	14671920.51	40.3986722	-104.9228729	0.47	
13961.00	90.900	92.680	7211.58	5462.68	-797.98	5465.65	1661978.95	14671916.86	40.3986620	-104.9225536	1.56	
14051.00	88.790	91.210	7211.82	5552.61	-801.04	5555.60	1662068.85	14671913.87	40.3986535	-104.9222307	2.86	
14140.00	89.530	90.960	7213.13	5641.57	-802.72	5644.57	1662157.79	14671912.24	40.3986488	-104.9219113	0.88	
14230.00	90.750	90.670	7212.91	5731.56	-804.00	5734.56	1662247.75	14671911.02	40.3986453	-104.9215882	1.39	
14319.00	90.350	89.710	7212.05	5820.55	-804.30	5823.55	1662336.70	14671910.78	40.3986444	-104.9212687	1.17	
14409.00	88.640	89.620	7212.85	5910.54	-803.77	5913.54	1662426.66	14671911.37	40.3986458	-104.9209456	1.90	
14498.00	89.720	90.260	7214.12	5999.53	-803.68	6002.53	1662515.61	14671911.52	40.3986460	-104.9206261	1.41	
14588.00	89.840	87.700	7214.47	6089.52	-802.08	6092.51	1662605.55	14671913.18	40.3986503	-104.9203030	2.85	
14677.00	91.100	88.000	7213.74	6178.46	-798.74	6181.44	1662694.45	14671916.57	40.3986594	-104.9199837	1.46	
14767.00	89.920	86.990	7212.94	6268.38	-794.80	6271.35	1662784.32	14671920.56	40.3986702	-104.9196609	1.73	
14856.00	90.840	86.430	7212.35	6357.25	-789.70	6360.20	1662873.13	14671925.73	40.3986841	-104.9193419	1.21	
14946.00	88.440	86.920	7212.91	6447.11	-784.48	6450.04	1662962.93	14671931.00	40.3986984	-104.9190193	2.72	
15035.00	89.280	87.130	7214.68	6535.99	-779.86	6538.90	1663051.75	14671935.68	40.3987110	-104.9187003	0.97	
15125.00	90.080	86.950	7215.18	6625.88	-775.21	6628.78	1663141.59	14671940.38	40.3987237	-104.9183776	0.91	
15214.00	88.900	87.530	7215.98	6714.79	-770.93	6717.67	1663230.44	14671944.72	40.3987354	-104.9180585	1.48	
15303.00	89.980	87.630	7216.85	6803.71	-767.17	6806.59	1663319.32	14671948.54	40.3987456	-104.9177392	1.22	
15393.00	91.300	88.270	7215.84	6893.66	-763.95	6896.52	1663409.21	14671951.81	40.3987544	-104.9174163	1.63	
15482.00	89.870	88.800	7214.93	6982.63	-761.67	6985.48	1663498.14	14671954.15	40.3987606	-104.9170969	1.71	
15572.00	89.240	90.700	7215.63	7072.62	-761.28	7075.48	1663588.10	14671954.60	40.3987616	-104.9167738	2.22	
15661.00	90.450	90.580	7215.87	7161.61	-762.27	7164.47	1663677.05	14671953.66	40.3987588	-104.9164543	1.37	
15751.00	88.420	90.550	7216.76	7251.60	-763.16	7254.45	1663767.00	14671952.84	40.3987563	-104.9161312	2.26	
15840.00	89.440	90.410	7218.42	7340.57	-763.91	7343.44	1663855.95	14671952.15	40.3987541	-104.9158118	1.16	
15930.00	90.280	89.790	7218.64	7430.57	-764.06	7433.43	1663945.91	14671952.05	40.3987536	-104.9154886	1.16	
16019.00	89.040	89.440	7219.17	7519.57	-763.47	7522.43	1664034.87	14671952.71	40.3987552	-104.9151691	1.45	

REFERENCE WELLPATH IDENTIFICATION			
Operator	KERR-MCGEE OIL & GAS ONSHORE LP (WA)	Well	DAMORE 18-6HZ
Field	WELD COUNTY (UTM/TRUE NORTH)	API/Legal	
Facility	SEC.18-T5N-R67W	Wellbore	DAMORE 18-6HZ AWB
Slot	SLOT#06 DAMORE 18-6HZ (2224'FNL & 700'FWL, SEC.18)		

WELLPATH DATA (200 stations) † = interpolated, ‡ = extrapolated station												
MD [ft]	Inclination [°]	Azimuth [°]	TVD [ft]	Vert Sect [ft]	North [ft]	East [ft]	Grid East [US ft]	Grid North [US ft]	Latitude	Longitude	DLS [°/100ft]	Comments
16108.00	89.790	88.980	7220.08	7608.56	-762.24	7611.41	1664123.82	14671953.99	40.3987585	-104.9148496	0.99	
16197.00	90.930	88.870	7219.52	7697.54	-760.57	7700.40	1664212.76	14671955.72	40.3987630	-104.9145302	1.29	
16287.00	89.390	89.600	7219.27	7787.53	-759.37	7790.38	1664302.72	14671956.98	40.3987662	-104.9142071	1.89	
16376.00	90.160	89.760	7219.62	7876.53	-758.87	7879.38	1664391.68	14671957.53	40.3987675	-104.9138875	0.88	
16465.00	90.040	90.570	7219.46	7965.53	-759.13	7968.38	1664480.64	14671957.33	40.3987667	-104.9135680	0.92	
16555.00	90.820	90.260	7218.79	8055.52	-759.78	8058.37	1664570.60	14671956.74	40.3987649	-104.9132449	0.93	
16644.00	88.780	90.640	7219.10	8144.51	-760.48	8147.37	1664659.55	14671956.10	40.3987629	-104.9129254	2.33	
16734.00	89.950	90.780	7220.09	8234.49	-761.59	8237.35	1664749.51	14671955.05	40.3987597	-104.9126023	1.31	
16823.00	88.390	90.830	7221.38	8323.46	-762.84	8326.33	1664838.45	14671953.85	40.3987562	-104.9122829	1.75	
16913.00	89.470	91.250	7223.06	8413.43	-764.48	8416.30	1664928.38	14671952.28	40.3987516	-104.9119598	1.29	
17002.00	90.810	91.700	7222.85	8502.39	-766.77	8505.27	1665017.32	14671950.05	40.3987453	-104.9116404	1.59	
17092.00	90.300	90.670	7221.98	8592.35	-768.63	8595.24	1665107.26	14671948.25	40.3987401	-104.9113174	1.28	
17182.00	88.280	90.480	7223.09	8682.33	-769.53	8685.23	1665197.20	14671947.40	40.3987375	-104.9109943	2.25	
17271.00	89.410	90.630	7224.88	8771.31	-770.39	8774.20	1665286.15	14671946.60	40.3987351	-104.9106749	1.28	
17361.00	91.180	91.650	7224.42	8861.27	-772.18	8864.18	1665376.09	14671944.87	40.3987301	-104.9103518	2.27	
17451.00	89.360	90.800	7224.00	8951.24	-774.11	8954.15	1665466.03	14671943.00	40.3987247	-104.9100288	2.23	
17540.00	90.420	91.080	7224.17	9040.22	-775.57	9043.14	1665554.98	14671941.60	40.3987206	-104.9097093	1.23	
17630.00	91.520	90.760	7222.64	9130.19	-777.01	9133.11	1665644.92	14671940.22	40.3987165	-104.9093863	1.27	
17669.00	92.050	90.960	7221.43	9169.16	-777.60	9172.09	1665683.88	14671939.66	40.3987149	-104.9092463	1.45	LAST BH MWD+IFR1+MSA SURVEY
17728.00‡	92.050	90.960	7219.32	9228.11	-778.59	9231.04	1665742.81	14671938.71	40.3987121	-104.9090347	0.00	PTB (2304 FSL & 480 FEL, SEC.15) 40.3987121, -104.9090347

HOLE & CASING SECTIONS - Ref Wellbore: DAMORE 18-6HZ AWB Ref Wellpath: DAMORE 18-6HZ AWP									
String/Diameter	Start MD [ft]	End MD [ft]	Interval [ft]	Start TVD [ft]	End TVD [ft]	Start N/S [ft]	Start E/W [ft]	End N/S [ft]	End E/W [ft]
9.625in Casing Surface	26.00	1901.00	1875.00	26.00	1849.64	0.00	0.00	-185.14	-309.62

REFERENCE WELLPATH IDENTIFICATION			
Operator	KERR-MCGEE OIL & GAS ONSHORE LP (WA)	Well	DAMORE 18-6HZ
Field	WELD COUNTY (UTM/TRUE NORTH)	API/Legal	
Facility	SEC.18-T5N-R67W	Wellbore	DAMORE 18-6HZ AWB
Slot	SLOT#06 DAMORE 18-6HZ (2224'FNL & 700'FWL,SEC.18)		

TARGETS								
Name	TVD [ft]	North [ft]	East [ft]	Grid East [US ft]	Grid North [US ft]	Latitude	Longitude	Shape
DAMORE DSU	16.00	57.56	-47.91	1656467.04	14672768.45	40.4010120	-104.9423490	polygon
	2D Polygon: dimensions not calculated							
SEC.13-T5N-R67W	16.00	-934.37	-1268.22	1655247.87	14671776.13	40.3982892	-104.9467303	polygon
	2D Polygon: dimensions not calculated							
SEC.14-T5N-R67W	16.00	-934.37	-1268.22	1655247.87	14671776.13	40.3982892	-104.9467303	polygon
	2D Polygon: dimensions not calculated							
SEC.15-T5N-R67W	16.00	-940.37	-1268.22	1655247.87	14671770.13	40.3982727	-104.9467303	polygon
	2D Polygon: dimensions not calculated							
SEC.17-T5N-R67W	16.00	-920.37	-1268.22	1655247.86	14671790.12	40.3983276	-104.9467303	polygon
	2D Polygon: dimensions not calculated							
SEC.18-T5N-R67W	16.00	-920.37	-1268.22	1655247.86	14671790.12	40.3983276	-104.9467303	polygon
	2D Polygon: dimensions not calculated							
DAMORE 18-6HZ BHL REV-2 (2313'FSL & 481'FEL,SEC.17)	7193.00	-770.24	9232.09	1665743.85	14671947.05	40.3987350	-104.9090309	point
DAMORE 18-6HZ HEEL REV-1 (2253'FSL & 75'FWL,SEC.18)	7193.00	-806.58	-636.44	1655879.31	14671904.28	40.3986400	-104.9444620	point

WELLPATH COMPOSITION - Ref Wellbore: DAMORE 18-6HZ AWB Ref Wellpath: DAMORE 18-6HZ AWP					
Start MD [ft]	End MD [ft]	Positional Uncertainty Model	Log Name/Comment	Wellbore	Survey Date
26.00	1853.00	Custom APC_ISCWSA REV 2 MWD+IFR1 (approximation)	Custom APC ISCWSA Rev-2 MWD+IFR1 <120 - 1794 >	DAMORE 18-6HZ AWB	2/26/2020
1853.00	17728.00	Custom APC_ISCWSA REV 2 MWD+IFR1+MSA (approximation)	BH Custom APC ISCWSA Rev-2 MWD+IFR1+MSA <1950 - 17669>	DAMORE 18-6HZ AWB	4/2/2020



REFERENCE WELLPATH IDENTIFICATION			
Operator	KERR-MCGEE OIL & GAS ONSHORE LP (WA)	Well	DAMORE 18-6HZ
Field	WELD COUNTY (UTM/TRUE NORTH)	API/Legal	
Facility	SEC.18-T5N-R67W	Wellbore	DAMORE 18-6HZ AWB
Slot	SLOT#06 DAMORE 18-6HZ (2224'FNL & 700'FWL, SEC.18)		

WELLPATH COMMENTS				
MD [ft]	Inclination [°]	Azimuth [°]	TVD [ft]	Comment
138.00	0.630	160.410	138.00	FIRST SURFACE MWD+IFR1 SURVEY
1853.00	23.400	237.210	1805.52	LAST SURFACE MWD+IFR1 SURVEY
1950.00	22.590	236.400	1894.81	FIRST BH MWD+IFR1+MSA SURVEY
6734.00	2.150	121.160	6452.74	KOP
7879.00	92.460	93.290	7193.51	LANDING (2248'FSL & 90'FEL, SEC.13) 40.3986263, -104.9443822
17669.00	92.050	90.960	7221.43	LAST BH MWD+IFR1+MSA SURVEY
17728.00	92.050	90.960	7219.32	PTB (2304'FSL & 480'FEL, SEC.15) 40.3987121, -104.9090347