

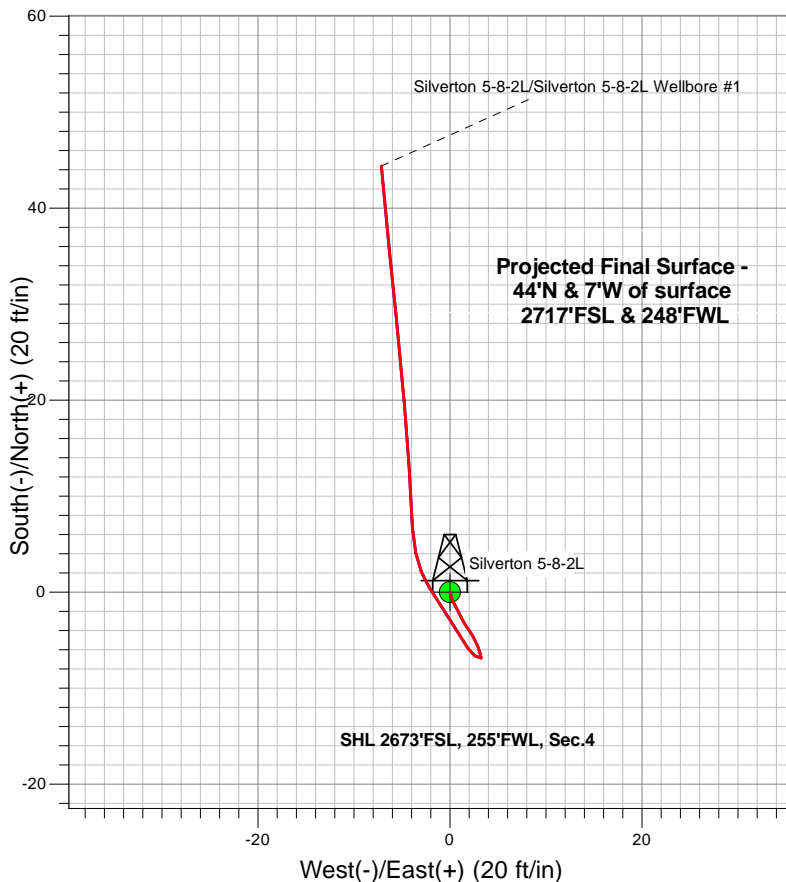

## Confluence Resources



### LEGEND

-  Silverton 5-8-2L Wellbore #1
-  Survey #1

## Final Surface Survey Plot

**Projected Final Surface Survey -  
 1590'MD & 1587' TVD @ 7.80 deg Inc  
 354.60 deg AZ**

Project: SEC.4-T4N-R63W  
 Site: Silverton Pad Sec.4-T4N-R63W  
 Well: Silverton 5-8-2L  
 Plan: Silverton 5-8-2L Wellbore #1



## **Confluence Resources**

**SEC.4-T4N-R63W**

**Silverton Pad Sec.4-T4N-R63W**

**Silverton 5-8-2L**

**Silverton 5-8-2L Wellbore #1**

**Survey: Survey #1**

## **Standard Survey Report**

**05 March, 2020**

<b>Company:</b>	Confluence Resources	<b>Local Co-ordinate Reference:</b>	Well Silverton 5-8-2L
<b>Project:</b>	SEC.4-T4N-R63W	<b>TVD Reference:</b>	WELL @ 4643.0ft
<b>Site:</b>	Silverton Pad Sec.4-T4N-R63W	<b>MD Reference:</b>	WELL @ 4643.0ft
<b>Well:</b>	Silverton 5-8-2L	<b>North Reference:</b>	True
<b>Wellbore:</b>	Silverton 5-8-2L Wellbore #1	<b>Survey Calculation Method:</b>	Minimum Curvature
<b>Design:</b>	Silverton 5-8-2L Wellbore #1	<b>Database:</b>	US_EDM

<b>Project</b>	SEC.4-T4N-R63W, Weld County, CO		
<b>Map System:</b>	US State Plane 1983	<b>System Datum:</b>	Mean Sea Level
<b>Geo Datum:</b>	North American Datum 1983		Using Well Reference Point
<b>Map Zone:</b>	Colorado Northern Zone		Using geodetic scale factor

Site	Silverton Pad Sec.4-T4N-R63W				
Site Position:		Northing:	1,369,035.30 usft	Latitude:	40.341660
From:	Lat/Long	Easting:	3,292,259.81 usft	Longitude:	-104.451510
Position Uncertainty:	0.0 ft	Slot Radius:	13-3/16 "	Grid Convergence:	0.68 °

Well	Silverton 5-8-2L					
Well Position	+N/-S	0.0 ft	Northing:	1,368,838.56 usft	Latitude:	40.341120
	+E/-W	0.0 ft	Easting:	3,292,259.35 usft	Longitude:	-104.451520
Position Uncertainty		0.0 ft	Wellhead Elevation:	0.0 ft	Ground Level:	4,630.0 ft

<b>Wellbore</b>	Silverton 5-8-2L Wellbore #1				
<b>Magnetics</b>	<b>Model Name</b>	<b>Sample Date</b>	<b>Declination (°)</b>	<b>Dip Angle (°)</b>	<b>Field Strength (nT)</b>
	HDGM	2/19/2020	7.98	66.85	52,090

<b>Design</b>	Silverton 5-8-2L Wellbore #1				
<b>Audit Notes:</b>					
<b>Version:</b>	1.0	<b>Phase:</b>	ACTUAL	<b>Tie On Depth:</b>	0.0
<b>Vertical Section:</b>	<b>Depth From (TVD) (ft)</b>	<b>+N/-S (ft)</b>	<b>+E/-W (ft)</b>	<b>Direction (°)</b>	
	0.0	0.0	0.0	350.88	

<b>Survey Program</b>	<b>Date</b>	3/5/2020			
<b>From (ft)</b>	<b>To (ft)</b>	<b>Survey (Wellbore)</b>	<b>Tool Name</b>	<b>Description</b>	
100.0	1,590.0	Survey #1 (Silverton 5-8-2L Wellbore #1)	MWD	MWD - Standard	

<b>Survey</b>										
<b>Measured Depth (ft)</b>	<b>Inclination (°)</b>	<b>Azimuth (°)</b>	<b>Vertical Depth (ft)</b>	<b>+N/-S (ft)</b>	<b>+E/-W (ft)</b>	<b>Vertical Section (ft)</b>	<b>Dogleg Rate (°/100usft)</b>	<b>Build Rate (°/100usft)</b>	<b>Turn Rate (°/100usft)</b>	
0.0	0.00	0.00	0.0	0.0	0.0	0.0	0.00	0.00	0.00	
1.0	0.00	0.00	1.0	0.0	0.0	0.0	0.00	0.00	0.00	
<b>SHL 2673'FSL, 255'FWL, Sec.4</b>										
100.0	0.00	0.00	100.0	0.0	0.0	0.0	0.00	0.00	0.00	
175.0	0.40	161.80	175.0	-0.2	0.1	-0.3	0.53	0.53	0.00	
204.0	0.50	163.00	204.0	-0.5	0.2	-0.5	0.35	0.34	4.14	
265.0	0.70	157.70	265.0	-1.1	0.4	-1.1	0.34	0.33	-8.69	
295.0	1.10	148.30	295.0	-1.5	0.6	-1.6	1.42	1.33	-31.33	
326.0	0.90	155.30	326.0	-2.0	0.8	-2.1	0.75	-0.65	22.58	
416.0	0.50	151.80	416.0	-2.9	1.3	-3.1	0.45	-0.44	-3.89	
461.0	0.50	145.60	461.0	-3.3	1.5	-3.5	0.12	0.00	-13.78	

<b>Company:</b>	Confluence Resources	<b>Local Co-ordinate Reference:</b>	Well Silverton 5-8-2L
<b>Project:</b>	SEC.4-T4N-R63W	<b>TVD Reference:</b>	WELL @ 4643.0ft
<b>Site:</b>	Silverton Pad Sec.4-T4N-R63W	<b>MD Reference:</b>	WELL @ 4643.0ft
<b>Well:</b>	Silverton 5-8-2L	<b>North Reference:</b>	True
<b>Wellbore:</b>	Silverton 5-8-2L Wellbore #1	<b>Survey Calculation Method:</b>	Minimum Curvature
<b>Design:</b>	Silverton 5-8-2L Wellbore #1	<b>Database:</b>	US_EDM

Survey									
Measured Depth (ft)	Inclination (°)	Azimuth (°)	Vertical Depth (ft)	+N/-S (ft)	+E/-W (ft)	Vertical Section (ft)	Dogleg Rate (°/100usft)	Build Rate (°/100usft)	Turn Rate (°/100usft)
505.0	0.60	149.30	505.0	-3.6	1.8	-3.9	0.24	0.23	8.41
550.0	0.60	141.90	550.0	-4.0	2.0	-4.3	0.17	0.00	-16.44
595.0	0.70	151.80	595.0	-4.4	2.3	-4.8	0.33	0.22	22.00
639.0	0.90	150.20	639.0	-5.0	2.6	-5.3	0.46	0.45	-3.64
684.0	1.00	159.70	684.0	-5.7	2.9	-6.1	0.41	0.22	21.11
729.0	0.90	161.80	729.0	-6.4	3.2	-6.8	0.24	-0.22	4.67
774.0	0.40	180.90	774.0	-6.9	3.3	-7.3	1.20	-1.11	42.44
863.0	1.10	308.60	862.9	-6.6	2.6	-7.0	1.55	0.79	143.48
908.0	1.60	324.20	907.9	-5.9	1.9	-6.1	1.37	1.11	34.67
952.0	1.80	329.30	951.9	-4.8	1.2	-4.9	0.57	0.45	11.59
997.0	2.10	328.30	996.9	-3.5	0.4	-3.5	0.67	0.67	-2.22
1,038.0	2.00	325.30	1,037.9	-2.2	-0.4	-2.1	0.36	-0.24	-7.32
1,083.0	2.10	328.40	1,082.8	-0.9	-1.3	-0.7	0.33	0.22	6.89
1,127.0	2.10	328.10	1,126.8	0.5	-2.1	0.8	0.02	0.00	-0.68
1,172.0	2.40	337.60	1,171.8	2.1	-2.9	2.5	1.06	0.67	21.11
1,216.0	3.10	347.40	1,215.7	4.1	-3.6	4.6	1.91	1.59	22.27
1,261.0	3.70	356.60	1,260.6	6.7	-3.9	7.2	1.80	1.33	20.44
1,305.0	4.40	356.90	1,304.5	9.8	-4.1	10.3	1.59	1.59	0.68
1,350.0	5.50	356.60	1,349.4	13.7	-4.3	14.2	2.45	2.44	-0.67
1,395.0	6.90	355.10	1,394.1	18.5	-4.7	19.0	3.13	3.11	-3.33
1,439.0	7.50	355.00	1,437.7	24.0	-5.1	24.5	1.36	1.36	-0.23
1,484.0	7.90	353.70	1,482.3	30.0	-5.7	30.6	0.97	0.89	-2.89
1,520.0	7.80	354.60	1,518.0	34.9	-6.2	35.5	0.44	-0.28	2.50
1,590.0	7.80	354.60	1,587.4	44.4	-7.1	44.9	0.00	0.00	0.00

Checked By: \_\_\_\_\_ Approved By: \_\_\_\_\_ Date: \_\_\_\_\_