

## Confluence Resources

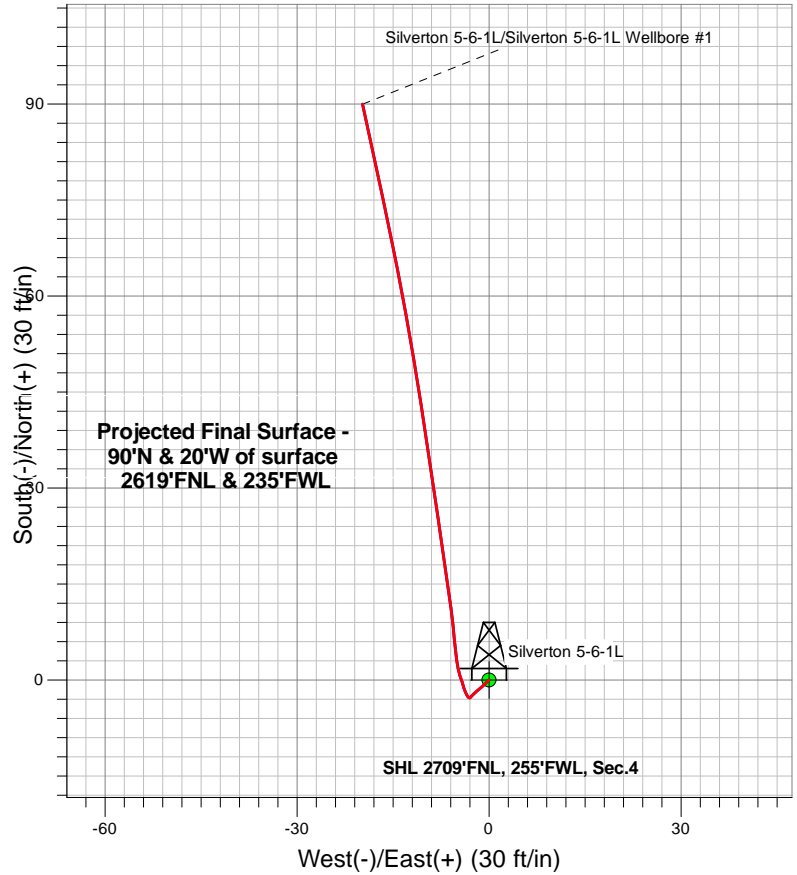

### LEGEND

— Silverton 5-6-1L Wellbore #1

## Final Surface Survey Plot

Projected Final Surface Survey -  
 1590'MD & 1583' TVD @ 12.50 deg Inc  
 347.80 deg AZ

Project: SEC.4-T4N-R63W  
 Site: Silverton Pad Sec.4-T4N-R63W  
 Well: Silverton 5-6-1L  
 Plan: Silverton 5-6-1L Wellbore #1



## **Confluence Resources**

**SEC.4-T4N-R63W**

**Silverton Pad Sec.4-T4N-R63W**

**Silverton 5-6-1L**

**Silverton 5-6-1L Wellbore #1**

**Survey: Survey #1**

## **Standard Survey Report**

**03 March, 2020**

<b>Company:</b>	Confluence Resources	<b>Local Co-ordinate Reference:</b>	Well Silverton 5-6-1L
<b>Project:</b>	SEC.4-T4N-R63W	<b>TVD Reference:</b>	WELL @ 4642.0ft
<b>Site:</b>	Silverton Pad Sec.4-T4N-R63W	<b>MD Reference:</b>	WELL @ 4642.0ft
<b>Well:</b>	Silverton 5-6-1L	<b>North Reference:</b>	True
<b>Wellbore:</b>	Silverton 5-6-1L Wellbore #1	<b>Survey Calculation Method:</b>	Minimum Curvature
<b>Design:</b>	Silverton 5-6-1L Wellbore #1	<b>Database:</b>	US_EDM

<b>Project</b>	SEC.4-T4N-R63W, Weld County, CO		
<b>Map System:</b>	US State Plane 1983	<b>System Datum:</b>	Mean Sea Level
<b>Geo Datum:</b>	North American Datum 1983		Using Well Reference Point
<b>Map Zone:</b>	Colorado Northern Zone		Using geodetic scale factor

Site	Silverton Pad Sec.4-T4N-R63W				
Site Position:		Northing:	1,369,035.30 usft	Latitude:	40.341660
From:	Lat/Long	Easting:	3,292,259.81 usft	Longitude:	-104.451510
Position Uncertainty:	0.0 ft	Slot Radius:	13-3/16 "	Grid Convergence:	0.68 °

Well	Silverton 5-6-1L					
Well Position	+N/-S	0.0 ft	Northing:	1,368,885.94 usft	Latitude:	40.341250
	+E/-W	0.0 ft	Easting:	3,292,261.58 usft	Longitude:	-104.451510
Position Uncertainty		0.0 ft	Wellhead Elevation:	0.0 ft	Ground Level:	4,629.0 ft

<b>Wellbore</b>	Silverton 5-6-1L Wellbore #1				
<b>Magnetics</b>	<b>Model Name</b>	<b>Sample Date</b>	<b>Declination (°)</b>	<b>Dip Angle (°)</b>	<b>Field Strength (nT)</b>
	HDGM	2/19/2020	7.98	66.85	52,090

<b>Design</b>	Silverton 5-6-1L Wellbore #1				
<b>Audit Notes:</b>					
<b>Version:</b>	1.0	<b>Phase:</b>	ACTUAL	<b>Tie On Depth:</b>	0.0
<b>Vertical Section:</b>	<b>Depth From (TVD) (ft)</b>	<b>+N/-S (ft)</b>	<b>+E/-W (ft)</b>	<b>Direction (°)</b>	
	0.0	0.0	0.0	347.60	

<b>Survey Program</b>	<b>Date</b>	3/3/2020			
<b>From (ft)</b>	<b>To (ft)</b>	<b>Survey (Wellbore)</b>	<b>Tool Name</b>	<b>Description</b>	
100.0	1,590.0	Survey #1 (Silverton 5-6-1L Wellbore #1)	MWD	MWD - Standard	

<b>Survey</b>										
<b>Measured Depth (ft)</b>	<b>Inclination (°)</b>	<b>Azimuth (°)</b>	<b>Vertical Depth (ft)</b>	<b>+N/-S (ft)</b>	<b>+E/-W (ft)</b>	<b>Vertical Section (ft)</b>	<b>Dogleg Rate (°/100usft)</b>	<b>Build Rate (°/100usft)</b>	<b>Turn Rate (°/100usft)</b>	
0.0	0.00	0.00	0.0	0.0	0.0	0.0	0.00	0.00	0.00	
100.0	0.00	0.00	100.0	0.0	0.0	0.0	0.00	0.00	0.00	
175.0	0.70	226.10	175.0	-0.3	-0.3	-0.2	0.93	0.93	0.00	
204.0	0.90	224.00	204.0	-0.6	-0.6	-0.5	0.70	0.69	-7.24	
234.0	1.00	231.90	234.0	-0.9	-1.0	-0.7	0.55	0.33	26.33	
265.0	1.00	229.80	265.0	-1.3	-1.4	-0.9	0.12	0.00	-6.77	
326.0	0.60	228.90	326.0	-1.8	-2.1	-1.3	0.66	-0.66	-1.48	
416.0	0.40	218.70	416.0	-2.4	-2.6	-1.8	0.24	-0.22	-11.33	
461.0	0.20	220.90	461.0	-2.6	-2.8	-1.9	0.45	-0.44	4.89	
505.0	0.30	226.10	505.0	-2.7	-2.9	-2.0	0.23	0.23	11.82	

<b>Company:</b>	Confluence Resources	<b>Local Co-ordinate Reference:</b>	Well Silverton 5-6-1L
<b>Project:</b>	SEC.4-T4N-R63W	<b>TVD Reference:</b>	WELL @ 4642.0ft
<b>Site:</b>	Silverton Pad Sec.4-T4N-R63W	<b>MD Reference:</b>	WELL @ 4642.0ft
<b>Well:</b>	Silverton 5-6-1L	<b>North Reference:</b>	True
<b>Wellbore:</b>	Silverton 5-6-1L Wellbore #1	<b>Survey Calculation Method:</b>	Minimum Curvature
<b>Design:</b>	Silverton 5-6-1L Wellbore #1	<b>Database:</b>	US_EDM

Survey									
Measured Depth (ft)	Inclination (°)	Azimuth (°)	Vertical Depth (ft)	+N/-S (ft)	+E/-W (ft)	Vertical Section (ft)	Dogleg Rate (°/100usft)	Build Rate (°/100usft)	Turn Rate (°/100usft)
550.0	0.20	265.30	550.0	-2.8	-3.0	-2.1	0.43	-0.22	87.11
595.0	0.40	314.50	595.0	-2.7	-3.2	-1.9	0.69	0.44	109.33
639.0	0.50	329.80	639.0	-2.4	-3.4	-1.6	0.35	0.23	34.77
684.0	0.80	336.90	684.0	-2.0	-3.7	-1.1	0.69	0.67	15.78
729.0	1.10	341.80	729.0	-1.3	-3.9	-0.4	0.69	0.67	10.89
774.0	1.30	341.30	774.0	-0.4	-4.2	0.6	0.45	0.44	-1.11
818.0	1.40	342.70	817.9	0.6	-4.5	1.6	0.24	0.23	3.18
863.0	1.70	348.30	862.9	1.8	-4.8	2.8	0.75	0.67	12.44
908.0	1.80	350.60	907.9	3.2	-5.1	4.2	0.27	0.22	5.11
952.0	2.20	355.50	951.9	4.7	-5.3	5.7	0.99	0.91	11.14
997.0	2.50	354.30	996.8	6.5	-5.4	7.5	0.68	0.67	-2.67
1,038.0	3.00	354.30	1,037.8	8.5	-5.6	9.5	1.22	1.22	0.00
1,083.0	3.90	352.20	1,082.7	11.2	-6.0	12.2	2.02	2.00	-4.67
1,127.0	4.80	351.80	1,126.6	14.5	-6.4	15.5	2.05	2.05	-0.91
1,172.0	6.10	351.60	1,171.4	18.7	-7.0	19.8	2.89	2.89	-0.44
1,216.0	7.40	351.80	1,215.1	23.8	-7.8	24.9	2.96	2.95	0.45
1,261.0	8.30	352.20	1,259.7	29.9	-8.6	31.1	2.00	2.00	0.89
1,305.0	8.80	350.60	1,303.2	36.4	-9.6	37.6	1.26	1.14	-3.64
1,350.0	9.50	351.60	1,347.6	43.4	-10.7	44.7	1.60	1.56	2.22
1,395.0	10.30	350.60	1,391.9	51.1	-11.9	52.4	1.82	1.78	-2.22
1,439.0	11.00	349.20	1,435.2	59.1	-13.4	60.6	1.70	1.59	-3.18
1,484.0	11.70	348.80	1,479.3	67.8	-15.0	69.4	1.57	1.56	-0.89
1,520.0	12.50	347.80	1,514.5	75.2	-16.6	77.0	2.30	2.22	-2.78
1,590.0	12.50	347.80	1,582.8	90.0	-19.8	92.1	0.00	0.00	0.00

Checked By: _____	Approved By: _____	Date: _____
-------------------	--------------------	-------------