





39.77699, -108.12428, 7212.5ft, 211°
04/20/2020 01:02:34 PM



COLORADO
Oil & Gas Conservation
Commission
Department of Natural Resources

Photo 2. Well head.

ELU 8905C-24 E24 396

API: 05-103-10682

Inspection: 700401124



39.77701, -108.12349, 7225.1ft, 313°
04/20/2020 01:01:29 PM



39.77666, -108.12359, 7214.4ft, 53°
04/20/2020 01:04:51 PM



COLORADO
Oil & Gas Conservation
Commission
Department of Natural Resources

Photo 4. Separator.

ELU 8905C-24 E24 396

API: 05-103-10682

Inspection: 700401124





39.77694, -108.12327, 7224.4ft, 90°
04/20/2020 12:59:35 PM

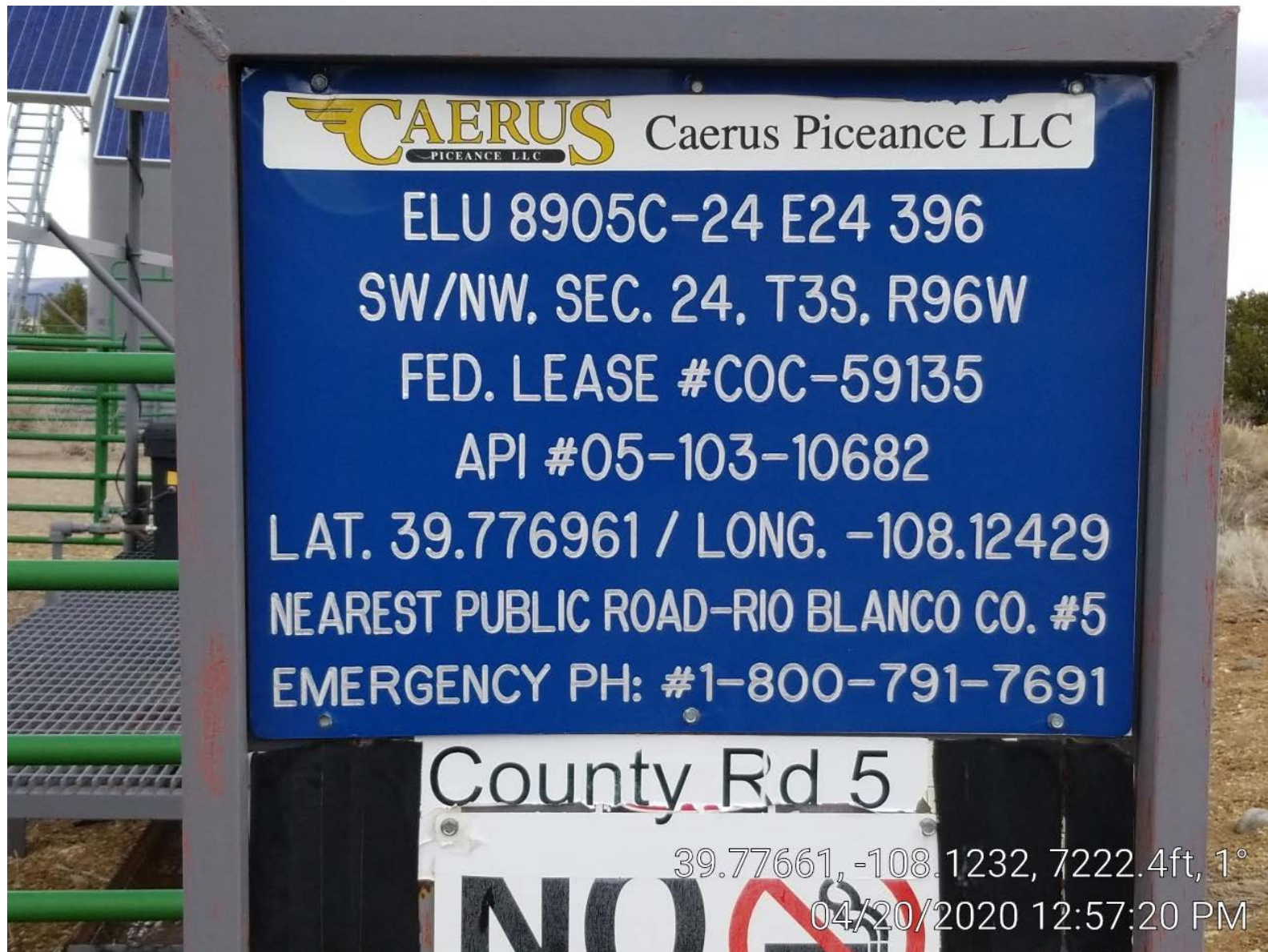



COLORADO
Oil & Gas Conservation
Commission
Department of Natural Resources

Photo 8. Fallen deadman marker NE corner.

ELU 8905C-24 E24 396

API: 05-103-10682

Inspection: 700401124