

# BONANZA CREEK ENERGY

Location: COLORADO Slot: SLOT#11 STATE ANTELOPE Y44-E14-13HNB (2687'FNL & 510'FEL,SEC.13)  
Field: WELD COUNTY (NAD83/TRUE) Well: STATE ANTELOPE Y44-E14-13HNB  
Facility: SEC.13-T05N-R62W Wellbore: STATE ANTELOPE Y44-E14-13HNB PWB 05-123-50287

Plot reference wellpath is STATE ANTELOPE Y44-E14-13HNB PWP (REV-C.0)	Grid System: NAD83 / Lambert Colorado SP, Northern Zone (501), US feet
True vertical depths are referenced to RIG (17) (RKB)	North Reference: True north
Reference wellpath measured depths are referenced to RIG (17) (RKB)	Scale: True distance
RIG (17) (RKB) to Mean Sea Level: 4590 feet	Coordinates are in feet referenced to Slot
Mean Sea Level to Ground level (At Slot: SLOT#11 STATE ANTELOPE Y44-E14-13HNB (2687'FNL & 510'FEL,SEC.13): 0 feet	Depths are in feet
Offset wellpath MDs are referenced to each path's default MD datum	Created by: robaid1 on 2020-03-04; Database: WellArchitectDB3

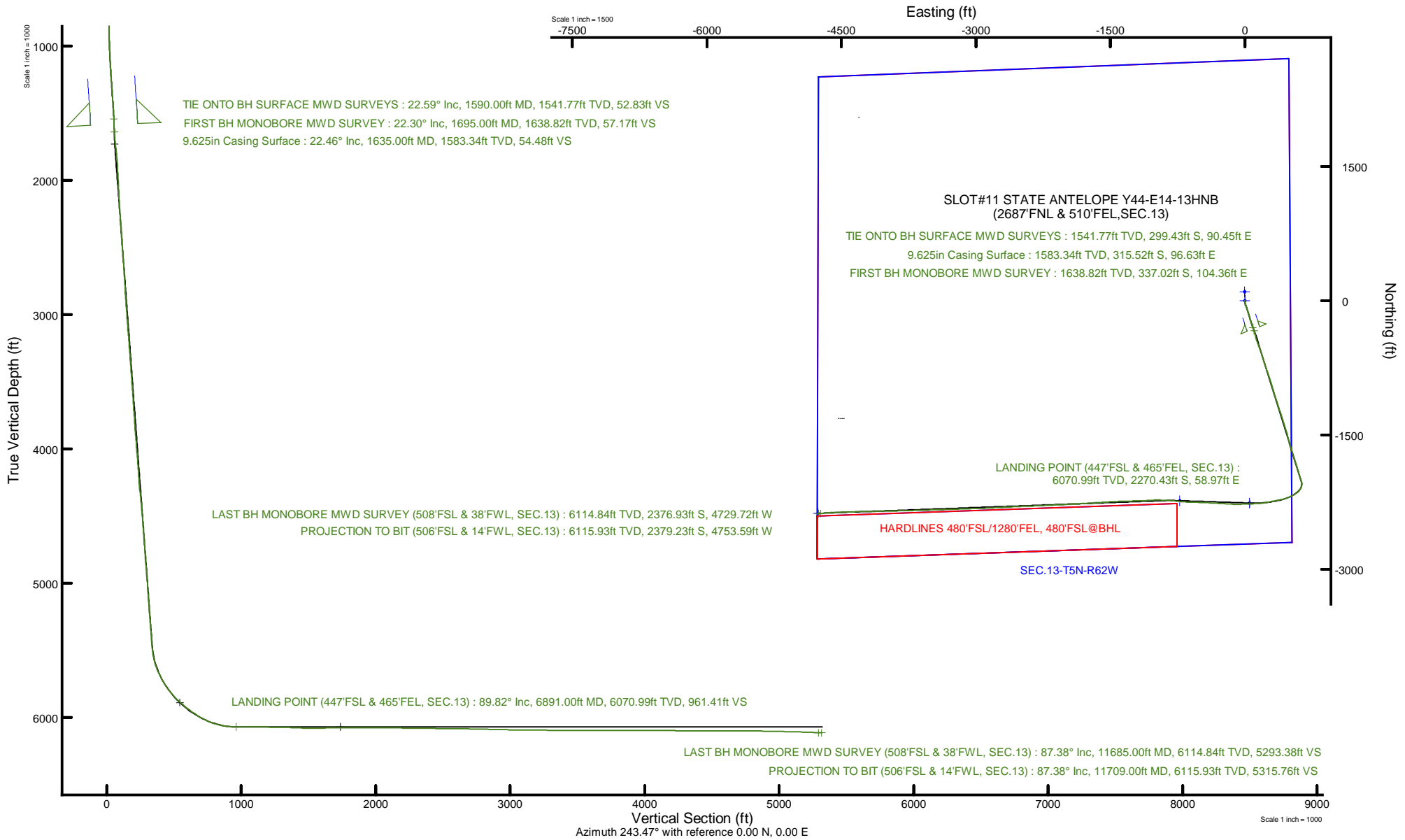



# Actual Wellpath Report

STATE ANTELOPE Y44-E14-13HNB AWP

Page 1 of 8



REFERENCE WELLPATH IDENTIFICATION			
Operator	BONANZA CREEK ENERGY	Well	STATE ANTELOPE Y44-E14-13HNB
Field	WELD COUNTY (NAD83/TRUE)	API/Legal	
Facility	SEC.13-T05N-R62W	Wellbore	STATE ANTELOPE Y44-E14-13HNB AWB
Slot	SLOT#11 STATE ANTELOPE Y44-E14-13HNB (2687'FNL & 510'FEL,SEC.13)		

REPORT SETUP INFORMATION			
Projection System	NAD83 / Lambert Colorado SP, Northern Zone (501), US feet	Software System	WellArchitect® 6.0
North Reference	True	User	Robiale01
Scale	0.999960	Report Generated	2/26/2020 at 5:47:45 PM
Convergence at slot	0.80° East	Database	WA_DENVER

WELLPATH LOCATION						
	Local coordinates		Grid coordinates		Geographic coordinates	
	North[ft]	East[ft]	Easting[US ft]	Northing[US ft]	Latitude	Longitude
Slot Location	1315.94	4472.99	3344314.16	1391347.21	40°24'3.8196"N	104°15'49.2120"W
Facility Reference Pt			3339859.89	1389969.91	40°23'50.8200"N	104°16'47.0280"W
Field Reference Pt			3224525.77	1254425.87	40°01'44.4000"N	104°41'53.5560"W

WELLPATH DATUM			
Calculation method	Minimum curvature	RIG (17") (RKB) to Facility Vertical Datum	4590.00ft
Horizontal Reference Pt	Slot	RIG (17") (RKB) to Mean Sea Level	4590.00ft
Vertical Reference Pt	RIG (17") (RKB)	RIG (17") (RKB) to Ground Level at Slot (SLOT#11 STATE ANTELOPE Y44-E14-13HNB (2687'FNL & 510'FEL,SEC.13))	4590.00ft
MD Reference Pt	RIG (17") (RKB)	Section Origin	N 0.00, E 0.00 ft
Field Vertical Reference	Mean Sea Level	Section Azimuth	243.47°



Actual Wellpath Report  
STATE ANTELOPE Y44-E14-13HNB AWP  
Page 2 of 8



REFERENCE WELLPATH IDENTIFICATION			
Operator	BONANZA CREEK ENERGY	Well	STATE ANTELOPE Y44-E14-13HNB
Field	WELD COUNTY (NAD83/TRUE)	API/Legal	
Facility	SEC.13-T05N-R62W	Wellbore	STATE ANTELOPE Y44-E14-13HNB AWB
Slot	SLOT#11 STATE ANTELOPE Y44-E14-13HNB (2687'FNL & 510'FEL,SEC.13)		

WELLPATH DATA (133 stations) † = interpolated, ‡ = extrapolated station										
MD [ft]	Inclination [°]	Azimuth [°]	TVD [ft]	Vert Sect [ft]	North [ft]	East [ft]	Latitude	Longitude	DLS [°/100ft]	Comments
0.00†	0.000	217.340	0.00	0.00	0.00	0.00	40°24'3.8196"N	104°15'49.2120"W	0.00	
17.00	0.000	217.340	17.00	0.00	0.00	0.00	40°24'3.8196"N	104°15'49.2120"W	0.00	
123.00	0.160	217.340	123.00	0.13	-0.12	-0.09	40°24'3.8184"N	104°15'49.2132"W	0.15	
215.00	0.530	245.160	215.00	0.67	-0.40	-0.55	40°24'3.8157"N	104°15'49.2192"W	0.43	
308.00	2.030	185.140	307.97	1.97	-2.22	-1.09	40°24'3.7977"N	104°15'49.2261"W	1.96	
400.00	3.880	178.120	399.85	4.12	-6.95	-1.14	40°24'3.7509"N	104°15'49.2267"W	2.05	
489.00	5.730	168.060	488.53	6.50	-14.31	-0.12	40°24'3.6782"N	104°15'49.2135"W	2.28	
578.00	7.380	166.100	576.95	8.87	-24.21	2.17	40°24'3.5804"N	104°15'49.1839"W	1.87	
666.00	9.100	161.010	664.04	11.02	-36.28	5.80	40°24'3.4611"N	104°15'49.1371"W	2.12	
755.00	10.030	161.930	751.80	13.08	-50.30	10.49	40°24'3.3226"N	104°15'49.0764"W	1.06	
843.00	12.070	161.180	838.16	15.44	-66.29	15.84	40°24'3.1645"N	104°15'49.0073"W	2.32	
931.00	12.730	160.530	924.11	17.87	-84.14	22.04	40°24'2.9881"N	104°15'48.9272"W	0.77	
1020.00	14.940	162.940	1010.52	20.96	-104.36	28.67	40°24'2.7884"N	104°15'48.8414"W	2.57	
1108.00	17.240	162.290	1095.07	24.83	-127.63	35.97	40°24'2.5584"N	104°15'48.7471"W	2.62	
1197.00	19.640	163.430	1179.50	29.44	-154.53	44.25	40°24'2.2926"N	104°15'48.6401"W	2.73	
1284.00	22.200	163.520	1260.75	34.84	-184.31	53.08	40°24'1.9983"N	104°15'48.5259"W	2.94	
1372.00	23.370	161.920	1341.89	40.31	-216.85	63.21	40°24'1.6768"N	104°15'48.3949"W	1.50	
1461.00	24.140	163.670	1423.35	46.12	-251.09	73.81	40°24'1.3384"N	104°15'48.2580"W	1.17	
1548.00	23.090	159.950	1503.06	51.20	-284.19	84.66	40°24'1.0113"N	104°15'48.1177"W	2.09	
1590.00	22.590	158.440	1541.77	52.83	-299.43	90.45	40°24'0.8607"N	104°15'48.0429"W	1.83	TIE ONTO BH SURFACE MWD SURVEYS
1695.00	22.300	160.960	1638.82	57.17	-337.02	104.36	40°24'0.4893"N	104°15'47.8631"W	0.96	FIRST BH MONOBORE MWD SURVEY
1784.00	22.720	167.940	1721.05	63.67	-369.80	113.46	40°24'0.1654"N	104°15'47.7455"W	3.04	
1871.00	24.990	167.520	1800.62	72.33	-404.18	120.94	40°23'59.8257"N	104°15'47.6488"W	2.62	
1959.00	25.170	160.040	1880.34	78.99	-439.92	131.35	40°23'59.4724"N	104°15'47.5143"W	3.61	
2046.00	25.220	161.230	1959.06	83.61	-474.86	143.63	40°23'59.1272"N	104°15'47.3555"W	0.59	
2134.00	24.710	158.770	2038.84	87.84	-509.76	156.32	40°23'58.7823"N	104°15'47.1915"W	1.31	
2223.00	24.870	157.800	2119.64	90.97	-544.43	170.13	40°23'58.4398"N	104°15'47.0130"W	0.49	
2309.00	24.510	163.300	2197.79	95.39	-578.26	182.09	40°23'58.1054"N	104°15'46.8584"W	2.70	
2398.00	24.820	161.310	2278.67	101.09	-613.64	193.38	40°23'57.7558"N	104°15'46.7125"W	1.00	
2486.00	24.820	163.780	2358.54	106.91	-648.87	204.46	40°23'57.4077"N	104°15'46.5693"W	1.18	



Actual Wellpath Report  
STATE ANTELOPE Y44-E14-13HNB AWP  
Page 3 of 8



REFERENCE WELLPATH IDENTIFICATION			
Operator	BONANZA CREEK ENERGY	Well	STATE ANTELOPE Y44-E14-13HNB
Field	WELD COUNTY (NAD83/TRUE)	API/Legal	
Facility	SEC.13-T05N-R62W	Wellbore	STATE ANTELOPE Y44-E14-13HNB AWB
Slot	SLOT#11 STATE ANTELOPE Y44-E14-13HNB (2687'FNL & 510'FEL,SEC.13)		

WELLPATH DATA (133 stations)										
MD [ft]	Inclination [°]	Azimuth [°]	TVD [ft]	Vert Sect [ft]	North [ft]	East [ft]	Latitude	Longitude	DLS [°/100ft]	Comments
2575.00	24.660	161.190	2439.38	112.75	-684.38	215.67	40°23'57.0568"N	104°15'46.4245"W	1.23	
2662.00	24.470	162.810	2518.51	118.11	-718.78	226.84	40°23'56.7169"N	104°15'46.2800"W	0.80	
2750.00	25.100	162.300	2598.40	123.94	-753.97	237.90	40°23'56.3691"N	104°15'46.1371"W	0.76	
2840.00	25.040	161.240	2679.92	129.44	-790.19	249.83	40°23'56.0112"N	104°15'45.9829"W	0.50	
2928.00	23.920	160.460	2760.01	134.13	-824.64	261.79	40°23'55.6708"N	104°15'45.8283"W	1.32	
3017.00	22.440	161.560	2841.82	138.72	-857.76	273.20	40°23'55.3435"N	104°15'45.6809"W	1.73	
3104.00	23.460	163.880	2921.94	144.19	-890.15	283.26	40°23'55.0235"N	104°15'45.5508"W	1.57	
3192.00	24.520	162.530	3002.33	150.23	-924.40	293.60	40°23'54.6850"N	104°15'45.4171"W	1.36	
3280.00	23.410	162.610	3082.75	155.88	-958.50	304.31	40°23'54.3481"N	104°15'45.2787"W	1.26	
3368.00	24.300	164.420	3163.23	162.10	-992.62	314.40	40°23'54.0108"N	104°15'45.1484"W	1.31	
3455.00	25.490	162.330	3242.15	168.38	-1027.70	324.89	40°23'53.6642"N	104°15'45.0128"W	1.70	
3542.00	25.620	162.400	3320.63	174.19	-1063.47	336.26	40°23'53.3107"N	104°15'44.8658"W	0.15	
3630.00	25.700	162.020	3399.96	179.98	-1099.76	347.90	40°23'52.9522"N	104°15'44.7154"W	0.21	
3718.00	25.390	162.240	3479.35	185.69	-1135.87	359.55	40°23'52.5953"N	104°15'44.5648"W	0.37	
3807.00	25.410	161.930	3559.75	191.41	-1172.20	371.29	40°23'52.2364"N	104°15'44.4131"W	0.15	
3895.00	25.520	161.700	3639.20	196.90	-1208.14	383.10	40°23'51.8811"N	104°15'44.2605"W	0.17	
3984.00	24.780	161.230	3719.76	202.17	-1244.00	395.12	40°23'51.5268"N	104°15'44.1051"W	0.86	
4073.00	25.300	162.410	3800.40	207.64	-1279.79	406.87	40°23'51.1731"N	104°15'43.9532"W	0.81	
4161.00	24.560	162.540	3880.20	213.45	-1315.16	418.04	40°23'50.8236"N	104°15'43.8089"W	0.84	
4249.00	24.790	163.370	3960.16	219.50	-1350.29	428.81	40°23'50.4765"N	104°15'43.6697"W	0.47	
4338.00	25.350	163.650	4040.78	226.08	-1386.45	439.51	40°23'50.1192"N	104°15'43.5314"W	0.64	
4425.00	25.130	161.970	4119.47	232.10	-1421.89	450.47	40°23'49.7690"N	104°15'43.3897"W	0.86	
4512.00	23.350	162.170	4198.80	237.44	-1455.87	461.47	40°23'49.4332"N	104°15'43.2476"W	2.05	
4601.00	23.790	165.480	4280.38	243.85	-1490.04	471.37	40°23'49.0956"N	104°15'43.1196"W	1.57	
4688.00	25.540	167.950	4359.44	252.19	-1525.37	479.69	40°23'48.7464"N	104°15'43.0122"W	2.33	
4776.00	25.060	163.640	4439.01	260.23	-1561.81	488.90	40°23'48.3863"N	104°15'42.8931"W	2.16	
4864.00	24.990	162.350	4518.74	266.39	-1597.40	499.78	40°23'48.0346"N	104°15'42.7524"W	0.63	
4951.00	25.200	162.660	4597.53	272.18	-1632.59	510.87	40°23'47.6868"N	104°15'42.6091"W	0.28	
5040.00	25.190	162.630	4678.07	278.22	-1668.76	522.18	40°23'47.3295"N	104°15'42.4630"W	0.02	
5126.00	24.890	162.270	4755.98	283.91	-1703.46	533.15	40°23'46.9865"N	104°15'42.3212"W	0.39	



Actual Wellpath Report  
STATE ANTELOPE Y44-E14-13HNB AWP  
Page 4 of 8



REFERENCE WELLPATH IDENTIFICATION			
Operator	BONANZA CREEK ENERGY	Well	STATE ANTELOPE Y44-E14-13HNB
Field	WELD COUNTY (NAD83/TRUE)	API/Legal	
Facility	SEC.13-T05N-R62W	Wellbore	STATE ANTELOPE Y44-E14-13HNB AWB
Slot	SLOT#11 STATE ANTELOPE Y44-E14-13HNB (2687'FNL & 510'FEL,SEC.13)		

WELLPATH DATA (133 stations)										
MD [ft]	Inclination [°]	Azimuth [°]	TVD [ft]	Vert Sect [ft]	North [ft]	East [ft]	Latitude	Longitude	DLS [°/100ft]	Comments
5214.00	25.310	162.240	4835.67	289.61	-1739.02	544.53	40°23'46.6352"N	104°15'42.1742"W	0.48	
5302.00	24.740	163.350	4915.41	295.64	-1774.57	555.54	40°23'46.2839"N	104°15'42.0318"W	0.84	
5391.00	24.930	162.740	4996.18	301.86	-1810.33	566.44	40°23'45.9305"N	104°15'41.8909"W	0.36	
5480.00	24.810	162.730	5076.93	307.88	-1846.07	577.55	40°23'45.5773"N	104°15'41.7474"W	0.13	
5568.00	23.960	161.890	5157.08	313.47	-1880.68	588.59	40°23'45.2353"N	104°15'41.6047"W	1.04	
5656.00	23.680	164.600	5237.58	319.50	-1914.71	598.84	40°23'44.8991"N	104°15'41.4723"W	1.28	
5745.00	25.170	162.660	5318.62	325.97	-1950.01	609.22	40°23'44.5503"N	104°15'41.3381"W	1.90	
5833.00	25.130	162.390	5398.27	331.86	-1985.68	620.45	40°23'44.1978"N	104°15'41.1929"W	0.14	
5921.00	24.200	164.550	5478.25	338.22	-2020.87	630.91	40°23'43.8500"N	104°15'41.0578"W	1.47	
6009.00	22.980	182.690	5559.00	350.09	-2055.47	634.92	40°23'43.5081"N	104°15'41.0060"W	8.33	
6098.00	27.620	201.250	5639.57	373.90	-2092.13	626.61	40°23'43.1459"N	104°15'41.1134"W	10.27	
6187.00	30.680	223.420	5717.51	410.63	-2127.96	603.45	40°23'42.7918"N	104°15'41.4127"W	12.54	
6275.00	36.100	239.420	5791.10	457.71	-2157.53	565.60	40°23'42.4996"N	104°15'41.9020"W	11.71	
6362.00	44.530	243.850	5857.40	513.89	-2184.07	516.05	40°23'42.2373"N	104°15'42.5424"W	10.23	
6450.00	50.790	251.210	5916.68	578.64	-2208.69	455.97	40°23'41.9940"N	104°15'43.3189"W	9.42	
6539.00	56.540	259.710	5969.45	648.59	-2226.47	386.66	40°23'41.8184"N	104°15'44.2147"W	10.04	
6627.00	63.120	258.550	6013.66	721.81	-2240.83	311.99	40°23'41.6765"N	104°15'45.1797"W	7.56	
6715.00	73.140	260.100	6046.40	800.26	-2255.90	231.84	40°23'41.5276"N	104°15'46.2156"W	11.50	
6803.00	82.410	265.890	6065.03	881.16	-2266.30	146.60	40°23'41.4248"N	104°15'47.3173"W	12.34	
6891.00	89.820	268.700	6070.99	961.41	-2270.43	58.97	40°23'41.3840"N	104°15'48.4499"W	9.00	LANDING POINT (447'FSL & 465'FEL, SEC.13)
6980.00	89.940	268.020	6071.17	1042.14	-2272.98	-30.00	40°23'41.3589"N	104°15'49.5997"W	0.78	
7158.00	89.110	274.240	6072.65	1199.72	-2269.47	-207.87	40°23'41.3935"N	104°15'51.8985"W	3.53	
7245.00	89.080	273.270	6074.02	1274.83	-2263.77	-294.67	40°23'41.4498"N	104°15'53.0204"W	1.12	
7333.00	88.710	272.730	6075.72	1351.38	-2259.17	-382.53	40°23'41.4953"N	104°15'54.1560"W	0.74	
7421.00	87.750	272.160	6078.44	1428.33	-2255.41	-470.41	40°23'41.5324"N	104°15'55.2917"W	1.27	
7509.00	89.880	271.860	6080.26	1505.61	-2252.33	-558.33	40°23'41.5628"N	104°15'56.4281"W	2.44	
7597.00	90.520	272.980	6079.95	1582.62	-2248.61	-646.25	40°23'41.5995"N	104°15'57.5644"W	1.47	
7684.00	90.310	274.570	6079.32	1657.72	-2242.89	-733.05	40°23'41.6561"N	104°15'58.6863"W	1.84	
7772.00	90.280	275.470	6078.87	1732.71	-2235.19	-820.71	40°23'41.7322"N	104°15'59.8192"W	1.02	
7859.00	90.340	272.370	6078.40	1807.70	-2229.24	-907.50	40°23'41.7909"N	104°16'0.9409"W	3.56	



Actual Wellpath Report  
STATE ANTELOPE Y44-E14-13HNB AWP  
Page 5 of 8



REFERENCE WELLPATH IDENTIFICATION			
Operator	BONANZA CREEK ENERGY	Well	STATE ANTELOPE Y44-E14-13HNB
Field	WELD COUNTY (NAD83/TRUE)	API/Legal	
Facility	SEC.13-T05N-R62W	Wellbore	STATE ANTELOPE Y44-E14-13HNB AWB
Slot	SLOT#11 STATE ANTELOPE Y44-E14-13HNB (2687'FNL & 510'FEL,SEC.13)		

WELLPATH DATA (133 stations)										
MD [ft]	Inclination [°]	Azimuth [°]	TVD [ft]	Vert Sect [ft]	North [ft]	East [ft]	Latitude	Longitude	DLS [°/100ft]	Comments
8035.00	89.970	265.810	6077.92	1966.31	-2232.03	-1083.38	40°23'41.7632"N	104°16'3.2140"W	3.73	
8124.00	90.090	268.310	6077.87	2047.86	-2236.60	-1172.25	40°23'41.7181"N	104°16'4.3627"W	2.81	
8212.00	89.170	269.200	6078.44	2127.43	-2238.51	-1260.23	40°23'41.6991"N	104°16'5.4997"W	1.45	
8300.00	88.890	268.370	6079.93	2206.96	-2240.37	-1348.20	40°23'41.6807"N	104°16'6.6366"W	1.00	
8388.00	89.290	266.630	6081.33	2287.32	-2244.21	-1436.10	40°23'41.6427"N	104°16'7.7727"W	2.03	
8476.00	89.630	267.040	6082.16	2368.10	-2249.07	-1523.96	40°23'41.5946"N	104°16'8.9083"W	0.61	
8563.00	89.420	266.620	6082.88	2447.97	-2253.88	-1610.82	40°23'41.5470"N	104°16'10.0309"W	0.54	
8650.00	89.290	265.820	6083.86	2528.19	-2259.62	-1697.63	40°23'41.4903"N	104°16'11.1528"W	0.93	
8737.00	89.600	266.720	6084.70	2608.39	-2265.28	-1784.44	40°23'41.4343"N	104°16'12.2748"W	1.09	
8826.00	88.580	266.670	6086.12	2690.16	-2270.41	-1873.28	40°23'41.3836"N	104°16'13.4230"W	1.15	
8914.00	88.770	267.020	6088.15	2770.92	-2275.25	-1961.12	40°23'41.3356"N	104°16'14.5583"W	0.45	
9002.00	88.890	267.150	6089.95	2851.53	-2279.72	-2048.99	40°23'41.2914"N	104°16'15.6939"W	0.20	
9091.00	88.800	267.250	6091.74	2932.99	-2284.07	-2137.87	40°23'41.2483"N	104°16'16.8426"W	0.15	
9180.00	88.770	267.370	6093.63	3014.38	-2288.25	-2226.75	40°23'41.2070"N	104°16'17.9913"W	0.14	
9355.00	89.910	268.190	6095.64	3173.84	-2295.02	-2401.60	40°23'41.1398"N	104°16'20.2512"W	0.80	
9443.00	89.600	267.550	6096.02	3253.98	-2298.29	-2489.54	40°23'41.1074"N	104°16'21.3877"W	0.81	
9532.00	89.600	266.890	6096.64	3335.44	-2302.61	-2578.43	40°23'41.0647"N	104°16'22.5366"W	0.74	
9620.00	89.850	267.310	6097.06	3416.06	-2307.06	-2666.32	40°23'41.0206"N	104°16'23.6724"W	0.56	
9708.00	89.850	267.230	6097.29	3496.58	-2311.25	-2754.22	40°23'40.9791"N	104°16'24.8085"W	0.09	
9797.00	89.630	267.040	6097.70	3578.09	-2315.70	-2843.10	40°23'40.9350"N	104°16'25.9573"W	0.33	
9886.00	90.000	267.600	6097.99	3659.49	-2319.86	-2932.01	40°23'40.8938"N	104°16'27.1063"W	0.75	
9975.00	89.880	268.700	6098.08	3740.36	-2322.74	-3020.96	40°23'40.8653"N	104°16'28.2559"W	1.24	
10063.00	89.750	267.760	6098.36	3820.27	-2325.46	-3108.91	40°23'40.8383"N	104°16'29.3927"W	1.08	
10151.00	89.750	267.920	6098.75	3900.42	-2328.77	-3196.85	40°23'40.8055"N	104°16'30.5292"W	0.18	
10240.00	89.970	268.510	6098.97	3981.25	-2331.54	-3285.81	40°23'40.7780"N	104°16'31.6789"W	0.71	
10328.00	89.690	268.180	6099.23	4061.08	-2334.09	-3373.77	40°23'40.7527"N	104°16'32.8158"W	0.49	
10417.00	90.220	268.210	6099.30	4141.92	-2336.89	-3462.73	40°23'40.7249"N	104°16'33.9655"W	0.60	
10506.00	89.510	268.210	6099.51	4222.75	-2339.67	-3551.68	40°23'40.6973"N	104°16'35.1152"W	0.80	
10595.00	90.090	268.550	6099.82	4303.47	-2342.19	-3640.64	40°23'40.6723"N	104°16'36.2650"W	0.76	
10684.00	89.880	268.370	6099.84	4384.14	-2344.58	-3729.61	40°23'40.6485"N	104°16'37.4148"W	0.31	



Actual Wellpath Report  
STATE ANTELOPE Y44-E14-13HNB AWP  
Page 6 of 8



REFERENCE WELLPATH IDENTIFICATION			
Operator	BONANZA CREEK ENERGY	Well	STATE ANTELOPE Y44-E14-13HNB
Field	WELD COUNTY (NAD83/TRUE)	API/Legal	
Facility	SEC.13-T05N-R62W	Wellbore	STATE ANTELOPE Y44-E14-13HNB AWB
Slot	SLOT#11 STATE ANTELOPE Y44-E14-13HNB (2687'FNL & 510'FEL,SEC.13)		

WELLPATH DATA (133 stations) † = interpolated, ‡ = extrapolated station										
MD [ft]	Inclination [°]	Azimuth [°]	TVD [ft]	Vert Sect [ft]	North [ft]	East [ft]	Latitude	Longitude	DLS [°/100ft]	Comments
10772.00	89.820	268.370	6100.07	4463.96	-2347.08	-3817.58	40°23'40.6237"N	104°16'38.5517"W	0.07	
10859.00	89.750	268.640	6100.40	4542.78	-2349.35	-3904.55	40°23'40.6011"N	104°16'39.6757"W	0.32	
10946.00	90.030	268.890	6100.56	4621.44	-2351.23	-3991.53	40°23'40.5824"N	104°16'40.7998"W	0.43	
11033.00	89.910	268.860	6100.61	4700.03	-2352.93	-4078.51	40°23'40.5654"N	104°16'41.9240"W	0.14	
11120.00	89.320	268.820	6101.19	4778.63	-2354.69	-4165.49	40°23'40.5479"N	104°16'43.0482"W	0.68	
11208.00	89.080	268.810	6102.42	4858.15	-2356.51	-4253.46	40°23'40.5297"N	104°16'44.1852"W	0.27	
11296.00	88.800	268.730	6104.05	4937.70	-2358.40	-4341.43	40°23'40.5109"N	104°16'45.3221"W	0.33	
11386.00	88.950	268.350	6105.82	5019.20	-2360.70	-4431.38	40°23'40.4881"N	104°16'46.4846"W	0.45	
11474.00	88.580	267.550	6107.71	5099.27	-2363.84	-4519.30	40°23'40.4569"N	104°16'47.6210"W	1.00	
11562.00	88.460	267.500	6109.99	5179.60	-2367.64	-4607.19	40°23'40.4192"N	104°16'48.7569"W	0.15	
11651.00	87.320	264.660	6113.26	5261.70	-2373.72	-4695.91	40°23'40.3589"N	104°16'49.9035"W	3.44	
11685.00	87.380	264.500	6114.84	5293.38	-2376.93	-4729.72	40°23'40.3272"N	104°16'50.3405"W	0.50	LAST BH MONOBORE MWD SURVEY (508'FSL & 38'FWL, SEC.13)
11709.00‡	87.380	264.500	6115.93	5315.76	-2379.23	-4753.59	40°23'40.3044"N	104°16'50.6489"W	0.00	PROJECTION TO BIT (506'FSL & 14'FWL, SEC.13)

HOLE & CASING SECTIONS - Ref Wellbore: STATE ANTELOPE Y44-E14-13HNB AWB      Ref Wellpath: STATE ANTELOPE Y44-E14-13HNB AWP									
String/Diameter	Start MD [ft]	End MD [ft]	Interval [ft]	Start TVD [ft]	End TVD [ft]	Start N/S [ft]	Start E/W [ft]	End N/S [ft]	End E/W [ft]
13.5in Open Hole	17.00	1645.00	1628.00	17.00	1592.58	0.00	0.00	-319.10	97.96
9.625in Casing Surface	17.00	1635.00	1618.00	17.00	1583.34	0.00	0.00	-315.52	96.63
8.5in Open Hole	1645.00	11709.00	10064.00	1592.58	6115.93	-319.10	97.96	-2379.23	-4753.59



Actual Wellpath Report

STATE ANTELOPE Y44-E14-13HNB AWP

Page 7 of 8



REFERENCE WELLPATH IDENTIFICATION			
Operator	BONANZA CREEK ENERGY	Well	STATE ANTELOPE Y44-E14-13HNB
Field	WELD COUNTY (NAD83/TRUE)	API/Legal	
Facility	SEC.13-T05N-R62W	Wellbore	STATE ANTELOPE Y44-E14-13HNB AWB
Slot	SLOT#11 STATE ANTELOPE Y44-E14-13HNB (2687'FNL & 510'FEL,SEC.13)		

TARGETS								
Name	TVD [ft]	North [ft]	East [ft]	Grid East [US ft]	Grid North [US ft]	Latitude	Longitude	Shape
SEC.13-T5N-R62W	0.00	100.19	-0.56	3344312.21	1391447.38	40°24'4.8096"N	104°15'49.2192"W	polygon
	2D Polygon: dimensions not calculated							
STATE ANTELOPE Y44-E14-13HNB HARDLINES 480'FSL/1280'FEL, 480'FSL@BHL	0.00	0.00	0.00	3344314.16	1391347.21	40°24'3.8196"N	104°15'49.2120"W	polygon
	2D Polygon: dimensions not calculated							
STATE ANTELOPE Y44-E14-13HNB BHL REV-2 (510'FSL & 10'FWL,SEC.13)	6071.00	-2375.54	-4758.10	3339589.84	1388905.66	40°23'40.3408"N	104°16'50.7073"W	point
STATE ANTELOPE Y44-E14-13HNB LP REV-2 (457'FSL & 470'FEL,SEC.13)	6071.00	-2260.56	54.04	3344399.71	1389087.72	40°23'41.4816"N	104°15'48.5136"W	point
STATE ANTELOPE Y44-E14-13HNB TARGET 1 REV-2 (510'FSL & 1250'FEL,SEC.13)	6071.00	-2234.55	-725.96	3343619.45	1389102.85	40°23'41.7384"N	104°15'58.5946"W	point

WELLPATH COMPOSITION - Ref Wellbore: STATE ANTELOPE Y44-E14-13HNB AWB      Ref Wellpath: STATE ANTELOPE Y44-E14-13HNB AWP					
Start MD [ft]	End MD [ft]	Positional Uncertainty Model	Log Name/Comment	Wellbore	Survey Date
17.00	1590.00	BH NaviTrak (superseded model) (Standard)	BH NaviTrak Surface MWD <123-1590>	STATE ANTELOPE Y44-E14-13HNB AWB	1/9/2020
1590.00	11709.00	BH AutoTrak Curve (Short)	BH ATC MONOBORE MWD SURVEYS <1695-11685>	STATE ANTELOPE Y44-E14-13HNB AWB	1/14/2020



Actual Wellpath Report  
STATE ANTELOPE Y44-E14-13HNB AWP  
Page 8 of 8



REFERENCE WELLPATH IDENTIFICATION			
Operator	BONANZA CREEK ENERGY	Well	STATE ANTELOPE Y44-E14-13HNB
Field	WELD COUNTY (NAD83/TRUE)	API/Legal	
Facility	SEC.13-T05N-R62W	Wellbore	STATE ANTELOPE Y44-E14-13HNB AWB
Slot	SLOT#11 STATE ANTELOPE Y44-E14-13HNB (2687'FNL & 510'FEL,SEC.13)		

WELLPATH COMMENTS				
MD [ft]	Inclination [°]	Azimuth [°]	TVD [ft]	Comment
1590.00	22.590	158.440	1541.77	TIE ONTO BH SURFACE MWD SURVEYS
1695.00	22.300	160.960	1638.82	FIRST BH MONOBORE MWD SURVEY
6891.00	89.820	268.700	6070.99	LANDING POINT (447'FSL & 465'FEL, SEC.13)
11685.00	87.380	264.500	6114.84	LAST BH MONOBORE MWD SURVEY (508'FSL & 38'FWL, SEC.13)
11709.00	87.380	264.500	6115.93	PROJECTION TO BIT (506'FSL & 14'FWL, SEC.13)