

Location:	COLORADO	Slot:	SLOT#10 STATE ANTELOPE X44-D14-13HNC (2667'FNL & 510'FEL,SEC.13)	
Field:	WELD COUNTY (NAD83/TRUE)	Well:	STATE ANTELOPE X44-D14-13HNC	
Facility:	SEC.13-T05N-R62W	Wellbore:	STATE ANTELOPE X44-D14-13HNC PWB	05-123-50292

Plot reference wellpath is STATE ANTELOPE X4-014-13#NC PWP (REV C-0)	Grid System: NAD83 / Lambert Colorado SP, Northern Zone (50), US feet
True vertical depths are referenced to RIG (17) (RKB)	North Reference: True north
Reference wellpath measured depths are referenced to RIG (17) (RKB)	Scale: True distance
RIG (17) (RKB) to Mean Sea Level: 4590 feet	Coordinates are in feet referenced to Slat
Mean Sea Level to Ground level (Alt Slat: SLOTH10 STATE ANTELOPE X4-014-13#NC (2667FNL & 510FEL,SEC.13): 0 feet	Depths are in feet
Other wellpath MDs are referenced to each path's default MD datum	Created by: nbsale01 on 2020-03-04; Database: WellArchitectDB3

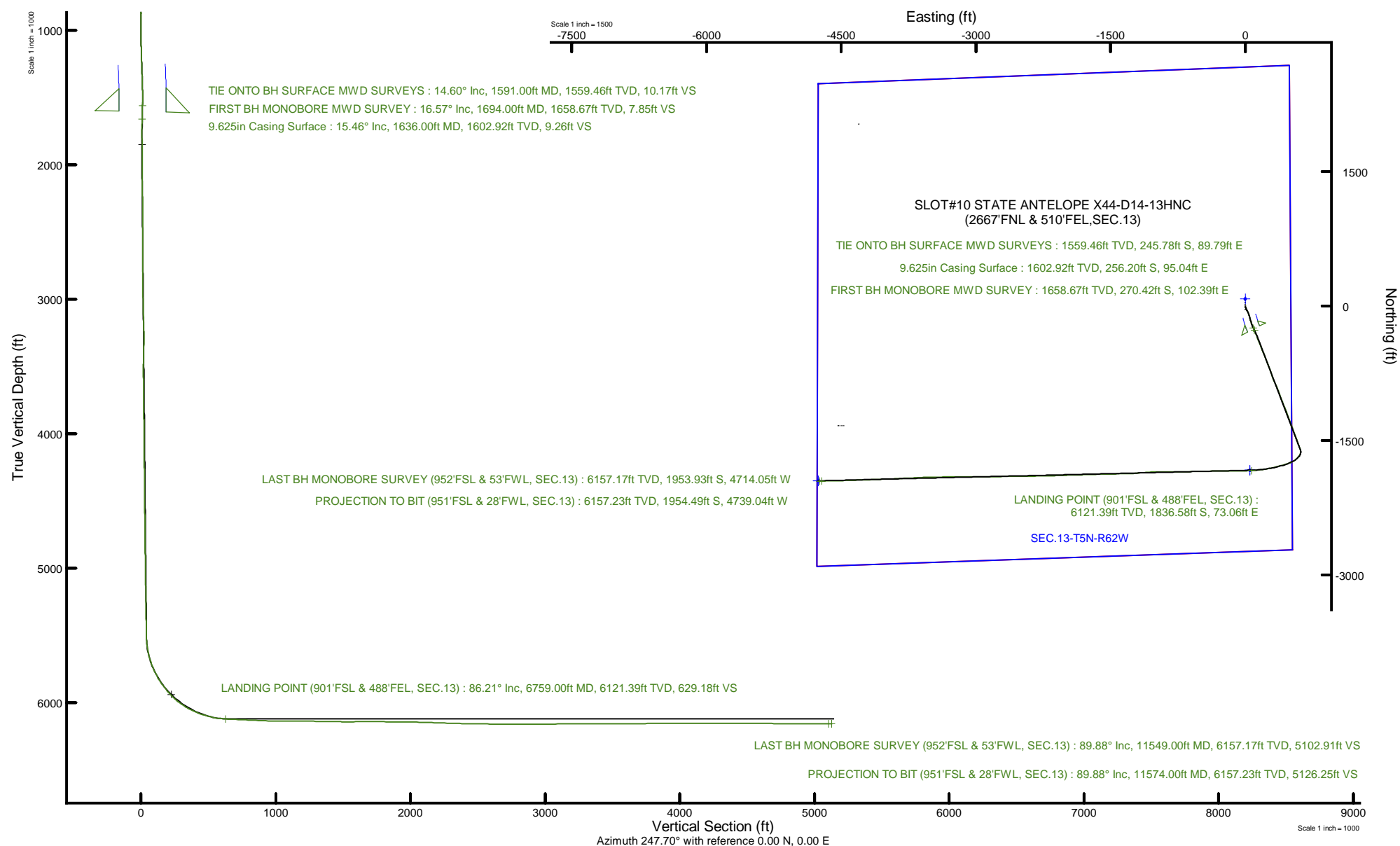



Actual Wellpath Report

STATE ANTELOPE X44-D14-13HNC AWP

Page 1 of 8



REFERENCE WELLPATH IDENTIFICATION			
Operator	BONANZA CREEK ENERGY	Well	STATE ANTELOPE X44-D14-13HNC
Field	WELD COUNTY (NAD83/TRUE)	API/Legal	
Facility	SEC.13-T05N-R62W	Wellbore	STATE ANTELOPE X44-D14-13HNC AWB
Slot	SLOT#10 STATE ANTELOPE X44-D14-13HNC (2667'FNL & 510'FEL,SEC.13)		

REPORT SETUP INFORMATION			
Projection System	NAD83 / Lambert Colorado SP, Northern Zone (501), US feet	Software System	WellArchitect® 6.0
North Reference	True	User	Robiale01
Scale	0.999960	Report Generated	2/26/2020 at 5:46:41 PM
Convergence at slot	0.80° East	Database	WA_DENVER

WELLPATH LOCATION						
	Local coordinates		Grid coordinates		Geographic coordinates	
	North[ft]	East[ft]	Easting[US ft]	Northing[US ft]	Latitude	Longitude
Slot Location	1335.97	4472.71	3344313.61	1391367.24	40°24'4.0176"N	104°15'49.2156"W
Facility Reference Pt			3339859.89	1389969.91	40°23'50.8200"N	104°16'47.0280"W
Field Reference Pt			3224525.77	1254425.87	40°01'44.4000"N	104°41'53.5560"W

WELLPATH DATUM			
Calculation method	Minimum curvature	RIG (17') (RKB) to Facility Vertical Datum	4590.00ft
Horizontal Reference Pt	Slot	RIG (17') (RKB) to Mean Sea Level	4590.00ft
Vertical Reference Pt	RIG (17') (RKB)	RIG (17') (RKB) to Ground Level at Slot (SLOT#10 STATE ANTELOPE X44-D14-13HNC (2667'FNL & 510'FEL,SEC.13))	4590.00ft
MD Reference Pt	RIG (17') (RKB)	Section Origin	N 0.00, E 0.00 ft
Field Vertical Reference	Mean Sea Level	Section Azimuth	247.70°



Actual Wellpath Report
STATE ANTELOPE X44-D14-13HNC AWP
Page 2 of 8



REFERENCE WELLPATH IDENTIFICATION			
Operator	BONANZA CREEK ENERGY	Well	STATE ANTELOPE X44-D14-13HNC
Field	WELD COUNTY (NAD83/TRUE)	API/Legal	
Facility	SEC.13-T05N-R62W	Wellbore	STATE ANTELOPE X44-D14-13HNC AWB
Slot	SLOT#10 STATE ANTELOPE X44-D14-13HNC (2667'FNL & 510'FEL,SEC.13)		

WELLPATH DATA (133 stations) † = interpolated, ‡ = extrapolated station										
MD [ft]	Inclination [°]	Azimuth [°]	TVD [ft]	Vert Sect [ft]	North [ft]	East [ft]	Latitude	Longitude	DLS [°/100ft]	Comments
0.00†	0.000	171.230	0.00	0.00	0.00	0.00	40°24'4.0176"N	104°15'49.2156"W	0.00	
17.00	0.000	171.230	17.00	0.00	0.00	0.00	40°24'4.0176"N	104°15'49.2156"W	0.00	
123.00	0.330	171.230	123.00	0.07	-0.30	0.05	40°24'4.0146"N	104°15'49.2150"W	0.31	
215.00	0.410	177.510	215.00	0.24	-0.89	0.10	40°24'4.0088"N	104°15'49.2143"W	0.10	
308.00	1.800	168.950	307.98	0.64	-2.66	0.40	40°24'3.9913"N	104°15'49.2105"W	1.50	
400.00	4.340	163.440	399.84	1.27	-7.41	1.66	40°24'3.9443"N	104°15'49.1941"W	2.78	
489.00	7.140	160.250	488.38	1.85	-15.85	4.49	40°24'3.8610"N	104°15'49.1575"W	3.17	
578.00	8.220	156.900	576.58	2.01	-26.91	8.86	40°24'3.7517"N	104°15'49.1011"W	1.31	
666.00	8.880	154.430	663.61	1.53	-38.82	14.26	40°24'3.6340"N	104°15'49.0313"W	0.86	
755.00	8.820	153.260	751.55	0.61	-51.11	20.29	40°24'3.5125"N	104°15'48.9533"W	0.21	
843.00	8.540	150.080	838.54	-0.78	-62.80	26.59	40°24'3.3970"N	104°15'48.8719"W	0.63	
931.00	10.290	158.030	925.35	-1.60	-75.75	32.79	40°24'3.2690"N	104°15'48.7918"W	2.47	
1020.00	11.770	160.730	1012.71	-1.07	-91.69	38.76	40°24'3.1115"N	104°15'48.7146"W	1.76	
1108.00	13.220	161.910	1098.62	0.14	-109.73	44.85	40°24'2.9333"N	104°15'48.6359"W	1.67	
1197.00	15.340	164.170	1184.87	2.21	-130.74	51.22	40°24'2.7257"N	104°15'48.5536"W	2.46	
1284.00	17.820	164.130	1268.24	5.00	-154.62	58.00	40°24'2.4897"N	104°15'48.4659"W	2.85	
1372.00	20.200	163.090	1351.44	7.93	-182.11	66.10	40°24'2.2181"N	104°15'48.3612"W	2.73	
1461.00	19.880	160.950	1435.05	10.23	-211.11	75.51	40°24'1.9315"N	104°15'48.2396"W	0.90	
1548.00	15.450	156.050	1517.93	10.73	-235.70	85.05	40°24'1.6885"N	104°15'48.1163"W	5.37	
1591.00	14.600	153.520	1559.46	10.17	-245.78	89.79	40°24'1.5888"N	104°15'48.0550"W	2.50	TIE ONTO BH SURFACE MWD SURVEYS
1694.00	16.570	152.350	1658.67	7.85	-270.42	102.39	40°24'1.3454"N	104°15'47.8921"W	1.94	FIRST BH MONOBORE MWD SURVEY
1783.00	16.660	157.430	1743.96	6.61	-293.44	113.18	40°24'1.1179"N	104°15'47.7527"W	1.63	
1870.00	18.050	160.850	1827.00	7.29	-317.69	122.39	40°24'0.8783"N	104°15'47.6337"W	1.98	
1958.00	20.480	161.390	1910.07	9.03	-345.16	131.78	40°24'0.6068"N	104°15'47.5123"W	2.77	
2045.00	20.450	157.260	1991.58	9.89	-373.61	142.51	40°24'0.3258"N	104°15'47.3736"W	1.66	
2133.00	20.610	157.850	2073.99	9.81	-402.13	154.29	40°24'0.0439"N	104°15'47.2213"W	0.30	
2222.00	20.250	158.380	2157.39	10.03	-430.96	165.87	40°23'59.7590"N	104°15'47.0716"W	0.45	
2308.00	20.790	158.420	2237.93	10.40	-458.98	176.97	40°23'59.4821"N	104°15'46.9282"W	0.63	
2397.00	20.330	157.940	2321.27	10.66	-488.00	188.59	40°23'59.1953"N	104°15'46.7781"W	0.55	
2485.00	20.310	157.880	2403.79	10.77	-516.32	200.08	40°23'58.9155"N	104°15'46.6295"W	0.03	



Actual Wellpath Report
STATE ANTELOPE X44-D14-13HNC AWP
Page 3 of 8



REFERENCE WELLPATH IDENTIFICATION			
Operator	BONANZA CREEK ENERGY	Well	STATE ANTELOPE X44-D14-13HNC
Field	WELD COUNTY (NAD83/TRUE)	API/Legal	
Facility	SEC.13-T05N-R62W	Wellbore	STATE ANTELOPE X44-D14-13HNC AWB
Slot	SLOT#10 STATE ANTELOPE X44-D14-13HNC (2667'FNL & 510'FEL,SEC.13)		

WELLPATH DATA (133 stations)										
MD [ft]	Inclination [°]	Azimuth [°]	TVD [ft]	Vert Sect [ft]	North [ft]	East [ft]	Latitude	Longitude	DLS [°/100ft]	Comments
2574.00	20.120	158.120	2487.31	10.93	-544.83	211.60	40°23'58.6338"N	104°15'46.4806"W	0.23	
2661.00	20.570	158.980	2568.88	11.37	-572.98	222.66	40°23'58.3556"N	104°15'46.3377"W	0.62	
2749.00	20.960	158.640	2651.16	11.98	-602.07	233.93	40°23'58.0681"N	104°15'46.1919"W	0.46	
2839.00	20.210	157.720	2735.42	12.24	-631.45	245.69	40°23'57.7778"N	104°15'46.0400"W	0.91	
2927.00	20.470	158.990	2817.93	12.59	-659.88	256.97	40°23'57.4969"N	104°15'45.8942"W	0.58	
3016.00	19.480	158.150	2901.57	13.06	-688.18	268.07	40°23'57.2172"N	104°15'45.7507"W	1.16	
3103.00	18.370	159.650	2983.87	13.64	-714.50	278.24	40°23'56.9571"N	104°15'45.6193"W	1.39	
3191.00	20.010	162.500	3066.98	15.37	-741.86	287.59	40°23'56.6867"N	104°15'45.4984"W	2.15	
3279.00	20.620	162.450	3149.51	17.91	-771.00	296.79	40°23'56.3989"N	104°15'45.3795"W	0.69	
3367.00	21.520	161.680	3231.62	20.31	-801.10	306.54	40°23'56.1014"N	104°15'45.2535"W	1.07	
3454.00	21.500	155.430	3312.57	20.78	-830.75	318.18	40°23'55.8084"N	104°15'45.1030"W	2.63	
3541.00	21.510	153.870	3393.52	19.08	-859.57	331.84	40°23'55.5237"N	104°15'44.9265"W	0.66	
3629.00	21.160	154.430	3475.49	17.10	-888.38	345.80	40°23'55.2390"N	104°15'44.7461"W	0.46	
3717.00	21.240	159.490	3557.54	16.69	-917.64	358.24	40°23'54.9498"N	104°15'44.5853"W	2.08	
3806.00	21.350	159.190	3640.46	17.61	-947.88	369.64	40°23'54.6510"N	104°15'44.4379"W	0.17	
3894.00	20.790	159.400	3722.58	18.49	-977.47	380.83	40°23'54.3585"N	104°15'44.2933"W	0.64	
3983.00	20.630	159.410	3805.83	19.42	-1006.94	391.90	40°23'54.0674"N	104°15'44.1503"W	0.18	
4072.00	20.760	159.350	3889.08	20.34	-1036.37	402.98	40°23'53.7765"N	104°15'44.0071"W	0.15	
4160.00	20.830	159.290	3971.35	21.22	-1065.60	414.01	40°23'53.4877"N	104°15'43.8645"W	0.08	
4248.00	20.800	159.230	4053.61	22.07	-1094.85	425.08	40°23'53.1987"N	104°15'43.7214"W	0.04	
4337.00	20.720	158.880	4136.83	22.81	-1124.31	436.36	40°23'52.9076"N	104°15'43.5756"W	0.17	
4424.00	20.550	158.780	4218.25	23.42	-1152.90	447.43	40°23'52.6250"N	104°15'43.4325"W	0.20	
4511.00	19.890	158.600	4299.89	23.93	-1180.91	458.36	40°23'52.3482"N	104°15'43.2913"W	0.76	
4600.00	19.520	159.510	4383.67	24.64	-1208.94	469.09	40°23'52.0713"N	104°15'43.1526"W	0.54	
4687.00	20.540	159.940	4465.41	25.69	-1236.89	479.41	40°23'51.7951"N	104°15'43.0192"W	1.18	
4775.00	20.150	159.080	4547.92	26.66	-1265.55	490.12	40°23'51.5119"N	104°15'42.8808"W	0.56	
4863.00	20.440	159.160	4630.46	27.41	-1294.07	501.00	40°23'51.2300"N	104°15'42.7402"W	0.33	
4950.00	20.080	159.570	4712.08	28.29	-1322.26	511.62	40°23'50.9514"N	104°15'42.6030"W	0.44	
5039.00	19.750	159.230	4795.75	29.18	-1350.64	522.28	40°23'50.6710"N	104°15'42.4652"W	0.39	
5125.00	19.040	159.960	4876.87	30.12	-1377.40	532.24	40°23'50.4065"N	104°15'42.3364"W	0.87	



Actual Wellpath Report
STATE ANTELOPE X44-D14-13HNC AWP
Page 4 of 8



REFERENCE WELLPATH IDENTIFICATION			
Operator	BONANZA CREEK ENERGY	Well	STATE ANTELOPE X44-D14-13HNC
Field	WELD COUNTY (NAD83/TRUE)	API/Legal	
Facility	SEC.13-T05N-R62W	Wellbore	STATE ANTELOPE X44-D14-13HNC AWB
Slot	SLOT#10 STATE ANTELOPE X44-D14-13HNC (2667'FNL & 510'FEL,SEC.13)		

WELLPATH DATA (133 stations) † = interpolated, ‡ = extrapolated station										
MD [ft]	Inclination [°]	Azimuth [°]	TVD [ft]	Vert Sect [ft]	North [ft]	East [ft]	Latitude	Longitude	DLS [°/100ft]	Comments
5213.00	20.440	160.120	4959.70	31.34	-1405.34	542.39	40°23'50.1305"N	104°15'42.2053"W	1.59	
5301.00	20.350	159.320	5042.18	32.41	-1434.11	553.02	40°23'49.8462"N	104°15'42.0680"W	0.33	
5390.00	20.130	160.520	5125.69	33.60	-1463.02	563.59	40°23'49.5605"N	104°15'41.9313"W	0.53	
5479.00	20.160	160.330	5209.24	35.06	-1491.90	573.86	40°23'49.2751"N	104°15'41.7986"W	0.08	
5567.00	20.330	158.810	5291.81	36.05	-1520.43	584.49	40°23'48.9931"N	104°15'41.6612"W	0.63	
5655.00	20.350	159.670	5374.32	36.87	-1549.04	595.33	40°23'48.7105"N	104°15'41.5211"W	0.34	
5744.00	20.280	159.240	5457.78	37.81	-1577.97	606.17	40°23'48.4246"N	104°15'41.3810"W	0.19	
5832.00	20.390	165.940	5540.31	40.42	-1607.10	615.30	40°23'48.1367"N	104°15'41.2630"W	2.65	
5920.00	21.600	189.450	5622.61	51.16	-1638.01	616.37	40°23'47.8313"N	104°15'41.2492"W	9.61	
6008.00	22.760	214.210	5704.28	73.92	-1668.13	604.11	40°23'47.5337"N	104°15'41.4076"W	10.63	
6097.00	28.860	223.670	5784.40	107.94	-1697.94	579.57	40°23'47.2391"N	104°15'41.7248"W	8.25	
6186.00	35.720	235.470	5859.66	153.05	-1728.27	543.25	40°23'46.9394"N	104°15'42.1942"W	10.44	
6274.00	41.530	250.700	5928.54	207.46	-1752.55	494.41	40°23'46.6994"N	104°15'42.8256"W	12.62	
6361.00	50.600	254.290	5988.85	269.79	-1771.23	434.69	40°23'46.5149"N	104°15'43.5973"W	10.84	
6449.00	60.710	255.160	6038.44	341.81	-1790.31	364.69	40°23'46.3263"N	104°15'44.5022"W	11.52	
6538.00	69.100	258.080	6076.16	421.34	-1808.88	286.34	40°23'46.1429"N	104°15'45.5148"W	9.88	
6626.00	75.630	261.580	6102.81	503.26	-1823.63	203.84	40°23'45.9971"N	104°15'46.5810"W	8.33	
6714.00	84.700	265.190	6117.83	586.63	-1833.57	117.82	40°23'45.8989"N	104°15'47.6929"W	11.07	
6759.00†	86.212	267.101	6121.39	629.18	-1836.58	73.06	40°23'45.8692"N	104°15'48.2713"W	5.40	LANDING POINT (901'FSL & 488'FEL, SEC.13)
6802.00	87.660	268.920	6123.69	669.45	-1838.07	30.15	40°23'45.8544"N	104°15'48.8259"W	5.40	
6890.00	87.600	269.460	6127.33	751.26	-1839.32	-57.76	40°23'45.8421"N	104°15'49.9622"W	0.62	
6979.00	87.600	269.470	6131.06	833.85	-1840.15	-146.68	40°23'45.8339"N	104°15'51.1114"W	0.01	
7068.00	87.480	269.170	6134.88	916.51	-1841.20	-235.59	40°23'45.8235"N	104°15'52.2606"W	0.36	
7157.00	89.630	269.230	6137.12	999.29	-1842.44	-324.55	40°23'45.8112"N	104°15'53.4103"W	2.42	
7244.00	89.970	269.330	6137.43	1080.19	-1843.54	-411.54	40°23'45.8004"N	104°15'54.5346"W	0.41	
7332.00	90.000	269.490	6137.45	1161.95	-1844.44	-499.54	40°23'45.7914"N	104°15'55.6720"W	0.18	
7420.00	89.140	267.000	6138.11	1244.35	-1847.14	-587.49	40°23'45.7648"N	104°15'56.8087"W	2.99	
7507.00	89.110	269.150	6139.44	1325.90	-1850.06	-674.42	40°23'45.7359"N	104°15'57.9323"W	2.47	
7596.00	89.020	270.040	6140.89	1408.47	-1850.69	-763.41	40°23'45.7296"N	104°15'59.0824"W	1.00	
7683.00	89.170	270.750	6142.27	1488.72	-1850.09	-850.39	40°23'45.7355"N	104°16'0.2066"W	0.83	



Actual Wellpath Report
STATE ANTELOPE X44-D14-13HNC AWP
Page 5 of 8



REFERENCE WELLPATH IDENTIFICATION			
Operator	BONANZA CREEK ENERGY	Well	STATE ANTELOPE X44-D14-13HNC
Field	WELD COUNTY (NAD83/TRUE)	API/Legal	
Facility	SEC.13-T05N-R62W	Wellbore	STATE ANTELOPE X44-D14-13HNC AWB
Slot	SLOT#10 STATE ANTELOPE X44-D14-13HNC (2667'FNL & 510'FEL,SEC.13)		

WELLPATH DATA (133 stations)										
MD [ft]	Inclination [°]	Azimuth [°]	TVD [ft]	Vert Sect [ft]	North [ft]	East [ft]	Latitude	Longitude	DLS [°/100ft]	Comments
7771.00	90.650	269.970	6142.40	1569.93	-1849.54	-938.39	40°23'45.7410"N	104°16'1.3439"W	1.90	
7858.00	90.310	267.020	6141.67	1651.25	-1851.82	-1025.35	40°23'45.7184"N	104°16'2.4678"W	3.41	
8034.00	89.230	264.170	6142.38	1818.72	-1865.34	-1200.81	40°23'45.5847"N	104°16'4.7355"W	1.73	
8123.00	89.970	268.420	6143.00	1903.05	-1871.09	-1289.60	40°23'45.5279"N	104°16'5.8831"W	4.85	
8211.00	88.890	269.510	6143.88	1985.06	-1872.68	-1377.57	40°23'45.5121"N	104°16'7.0202"W	1.74	
8299.00	88.400	269.230	6145.96	2066.82	-1873.64	-1465.54	40°23'45.5025"N	104°16'8.1572"W	0.64	
8387.00	88.370	268.450	6148.44	2148.86	-1875.42	-1553.49	40°23'45.4849"N	104°16'9.2938"W	0.89	
8475.00	88.210	268.290	6151.07	2231.16	-1877.93	-1641.42	40°23'45.4601"N	104°16'10.4302"W	0.26	
8562.00	88.280	268.110	6153.73	2312.62	-1880.66	-1728.33	40°23'45.4330"N	104°16'11.5536"W	0.22	
8649.00	88.980	268.420	6155.81	2394.05	-1883.29	-1815.27	40°23'45.4069"N	104°16'12.6772"W	0.88	
8736.00	89.080	268.390	6157.28	2475.42	-1885.71	-1902.22	40°23'45.3830"N	104°16'13.8010"W	0.12	
8825.00	89.200	267.960	6158.62	2558.79	-1888.55	-1991.17	40°23'45.3549"N	104°16'14.9506"W	0.50	
8913.00	89.970	267.790	6159.26	2641.39	-1891.81	-2079.10	40°23'45.3226"N	104°16'16.0871"W	0.90	
9001.00	90.180	268.300	6159.14	2723.91	-1894.81	-2167.05	40°23'45.2928"N	104°16'17.2238"W	0.63	
9090.00	89.850	268.860	6159.12	2807.06	-1897.02	-2256.02	40°23'45.2710"N	104°16'18.3738"W	0.73	
9179.00	90.030	269.040	6159.21	2890.01	-1898.65	-2345.01	40°23'45.2548"N	104°16'19.5239"W	0.29	
9266.00	90.120	269.270	6159.10	2970.99	-1899.93	-2432.00	40°23'45.2420"N	104°16'20.6482"W	0.28	
9354.00	89.970	268.490	6159.03	3053.05	-1901.65	-2519.98	40°23'45.2249"N	104°16'21.7853"W	0.90	
9442.00	90.740	269.910	6158.48	3134.92	-1902.88	-2607.97	40°23'45.2127"N	104°16'22.9225"W	1.84	
9531.00	90.220	269.640	6157.74	3217.39	-1903.23	-2696.96	40°23'45.2091"N	104°16'24.0727"W	0.66	
9619.00	89.820	269.280	6157.71	3299.13	-1904.06	-2784.96	40°23'45.2008"N	104°16'25.2100"W	0.61	
9707.00	90.030	269.270	6157.82	3380.96	-1905.17	-2872.95	40°23'45.1897"N	104°16'26.3473"W	0.24	
9796.00	90.550	270.710	6157.37	3463.31	-1905.19	-2961.95	40°23'45.1895"N	104°16'27.4975"W	1.72	
9885.00	90.460	270.300	6156.59	3545.35	-1904.40	-3050.94	40°23'45.1971"N	104°16'28.6477"W	0.47	
9974.00	90.180	269.480	6156.09	3627.76	-1904.57	-3139.94	40°23'45.1953"N	104°16'29.7980"W	0.97	
10062.00	90.250	269.260	6155.76	3709.54	-1905.54	-3227.93	40°23'45.1856"N	104°16'30.9353"W	0.26	
10150.00	90.340	268.660	6155.31	3791.56	-1907.14	-3315.92	40°23'45.1697"N	104°16'32.0724"W	0.69	
10239.00	90.340	268.990	6154.78	3874.58	-1908.96	-3404.90	40°23'45.1516"N	104°16'33.2225"W	0.37	
10327.00	90.550	269.080	6154.09	3956.55	-1910.44	-3492.88	40°23'45.1368"N	104°16'34.3596"W	0.26	
10416.00	90.120	267.510	6153.57	4039.86	-1913.09	-3581.84	40°23'45.1105"N	104°16'35.5093"W	1.83	



Actual Wellpath Report
STATE ANTELOPE X44-D14-13HNC AWP
Page 6 of 8



REFERENCE WELLPATH IDENTIFICATION			
Operator	BONANZA CREEK ENERGY	Well	STATE ANTELOPE X44-D14-13HNC
Field	WELD COUNTY (NAD83/TRUE)	API/Legal	
Facility	SEC.13-T05N-R62W	Wellbore	STATE ANTELOPE X44-D14-13HNC AWB
Slot	SLOT#10 STATE ANTELOPE X44-D14-13HNC (2667'FNL & 510'FEL,SEC.13)		

WELLPATH DATA (133 stations) † = interpolated, ‡ = extrapolated station										
MD [ft]	Inclination [°]	Azimuth [°]	TVD [ft]	Vert Sect [ft]	North [ft]	East [ft]	Latitude	Longitude	DLS [°/100ft]	Comments
10505.00	89.660	267.540	6153.75	4123.58	-1916.94	-3670.75	40°23'45.0724"N	104°16'36.6585"W	0.52	
10594.00	89.750	267.250	6154.20	4207.38	-1920.98	-3759.66	40°23'45.0323"N	104°16'37.8076"W	0.34	
10771.00	89.940	267.620	6154.68	4373.98	-1928.90	-3936.48	40°23'44.9538"N	104°16'40.0929"W	0.23	
10858.00	90.250	268.100	6154.54	4455.66	-1932.15	-4023.42	40°23'44.9215"N	104°16'41.2166"W	0.66	
10945.00	89.570	267.190	6154.67	4537.44	-1935.73	-4110.35	40°23'44.8861"N	104°16'42.3400"W	1.31	
11032.00	89.750	267.970	6155.19	4619.25	-1939.40	-4197.27	40°23'44.8496"N	104°16'43.4634"W	0.92	
11119.00	89.540	268.470	6155.73	4700.73	-1942.10	-4284.22	40°23'44.8228"N	104°16'44.5873"W	0.62	
11207.00	89.630	267.670	6156.37	4783.23	-1945.07	-4372.17	40°23'44.7933"N	104°16'45.7240"W	0.91	
11295.00	89.910	268.440	6156.72	4865.74	-1948.05	-4460.12	40°23'44.7637"N	104°16'46.8607"W	0.93	
11385.00	89.750	268.640	6156.99	4949.85	-1950.35	-4550.09	40°23'44.7408"N	104°16'48.0235"W	0.28	
11473.00	90.060	268.830	6157.13	5031.99	-1952.29	-4638.06	40°23'44.7215"N	104°16'49.1606"W	0.41	
11549.00	89.880	268.700	6157.17	5102.91	-1953.93	-4714.05	40°23'44.7052"N	104°16'50.1426"W	0.29	LAST BH MONOBORE SURVEY (952'FSL & 53'FWL, SEC.13)
11574.00‡	89.880	268.700	6157.23	5126.25	-1954.49	-4739.04	40°23'44.6995"N	104°16'50.4656"W	0.00	PROJECTION TO BIT (951'FSL & 28'FWL, SEC.13)

HOLE & CASING SECTIONS - Ref Wellbore: STATE ANTELOPE X44-D14-13HNC AWB Ref Wellpath: STATE ANTELOPE X44-D14-13HNC AWP									
String/Diameter	Start MD [ft]	End MD [ft]	Interval [ft]	Start TVD [ft]	End TVD [ft]	Start N/S [ft]	Start E/W [ft]	End N/S [ft]	End E/W [ft]
13.5in Open Hole	17.00	1646.00	1629.00	17.00	1612.56	0.00	0.00	-258.59	96.26
9.625in Casing Surface	17.00	1636.00	1619.00	17.00	1602.92	0.00	0.00	-256.20	95.04
8.5in Open Hole	1646.00	11574.00	9928.00	1612.56	6157.23	-258.59	96.26	-1954.49	-4739.04



Actual Wellpath Report

STATE ANTELOPE X44-D14-13HNC AWP

Page 7 of 8



REFERENCE WELLPATH IDENTIFICATION			
Operator	BONANZA CREEK ENERGY	Well	STATE ANTELOPE X44-D14-13HNC
Field	WELD COUNTY (NAD83/TRUE)	API/Legal	
Facility	SEC.13-T05N-R62W	Wellbore	STATE ANTELOPE X44-D14-13HNC AWB
Slot	SLOT#10 STATE ANTELOPE X44-D14-13HNC (2667'FNL & 510'FEL,SEC.13)		

TARGETS								
Name	TVD [ft]	North [ft]	East [ft]	Grid East [US ft]	Grid North [US ft]	Latitude	Longitude	Shape
SEC.13-T5N-R62W	0.00	80.15	-0.28	3344312.21	1391447.38	40°24'4.8096"N	104°15'49.2192"W	polygon
	2D Polygon: dimensions not calculated							
STATE ANTELOPE X44-D14-13HNC BHL REV-1 (955'FSL & 10'FWL,SEC.13)	6050.00	-1950.43	-4756.62	3339584.84	1389350.77	40°23'44.7396"N	104°16'50.6928"W	point
STATE ANTELOPE X44-D14-13HNC LP REV-1 (905'FSL & 470'FEL,SEC.13)	6050.00	-1832.49	51.53	3344390.68	1389535.73	40°23'45.9096"N	104°15'48.5496"W	point
STATE ANTELOPE X44-D14-13HNC BHL REV-2 (955'FSL & 10'FWL,SEC.13)_copy	6121.00	-1950.43	-4756.62	3339584.84	1389350.77	40°23'44.7396"N	104°16'50.6928"W	point
STATE ANTELOPE X44-D14-13HNC LP REV-2 (905'FSL & 470'FEL,SEC.13)_copy	6121.00	-1832.49	51.53	3344390.68	1389535.73	40°23'45.9096"N	104°15'48.5496"W	point

WELLPATH COMPOSITION - Ref Wellbore: STATE ANTELOPE X44-D14-13HNC AWB Ref Wellpath: STATE ANTELOPE X44-D14-13HNC AWP					
Start MD [ft]	End MD [ft]	Positional Uncertainty Model	Log Name/Comment	Wellbore	Survey Date
17.00	1591.00	BHI NaviTrak (Rotating)	BH NaviTrak Surface MWD <123-1591>	STATE ANTELOPE X44-D14-13HNC AWB	1/8/2020
1591.00	11574.00	BH AutoTrak Curve (Short)	BH Monobore MWD Surveys <1694-11549>	STATE ANTELOPE X44-D14-13HNC AWB	1/18/2020



Actual Wellpath Report

STATE ANTELOPE X44-D14-13HNC AWP

Page 8 of 8



REFERENCE WELLPATH IDENTIFICATION			
Operator	BONANZA CREEK ENERGY	Well	STATE ANTELOPE X44-D14-13HNC
Field	WELD COUNTY (NAD83/TRUE)	API/Legal	
Facility	SEC.13-T05N-R62W	Wellbore	STATE ANTELOPE X44-D14-13HNC AWB
Slot	SLOT#10 STATE ANTELOPE X44-D14-13HNC (2667'FNL & 510'FEL,SEC.13)		

WELLPATH COMMENTS				
MD [ft]	Inclination [°]	Azimuth [°]	TVD [ft]	Comment
1591.00	14.600	153.520	1559.46	TIE ONTO BH SURFACE MWD SURVEYS
1694.00	16.570	152.350	1658.67	FIRST BH MONOBORE MWD SURVEY
6759.00	86.212	267.101	6121.39	LANDING POINT (901'FSL & 488'FEL, SEC.13)
11549.00	89.880	268.700	6157.17	LAST BH MONOBORE SURVEY (952'FSL & 53'FWL, SEC.13)
11574.00	89.880	268.700	6157.23	PROJECTION TO BIT (951'FSL & 28'FWL, SEC.13)