

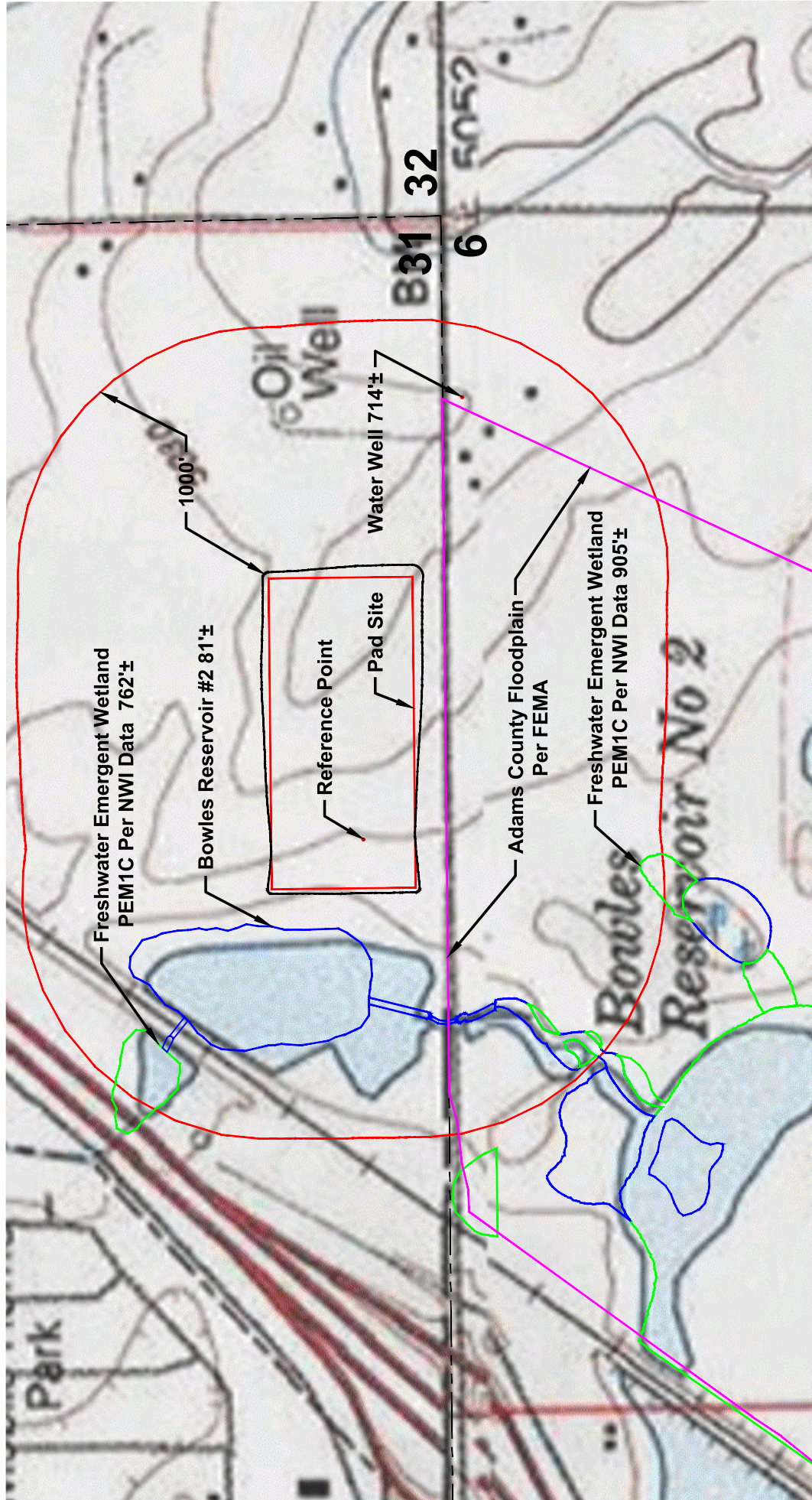

HYDROLOGY MAP
SW 1/4 SE 1/4 SECTION 31
T1N R65W 6TH PM
WELD COUNTY, COLORADO

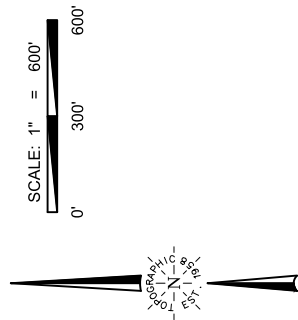

VERDAD RESOURCES

COUNTY LINE PAD

JOB NO. 116941, 116940

118679

MAPP

MARCH 30, 2020

SHEET: 1 OF 1

FZA_COUNTYLINE_3107_3112_3130_HYDRO_REV1

REVISION:

INT	DATE

NOTE:

ALL PRODUCTION FACILITIES WILL BE ON PAD

TOPOGRAPHIC

LOYALTY INNOVATION LEGACY

520 Stacy Court Ste B, Lafayette, CO 80026

303.666.0379 www.topographic.com

G:\GEO SURV\WELD\NORTH\VERDAD\COUNTY LINE 3112\FINAL PRODUCT\SI2\FZA_COUNTYLINE_3107_3112_3130_HYDRO_REV1.DWG 3/30/2020 3:31:42 PM wmap