

FIFTH CREEK ENERGY

Location: COLORADO Slot: SLOT#03 CRITTER CREEK #202-1807H (205'FSL & 828'FWL, SEC.18)
 Field: WELD COUNTY (NAD 83 / TN) Well: CRITTER CREEK #202-1807H
 Facility: SEC.18-T11N-R63W Wellbore: CRITTER CREEK #202-1807H PWB

Plot reference wellpath is CRITTER CREEK #202-1807H PWP (REV-D.0)	Grid System: NAD83 / Lambert Colorado SP, Northern Zone (601), US feet
True vertical depths are referenced to UNIT 406 (21KB) (RKB)	* = Wellpath was transformed from a different geodetic datum
Measured depths are referenced to UNIT 406 (21KB) (RKB)	North Reference: True north
UNIT 406 (21KB) (RKB) to Mean Sea Level: 5357 feet	Scale: True distance
Mean Sea Level to Mud line (At Slot: SLOT#03 CRITTER CREEK #202-1807H (215'FSL & 828'FWL, SEC.18)): 0 feet	Depths are in feet
Coordinates are in feet referenced to Slot	Created by: ingnjamr on 2017-12-04

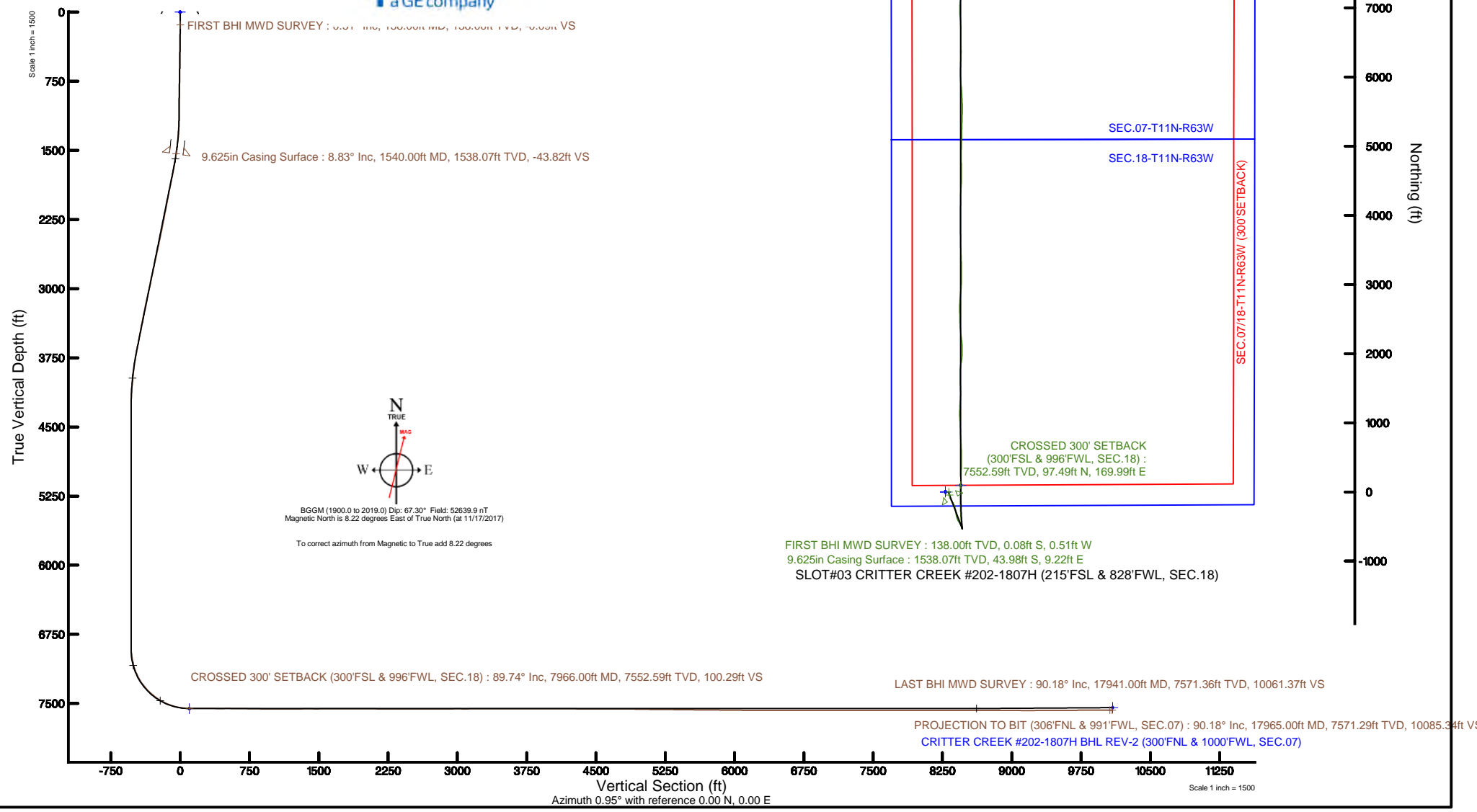



Actual Wellpath Report

CRITTER CREEK #202-1807H AWP

Page 1 of 10



REFERENCE WELLPATH IDENTIFICATION			
Operator	FIFTH CREEK ENERGY	Slot	SLOT#03 CRITTER CREEK #202-1807H (215'FSL & 828'FWL, SEC.18)
Area	COLORADO	Well	CRITTER CREEK #202-1807H
Field	WELD COUNTY (NAD 83 / TN)	Wellbore	CRITTER CREEK #202-1807H AWB
Facility	SEC.18-T11N-R63W		

REPORT SETUP INFORMATION			
Projection System	NAD83 / Lambert Colorado SP, Northern Zone (501), US feet	Software System	WellArchitect® 5.0
North Reference	True	User	Ingmjmr
Scale	1.000024	Report Generated	12/4/2017 at 1:39:46 PM
Convergence at slot	0.66° East	Database/Source file	Denver/CRITTER_CREEK_#202-1807H_AWP.xml

WELLPATH LOCATION						
	Local coordinates		Grid coordinates		Geographic coordinates	
	North[ft]	East[ft]	Easting[US ft]	Northing[US ft]	Latitude	Longitude
Slot Location	0.00	49.90	3281266.54	1578010.88	40°54'56.080"N	104°28'56.430"W
Facility Reference Pt			3281216.64	1578010.30	40°54'56.080"N	104°28'57.080"W
Field Reference Pt			3310982.01	1578058.18	40°54'53.000"N	104°22'29.410"W

WELLPATH DATUM			
Calculation method	Minimum curvature	UNIT 406 (21'KB) (RKB) to Facility Vertical Datum	5357.00ft
Horizontal Reference Pt	Slot	UNIT 406 (21'KB) (RKB) to Mean Sea Level	5357.00ft
Vertical Reference Pt	UNIT 406 (21'KB) (RKB)	UNIT 406 (21'KB) (RKB) to Mud Line at Slot (SLOT#03 CRITTER CREEK #202-1807H (215'FSL & 828'FWL, SEC.18))	5357.00ft
MD Reference Pt	UNIT 406 (21'KB) (RKB)	Section Origin	N 0.00, E 0.00 ft
Field Vertical Reference	Mean Sea Level	Section Azimuth	0.95°



Actual Wellpath Report

CRITTER CREEK #202-1807H AWP
Page 2 of 10



REFERENCE WELLPATH IDENTIFICATION			
Operator	FIFTH CREEK ENERGY	Slot	SLOT#03 CRITTER CREEK #202-1807H (215'FSL & 828'FWL, SEC.18)
Area	COLORADO	Well	CRITTER CREEK #202-1807H
Field	WELD COUNTY (NAD 83 / TN)	Wellbore	CRITTER CREEK #202-1807H AWB
Facility	SEC.18-T11N-R63W		

WELLPATH DATA (193 stations) † = interpolated/extrapolated station										
MD [ft]	Inclination [°]	Azimuth [°]	TVD [ft]	Vert Sect [ft]	North [ft]	East [ft]	Latitude	Longitude	DLS [°/100ft]	Comments
0.00†	0.000	261.190	0.00	0.00	0.00	0.00	40°54'56.080"N	104°28'56.430"W	0.00	
21.00	0.000	261.190	21.00	0.00	0.00	0.00	40°54'56.080"N	104°28'56.430"W	0.00	
138.00	0.510	261.190	138.00	-0.09	-0.08	-0.51	40°54'56.079"N	104°28'56.437"W	0.44	FIRST BHI MWD SURVEY
231.00	1.050	244.650	230.99	-0.54	-0.51	-1.69	40°54'56.075"N	104°28'56.452"W	0.62	
326.00	1.280	233.360	325.97	-1.57	-1.51	-3.33	40°54'56.065"N	104°28'56.473"W	0.34	
420.00	1.080	224.660	419.95	-2.85	-2.77	-4.80	40°54'56.053"N	104°28'56.492"W	0.29	
514.00	1.440	239.460	513.93	-4.11	-4.00	-6.44	40°54'56.040"N	104°28'56.514"W	0.51	
608.00	1.240	137.170	607.91	-5.46	-5.35	-6.76	40°54'56.027"N	104°28'56.518"W	2.22	
703.00	1.570	130.090	702.88	-7.02	-6.94	-5.07	40°54'56.011"N	104°28'56.496"W	0.39	
797.00	1.350	136.870	796.85	-8.63	-8.58	-3.33	40°54'55.995"N	104°28'56.473"W	0.30	
891.00	1.340	129.350	890.83	-10.11	-10.08	-1.72	40°54'55.980"N	104°28'56.452"W	0.19	
987.00	0.510	129.440	986.81	-11.07	-11.06	-0.52	40°54'55.971"N	104°28'56.437"W	0.86	
1083.00	0.540	109.430	1082.81	-11.48	-11.49	0.24	40°54'55.967"N	104°28'56.427"W	0.19	
1177.00	1.660	181.840	1176.79	-12.98	-12.99	0.61	40°54'55.952"N	104°28'56.422"W	1.68	
1272.00	2.980	173.570	1271.71	-16.81	-16.82	0.84	40°54'55.914"N	104°28'56.419"W	1.43	
1366.00	5.160	161.060	1365.47	-23.21	-23.25	2.49	40°54'55.850"N	104°28'56.398"W	2.49	
1460.00	7.450	162.410	1458.90	-32.96	-33.06	5.70	40°54'55.753"N	104°28'56.356"W	2.44	
1493.00	8.230	162.080	1491.59	-37.22	-37.35	7.08	40°54'55.711"N	104°28'56.338"W	2.37	
1601.00	9.620	162.270	1598.28	-53.09	-53.30	12.20	40°54'55.553"N	104°28'56.271"W	1.29	
1697.00	10.910	162.570	1692.74	-69.31	-69.61	17.37	40°54'55.392"N	104°28'56.204"W	1.34	
1792.00	12.330	163.840	1785.79	-87.54	-87.93	22.88	40°54'55.211"N	104°28'56.132"W	1.52	
1887.00	12.300	158.800	1878.61	-106.60	-107.10	29.37	40°54'55.022"N	104°28'56.048"W	1.13	
1981.00	12.310	152.400	1970.45	-124.68	-125.32	37.63	40°54'54.842"N	104°28'55.940"W	1.45	
2075.00	12.370	149.620	2062.28	-142.08	-142.89	47.36	40°54'54.668"N	104°28'55.813"W	0.64	
2171.00	12.380	151.890	2156.05	-159.86	-160.83	57.41	40°54'54.491"N	104°28'55.682"W	0.51	
2265.00	12.230	152.360	2247.89	-177.41	-178.54	66.78	40°54'54.316"N	104°28'55.560"W	0.19	
2361.00	12.550	158.180	2341.66	-195.96	-197.23	75.37	40°54'54.131"N	104°28'55.448"W	1.34	
2456.00	12.380	160.520	2434.42	-215.02	-216.42	82.61	40°54'53.942"N	104°28'55.354"W	0.56	
2552.00	12.330	165.530	2528.20	-234.54	-236.04	88.60	40°54'53.748"N	104°28'55.276"W	1.12	
2646.00	12.420	168.350	2620.02	-254.08	-255.66	93.15	40°54'53.554"N	104°28'55.217"W	0.65	



Actual Wellpath Report

CRITTER CREEK #202-1807H AWP

Page 3 of 10



REFERENCE WELLPATH IDENTIFICATION			
Operator	FIFTH CREEK ENERGY	Slot	SLOT#03 CRITTER CREEK #202-1807H (215'FSL & 828'FWL, SEC.18)
Area	COLORADO	Well	CRITTER CREEK #202-1807H
Field	WELD COUNTY (NAD 83 / TN)	Wellbore	CRITTER CREEK #202-1807H AWB
Facility	SEC.18-T11N-R63W		

WELLPATH DATA (193 stations)										
MD [ft]	Inclination [°]	Azimuth [°]	TVD [ft]	Vert Sect [ft]	North [ft]	East [ft]	Latitude	Longitude	DLS [°/100ft]	Comments
2742.00	12.370	167.820	2713.78	-274.17	-275.83	97.40	40°54'53.355"N	104°28'55.161"W	0.13	
2836.00	12.460	170.290	2805.58	-293.94	-295.66	101.24	40°54'53.159"N	104°28'55.111"W	0.57	
2931.00	12.550	168.840	2898.33	-314.11	-315.89	104.96	40°54'52.959"N	104°28'55.063"W	0.34	
3026.00	12.520	170.970	2991.07	-334.34	-336.19	108.58	40°54'52.758"N	104°28'55.016"W	0.49	
3121.00	12.650	165.600	3083.79	-354.51	-356.43	112.78	40°54'52.558"N	104°28'54.961"W	1.24	
3215.00	12.380	161.330	3175.55	-373.93	-375.95	118.57	40°54'52.365"N	104°28'54.886"W	1.03	
3310.00	12.600	157.670	3268.31	-393.04	-395.18	125.76	40°54'52.175"N	104°28'54.792"W	0.86	
3405.00	12.670	152.790	3361.01	-411.75	-414.03	134.46	40°54'51.989"N	104°28'54.679"W	1.13	
3501.00	12.340	146.350	3454.74	-429.47	-431.93	144.96	40°54'51.812"N	104°28'54.542"W	1.49	
3596.00	12.380	149.680	3547.54	-446.53	-449.18	155.73	40°54'51.642"N	104°28'54.402"W	0.75	
3691.00	12.510	154.110	3640.31	-464.42	-467.22	165.36	40°54'51.463"N	104°28'54.276"W	1.01	
3786.00	10.750	152.210	3733.35	-481.37	-484.32	173.99	40°54'51.295"N	104°28'54.164"W	1.90	
3882.00	9.130	154.930	3827.91	-496.06	-499.14	181.39	40°54'51.148"N	104°28'54.067"W	1.76	
3977.00	6.810	160.470	3921.99	-508.12	-511.28	186.47	40°54'51.028"N	104°28'54.001"W	2.57	
4072.00	6.150	174.420	4016.38	-518.45	-521.65	188.84	40°54'50.926"N	104°28'53.970"W	1.79	
4166.00	3.690	170.670	4110.03	-526.43	-529.65	189.82	40°54'50.847"N	104°28'53.958"W	2.64	
4261.00	2.030	131.900	4204.92	-530.54	-533.79	191.57	40°54'50.806"N	104°28'53.935"W	2.59	
4356.00	0.340	321.880	4299.90	-531.42	-534.69	192.65	40°54'50.797"N	104°28'53.921"W	2.49	
4450.00	0.140	40.580	4393.90	-531.12	-534.38	192.55	40°54'50.800"N	104°28'53.922"W	0.36	
4545.00	0.060	140.460	4488.90	-531.07	-534.33	192.66	40°54'50.800"N	104°28'53.921"W	0.17	
4639.00	0.000	8.230	4582.90	-531.11	-534.37	192.69	40°54'50.800"N	104°28'53.920"W	0.06	
4733.00	0.130	102.180	4676.90	-531.13	-534.40	192.80	40°54'50.800"N	104°28'53.919"W	0.14	
4828.00	0.000	8.230	4771.90	-531.15	-534.42	192.90	40°54'50.800"N	104°28'53.917"W	0.14	
4923.00	0.030	237.220	4866.90	-531.16	-534.43	192.88	40°54'50.799"N	104°28'53.918"W	0.03	
5017.00	0.040	250.260	4960.90	-531.19	-534.46	192.83	40°54'50.799"N	104°28'53.918"W	0.01	
5112.00	0.040	330.650	5055.90	-531.17	-534.44	192.78	40°54'50.799"N	104°28'53.919"W	0.05	
5206.00	0.100	232.350	5149.90	-531.19	-534.46	192.70	40°54'50.799"N	104°28'53.920"W	0.12	
5301.00	0.030	85.750	5244.90	-531.24	-534.51	192.66	40°54'50.799"N	104°28'53.921"W	0.13	
5396.00	0.030	197.430	5339.90	-531.26	-534.53	192.68	40°54'50.798"N	104°28'53.920"W	0.05	
5492.00	0.040	237.170	5435.90	-531.31	-534.57	192.64	40°54'50.798"N	104°28'53.921"W	0.03	



Actual Wellpath Report

CRITTER CREEK #202-1807H AWP

Page 4 of 10



REFERENCE WELLPATH IDENTIFICATION			
Operator	FIFTH CREEK ENERGY	Slot	SLOT#03 CRITTER CREEK #202-1807H (215'FSL & 828'FWL, SEC.18)
Area	COLORADO	Well	CRITTER CREEK #202-1807H
Field	WELD COUNTY (NAD 83 / TN)	Wellbore	CRITTER CREEK #202-1807H AWB
Facility	SEC.18-T11N-R63W		

WELLPATH DATA (193 stations) † = interpolated/extrapolated station										
MD [ft]	Inclination [°]	Azimuth [°]	TVD [ft]	Vert Sect [ft]	North [ft]	East [ft]	Latitude	Longitude	DLS [°/100ft]	Comments
5587.00	0.030	4.610	5530.90	-531.30	-534.57	192.62	40°54'50.798"N	104°28'53.921"W	0.07	
5683.00	0.030	210.630	5626.90	-531.30	-534.56	192.60	40°54'50.798"N	104°28'53.921"W	0.06	
5778.00	0.030	309.530	5721.90	-531.30	-534.57	192.57	40°54'50.798"N	104°28'53.922"W	0.05	
5874.00	0.040	150.720	5817.90	-531.32	-534.58	192.57	40°54'50.798"N	104°28'53.922"W	0.07	
5969.00	0.070	206.720	5912.90	-531.40	-534.66	192.56	40°54'50.797"N	104°28'53.922"W	0.06	
6065.00	0.040	190.110	6008.90	-531.48	-534.75	192.53	40°54'50.796"N	104°28'53.922"W	0.04	
6160.00	0.070	267.010	6103.90	-531.52	-534.78	192.46	40°54'50.796"N	104°28'53.923"W	0.08	
6256.00	0.060	86.370	6199.90	-531.52	-534.78	192.46	40°54'50.796"N	104°28'53.923"W	0.14	
6351.00	0.000	8.230	6294.90	-531.52	-534.78	192.51	40°54'50.796"N	104°28'53.923"W	0.06	
6447.00	0.030	46.970	6390.90	-531.50	-534.76	192.52	40°54'50.796"N	104°28'53.922"W	0.03	
6543.00	0.040	325.800	6486.90	-531.45	-534.72	192.52	40°54'50.797"N	104°28'53.922"W	0.05	
6639.00	0.000	8.230	6582.90	-531.43	-534.69	192.50	40°54'50.797"N	104°28'53.923"W	0.04	
6735.00	0.090	242.980	6678.90	-531.46	-534.72	192.44	40°54'50.797"N	104°28'53.924"W	0.09	
6830.00	0.070	36.090	6773.90	-531.45	-534.71	192.40	40°54'50.797"N	104°28'53.924"W	0.16	
6925.00	0.040	345.840	6868.90	-531.37	-534.63	192.43	40°54'50.797"N	104°28'53.924"W	0.06	
7021.00	5.930	333.710	6964.73	-526.92	-530.15	190.22	40°54'50.842"N	104°28'53.952"W	6.14	
7115.00	13.080	351.510	7057.39	-512.09	-515.25	186.50	40°54'50.989"N	104°28'54.001"W	8.14	
7211.00	21.400	354.770	7149.00	-483.91	-487.02	183.29	40°54'51.268"N	104°28'54.043"W	8.72	
7306.00	29.690	356.090	7234.64	-443.17	-446.22	180.10	40°54'51.671"N	104°28'54.084"W	8.75	
7400.00	38.650	356.000	7312.34	-390.62	-393.60	176.46	40°54'52.191"N	104°28'54.132"W	9.53	
7495.00	46.770	357.330	7382.08	-326.42	-329.33	172.77	40°54'52.826"N	104°28'54.180"W	8.60	
7590.00	55.320	358.320	7441.76	-252.72	-255.57	170.01	40°54'53.555"N	104°28'54.216"W	9.04	
7684.00	63.650	357.920	7489.44	-171.91	-174.71	167.34	40°54'54.354"N	104°28'54.250"W	8.87	
7779.00	72.790	358.940	7524.66	-83.87	-86.62	164.95	40°54'55.224"N	104°28'54.281"W	9.67	
7874.00	81.630	2.070	7545.67	8.67	5.92	165.81	40°54'56.138"N	104°28'54.270"W	9.84	
7966.00†	89.736	3.145	7552.59	100.29	97.49	169.99	40°54'57.043"N	104°28'54.216"W	8.89	CROSSED 300' SETBACK (300'FSL & 996'FWL, SEC.18)
7969.00	90.000	3.180	7552.60	103.29	100.48	170.15	40°54'57.073"N	104°28'54.214"W	8.89	
8065.00	89.940	1.200	7552.65	199.26	196.41	173.82	40°54'58.021"N	104°28'54.166"W	2.06	
8160.00	89.820	2.380	7552.85	294.25	291.36	176.79	40°54'58.959"N	104°28'54.127"W	1.25	
8255.00	89.720	1.140	7553.23	389.24	386.31	179.71	40°54'59.897"N	104°28'54.089"W	1.31	



Actual Wellpath Report

CRITTER CREEK #202-1807H AWP

Page 5 of 10



REFERENCE WELLPATH IDENTIFICATION			
Operator	FIFTH CREEK ENERGY	Slot	SLOT#03 CRITTER CREEK #202-1807H (215'FSL & 828'FWL, SEC.18)
Area	COLORADO	Well	CRITTER CREEK #202-1807H
Field	WELD COUNTY (NAD 83 / TN)	Wellbore	CRITTER CREEK #202-1807H AWB
Facility	SEC.18-T11N-R63W		

WELLPATH DATA (193 stations)										
MD [ft]	Inclination [°]	Azimuth [°]	TVD [ft]	Vert Sect [ft]	North [ft]	East [ft]	Latitude	Longitude	DLS [°/100ft]	Comments
8351.00	90.370	359.950	7553.15	485.23	482.30	180.62	40°55'00.846"N	104°28'54.077"W	1.41	
8445.00	89.140	358.150	7553.56	579.17	576.28	179.06	40°55'01.774"N	104°28'54.098"W	2.32	
8539.00	89.080	357.580	7555.02	673.03	670.21	175.56	40°55'02.702"N	104°28'54.143"W	0.61	
8634.00	89.050	356.930	7556.57	767.81	765.08	171.01	40°55'03.640"N	104°28'54.202"W	0.68	
8728.00	89.020	357.510	7558.15	861.60	858.96	166.45	40°55'04.567"N	104°28'54.262"W	0.62	
8822.00	90.060	359.160	7558.90	955.50	952.91	163.72	40°55'05.495"N	104°28'54.297"W	2.07	
8916.00	90.000	356.200	7558.86	1049.33	1046.83	159.92	40°55'06.423"N	104°28'54.347"W	3.15	
9011.00	90.180	0.320	7558.71	1144.21	1141.76	157.03	40°55'07.361"N	104°28'54.385"W	4.34	
9105.00	90.150	2.910	7558.44	1238.19	1235.72	159.68	40°55'08.290"N	104°28'54.350"W	2.76	
9200.00	90.120	4.040	7558.21	1333.10	1330.54	165.44	40°55'09.227"N	104°28'54.275"W	1.19	
9294.00	89.910	359.510	7558.19	1427.06	1424.47	168.35	40°55'10.155"N	104°28'54.237"W	4.82	
9389.00	90.090	357.280	7558.19	1521.96	1519.43	165.69	40°55'11.093"N	104°28'54.272"W	2.36	
9485.00	90.000	0.400	7558.11	1617.89	1615.39	163.75	40°55'12.041"N	104°28'54.297"W	3.25	
9580.00	90.060	358.370	7558.06	1712.85	1710.38	162.73	40°55'12.980"N	104°28'54.310"W	2.14	
9674.00	90.150	6.840	7557.89	1806.72	1804.20	167.00	40°55'13.907"N	104°28'54.255"W	9.01	
9769.00	89.940	9.250	7557.81	1900.99	1898.26	180.29	40°55'14.836"N	104°28'54.081"W	2.55	
9863.00	89.820	1.780	7558.01	1994.62	1991.76	189.32	40°55'15.760"N	104°28'53.964"W	7.95	
9959.00	89.970	358.630	7558.19	2090.60	2087.74	189.66	40°55'16.708"N	104°28'53.959"W	3.28	
10054.00	89.780	353.720	7558.40	2185.24	2182.50	183.33	40°55'17.645"N	104°28'54.042"W	5.17	
10150.00	89.970	353.830	7558.60	2280.49	2277.94	172.92	40°55'18.588"N	104°28'54.178"W	0.23	
10245.00	89.940	355.810	7558.68	2374.94	2372.55	164.34	40°55'19.522"N	104°28'54.289"W	2.08	
10340.00	90.060	359.630	7558.68	2469.77	2467.45	160.56	40°55'20.460"N	104°28'54.338"W	4.02	
10436.00	89.880	357.740	7558.73	2565.70	2563.42	158.36	40°55'21.409"N	104°28'54.367"W	1.98	
10531.00	90.220	0.150	7558.65	2660.63	2658.40	156.61	40°55'22.347"N	104°28'54.390"W	2.56	
10626.00	89.940	3.210	7558.51	2755.61	2753.35	159.39	40°55'23.285"N	104°28'54.354"W	3.23	
10721.00	90.120	6.170	7558.46	2850.40	2848.02	167.16	40°55'24.221"N	104°28'54.252"W	3.12	
10817.00	90.150	3.780	7558.24	2946.15	2943.65	175.49	40°55'25.165"N	104°28'54.144"W	2.49	
10912.00	89.880	0.050	7558.21	3041.12	3038.58	178.66	40°55'26.103"N	104°28'54.103"W	3.94	
11007.00	90.180	0.260	7558.16	3136.11	3133.58	178.92	40°55'27.042"N	104°28'54.099"W	0.39	
11103.00	89.910	0.560	7558.09	3232.11	3229.58	179.60	40°55'27.991"N	104°28'54.090"W	0.42	



Actual Wellpath Report

CRITTER CREEK #202-1807H AWP
Page 6 of 10



REFERENCE WELLPATH IDENTIFICATION			
Operator	FIFTH CREEK ENERGY	Slot	SLOT#03 CRITTER CREEK #202-1807H (215'FSL & 828'FWL, SEC.18)
Area	COLORADO	Well	CRITTER CREEK #202-1807H
Field	WELD COUNTY (NAD 83 / TN)	Wellbore	CRITTER CREEK #202-1807H AWB
Facility	SEC.18-T11N-R63W		

WELLPATH DATA (193 stations)										
MD [ft]	Inclination [°]	Azimuth [°]	TVD [ft]	Vert Sect [ft]	North [ft]	East [ft]	Latitude	Longitude	DLS [°/100ft]	Comments
11198.00	89.970	357.590	7558.19	3327.05	3324.55	178.07	40°55'28.929"N	104°28'54.110"W	3.13	
11294.00	90.090	358.160	7558.14	3422.91	3420.49	174.51	40°55'29.877"N	104°28'54.157"W	0.61	
11389.00	89.910	358.590	7558.14	3517.81	3515.45	171.82	40°55'30.815"N	104°28'54.192"W	0.49	
11485.00	90.180	359.020	7558.06	3613.75	3611.43	169.81	40°55'31.764"N	104°28'54.218"W	0.53	
11580.00	89.970	358.900	7557.94	3708.69	3706.41	168.09	40°55'32.702"N	104°28'54.240"W	0.25	
11675.00	90.180	359.410	7557.81	3803.64	3801.40	166.69	40°55'33.641"N	104°28'54.259"W	0.58	
11771.00	90.030	359.950	7557.64	3899.62	3897.40	166.15	40°55'34.589"N	104°28'54.265"W	0.58	
11867.00	90.090	0.480	7557.54	3995.61	3993.40	166.51	40°55'35.538"N	104°28'54.261"W	0.56	
11962.00	89.850	0.480	7557.59	4090.61	4088.39	167.31	40°55'36.476"N	104°28'54.250"W	0.25	
12057.00	89.850	0.820	7557.84	4185.60	4183.39	168.39	40°55'37.415"N	104°28'54.236"W	0.36	
12153.00	89.720	1.470	7558.20	4281.60	4279.37	170.30	40°55'38.363"N	104°28'54.211"W	0.69	
12248.00	89.820	2.430	7558.58	4376.59	4374.31	173.54	40°55'39.301"N	104°28'54.169"W	1.02	
12343.00	89.880	3.050	7558.83	4471.54	4469.20	178.08	40°55'40.239"N	104°28'54.110"W	0.66	
12439.00	89.940	359.540	7558.98	4567.52	4565.16	180.25	40°55'41.187"N	104°28'54.082"W	3.66	
12534.00	90.090	359.680	7558.95	4662.50	4660.16	179.60	40°55'42.126"N	104°28'54.090"W	0.22	
12629.00	90.000	358.290	7558.88	4757.44	4755.14	177.92	40°55'43.064"N	104°28'54.112"W	1.47	
12724.00	89.140	359.680	7559.59	4852.38	4850.12	176.24	40°55'44.003"N	104°28'54.134"W	1.72	
12820.00	89.050	1.740	7561.11	4948.36	4946.10	177.42	40°55'44.951"N	104°28'54.119"W	2.15	
12915.00	89.170	1.380	7562.58	5043.34	5041.05	180.01	40°55'45.889"N	104°28'54.085"W	0.40	
13010.00	89.200	1.070	7563.93	5138.33	5136.02	182.04	40°55'46.828"N	104°28'54.058"W	0.33	
13105.00	89.690	1.720	7564.85	5233.32	5230.98	184.35	40°55'47.766"N	104°28'54.028"W	0.86	
13201.00	89.290	2.030	7565.71	5329.31	5326.93	187.49	40°55'48.714"N	104°28'53.987"W	0.53	
13297.00	89.290	1.490	7566.90	5425.29	5422.88	190.44	40°55'49.662"N	104°28'53.949"W	0.56	
13393.00	89.480	0.690	7567.93	5521.28	5518.85	192.27	40°55'50.610"N	104°28'53.925"W	0.86	
13489.00	89.570	358.290	7568.72	5617.24	5614.84	191.41	40°55'51.559"N	104°28'53.936"W	2.50	
13584.00	89.630	357.020	7569.39	5712.08	5709.75	187.53	40°55'52.496"N	104°28'53.987"W	1.34	
13678.00	89.230	355.730	7570.32	5805.77	5803.56	181.59	40°55'53.423"N	104°28'54.064"W	1.44	
13773.00	89.320	355.490	7571.52	5900.35	5898.27	174.31	40°55'54.359"N	104°28'54.159"W	0.27	
13869.00	89.450	357.370	7572.55	5996.04	5994.08	168.34	40°55'55.306"N	104°28'54.237"W	1.96	
13964.00	89.510	0.570	7573.42	6090.97	6089.05	166.63	40°55'56.244"N	104°28'54.259"W	3.37	



Actual Wellpath Report

CRITTER CREEK #202-1807H AWP
Page 7 of 10



REFERENCE WELLPATH IDENTIFICATION			
Operator	FIFTH CREEK ENERGY	Slot	SLOT#03 CRITTER CREEK #202-1807H (215'FSL & 828'FWL, SEC.18)
Area	COLORADO	Well	CRITTER CREEK #202-1807H
Field	WELD COUNTY (NAD 83 / TN)	Wellbore	CRITTER CREEK #202-1807H AWB
Facility	SEC.18-T11N-R63W		

WELLPATH DATA (193 stations)										
MD [ft]	Inclination [°]	Azimuth [°]	TVD [ft]	Vert Sect [ft]	North [ft]	East [ft]	Latitude	Longitude	DLS [°/100ft]	Comments
14060.00	89.600	3.020	7574.16	6186.95	6184.99	169.64	40°55'57.192"N	104°28'54.220"W	2.55	
14155.00	89.910	1.650	7574.57	6281.92	6279.91	173.51	40°55'58.130"N	104°28'54.169"W	1.48	
14251.00	89.910	359.610	7574.72	6377.91	6375.89	174.56	40°55'59.078"N	104°28'54.156"W	2.12	
14345.00	90.000	359.950	7574.79	6471.89	6469.89	174.20	40°56'00.007"N	104°28'54.160"W	0.37	
14441.00	89.880	0.050	7574.89	6567.88	6565.89	174.20	40°56'00.956"N	104°28'54.160"W	0.16	
14536.00	90.090	359.370	7574.92	6662.86	6660.89	173.72	40°56'01.894"N	104°28'54.167"W	0.75	
14631.00	90.000	357.170	7574.84	6757.75	6755.84	170.85	40°56'02.833"N	104°28'54.204"W	2.32	
14726.00	89.940	355.400	7574.89	6852.43	6850.64	164.70	40°56'03.769"N	104°28'54.284"W	1.86	
14822.00	90.090	358.060	7574.87	6948.16	6946.47	159.22	40°56'04.716"N	104°28'54.356"W	2.78	
14918.00	90.250	3.490	7574.58	7044.12	7042.43	160.52	40°56'05.664"N	104°28'54.339"W	5.66	
15014.00	89.780	5.770	7574.56	7139.92	7138.11	168.27	40°56'06.610"N	104°28'54.238"W	2.42	
15109.00	89.750	4.010	7574.95	7234.69	7232.76	176.37	40°56'07.545"N	104°28'54.132"W	1.85	
15204.00	89.970	1.460	7575.18	7329.63	7327.64	180.90	40°56'08.482"N	104°28'54.073"W	2.69	
15299.00	89.940	1.020	7575.26	7424.63	7422.62	182.95	40°56'09.421"N	104°28'54.046"W	0.46	
15395.00	89.940	1.880	7575.36	7520.63	7518.59	185.38	40°56'10.369"N	104°28'54.015"W	0.90	
15489.00	90.030	2.040	7575.38	7614.61	7612.53	188.60	40°56'11.297"N	104°28'53.973"W	0.20	
15584.00	90.280	0.240	7575.12	7709.61	7707.51	190.49	40°56'12.236"N	104°28'53.948"W	1.91	
15678.00	90.030	359.470	7574.87	7803.59	7801.51	190.25	40°56'13.164"N	104°28'53.951"W	0.86	
15773.00	90.030	358.260	7574.82	7898.53	7896.49	188.37	40°56'14.103"N	104°28'53.976"W	1.27	
15868.00	90.030	358.010	7574.77	7993.41	7991.44	185.28	40°56'15.041"N	104°28'54.016"W	0.26	
15963.00	89.970	357.650	7574.77	8088.27	8086.37	181.68	40°56'15.979"N	104°28'54.063"W	0.38	
16058.00	90.000	357.630	7574.79	8183.11	8181.29	177.77	40°56'16.917"N	104°28'54.114"W	0.04	
16153.00	89.880	357.990	7574.89	8277.97	8276.22	174.14	40°56'17.855"N	104°28'54.161"W	0.40	
16248.00	89.750	358.070	7575.20	8372.85	8371.16	170.87	40°56'18.793"N	104°28'54.204"W	0.16	
16343.00	89.910	357.630	7575.48	8467.71	8466.10	167.31	40°56'19.731"N	104°28'54.250"W	0.49	
16438.00	89.880	358.570	7575.66	8562.59	8561.04	164.16	40°56'20.669"N	104°28'54.291"W	0.99	
16533.00	90.340	358.290	7575.47	8657.49	8656.01	161.56	40°56'21.607"N	104°28'54.325"W	0.57	
16628.00	90.120	2.140	7575.09	8752.47	8750.99	161.91	40°56'22.546"N	104°28'54.320"W	4.06	
16723.00	89.880	0.510	7575.09	8847.46	8845.96	164.11	40°56'23.484"N	104°28'54.292"W	1.73	
16817.00	89.690	359.540	7575.45	8941.45	8939.96	164.15	40°56'24.413"N	104°28'54.291"W	1.05	



Actual Wellpath Report

CRITTER CREEK #202-1807H AWP
Page 8 of 10



REFERENCE WELLPATH IDENTIFICATION			
Operator	FIFTH CREEK ENERGY	Slot	SLOT#03 CRITTER CREEK #202-1807H (215'FSL & 828'FWL, SEC.18)
Area	COLORADO	Well	CRITTER CREEK #202-1807H
Field	WELD COUNTY (NAD 83 / TN)	Wellbore	CRITTER CREEK #202-1807H AWB
Facility	SEC.18-T11N-R63W		

WELLPATH DATA (193 stations)										
MD [ft]	Inclination [°]	Azimuth [°]	TVD [ft]	Vert Sect [ft]	North [ft]	East [ft]	Latitude	Longitude	DLS [°/100ft]	Comments
16912.00	90.030	358.910	7575.68	9036.40	9034.95	162.87	40°56'25.352"N	104°28'54.308"W	0.75	
17007.00	89.820	2.290	7575.80	9131.39	9129.93	163.86	40°56'26.290"N	104°28'54.295"W	3.56	
17103.00	90.150	359.380	7575.83	9227.38	9225.91	165.26	40°56'27.238"N	104°28'54.277"W	3.05	
17198.00	90.310	4.960	7575.45	9322.32	9320.80	168.85	40°56'28.176"N	104°28'54.230"W	5.88	
17293.00	90.400	3.770	7574.86	9417.15	9415.52	176.08	40°56'29.112"N	104°28'54.136"W	1.26	
17388.00	90.310	356.000	7574.27	9512.06	9510.45	175.89	40°56'30.050"N	104°28'54.138"W	8.18	
17483.00	90.250	347.300	7573.80	9605.72	9604.35	162.11	40°56'30.978"N	104°28'54.318"W	9.16	
17578.00	90.340	352.610	7573.31	9698.94	9697.86	145.55	40°56'31.902"N	104°28'54.533"W	5.59	
17672.00	90.280	1.900	7572.80	9792.64	9791.64	141.05	40°56'32.828"N	104°28'54.592"W	9.88	
17767.00	90.370	3.790	7572.26	9887.58	9886.52	145.77	40°56'33.766"N	104°28'54.531"W	1.99	
17862.00	90.310	3.690	7571.70	9982.47	9981.32	151.96	40°56'34.702"N	104°28'54.450"W	0.12	
17941.00	90.180	3.750	7571.36	10061.37	10060.15	157.09	40°56'35.481"N	104°28'54.383"W	0.18	LAST BHI MWD SURVEY
17965.00	90.180	3.750	7571.29	10085.34	10084.10	158.66	40°56'35.718"N	104°28'54.363"W	0.00	PROJECTION TO BIT (306'FNL & 991'FWL, SEC.07)



Actual Wellpath Report

CRITTER CREEK #202-1807H AWP

Page 9 of 10



REFERENCE WELLPATH IDENTIFICATION			
Operator	FIFTH CREEK ENERGY	Slot	SLOT#03 CRITTER CREEK #202-1807H (215'FSL & 828'FWL, SEC.18)
Area	COLORADO	Well	CRITTER CREEK #202-1807H
Field	WELD COUNTY (NAD 83 / TN)	Wellbore	CRITTER CREEK #202-1807H AWB
Facility	SEC.18-T11N-R63W		

TARGETS								
Name	TVD [ft]	North [ft]	East [ft]	Grid East [US ft]	Grid North [US ft]	Latitude	Longitude	Shape
SEC.07-T11N-R63W	0.00	0.00	-49.90	3281216.64	1578010.30	40°54'56.080"N	104°28'57.080"W	polygon
SEC.18-T11N-R63W	0.00	0.00	-49.90	3281216.64	1578010.30	40°54'56.080"N	104°28'57.080"W	polygon
CRITTER CREEK #202-1807H BHL (300'FNL & 1000'FWL, SEC.07)	7470.00	10090.38	167.30	3281318.03	1588102.73	40°56'35.780"N	104°28'54.250"W	point
SEC.07/18-T11N-R63W (300'SETBACK)	7470.00	0.00	-49.90	3281216.64	1578010.30	40°54'56.080"N	104°28'57.080"W	polygon
CRITTER CREEK #202-1807H LP (300'FSL & 1000'FWL, SEC.18)	7485.00	96.15	171.21	3281436.64	1578108.98	40°54'57.030"N	104°28'54.200"W	point
CRITTER CREEK #202-1807H BHL REV-1 (300'FNL & 1000'FWL, SEC.07)	7507.10	10090.38	167.30	3281318.03	1588102.73	40°56'35.780"N	104°28'54.250"W	point
CRITTER CREEK #202-1807H BHL REV-2 (300'FNL & 1000'FWL, SEC.07)	7544.71	10090.38	167.30	3281318.03	1588102.73	40°56'35.780"N	104°28'54.250"W	point
CRITTER CREEK #202-1807H LP REV-1 (300'FSL & 1000'FWL, SEC.18)	7555.00	96.15	171.21	3281436.64	1578108.98	40°54'57.030"N	104°28'54.200"W	point

WELLPATH COMPOSITION - Ref Wellbore: CRITTER CREEK #202-1807H AWB Ref Wellpath: CRITTER CREEK #202-1807H AWP				
Start MD [ft]	End MD [ft]	Positional Uncertainty Model	Log Name/Comment	Wellbore
21.00	1493.00	Custom BHI NaviTrak (Standard Rotating+Axial Corr) (Rockies 0.03Gt model)	BHI NAVITRAK+SR+AC+ROCKIES <138-1493>	CRITTER CREEK #202-1807H AWB
1493.00	17941.00	Custom BHI AutoTrak Curve (Axial Corr, Short spacing) (Rockies 0.03Gt model)	BHI ATCURVE +AC+SS+ROCKIES <1601-17941>	CRITTER CREEK #202-1807H AWB
17941.00	17965.00	Blind Drilling (std)	Projection to bit	CRITTER CREEK #202-1807H AWB



Actual Wellpath Report

CRITTER CREEK #202-1807H AWP
Page 10 of 10



REFERENCE WELLPATH IDENTIFICATION			
Operator	FIFTH CREEK ENERGY	Slot	SLOT#03 CRITTER CREEK #202-1807H (215'FSL & 828'FWL, SEC.18)
Area	COLORADO	Well	CRITTER CREEK #202-1807H
Field	WELD COUNTY (NAD 83 / TN)	Wellbore	CRITTER CREEK #202-1807H AWB
Facility	SEC.18-T11N-R63W		

WELLPATH COMMENTS				
MD [ft]	Inclination [°]	Azimuth [°]	TVD [ft]	Comment
138.00	0.510	261.190	138.00	FIRST BHI MWD SURVEY
7966.00	89.736	3.145	7552.59	CROSSED 300' SETBACK (300'FSL & 996'FWL, SEC.18)
17941.00	90.180	3.750	7571.36	LAST BHI MWD SURVEY
17965.00	90.180	3.750	7571.29	PROJECTION TO BIT (306'FNL & 991'FWL, SEC.07)