

Post-construction Stormwater/Reclamation Inspection Report

Location: Cass Farms 11-25H

Inspection Date: 6/11/2018

Prepared By:



Qtr/Qtr: NWNW

Section: 25

Township: 8N

Range: 62W



MALLARD

EXPLORATION

This report contains a diagram/map, Tier 1 evaluation, and final stabilization (CDPHE)/interim or final reclamation completion (COGCC) evaluation. The diagram/map shows the stormwater features and disturbance information. It is important to note that the BMPs and stormwater issues represented are not to scale and are meant show approximate locations when on the site.

Priority stars on the diagrams/maps represent general locations of stormwater issues. Priority stars are color coordinated by priority:

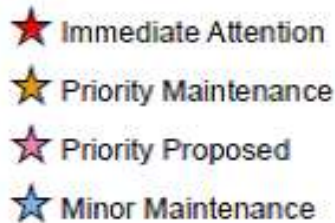

Immediate Attention Needed: Issue that needs immediate attention to protect waters of the state or human health.

Priority Maintenance: Maintenance needed to existing structural stormwater BMPs to protect waters of the state.

Priority Proposed: Erosion or sediment movement occurring without control by a structural BMP. Recommend addressing erosion or sediment issues at this location.

Minor Maintenance: Structural BMPs that need low priority maintenance. Examples include wattles filling with sediment and crushed culverts.



Post-construction Stormwater Management Plan Inspection Map

Cass Farms 11-25H Pad

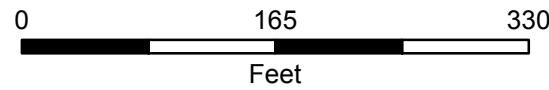
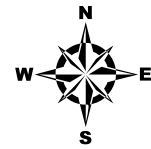

Prepared by:



Editor: PArendt

Scale: 1:1,500

File: Mallard_PostConstrSWP_DDP_V1

Date: 6/25/2018

- Annual (COGCC)
- Biannual (COGCC)
- Quarterly (COGCC)
- Tier 1 - Excluded
- DG
- PR
- XX
- Immediate Attention Needed
- Priority Maintenance
- Priority Proposed
- Minor Maintenance
- Addressed (Drop)
- Highway
- County/Local Road
- Canal/Irrigation Ditch
- Waterbody
- Waterway

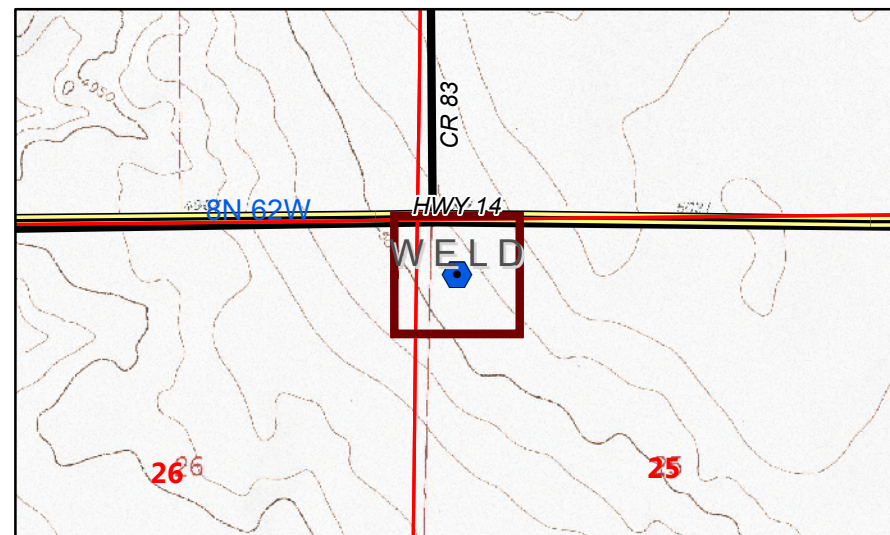

Tier 1 Evaluation

Location: Cass Farms 11-25H

Is it located in an agricultural field? No

Evaluation date: 6/11/2018

Tier 1 company: H2E

Tier 1 Criteria

Is the slope less than 5%? Yes

Does the soil have low erosive potential? Yes

Vegetation greater than 80% cover or permanent resistance cover? Yes

Greater than 500 feet from a perennial stream or classified water body? Yes

Disturbance less than 1 acre? No

Tier 1 Applicable? No

If location meets all of the Tier 1 criteria (Yes), then the facility is Tier 1 Applicable. Growing season inspection schedules are used for sites that are ready for Form 4 interim or final reclamation completion/photo collection at the next growing season visit, provided ground conditions support data collection at the time of inspection. The one-time growing season schedule is used for locations that can move to Tier 1 once Form 4 interim or final reclamation completion/photo collection is performed.

Adjusted inspection schedule (as applicable): Annual (COGCC)

Tier 1 notes: First inspection by H2E since acquisition. Notice of interim reclamation completion (along with Form 4 photos) submitted 12/12/2014 by Olsson Associates; approved 03/30/2015. Site moved to annual inspection schedule due to acreage of interim pad (> 1 acre).

Final Stabilization (CDPHE)/Interim or Final Reclamation Completion (COGCC) Evaluation

Location: Cass Farms 11-25H

Inspection company: Olsson Associates

Final stabilization/interim reclamation completion survey date: ~12/12/2014

<u>Disturbed</u>	<u>Native/background</u>
UTM N:	UTM N:
UTM E:	UTM E:
Shrub %:	Shrub %:
Grass %:	Grass %:
Forbs %:	Forbs %:
Total %:	Total %:

Vegetative cover %:

Final stabilization or interim/final reclamation completion met? Yes

Final stabilization/reclamation completion notes:

Notice of interim reclamation completion (along with Form 4 photos) submitted 12/12/2014 by Olsson Associates; approved 03/30/2015.