

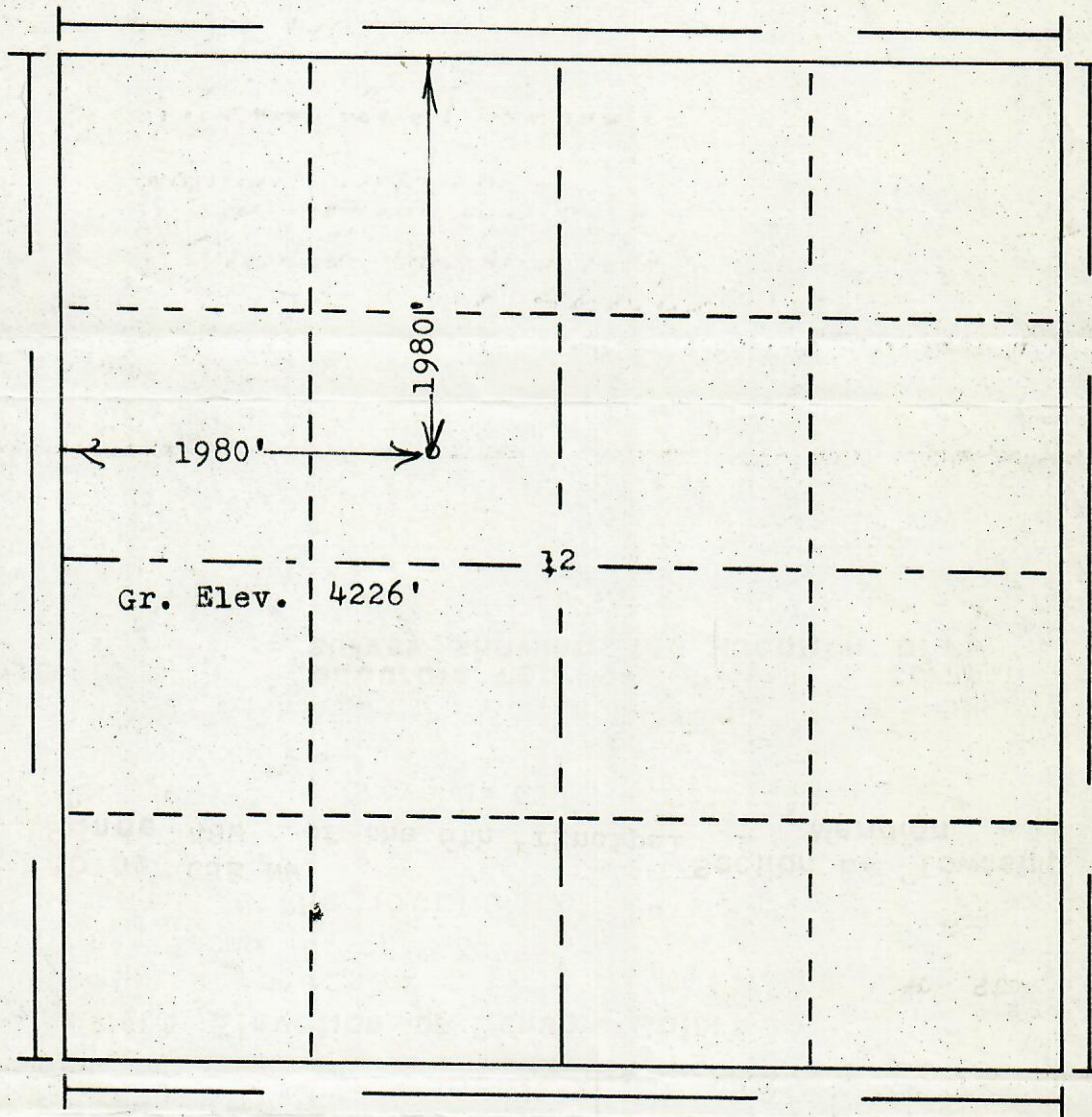

FORM F-106

RECEIVED  
NOV 4 1982  
COLO. OIL & GAS CONS. CO.

R. 48W

T.  
16  
S

Scale... 1" = 1000'

Powers Elevation of Denver, Colorado  
has in accordance with a request from Mr. Stubbs  
for Termo Co. of Texas  
determined the location of No.1 Cheyenne-State  
to be CSE NW Section 12 Township 16S  
Range 48W of the 6th Principal Meridian  
Cheyenne County, Colorado

I hereby certify that this plat is an  
accurate representation of a correct  
survey showing the location of

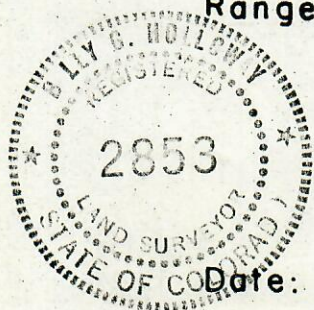

Date: 10-16-82

Licensed Land Surveyor No. 2853  
State of Colorado