

LEGEND:

 **PROPOSED LOCATION**



HIGHPOINT OPERATING CORPORATION

RANDALL CREEK 30 SW PAD
S 1/2 SW 1/4, SECTION 30, T12N, R62W, 6th P.M.
WELD COUNTY, COLORADO



UELS, LLC
Corporate Office * 85 South 200 East
Vernal, UT 84078 * (435) 789-1017

SURVEYED BY	C.M., O.R.	08-17-18	SCALE
DRAWN BY	L.K.	08-29-18	1 : 100,000
ACCESS ROAD MAP			TOPO A

T12N

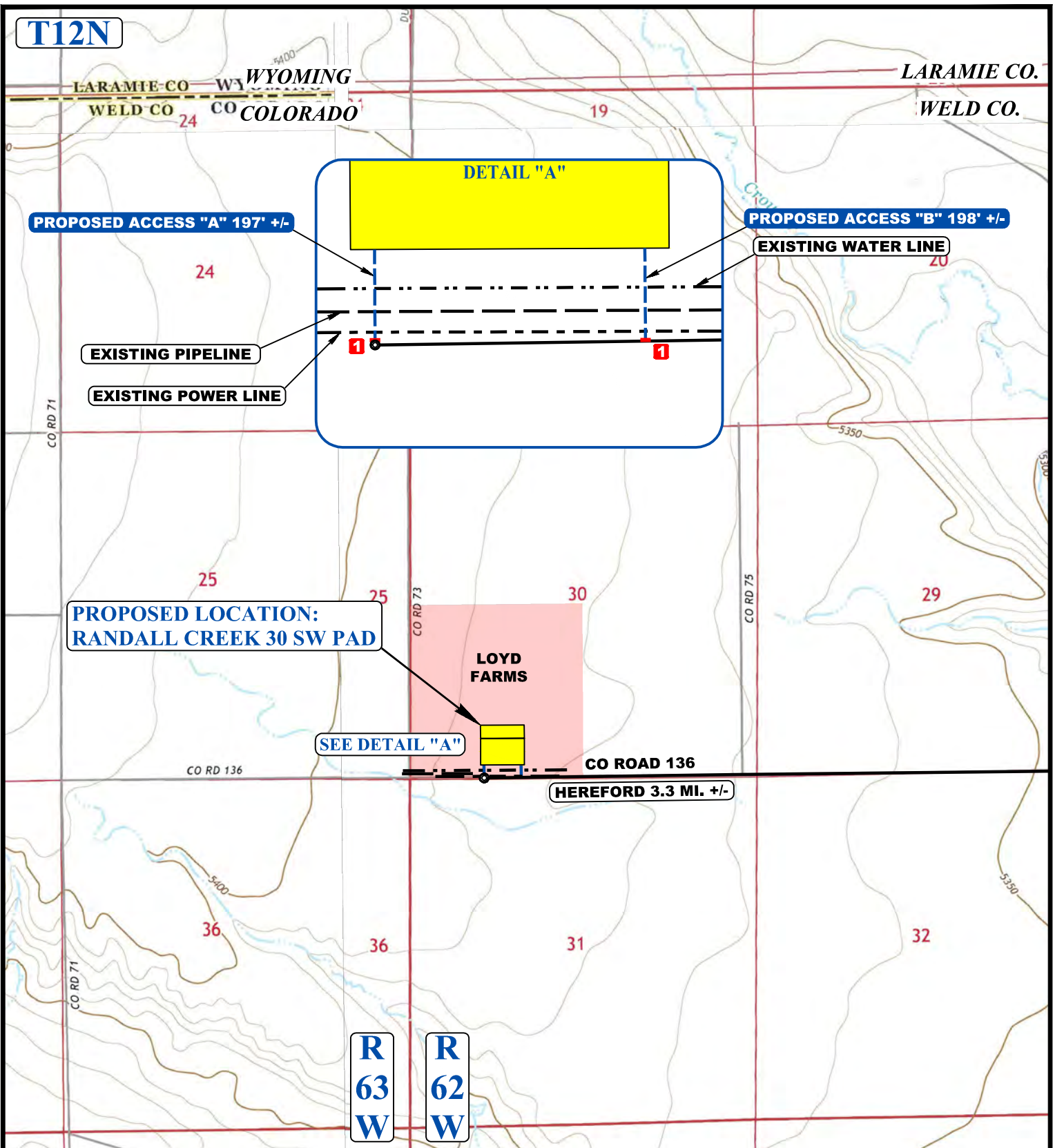

NOTE: PARCEL DATA SHOWN HAS BEEN OBTAINED FROM VARIOUS SOURCES AND SHOULD BE USED FOR MAPPING, GRAPHIC AND PLANNING PURPOSES ONLY. NO WARRANTY IS MADE BY UINTAH ENGINEERING AND LAND SURVEYING (UELS) FOR ACCURACY OF THE PARCEL DATA.

LEGEND:

- EXISTING ROAD
- PROPOSED ROAD
- EXISTING POWER LINE
- EXISTING PIPELINE
- EXISTING WATER LINE
- 1** INSTALL CATTLE GUARD



UELS, LLC
Corporate Office * 85 South 200 East
Vernal, UT 84078 * (435) 789-1017



HIGHPOINT OPERATING CORPORATION

RANDALL CREEK 30 SW PAD
S 1/2 SW 1/4, SECTION 30, T12N, R62W, 6th P.M.
WELD COUNTY, COLORADO

SURVEYED BY	C.M., O.R.	08-17-18	SCALE
DRAWN BY	L.K.	08-29-18	1 : 24,000
ACCESS ROAD MAP			TOPO B