

# EASTERN HILLS 4-65 17-18 3AH-3DH, 4AH-4DH PAD HYDROLOGY MAP

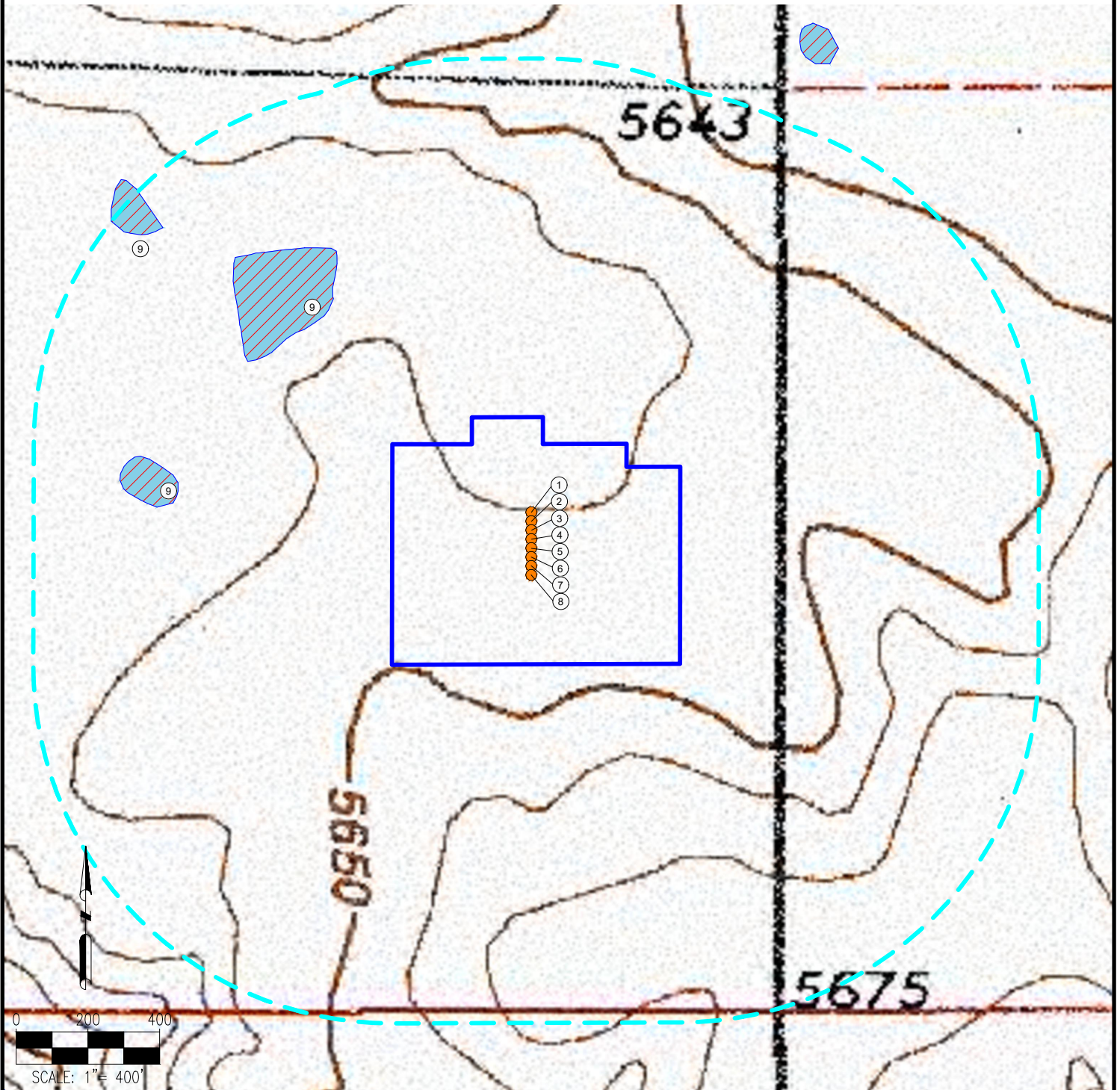

MEASUREMENTS ARE MADE FROM THE NEAREST EDGE OF THE DISTURBANCE AREA.

- |                                 |  |
|---------------------------------|--|
| 1. EASTERN HILLS 4-65 17-18 3AH | 7. EASTERN HILLS 4-65 17-18 4CH                            |
| 2. EASTERN HILLS 4-65 17-18 3BH | 8. EASTERN HILLS 4-65 17-18 4DH                            |
| 3. EASTERN HILLS 4-65 17-18 3CH | 9. WETLANDS ARE $\pm 402'$ NW, $\pm 598'$ W, $\pm 880'$ NW |
| 4. EASTERN HILLS 4-65 17-18 3DH |  |
| 5. EASTERN HILLS 4-65 17-18 4AH |  |
| 6. EASTERN HILLS 4-65 17-18 4BH |  |

## LEGEND:



= PROPOSED WELL



= WETLAND



= DISTURBANCE AREA



= 1000' RADIUS

DISCLAIMER:  
THIS PLOT DOES NOT REPRESENT A MONUMENTED LAND SURVEY AND SHOULD NOT BE RELIED UPON TO DETERMINE BOUNDARY LINES, PROPERTY OWNERSHIP OR OTHER PROPERTY INTERESTS. PARCEL LINES, IF DEPICTED HAVE NOT BEEN FIELD VERIFIED AND MAY BE BASED UPON PUBLICLY AVAILABLE DATA THAT ALSO HAS NOT BEEN INDEPENDENTLY VERIFIED.

DATA SOURCE:  
TOPO MAP: USGS  
NHD: USGS  
PUBLICLY AVAILABLE DATA SOURCES HAVE NOT BEEN INDEPENDENTLY VERIFIED BY ASCENT.



8620 Wolff Court  
Westminster, CO 80031  
(303) 928-7128  
www.ascentgeomatics.com

FIELD DATE:  
04-24-18

DRAWING DATE:  
03-11-20

BY:  
JW

CHECKED:  
IJM

SITE NAME:  
EASTERN HILLS 4-65 17-18 3AH-3DH, 4AH-4DH PAD

SURFACE LOCATION:  
E 1/2 SE 1/4 SEC. 17, T4S, R65W, 6TH P.M.  
ARAPAHOE COUNTY, COLORADO

PREPARED FOR:

