

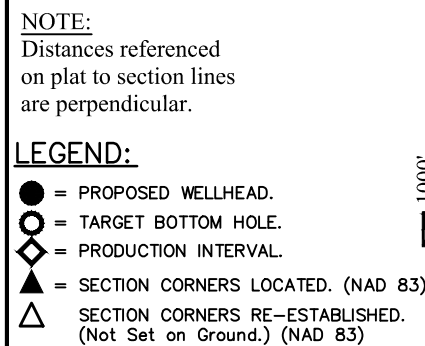





BISON OIL & GAS II
BIG MOUNTAIN VIPER FED 8-59 16-17-18-1
NW 1/4 SW 1/4, SECTION 16, T8N, R59W, 6th P.M.
WELD COUNTY, COLORADO

BASIS OF ELEVATION
OPUS SOLUTION GENERATED NAVD 88



Distances referenced
on plat to section lines
are perpendicular.

 = PROPOSED WELLHEAD.
 = TARGET BOTTOM HOLE.
 = PRODUCTION INTERVAL.
 = SECTION CORNERS LOCATED. (NAD 83)
 = SECTION CORNERS RE-ESTABLISHED.
 (Not Set on Ground.) (NAD 83)

PDOP = 1.4		REV: 2 01-10-20 C.IVIE (SURFACE LOCATION MOVE)	
SURFACE LOCATION 2551' FSL 635' FWL	BEG. PROD. INTERVAL 350' FNL 300' FEL	ENDING PROD. INTERVAL 350' FNL 2557' FEL	TARGET BOTTOM HOLE 350' FNL 2615' FEL
NAD 83 (SURFACE LOCATION)	NAD 83 (BEG. PROD. INTERVAL)	NAD 83 (ENDING PROD. INTERVAL)	NAD 83 (TARGET BOTTOM HOLE)
LATITUDE = 40°39'42.50" (40.661806°)	LATITUDE = 40°40'07.43" (40.668730°)	LATITUDE = 40°40'07.92" (40.668866°)	LATITUDE = 40°40'07.92" (40.668867°)
LONGITUDE = 103°59'19.74" (103.988816°)	LONGITUDE = 103°59'31.46" (103.992071°)	LONGITUDE = 104°01'09.42" (104.019284°)	LONGITUDE = 104°01'10.17" (104.019493°)
NAD 27 (SURFACE LOCATION)	NAD 27 (BEG. PROD. INTERVAL)	NAD 27 (ENDING PROD. INTERVAL)	NAD 27 (TARGET BOTTOM HOLE)
LATITUDE = 40°39'42.55" (40.661819°)	LATITUDE = 40°40'07.47" (40.668743°)	LATITUDE = 40°40'07.96" (40.668879°)	LATITUDE = 40°40'07.97" (40.668880°)
LONGITUDE = 103°59'17.92" (103.988311°)	LONGITUDE = 103°59'29.64" (103.991567°)	LONGITUDE = 104°01'07.60" (104.018779°)	LONGITUDE = 104°01'08.36" (104.018988°)
STATE PLANE NAD 83 (CO. NORTH)	STATE PLANE NAD 83 (CO. NORTH)	STATE PLANE NAD 83 (CO. NORTH)	STATE PLANE NAD 83 (CO. NORTH)
N: 1487511.02' E: 3419234.74'	N: 1490017.81' E: 3418288.76'	N: 1489940.10' E: 3410740.11'	N: 1489939.61' E: 3410682.13'
STATE PLANE NAD 27 (CO. NORTH)	STATE PLANE NAD 27 (CO. NORTH)	STATE PLANE NAD 27 (CO. NORTH)	STATE PLANE NAD 27 (CO. NORTH)
N: 487509.48' E: 2419385.90'	N: 490016.21' E: 2418439.86'	N: 489938.54' E: 2410891.00'	N: 489938.05' E: 2410833.01'

STATE OF COLORADO
REGISTERED LAND SURVEYOR
REGISTRATION NO. 28285
STATE OF COLORADO
03-16-20

UELS, LLC
Corporate Office * 85 South 200 East
Vernal, UT 84078 * (435) 789-1017

SURVEYED BY	CHAD MEIERS, A.S.	01-10-20	SCALE
DRAWN BY	K.B.	03-19-19	1" = 1000'

WELL LOCATION PLAT