

Wellpad Construction Boundary

Disturbance Area

Straw Bales

Topsoil Stockpile

Straw Wattles

Proposed Wellpad Access Road

Road Mats

Existing Access Road

County Road 30

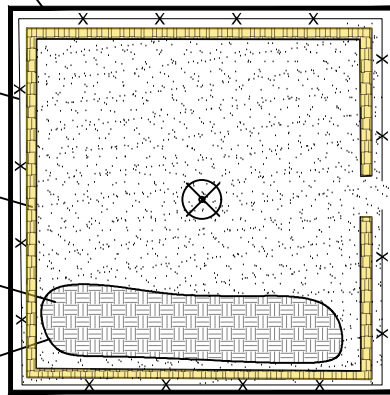

LEGEND

-  Silt Fence
-  Well Head
-  Road Mat
-  Straw Bale
-  Disturbance Area
-  Topsoil

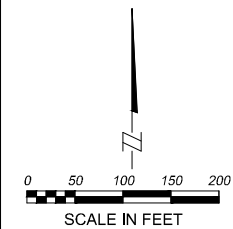

FACILITY LAYOUT	
HOSS #1 SECTION 34-T1N-R49W-6TH PM, SE-SE WASHINGTON COUNTY, COLORADO	
PROJECT: 18530aa	DRAFT: LNA
DATE: 2/24/2020	REVIEW:

