

Banta Ridge 15-19D-1-103

API: 05-103-10263

Inspection: 700400150



Photo 1. Location.



COLORADO
Oil & Gas Conservation
Commission
Department of Natural Resources

Banta Ridge 15-19D-1-103

API: 05-103-10263

Inspection: 700400150



Photo 2. Well head.



COLORADO
Oil & Gas Conservation
Commission
Department of Natural Resources

Banta Ridge 15-19D-1-103

API: 05-103-10263

Inspection: 700400150



Photo 3. Compressor, separator, meter building.



Banta Ridge 15-19D-1-103

API: 05-103-10263

Inspection: 700400150



Photo 4. Tanks.



COLORADO
Oil & Gas Conservation
Commission
Department of Natural Resources

Banta Ridge 15-19D-1-103

API: 05-103-10263

Inspection: 700400150

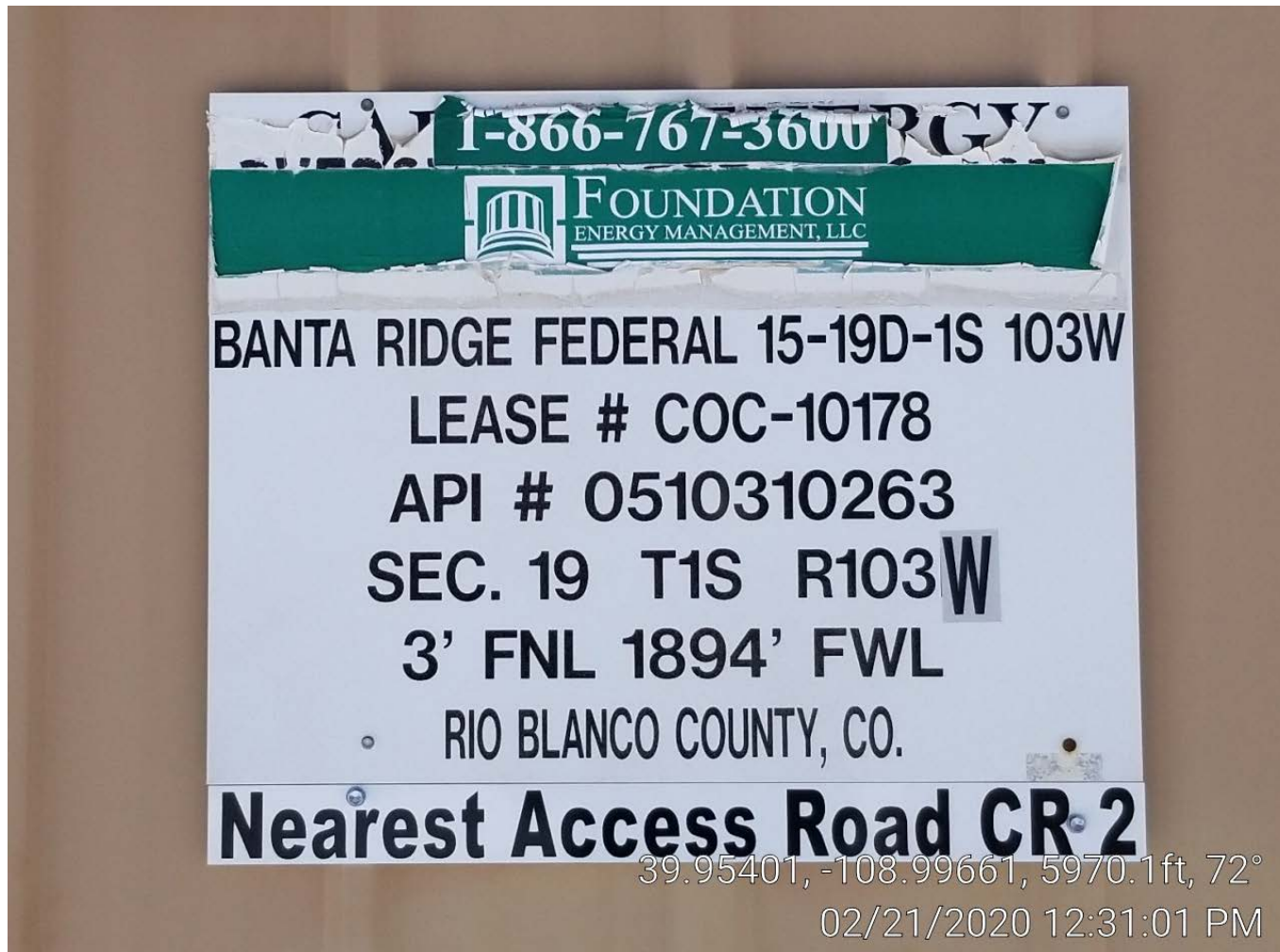

Photo 5. Battery sign.



COLORADO
Oil & Gas Conservation
Commission
Department of Natural Resources