



FORM F-106



00208608

RECEIVED

MAR 29 1973

COLO. OIL & GAS CONS. COMM.

R. 81 W

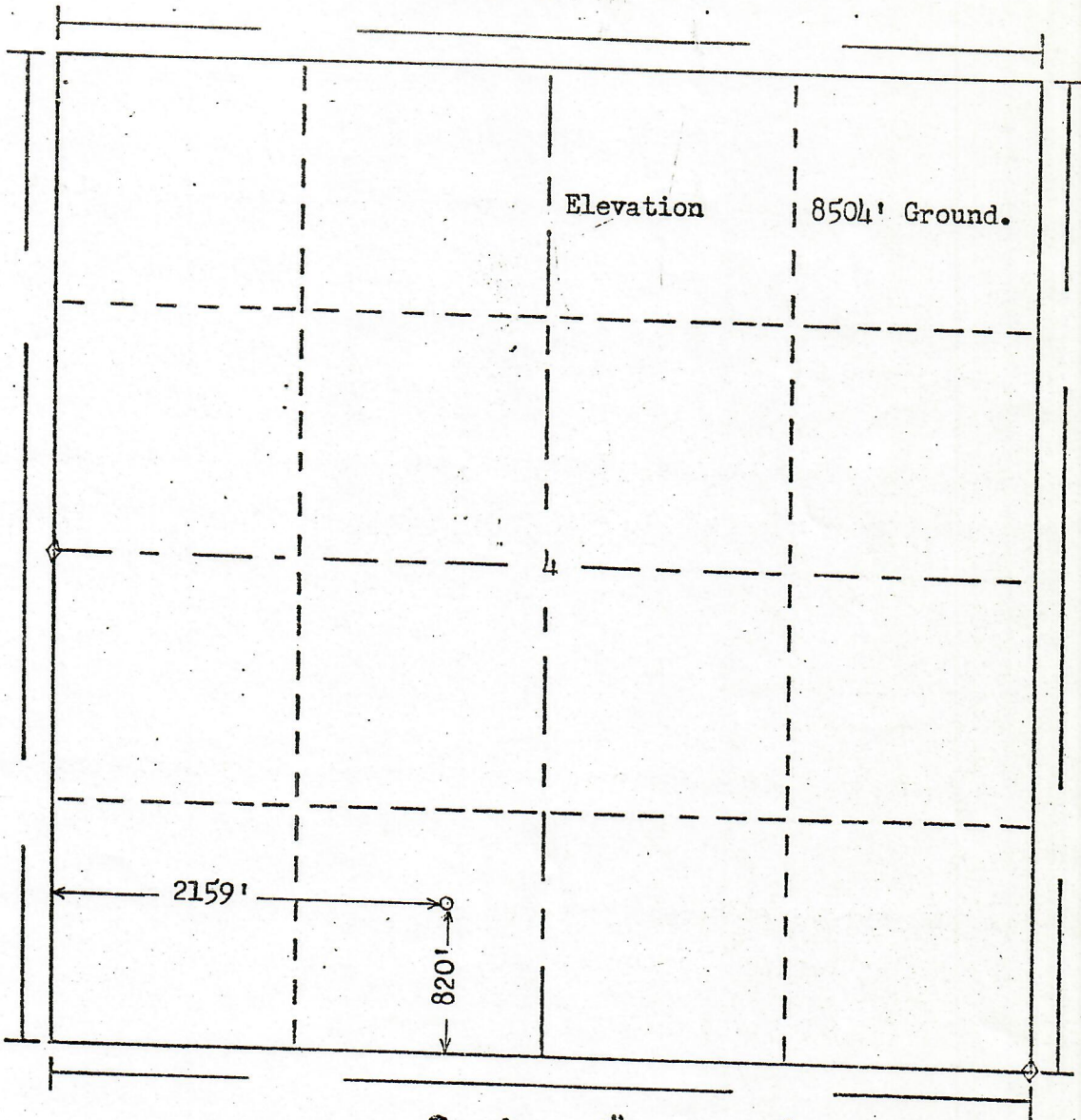
T.
6
N.

Scale... 1" = 1000'

Powers Elevation Company, Inc. of Denver, Colorado
has in accordance with a request from Mr. Lindermanis
for Louisiana Lands & Exploration Company
determined the location of #1 LLE-Federal
to be 820'FS & 2159'FW Section 4 Township 6 N.
Range 81 W. of the 6th Principal Meridian
Jackson County, Colorado

I hereby certify that this plat is an
accurate representation of a correct
survey showing the location of
#1 LLE-Federal

Date: 3-16-73