

A: INTERMITTENT POND ±190' N  
 B: INTERMITTENT POND ±390' N  
 C: STOCK POND ±440' E  
 D: \*WATER WELL (PERMIT #269226, WELL CONSTRUCTED) ±949' W  
 \*WELL LOCATION NOT FIELD VERIFIED

**T2N**  
**R63W**

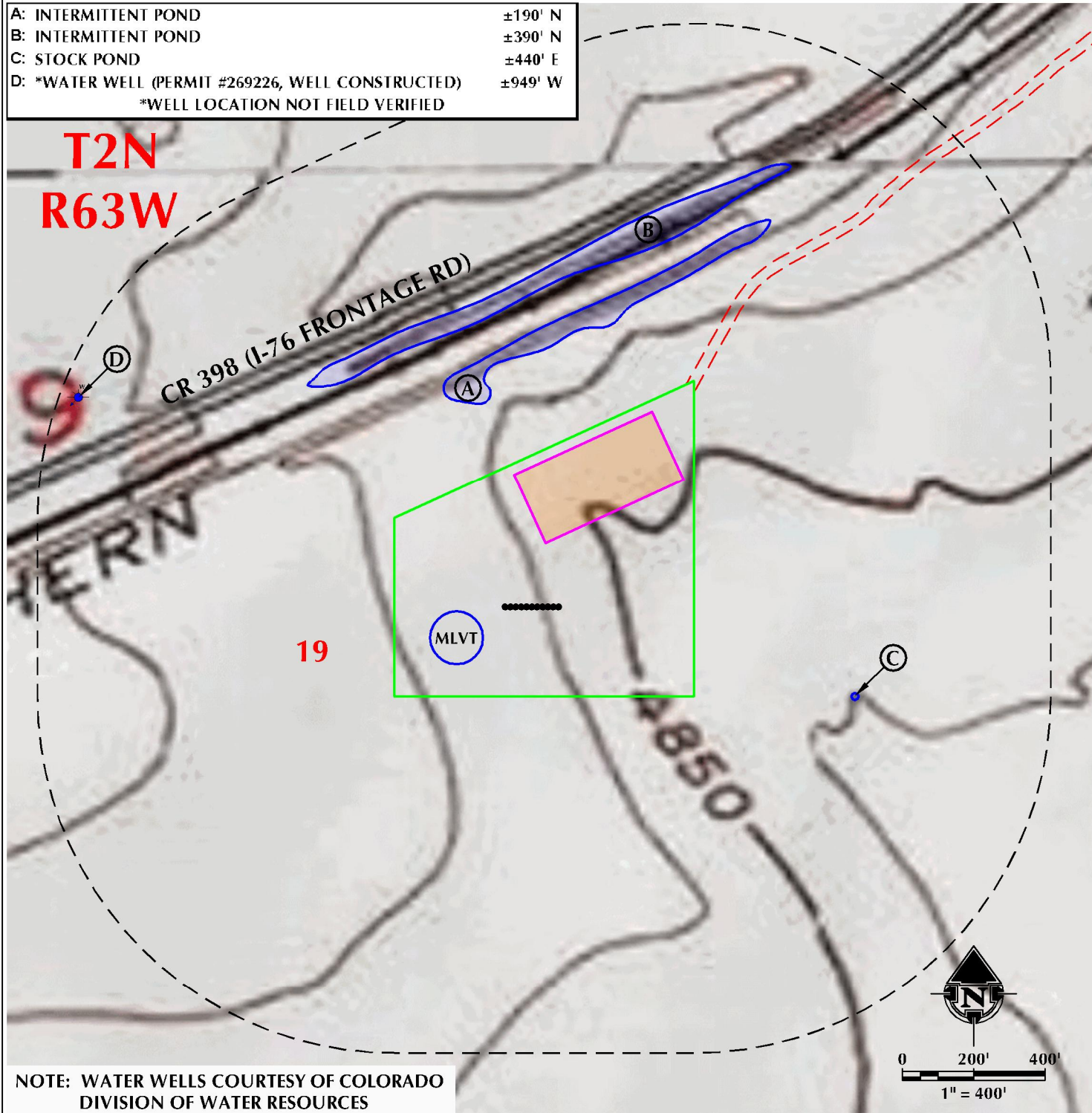

#### LEGEND

- PROPOSED WELL
- ACCESS ROAD
- DITCH/CANAL/DRAINAGE
- DISTURBANCE AREA
- PROPOSED FACILITY
- 1000' DISTURBANCE BUFFER

\*ALL DISTANCES MEASURED FROM EDGE OF DISTURBANCE.

- ROAD - IMPROVED - EXISTING
- ROAD - PRIMITIVE - EXISTING
- ROAD - HIGHWAY - EXISTING

**PAD - KBL 02N-63W-19**

**HYDROLOGY MAP**  
 KBL 1918-01H, KBL 1918-02H,  
 KBL 1918-03H, KBL 1918-04H, KBL 1918-05H,  
 KBL 1918-06H, KBL 1930-07H, KBL 1930-08H,  
 KBL 1930-09H, KBL 1930-11H & KBL 1930-12H  
 LOCATED IN SECTION 19  
 T2N, R63W, 6TH P.M.  
 WELD COUNTY, COLORADO



5950 Cedar Springs Road, Suite 200  
 Dallas, Texas 75235



**CONSULTING, LLC**

**SHERIDAN OFFICE**  
 1095 Saberton Avenue  
 Sheridan, Wyoming 82801  
 Phone 307-674-0609

**LOVELAND OFFICE**  
 6706 North Franklin Avenue  
 Loveland, Colorado 80538  
 Phone 970-776-4331

SCALE:	1" = 400ft	NAD83 CO-Nft
DRAWN:	DJD	DATE: 7/3/19
REVISED:	HJL	DATE: 1/7/2020