



99999999

KATY T-B. X

## WELL SITE INSPECTION

PERMIT NO \_\_\_\_\_

DATE AUG 28, 1985COUNTY LOGANLEGAL SE/4 S 27 T 2 N R 54 WOPERATOR FALCON-SEPPOENWELL NAME SCHWARZ

RIG \_\_\_\_\_

SURFACE CASING \_\_\_\_\_ SIZE \_\_\_\_\_ DEPTH \_\_\_\_\_ DATE \_\_\_\_\_

CEMENT VOLUME \_\_\_\_\_ RETURNS \_\_\_\_\_ WOC \_\_\_\_\_

PROBABLE FOX HILLS DEPTH \_\_\_\_\_

MUD PITS \_\_\_\_\_

DISPOSAL \_\_\_\_\_

PRODUCTION STRING \_\_\_\_\_ SIZE \_\_\_\_\_ DEPTH \_\_\_\_\_

STAGED \_\_\_\_\_ CBL CHECKED \_\_\_\_\_

SQUEEZE \_\_\_\_\_ FRAC JOB \_\_\_\_\_

BATTERY \_\_\_\_\_ SIGN \_\_\_\_\_

SITE INSPECTION AFTER DRILLING Tucker has cut pitsfor proposed well. (See over). Cannot  
find old well head. Did find  
drilling line, pump rubber, etc.If necessary, survey from old well  
spot, get metal detector & dig.

DIRECTIONS \_\_\_\_\_

SurveyThis is a wheat field  
in stubble

ACTION \_\_\_\_\_

ENGINEER

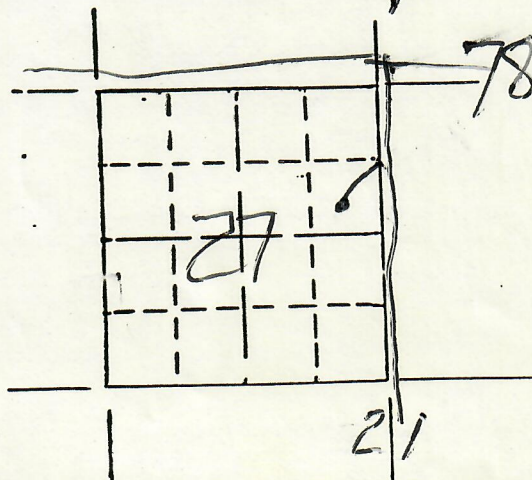
D. Bucknell

00823460



TWP 12N R54W

24 23

Rd 18

27 26

1827

~~Clark~~ Tucker

666'

1980

New reserve &  
mud pits

660

FALCON SEA  
SCHWARZ

Rd 21

15

15