

Location:	COLORADO	Slot:	SLOT#09 JODSTER SOUTH 25-9HZ (2317FNL & 704FEL,SEC.25)
Field:	LARIMER COUNTY	Well:	JODSTER SOUTH 25-9HZ
Facility:	SEC.25-T5N-R68W	Wellbore:	JODSTER SOUTH 25-9HZ PWB
Plot reference wellpath is JODSTER SOUTH 25-9HZ PWP Rev-A-0		Grid System: NAD83 / UTM Zone 13 North, US feet	
True vertical depths are referenced to PD 564 (26') (RT)		North Reference: True north	
Reference wellpath measured depths are referenced to PD 564 (26') (RT)		Scale: True distance	
PD 564 (26') (RT) to Mean Sea Level: 4887 feet		Coordinates are in feet referenced to Slot	
Mean Sea Level to Mud line (At Slot: SLOT#09 JODSTER SOUTH 25-9HZ (2317FNL & 704FEL,SEC.25)): 0 feet		Depths are in feet	
Offset wellpath MDs are referenced to each path's default MD datum		Created by: ragnos on 2019-11-29; Database: WellArchitect:DB	

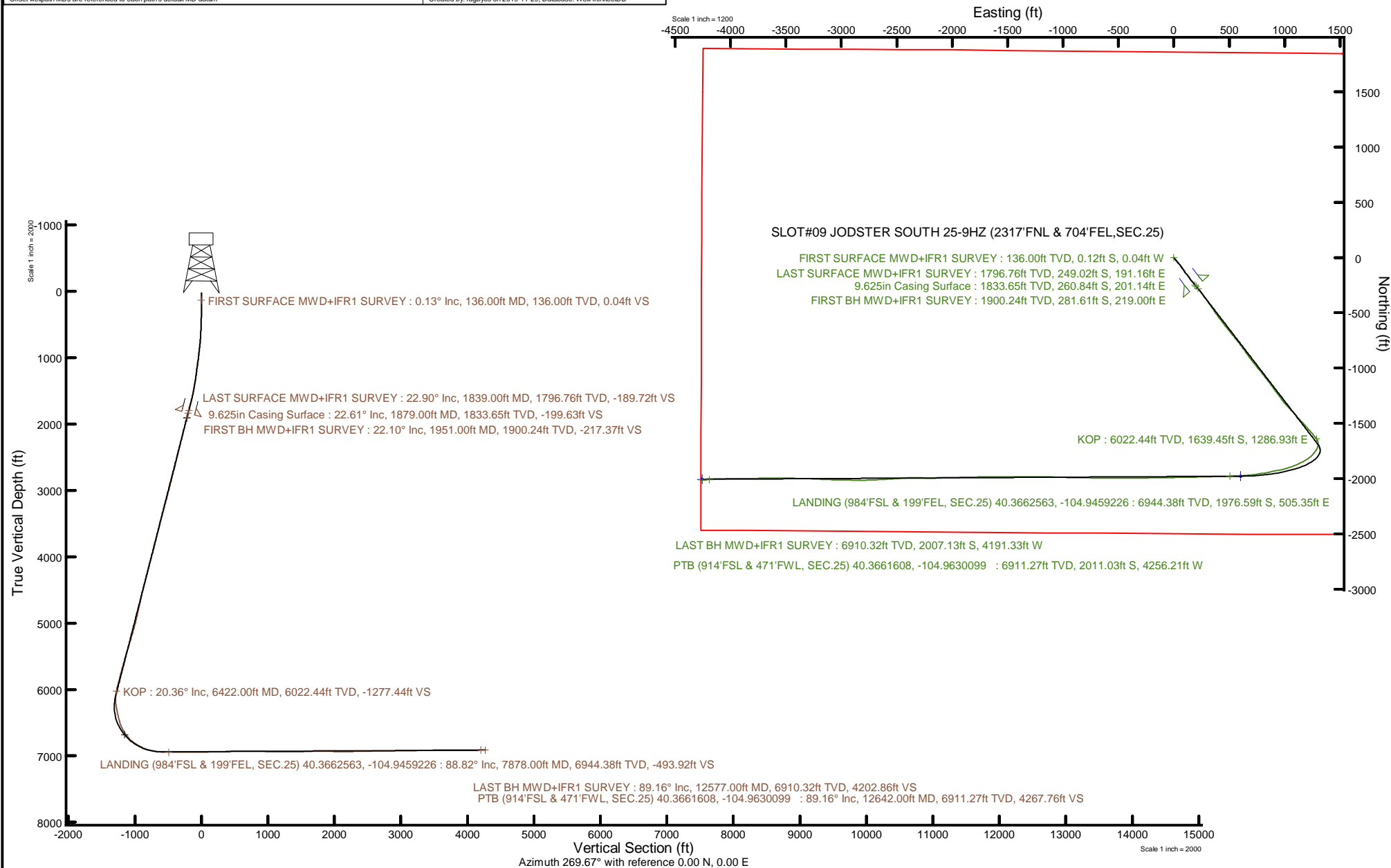

### REFERENCE WELLPATH IDENTIFICATION

Operator	KERR-MCGEE OIL & GAS ONSHORE LP (WA)	Well	JODSTER SOUTH 25-9HZ
Field	LARIMER COUNTY	API/Legal	
Facility	SEC.25-T5N-R68W	Wellbore	JODSTER SOUTH 25-9HZ AWB
Slot	SLOT#09 JODSTER SOUTH 25-9HZ (2317'FNL & 704'FEL,SEC.25)		

### REPORT SETUP INFORMATION

Projection System	NAD83 / UTM Zone 13 North, US feet	Software System	WellArchitect® 6.0
North Reference	True	User	Ragbyos
Scale	0.999600	Report Generated	11/29/2019 at 11:16:58 AM
Convergence at slot	0.03° East	Database	WellArchitectDB

### WELLPATH LOCATION

	Local coordinates		Grid coordinates		Geographic coordinates	
	North[ft]	East[ft]	Easting[US ft]	Northing[US ft]	Latitude	Longitude
Slot Location	-119.92	-1.08	1654973.55	14662086.55	40.3716819°	-104.9477361°
Facility Reference Pt			1654974.57	14662206.42	40.3720111°	-104.9477322°
Field Reference Pt			0.00	0.00	0.0000000°	-109.4887439°

### WELLPATH DATUM

Calculation method	Minimum curvature	PD 564 (26') (RT) to Facility Vertical Datum	4887.00ft
Horizontal Reference Pt	Slot	PD 564 (26') (RT) to Mean Sea Level	4887.00ft
Vertical Reference Pt	PD 564 (26') (RT)	PD 564 (26') (RT) to Mud Line at Slot (SLOT#09 JODSTER SOUTH 25-9HZ (2317'FNL & 704'FEL,SEC.25))	4887.00ft
MD Reference Pt	PD 564 (26') (RT)	Section Origin	N 0.00, E 0.00 ft
Field Vertical Reference	Mean Sea Level	Section Azimuth	269.67°

### REFERENCE WELLPATH IDENTIFICATION

Operator	KERR-MCGEE OIL & GAS ONSHORE LP (WA)	Well	JODSTER SOUTH 25-9HZ
Field	LARIMER COUNTY	API/Legal	
Facility	SEC.25-T5N-R68W	Wellbore	JODSTER SOUTH 25-9HZ AWB
Slot	SLOT#09 JODSTER SOUTH 25-9HZ (2317'FNL & 704'FEL,SEC.25)		

### WELLPATH DATA (143 stations) † = interpolated, ‡ = extrapolated station

MD [ft]	Inclination [°]	Azimuth [°]	TVD [ft]	Vert Sect [ft]	North [ft]	East [ft]	Grid East [US ft]	Grid North [US ft]	Latitude	Longitude	DLS [°/100ft]	Comments
0.00†	0.000	196.430	0.00	0.00	0.00	0.00	1654973.55	14662086.55	40.3716819	-104.9477361	0.00	
26.00	0.000	196.430	26.00	0.00	0.00	0.00	1654973.55	14662086.55	40.3716819	-104.9477361	0.00	
136.00	0.130	196.430	136.00	0.04	-0.12	-0.04	1654973.52	14662086.43	40.3716816	-104.9477362	0.12	FIRST SURFACE MWD+IFR1 SURVEY
231.00	0.480	164.350	231.00	-0.04	-0.61	0.04	1654973.59	14662085.94	40.3716803	-104.9477360	0.40	
327.00	1.270	146.680	326.99	-0.72	-1.88	0.73	1654974.29	14662084.67	40.3716768	-104.9477335	0.86	
422.00	2.770	147.830	421.92	-2.51	-4.71	2.54	1654976.09	14662081.85	40.3716690	-104.9477270	1.58	
517.00	3.650	142.900	516.78	-5.53	-9.06	5.58	1654979.14	14662077.49	40.3716571	-104.9477161	0.97	
611.00	4.440	141.590	610.54	-9.56	-14.30	9.65	1654983.20	14662072.26	40.3716427	-104.9477015	0.85	
706.00	5.670	139.120	705.17	-14.88	-20.73	15.00	1654988.56	14662065.84	40.3716250	-104.9476823	1.31	
802.00	8.350	140.180	800.44	-22.40	-29.67	22.57	1654996.13	14662056.90	40.3716005	-104.9476551	2.79	
897.00	9.980	139.740	894.23	-32.07	-41.25	32.31	1655005.87	14662045.33	40.3715687	-104.9476202	1.72	
992.00	11.820	140.000	987.51	-43.57	-54.99	43.89	1655017.45	14662031.61	40.3715310	-104.9475786	1.94	
1088.00	12.610	141.940	1081.34	-56.26	-70.77	56.67	1655030.24	14662015.84	40.3714877	-104.9475327	0.93	
1183.00	13.050	145.450	1173.96	-68.63	-87.77	69.14	1655042.72	14661998.85	40.3714410	-104.9474880	0.94	
1278.00	13.840	144.930	1266.36	-81.14	-105.90	81.75	1655055.34	14661980.74	40.3713913	-104.9474427	0.84	
1373.00	14.500	144.490	1358.47	-94.47	-124.88	95.19	1655068.78	14661961.77	40.3713391	-104.9473945	0.70	
1468.00	16.660	142.460	1449.97	-109.56	-145.37	110.40	1655083.99	14661941.31	40.3712829	-104.9473399	2.34	
1563.00	20.300	143.340	1540.06	-127.56	-169.39	128.54	1655102.14	14661917.30	40.3712170	-104.9472748	3.84	
1658.00	21.090	143.080	1628.93	-147.51	-196.28	148.65	1655122.26	14661890.44	40.3711432	-104.9472026	0.84	
1753.00	22.020	140.710	1717.29	-168.90	-223.73	170.19	1655143.81	14661863.01	40.3710678	-104.9471253	1.34	
1839.00	22.900	140.000	1796.76	-189.72	-249.02	191.16	1655164.78	14661837.74	40.3709984	-104.9470501	1.07	LAST SURFACE MWD+IFR1 SURVEY
1951.00	22.100	138.960	1900.24	-217.37	-281.61	219.00	1655192.63	14661805.18	40.3709090	-104.9469502	0.80	FIRST BH MWD+IFR1 SURVEY
2040.00	22.010	142.450	1982.73	-238.38	-307.46	240.16	1655213.79	14661779.36	40.3708380	-104.9468742	1.48	
2130.00	23.460	144.030	2065.73	-259.02	-335.33	260.96	1655234.60	14661751.51	40.3707615	-104.9467996	1.75	
2219.00	22.980	144.680	2147.52	-279.30	-363.84	281.41	1655255.06	14661723.02	40.3706832	-104.9467262	0.61	
2309.00	24.300	144.780	2229.97	-299.97	-393.31	302.25	1655275.91	14661693.58	40.3706024	-104.9466514	1.47	
2398.00	24.400	145.690	2311.05	-320.72	-423.45	323.17	1655296.84	14661663.46	40.3705196	-104.9465763	0.44	
2487.00	23.920	145.930	2392.26	-341.01	-453.58	343.64	1655317.32	14661633.35	40.3704369	-104.9465029	0.55	
2577.00	22.710	145.440	2474.91	-360.92	-483.00	363.72	1655337.41	14661603.95	40.3703561	-104.9464308	1.36	
2667.00	23.300	143.930	2557.75	-381.09	-511.70	384.05	1655357.75	14661575.28	40.3702774	-104.9463578	0.93	
2756.00	22.620	144.480	2639.70	-401.23	-539.86	404.36	1655378.07	14661547.15	40.3702001	-104.9462849	0.80	
2846.00	23.270	142.260	2722.58	-422.01	-568.00	425.30	1655399.01	14661519.02	40.3701228	-104.9462098	1.20	
2935.00	22.020	142.610	2804.72	-442.74	-595.16	446.19	1655419.91	14661491.89	40.3700483	-104.9461348	1.41	
3025.00	22.330	141.440	2888.06	-463.49	-621.94	467.09	1655440.82	14661465.14	40.3699748	-104.9460598	0.60	
3114.00	22.740	141.160	2970.26	-484.66	-648.56	488.42	1655462.16	14661438.54	40.3699017	-104.9459833	0.48	
3203.00	22.630	141.530	3052.38	-505.95	-675.36	509.86	1655483.61	14661411.76	40.3698281	-104.9459063	0.20	
3293.00	22.790	140.120	3135.40	-527.74	-702.29	531.81	1655505.56	14661384.85	40.3697542	-104.9458276	0.63	
3382.00	22.880	141.360	3217.43	-549.44	-729.04	553.66	1655527.42	14661358.13	40.3696808	-104.9457491	0.55	
3472.00	23.310	142.000	3300.21	-571.17	-756.73	575.55	1655549.32	14661330.46	40.3696048	-104.9456706	0.55	
3561.00	23.670	143.680	3381.84	-592.43	-785.00	596.97	1655570.75	14661302.21	40.3695272	-104.9455937	0.85	
3650.00	23.750	143.460	3463.33	-613.52	-813.80	618.23	1655592.01	14661273.44	40.3694481	-104.9455174	0.13	
3740.00	23.870	144.040	3545.67	-634.83	-843.10	639.71	1655613.50	14661244.16	40.3693677	-104.9454403	0.29	
3829.00	23.720	144.410	3627.10	-655.65	-872.23	660.70	1655634.51	14661215.06	40.3692877	-104.9453650	0.24	
3918.00	22.840	145.230	3708.85	-675.76	-900.98	680.97	1655654.78	14661186.33	40.3692088	-104.9452923	1.05	
4008.00	21.980	142.850	3792.06	-695.73	-928.75	701.11	1655674.92	14661158.58	40.3691326	-104.9452200	1.39	

### REFERENCE WELLPATH IDENTIFICATION

Operator	KERR-MCGEE OIL & GAS ONSHORE LP (WA)	Well	JODSTER SOUTH 25-9HZ
Field	LARIMER COUNTY	API/Legal	
Facility	SEC.25-T5N-R68W	Wellbore	JODSTER SOUTH 25-9HZ AWB
Slot	SLOT#09 JODSTER SOUTH 25-9HZ (2317'FNL & 704'FEL,SEC.25)		

### WELLPATH DATA (143 stations) † = interpolated, ‡ = extrapolated station

MD [ft]	Inclination [°]	Azimuth [°]	TVD [ft]	Vert Sect [ft]	North [ft]	East [ft]	Grid East [US ft]	Grid North [US ft]	Latitude	Longitude	DLS [°/100ft]	Comments
4097.00	22.240	142.150	3874.51	-715.97	-955.33	721.50	1655695.33	14661132.03	40.3690596	-104.9451468	0.42	
4187.00	23.890	139.820	3957.32	-738.02	-982.70	743.71	1655717.54	14661104.68	40.3689845	-104.9450671	2.09	
4276.00	22.320	140.020	4039.18	-760.35	-1009.42	766.20	1655740.04	14661077.98	40.3689111	-104.9449864	1.77	
4365.00	23.360	140.880	4121.20	-782.19	-1036.06	788.19	1655762.04	14661051.37	40.3688380	-104.9449075	1.23	
4455.00	22.670	143.330	4204.03	-803.65	-1063.82	809.81	1655783.66	14661023.63	40.3687618	-104.9448299	1.31	
4544.00	23.030	141.520	4286.05	-824.56	-1091.20	830.88	1655804.74	14660996.27	40.3686866	-104.9447543	0.89	
4634.00	22.890	142.620	4368.92	-845.98	-1118.89	852.46	1655826.33	14660968.61	40.3686106	-104.9446769	0.50	
4723.00	23.340	143.170	4450.78	-866.90	-1146.76	873.54	1655847.42	14660940.76	40.3685341	-104.9446012	0.56	
4813.00	22.980	144.520	4533.52	-887.62	-1175.34	894.42	1655868.31	14660912.21	40.3684557	-104.9445263	0.71	
4902.00	21.360	144.740	4615.94	-906.90	-1202.72	913.86	1655887.76	14660884.85	40.3683805	-104.9444565	1.82	
4991.00	20.890	143.100	4698.96	-925.64	-1228.64	932.75	1655906.65	14660858.95	40.3683094	-104.9443888	0.85	
5081.00	20.150	140.720	4783.25	-944.94	-1253.48	952.20	1655926.11	14660834.14	40.3682412	-104.9443190	1.24	
5170.00	21.180	145.040	4866.53	-963.72	-1278.52	971.12	1655945.03	14660809.11	40.3681725	-104.9442511	2.07	
5260.00	21.630	142.770	4950.32	-982.91	-1305.05	990.47	1655964.40	14660782.60	40.3680996	-104.9441816	1.05	
5349.00	21.800	137.260	5033.01	-1003.91	-1330.25	1011.61	1655985.54	14660757.43	40.3680305	-104.9441058	2.30	
5463.00	22.450	136.840	5138.62	-1032.98	-1361.68	1040.87	1656014.81	14660726.03	40.3679442	-104.9440008	0.59	
5553.00	22.300	134.920	5221.85	-1056.69	-1386.27	1064.71	1656038.66	14660701.46	40.3678767	-104.9439152	0.83	
5642.00	24.680	138.690	5303.47	-1080.77	-1412.16	1088.94	1656062.89	14660675.60	40.3678056	-104.9438283	3.16	
5732.00	26.870	139.270	5384.51	-1106.27	-1441.69	1114.62	1656088.58	14660646.10	40.3677246	-104.9437361	2.45	
5821.00	23.710	137.030	5464.97	-1131.43	-1470.03	1139.95	1656113.91	14660617.78	40.3676468	-104.9436452	3.71	
5910.00	22.500	137.310	5546.83	-1155.03	-1495.64	1163.69	1656137.66	14660592.20	40.3675765	-104.9435600	1.37	
6000.00	23.160	138.620	5629.78	-1178.26	-1521.58	1187.07	1656161.04	14660566.28	40.3675053	-104.9434761	0.93	
6089.00	20.840	138.250	5712.29	-1200.23	-1546.53	1209.18	1656183.16	14660541.36	40.3674368	-104.9433968	2.61	
6178.00	21.630	138.940	5795.25	-1221.40	-1570.71	1230.50	1656204.48	14660517.20	40.3673704	-104.9433203	0.93	
6268.00	21.580	139.760	5878.93	-1242.84	-1595.85	1252.08	1656226.08	14660492.08	40.3673014	-104.9432428	0.34	
6357.00	21.470	140.550	5961.72	-1263.62	-1620.92	1273.01	1656247.01	14660467.03	40.3672326	-104.9431677	0.35	
6422.00†	20.359	145.747	6022.44	-1277.44	-1639.45	1286.93	1656260.93	14660448.52	40.3671817	-104.9431178	3.33	KOP
6446.00	19.990	147.800	6044.97	-1281.93	-1646.37	1291.47	1656265.47	14660441.60	40.3671627	-104.9431015	3.33	
6536.00	23.640	174.490	6128.72	-1291.71	-1677.44	1301.42	1656275.45	14660410.55	40.3670774	-104.9430658	11.63	
6625.00	23.620	197.580	6210.43	-1287.83	-1712.27	1297.75	1656271.79	14660375.73	40.3669818	-104.9430790	10.34	
6715.00	19.880	212.840	6294.07	-1273.90	-1742.35	1283.99	1656258.05	14660345.65	40.3668992	-104.9431284	7.50	
6804.00	18.390	218.020	6378.16	-1256.91	-1766.13	1267.13	1656241.22	14660321.88	40.3668340	-104.9431889	2.54	
6894.00	21.540	225.760	6462.76	-1236.18	-1788.85	1246.54	1656220.65	14660299.15	40.3667716	-104.9432628	4.56	
6983.00	25.190	233.430	6544.46	-1209.12	-1811.54	1219.61	1656193.74	14660276.45	40.3667093	-104.9433594	5.33	
7073.00	32.640	238.930	6623.20	-1172.76	-1835.52	1183.38	1656157.54	14660252.46	40.3666435	-104.9434894	8.78	
7162.00	41.370	244.940	6694.23	-1125.30	-1860.42	1136.07	1656110.27	14660227.55	40.3665752	-104.9436592	10.61	
7252.00	48.270	247.150	6758.04	-1067.19	-1886.09	1078.11	1656052.34	14660201.85	40.3665047	-104.9438672	7.86	
7341.00	57.560	256.140	6811.71	-999.77	-1908.06	1010.81	1655985.08	14660179.85	40.3664444	-104.9441087	13.17	
7431.00	62.280	258.300	6856.81	-923.74	-1925.25	934.88	1655909.19	14660162.63	40.3663973	-104.9443812	5.64	
7520.00	69.090	259.060	6893.44	-844.17	-1941.14	855.40	1655829.75	14660146.69	40.3663536	-104.9446664	7.69	
7610.00	77.410	260.870	6919.36	-759.29	-1956.12	770.61	1655745.00	14660131.67	40.3663125	-104.9449707	9.44	
7699.00	83.200	263.790	6934.34	-672.33	-1967.80	683.71	1655658.15	14660119.94	40.3662805	-104.9452826	7.26	
7788.00	87.540	267.860	6941.53	-583.86	-1974.25	595.27	1655569.75	14660113.44	40.3662628	-104.9455999	6.67	
7878.00	88.820	269.150	6944.38	-493.92	-1976.59	505.35	1655479.87	14660111.05	40.3662563	-104.9459226	2.02	LANDING (984'FSL & 199'FEL, SEC.25) 40.3662563, -104.9459226
7967.00	89.420	268.300	6945.75	-404.95	-1978.57	416.38	1655390.94	14660109.01	40.3662509	-104.9462419	1.17	

REFERENCE WELLPATH IDENTIFICATION			
Operator	KERR-MCGEE OIL & GAS ONSHORE LP (WA)	Well	JODSTER SOUTH 25-9HZ
Field	LARIMER COUNTY	API/Legal	
Facility	SEC.25-T5N-R68W	Wellbore	JODSTER SOUTH 25-9HZ AWB
Slot	SLOT#09 JODSTER SOUTH 25-9HZ (2317'FNL & 704'FEL,SEC.25)		

WELLPATH DATA (143 stations)												
MD [ft]	Inclination [°]	Azimuth [°]	TVD [ft]	Vert Sect [ft]	North [ft]	East [ft]	Grid East [US ft]	Grid North [US ft]	Latitude	Longitude	DLS [°/100ft]	Comments
8056.00	89.850	268.340	6946.32	-315.97	-1981.18	327.42	1655302.02	14660106.35	40.3662438	-104.9465611	0.49	
8146.00	90.500	268.530	6946.04	-226.00	-1983.64	237.46	1655212.09	14660103.84	40.3662370	-104.9468840	0.75	
8235.00	90.640	268.260	6945.16	-137.02	-1986.13	148.50	1655123.16	14660101.30	40.3662302	-104.9472032	0.34	
8324.00	91.090	269.360	6943.81	-48.04	-1987.98	59.53	1655034.23	14660099.40	40.3662251	-104.9475225	1.34	
8414.00	91.330	269.000	6941.91	41.93	-1989.27	-30.44	1654944.30	14660098.06	40.3662216	-104.9478453	0.48	
8503.00	91.840	268.720	6939.45	130.89	-1991.04	-119.39	1654855.39	14660096.24	40.3662167	-104.9481645	0.65	
8593.00	91.150	269.520	6937.10	220.85	-1992.42	-209.35	1654765.47	14660094.80	40.3662129	-104.9484874	1.17	
8682.00	91.720	270.060	6934.87	309.82	-1992.75	-298.32	1654676.53	14660094.42	40.3662120	-104.9488066	0.88	
8771.00	90.690	269.330	6933.00	398.80	-1993.22	-387.29	1654587.59	14660093.90	40.3662107	-104.9491259	1.42	
8860.00	91.250	269.580	6931.50	487.79	-1994.07	-476.28	1654498.64	14660093.00	40.3662084	-104.9494453	0.69	
8949.00	89.320	270.120	6931.05	576.78	-1994.30	-565.27	1654409.69	14660092.71	40.3662077	-104.9497646	2.25	
9038.00	89.620	270.460	6931.88	665.77	-1993.85	-654.27	1654320.73	14660093.11	40.3662090	-104.9500840	0.51	
9128.00	90.620	271.190	6931.69	755.75	-1992.55	-744.25	1654230.77	14660094.35	40.3662125	-104.9504069	1.38	
9217.00	89.160	270.940	6931.86	844.72	-1990.90	-833.24	1654141.83	14660095.95	40.3662171	-104.9507263	1.66	
9307.00	89.080	271.060	6933.24	934.69	-1989.33	-923.21	1654051.89	14660097.47	40.3662214	-104.9510491	0.16	
9396.00	89.450	271.260	6934.38	1023.65	-1987.53	-1012.19	1653962.95	14660099.22	40.3662263	-104.9513684	0.47	
9486.00	90.530	272.860	6934.40	1113.57	-1984.29	-1102.12	1653873.04	14660102.40	40.3662352	-104.9516912	2.14	
9575.00	89.390	269.580	6934.46	1202.52	-1982.40	-1191.09	1653784.11	14660104.24	40.3662404	-104.9520104	3.90	
9665.00	89.880	269.720	6935.03	1292.52	-1982.95	-1281.09	1653694.15	14660103.64	40.3662388	-104.9523334	0.57	
9754.00	89.850	269.950	6935.24	1381.52	-1983.20	-1370.09	1653605.19	14660103.33	40.3662381	-104.9526528	0.26	
9843.00	90.520	270.740	6934.96	1470.51	-1982.67	-1459.08	1653516.23	14660103.81	40.3662396	-104.9529722	1.16	
9933.00	91.490	270.910	6933.38	1560.48	-1981.37	-1549.06	1653426.29	14660105.06	40.3662431	-104.9532950	1.09	
10022.00	90.730	268.970	6931.65	1649.46	-1981.47	-1638.04	1653337.34	14660104.91	40.3662428	-104.9536144	2.34	
10112.00	89.820	268.530	6931.22	1739.44	-1983.43	-1728.01	1653247.41	14660102.89	40.3662374	-104.9539372	1.12	
10201.00	89.720	268.640	6931.58	1828.43	-1985.63	-1816.98	1653158.47	14660100.64	40.3662314	-104.9542565	0.17	
10291.00	88.870	268.510	6932.69	1918.40	-1987.87	-1906.95	1653068.54	14660098.35	40.3662252	-104.9545794	0.96	
10380.00	89.960	268.760	6933.59	2007.38	-1989.99	-1995.92	1652979.61	14660096.18	40.3662194	-104.9548986	1.26	
10470.00	89.420	268.160	6934.08	2097.36	-1992.40	-2085.88	1652889.68	14660093.71	40.3662127	-104.9552215	0.90	
10559.00	89.930	270.070	6934.59	2186.35	-1993.78	-2174.87	1652800.74	14660092.29	40.3662089	-104.9555408	2.22	
10648.00	91.300	271.990	6933.63	2275.31	-1992.18	-2263.84	1652711.80	14660093.83	40.3662133	-104.9558601	2.65	
10738.00	91.040	269.390	6931.79	2365.27	-1991.10	-2353.81	1652621.87	14660094.86	40.3662162	-104.9561830	2.90	
10827.00	90.550	265.930	6930.56	2454.19	-1994.73	-2442.71	1652533.00	14660091.18	40.3662063	-104.9565020	3.93	
10917.00	92.800	265.960	6927.93	2543.96	-2001.09	-2532.44	1652443.31	14660084.77	40.3661888	-104.9568240	2.50	
11007.00	91.520	267.370	6924.54	2633.77	-2006.32	-2622.22	1652353.57	14660079.48	40.3661744	-104.9571462	2.12	
11096.00	90.240	267.390	6923.17	2722.69	-2010.39	-2711.12	1652264.71	14660075.37	40.3661632	-104.9574652	1.44	
11186.00	90.050	269.250	6922.94	2812.66	-2013.03	-2801.07	1652174.79	14660072.67	40.3661559	-104.9577880	2.08	
11275.00	90.040	271.040	6922.87	2901.65	-2012.80	-2890.07	1652085.83	14660072.85	40.3661565	-104.9581074	2.01	
11365.00	89.640	269.930	6923.12	2991.64	-2012.04	-2980.06	1651995.87	14660073.56	40.3661586	-104.9584303	1.31	
11454.00	90.560	272.720	6922.97	3080.59	-2009.98	-3069.03	1651906.94	14660075.56	40.3661642	-104.9587496	3.30	
11544.00	90.900	272.440	6921.82	3170.47	-2005.93	-3158.93	1651817.07	14660079.56	40.3661753	-104.9590722	0.49	
11633.00	91.810	272.750	6919.72	3259.33	-2001.90	-3247.81	1651728.23	14660083.53	40.3661863	-104.9593912	1.08	
11723.00	91.160	271.480	6917.38	3349.21	-1998.58	-3337.72	1651638.35	14660086.80	40.3661954	-104.9597138	1.58	
11812.00	91.990	271.290	6914.94	3438.14	-1996.43	-3426.66	1651549.45	14660088.89	40.3662013	-104.9600330	0.96	
11902.00	90.500	270.820	6912.98	3528.09	-1994.78	-3516.62	1651459.52	14660090.50	40.3662058	-104.9603558	1.74	
11991.00	90.640	270.360	6912.10	3617.07	-1993.86	-3605.61	1651370.57	14660091.36	40.3662082	-104.9606752	0.54	

## TARGETS

# Actual Wellpath Report

JODSTER SOUTH 25-9HZ AWP

Page 6 of 7

REFERENCE WELLPATH IDENTIFICATION			
Operator	KERR-MCGEE OIL & GAS ONSHORE LP (WA)	Well	JODSTER SOUTH 25-9HZ
Field	LARIMER COUNTY	API/Legal	
Facility	SEC.25-T5N-R68W	Wellbore	JODSTER SOUTH 25-9HZ AWB
Slot	SLOT#09 JODSTER SOUTH 25-9HZ (2317'FNL & 704'FEL,SEC.25)		

WELLPATH COMPOSITION - Ref Wellbore: JODSTER SOUTH 25-9HZ AWB Ref Wellpath: JODSTER SOUTH 25-9HZ AWP					
Start MD [ft]	End MD [ft]	Positional Uncertainty Model	Log Name/Comment	Wellbore	Survey Date
26.00	1839.00	Custom APC_ISCWSA REV 2 MWD+IFR1 (approximation)	Custom APC ISCWSA Rev-2 MWD+IFR1 <137 - 1839>	JODSTER SOUTH 25-9HZ AWB	
1839.00	12642.00	Custom_APC_ISCWSA REV 2 MWD	BH Custom APC ISCWSA Rev-2 MWD+IFR1 <1951 - 12577>	JODSTER SOUTH 25-9HZ AWB	11/13/2019

REFERENCE WELLPATH IDENTIFICATION			
Operator	KERR-MCGEE OIL & GAS ONSHORE LP (WA)	Well	JODSTER SOUTH 25-9HZ
Field	LARIMER COUNTY	API/Legal	
Facility	SEC.25-T5N-R68W	Wellbore	JODSTER SOUTH 25-9HZ AWB
Slot	SLOT#09 JODSTER SOUTH 25-9HZ (2317'FNL & 704'FEL,SEC.25)		

WELLPATH COMMENTS				
MD [ft]	Inclination [°]	Azimuth [°]	TVD [ft]	Comment
136.00	0.130	196.430	136.00	FIRST SURFACE MWD+IFR1 SURVEY
1839.00	22.900	140.000	1796.76	LAST SURFACE MWD+IFR1 SURVEY
1951.00	22.100	138.960	1900.24	FIRST BH MWD+IFR1 SURVEY
6422.00	20.359	145.747	6022.44	KOP
7878.00	88.820	269.150	6944.38	LANDING (984'FSL & 199'FEL, SEC.25) 40.3662563, -104.9459226
12577.00	89.160	266.560	6910.32	LAST BH MWD+IFR1 SURVEY
12642.00	89.160	266.560	6911.27	PTB (914'FSL & 471'FWL, SEC.25) 40.3661608, -104.9630099