

# Facility Layout Drawing

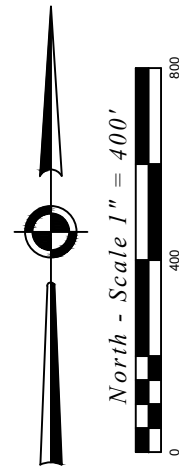
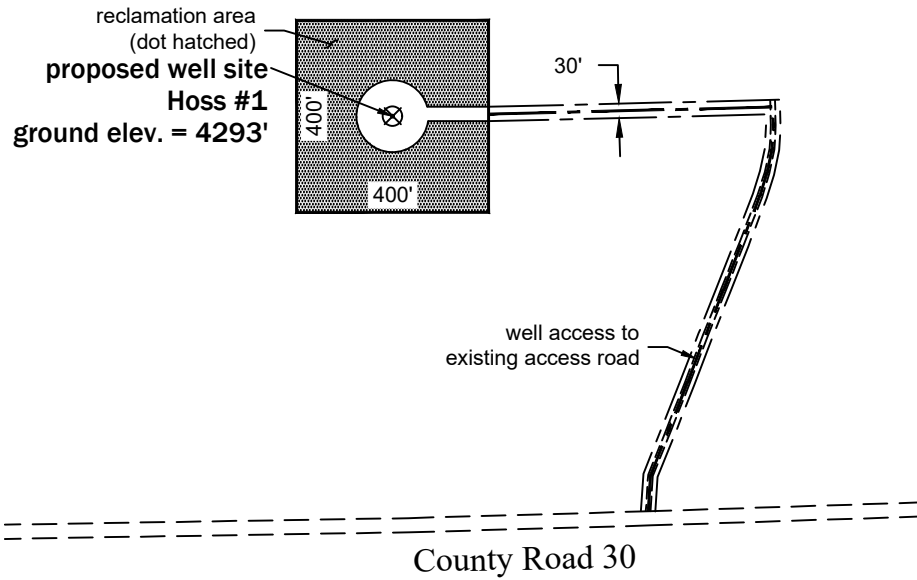

Size of disturbed area during construction in acres: 4.7 acres  
 Size of location after interim reclamation in acres: 1.5 acres  
 Estimated location ground elevation: 4293' [NAVD88]

P:\Project\2019\19039\dwg\19039\_Lay\_Well.dwg January 20, 2020 - 7:52am

Well Name: <b>Hoss #1</b>	Field Date <b>1.16.2020</b>	Prepared for: <b>St. Croix Operating, Inc.</b>	Project#: <b>19039.001</b>
Section 34-T1N-R49W-6th PM, SE-SE	Party Chief <b>ADS/DCB</b>	PLS Corporation 532 West 66th Street Loveland, Colorado 80538 970.669.2100 office - info@plscorporation.com	
Washington County, Colorado	Proj. Manager <b>MDG</b>		
	Drawing Date <b>1.20.2020</b>		