



Extraction Oil & Gas
Project: Weld County, CO (NAD83)
Site: Sec 07-T01S-R68W Livingston Pad
Well: Livingston S19-25-10N
Wellbore: Wellbore #1
Design: Wellbore #1 (Livingston S19-25-10N/Wellbore #1)
Patterson 901

PROJECT DETAILS: Weld County, CO (NAD83)
Geodetic System: US State Plane 1983
Datum: North American Datum 1983
Ellipsoid: GRS 1980
Zone: Colorado Northern Zone
System Datum: Ground Level
Local North: True

WELL DETAILS: Livingston S19-25-10N

Ground Elevation:: 5322.90
RKB Elevation: KB @ 5351.90usft (Patterson 901)
Rig Name: Patterson 901

Northing	Easting	Latitude	Longitude
1235372.53	3129038.37	39.978562	-105.039544

ANNOTATIONS

MD	Inc	Azi	TVD	+N/-S	+E/-W	VSect	Departure	Annotation
1586.00	9.23	337.00	1582.41	46.58	-28.17	-45.52	63.88	Tie into Surface Surveys
1859.00	8.04	331.25	1852.32	83.47	-45.91	-81.74	104.86	First MWD Survey @ 1859' MD
7830.91	30.00	180.40	7754.47	605.37	-415.07	-589.85	916.40	30° Inclination @ 7830.91' MD
8239.02	70.00	181.05	8009.86	298.63	-430.36	-282.76	1222.23	70° Inclination @ 8239.02' MD
10875.64	89.26	178.51	8069.30	-2332.00	-438.71	2346.44	3852.94	Cross @ 10875.64' MD
16145.87	89.84	177.67	8109.33	-7599.50	-410.27	7609.40	9122.93	Cross @ 16145.87' MD
20897.00	89.66	179.61	8142.31	-12349.60	-451.43	12357.84	13873.89	Last MWD Survey @ 20897' MD
20924.00	89.66	179.61	8142.47	-12376.59	-451.24	12384.82	13900.89	Projection to TD @ 20924' MD 498' FSL/ 1891' FEL

SHL/ 2331' FSL & 1366' FEL
LP/ 2459' FSL & 1779' FEL
BHL/ 460' FSL & 1904' FEL
Ground Elevation 5322.9'

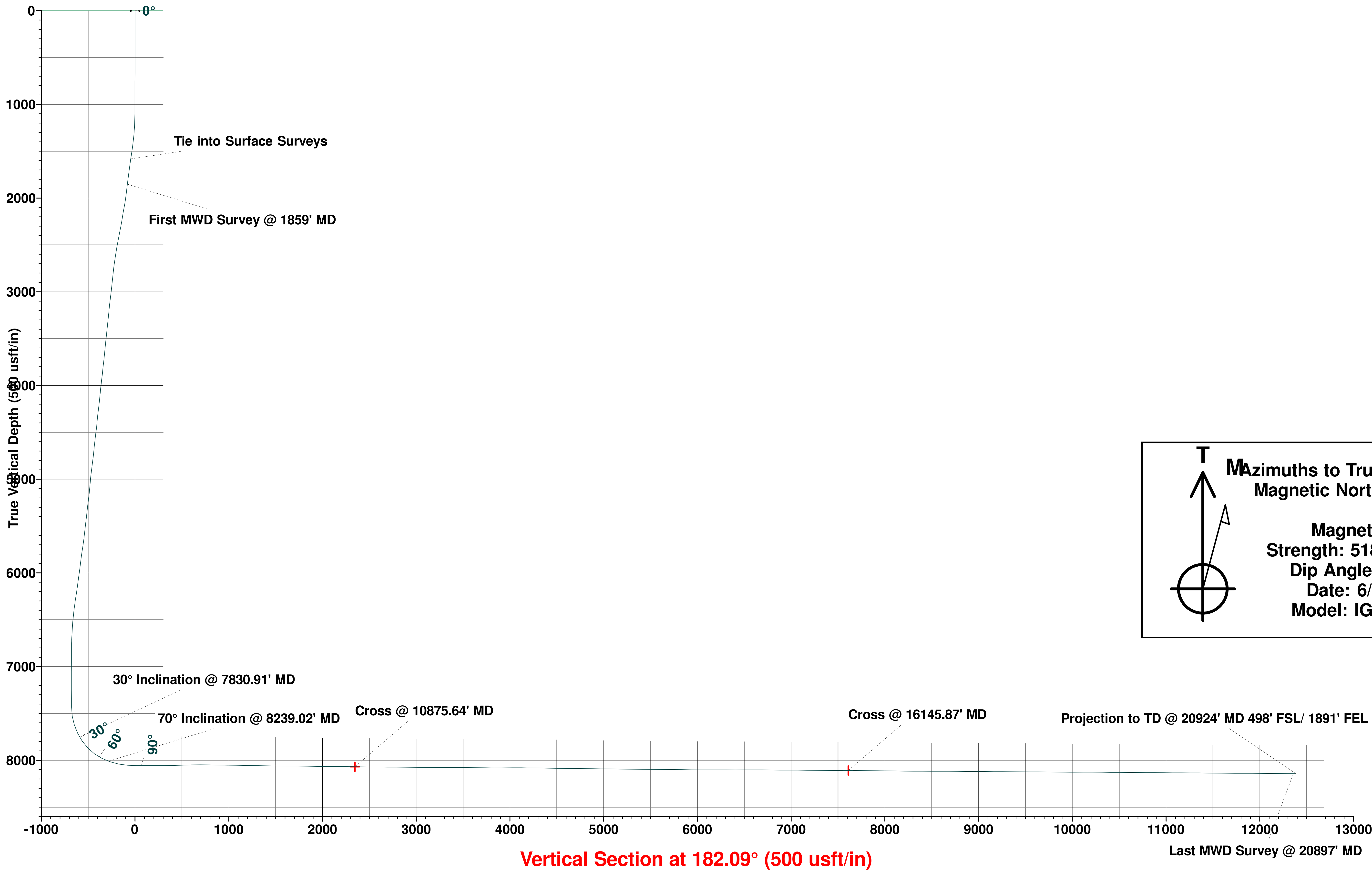

Mazimuths to True North
Magnetic North: 8.10°

Magnetic Field
Strength: 51868.6nT
Dip Angle: 66.42°
Date: 6/28/2019
Model: IGRF2015

