

MALLARD EXPLORATION

WELD COUNTY, COLORADO (NAD 83)

SE SW SEC. 31 T9N R59W 6th P.M.

AF 1

ORIGINAL WELLBORE

23 July, 2019

Plan: PROPOSAL #1





Project: WELD COUNTY, COLORADO (NAD 83)
Site: SE SW SEC. 31 T9N R59W 6th P.M.
Well: AF 1
Wellbore: ORIGINAL WELLBORE
Design: PROPOSAL #1

ANNOTATIONS

TVD	MD	Inc	Azi	+N/-S	+E/-W	Vsect	Dep	Annotation
0.00	0.00	0.00	0.00	0.00	0.00	0.00	0.00	SHL: 742ft FSL & 1913ft FWL of Sec 31
1200.00	1200.00	0.00	0.00	0.00	0.00	0.00	0.00	START NUDGE (3°/100ft BUR)
2113.76	2152.79	28.58	236.28	-129.21	-193.62	-172.40	232.78	EOB TO 28.58° INC
5281.37	5760.06	28.58	236.28	-1087.17	-1629.21	-1450.63	1958.64	KOP (10°/100ft DGLG)
6048.00	6894.54	90.00	90.01	-1319.21	-1103.62	-896.52	2668.98	LP: 593ft FNL & 300ft FWL of Sec 6
6048.00	16839.57	90.00	90.01	-1321.29	8841.42	8939.60	12614.01	BHL: 592ft FNL & 300ft FEL of Sec 5

WELLBORE TARGET DETAILS (LAT/LONG)

Name	TVD	+N/-S	+E/-W	Latitude	Longitude
LP - AF 1	6048.00	-1319.21	-1103.62	40.697675	-104.027399
BHL - AF 1	6048.00	-1321.29	8841.42	40.697665	-103.991534

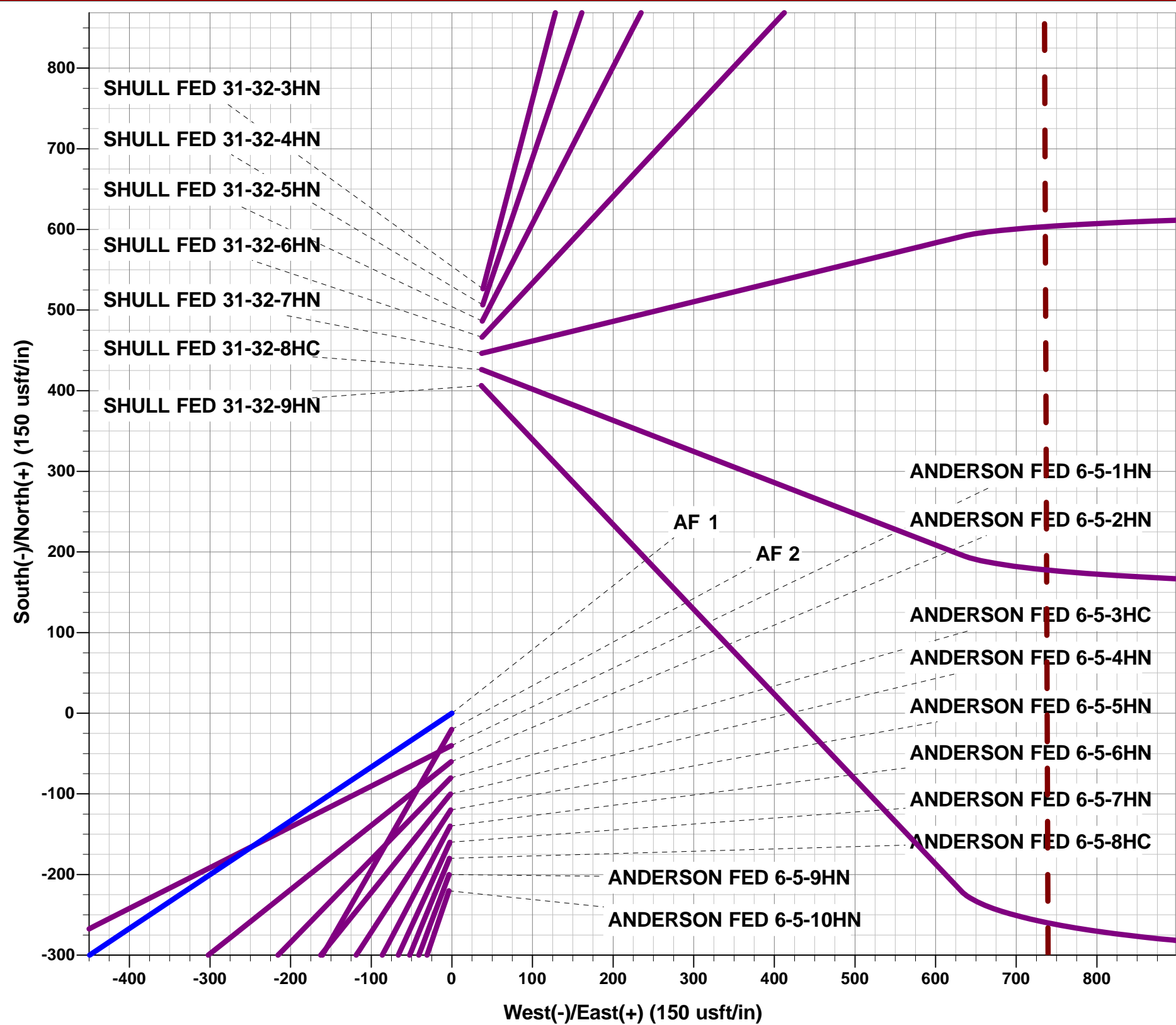

FORMATION TOP DETAILS

TVDPath	MDPath	Formation
470.00	470.00	Fox Hills Base
1487.00	1488.09	Pierre Shale Top
3290.00	3492.29	Richard Sandstone
3425.00	3646.03	Parkman Sandstone
4112.00	4428.38	Sussex Sandstone
4579.00	4960.20	Shannon Sandstone
5348.00	5834.07	TeePee Buttes
5959.00	6563.53	Sharon Springs
5998.00	6647.97	Niobrara Top
6028.00	6739.32	Niobrara A Chalk Target Top
6048.00	6894.54	Niobrara A Chalk Tgt Center

PROPOSED LOCAL COORDINATES:

SHL: 742ft FSL & 1913ft FWL of Sec 31
HZ LP: 593ft FNL & 300ft FWL of Sec 6
BHL: 592ft FNL & 300ft FEL of Sec 5

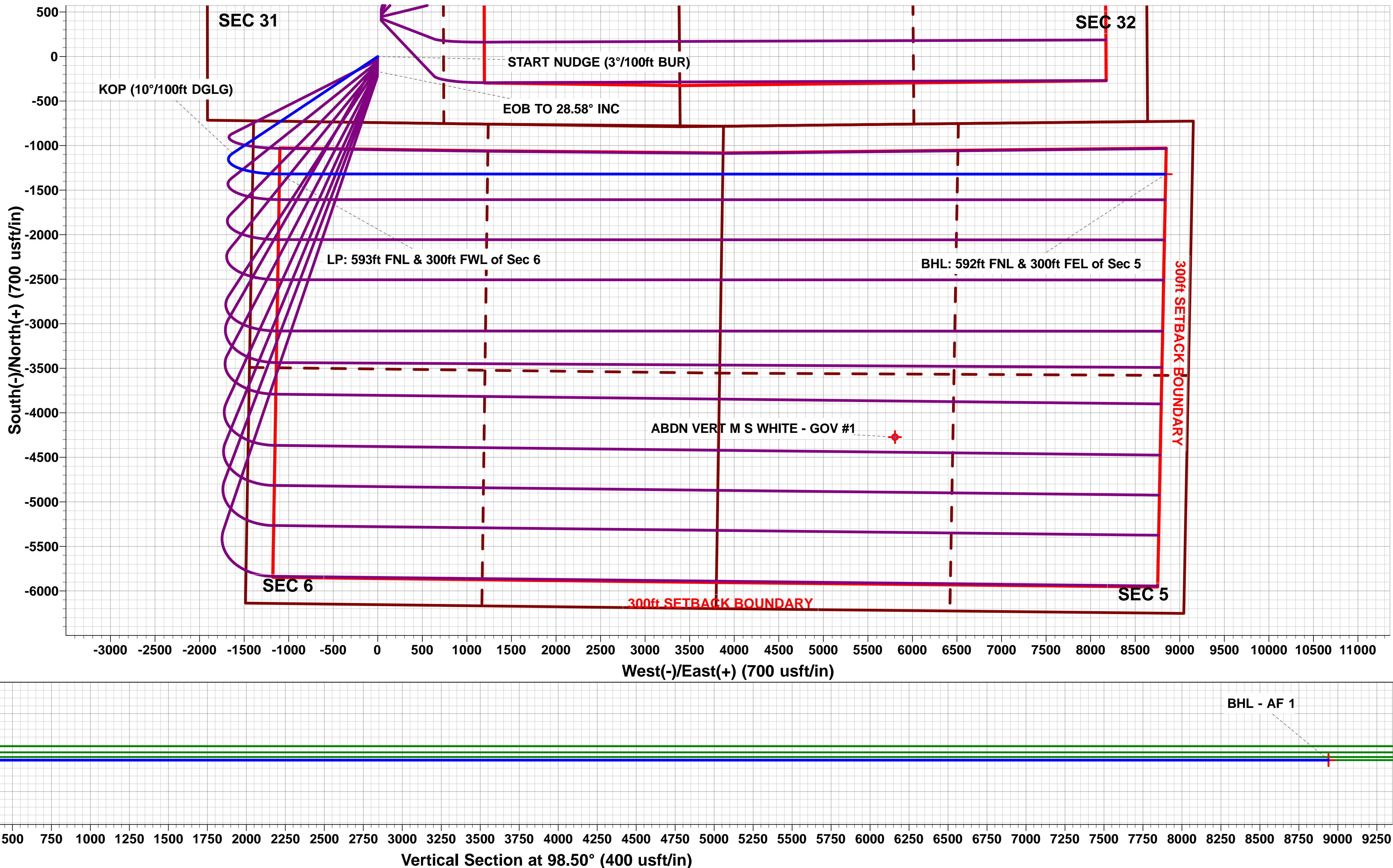
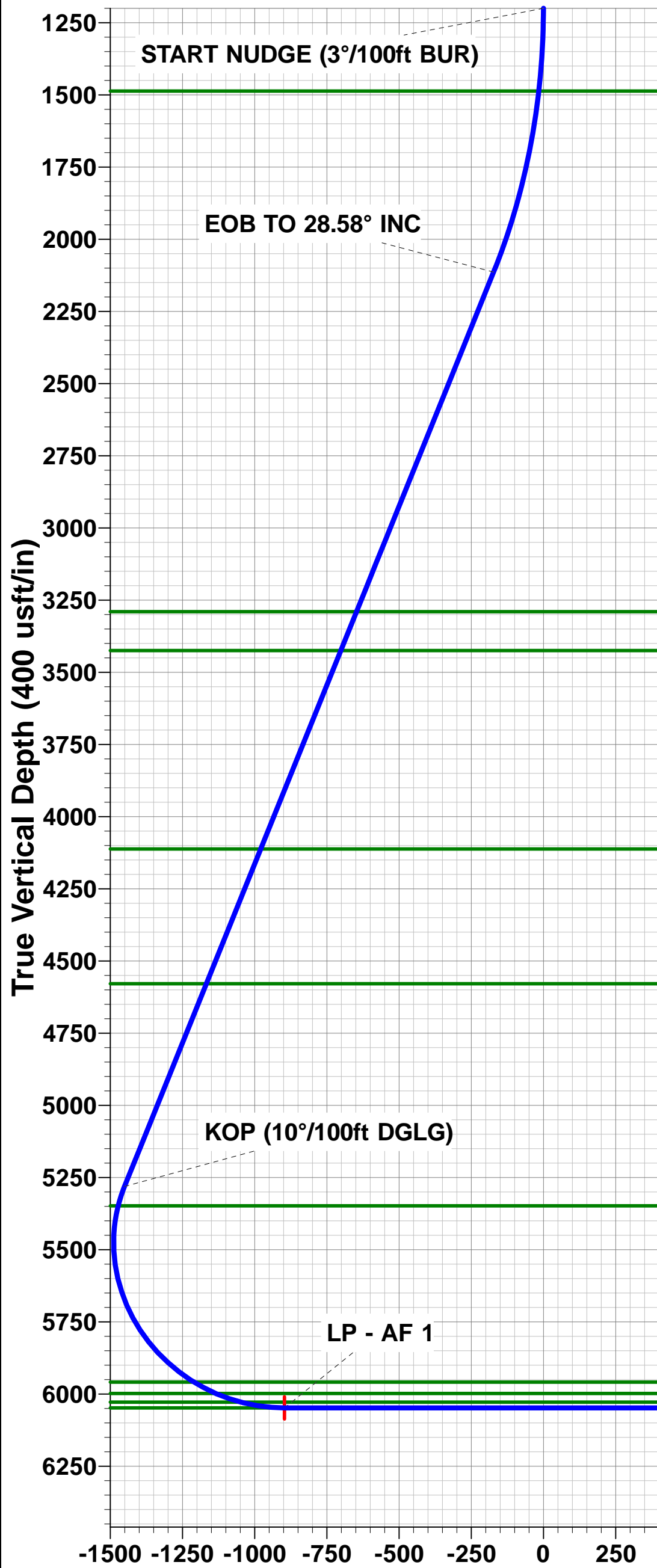
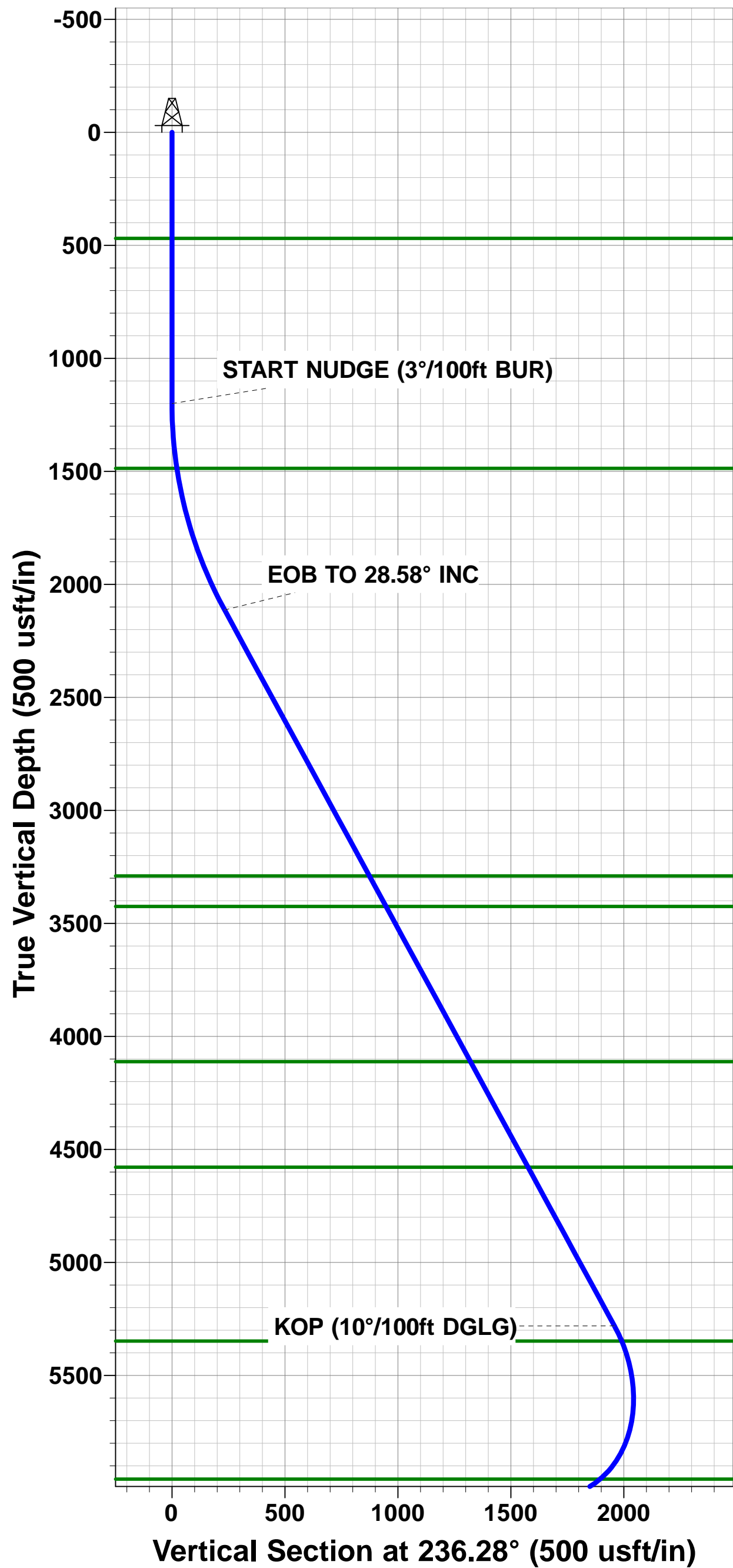

Planning Report



Database:	Database 1	Local Co-ordinate Reference:	Well AF 1
Company:	MALLARD EXPLORATION	TVD Reference:	KB 25' @ 4903.00usft (Original Well Elev)
Project:	WELD COUNTY, COLORADO (NAD 83)	MD Reference:	KB 25' @ 4903.00usft (Original Well Elev)
Site:	SE SW SEC. 31 T9N R59W 6th P.M.	North Reference:	True
Well:	AF 1	Survey Calculation Method:	Minimum Curvature
Wellbore:	ORIGINAL WELLBORE		
Design:	PROPOSAL #1		

Project	WELD COUNTY, COLORADO (NAD 83)		
Map System:	US State Plane 1983	System Datum:	Mean Sea Level
Geo Datum:	North American Datum 1983		
Map Zone:	Colorado Northern Zone		Using geodetic scale factor

Site	SE SW SEC. 31 T9N R59W 6th P.M.		
Site Position:		Northing:	1,501,513.53 usft
From:	Lat/Long	Easting:	3,409,242.57 usft
Position Uncertainty:	0.00 usft	Slot Radius:	1.10 ft
		Latitude:	40.700697
		Longitude:	-104.023987
		Grid Convergence:	0.95 °

Well	AF 1		
Well Position	+N/-S	218.23 usft	Northing:
	+E/-W	157.49 usft	Easting:
Position Uncertainty	0.00 usft		Wellhead Elevation:
			Latitude:
			Longitude:
			Ground Level:

Wellbore	ORIGINAL WELLBORE				
Magnetics	Model Name	Sample Date	Declination (°)	Dip Angle (°)	Field Strength (nT)
	IGRF2015	23/07/2019	7.61	67.15	52,382

Design	PROPOSAL #1			
Audit Notes:				
Version:	Phase:	PROTOTYPE	Tie On Depth:	0.00
Vertical Section:	Depth From (TVD) (usft)	+N/-S (usft)	+E/-W (usft)	Direction (°)
	6,048.00	0.00	0.00	98.50

Plan Sections											
MD (usft)	Inc (°)	Azi (°)	Vertical Depth	SS (usft)	+N/-S (usft)	+E/-W (usft)	Dogleg Rate (°/100usf)	Build Rate (°/100usf)	Turn Rate (°/100usf)	TFO (°)	Target
0.00	0.00	0.00	0.00	-4,903.00	0.00	0.00	0.00	0.00	0.00	0.00	
1,200.00	0.00	0.00	1,200.00	-3,703.00	0.00	0.00	0.00	0.00	0.00	0.00	
2,152.79	28.58	236.28	2,113.76	-2,789.24	-129.21	-193.62	3.00	3.00	0.00	236.28	
5,760.06	28.58	236.28	5,281.37	378.37	-1,087.17	-1,629.21	0.00	0.00	0.00	0.00	
6,894.54	90.00	90.01	6,048.00	1,145.00	-1,319.21	-1,103.62	10.00	5.41	-12.89	-142.76	LP - AF 1
16,839.57	90.00	90.01	6,048.00	1,145.00	-1,321.29	8,841.42	0.00	0.00	0.00	0.00	BHL - AF 1

Planning Report



Database:	Database 1	Local Co-ordinate Reference:	Well AF 1
Company:	MALLARD EXPLORATION	TVD Reference:	KB 25' @ 4903.00usft (Original Well Elev)
Project:	WELD COUNTY, COLORADO (NAD 83)	MD Reference:	KB 25' @ 4903.00usft (Original Well Elev)
Site:	SE SW SEC. 31 T9N R59W 6th P.M.	North Reference:	True
Well:	AF 1	Survey Calculation Method:	Minimum Curvature
Wellbore:	ORIGINAL WELLBORE		
Design:	PROPOSAL #1		

Planned Survey										
MD (usft)	Inc (°)	Azi (°)	TVD (usft)	SS (usft)	+N/-S (usft)	+E/-W (usft)	Vertical Section (usft)	Dogleg Rate (°/100usft)	Build Rate (°/100usft)	Turn Rate (°/100usft)
SHL: 742ft FSL & 1913ft FWL of Sec 31										
0.00	0.00	0.00	0.00	4,903.00	0.00	0.00	0.00	0.00	0.00	0.00
100.00	0.00	0.00	100.00	4,803.00	0.00	0.00	0.00	0.00	0.00	0.00
200.00	0.00	0.00	200.00	4,703.00	0.00	0.00	0.00	0.00	0.00	0.00
300.00	0.00	0.00	300.00	4,603.00	0.00	0.00	0.00	0.00	0.00	0.00
400.00	0.00	0.00	400.00	4,503.00	0.00	0.00	0.00	0.00	0.00	0.00
Fox Hills Base										
470.00	0.00	0.00	470.00	4,433.00	0.00	0.00	0.00	0.00	0.00	0.00
500.00	0.00	0.00	500.00	4,403.00	0.00	0.00	0.00	0.00	0.00	0.00
600.00	0.00	0.00	600.00	4,303.00	0.00	0.00	0.00	0.00	0.00	0.00
700.00	0.00	0.00	700.00	4,203.00	0.00	0.00	0.00	0.00	0.00	0.00
800.00	0.00	0.00	800.00	4,103.00	0.00	0.00	0.00	0.00	0.00	0.00
900.00	0.00	0.00	900.00	4,003.00	0.00	0.00	0.00	0.00	0.00	0.00
1,000.00	0.00	0.00	1,000.00	3,903.00	0.00	0.00	0.00	0.00	0.00	0.00
1,100.00	0.00	0.00	1,100.00	3,803.00	0.00	0.00	0.00	0.00	0.00	0.00
START NUDGE (3°/100ft BUR)										
1,200.00	0.00	0.00	1,200.00	3,703.00	0.00	0.00	0.00	0.00	0.00	0.00
1,300.00	3.00	236.28	1,299.95	3,603.05	-1.45	-2.18	-1.94	3.00	3.00	0.00
1,400.00	6.00	236.28	1,399.63	3,503.37	-5.81	-8.70	-7.75	3.00	3.00	0.00
Pierre Shale Top										
1,488.09	8.64	236.28	1,487.00	3,416.00	-12.04	-18.04	-16.06	3.00	3.00	0.00
1,500.00	9.00	236.28	1,498.77	3,404.23	-13.05	-19.56	-17.41	3.00	3.00	0.00
1,600.00	12.00	236.28	1,597.08	3,305.92	-23.17	-34.72	-30.91	3.00	3.00	0.00
1,700.00	15.00	236.28	1,694.31	3,208.69	-36.12	-54.13	-48.20	3.00	3.00	0.00
1,800.00	18.00	236.28	1,790.18	3,112.82	-51.88	-77.75	-69.23	3.00	3.00	0.00
1,900.00	21.00	236.28	1,884.43	3,018.57	-70.41	-105.52	-93.95	3.00	3.00	0.00
2,000.00	24.00	236.28	1,976.81	2,926.19	-91.65	-137.34	-122.29	3.00	3.00	0.00
2,100.00	27.00	236.28	2,067.06	2,835.94	-115.54	-173.15	-154.17	3.00	3.00	0.00
EOB TO 28.58° INC										
2,152.79	28.58	236.28	2,113.76	2,789.24	-129.21	-193.62	-172.40	3.00	3.00	0.00
2,200.00	28.58	236.28	2,155.21	2,747.79	-141.74	-212.41	-189.13	0.00	0.00	0.00
2,300.00	28.58	236.28	2,243.02	2,659.98	-168.30	-252.21	-224.56	0.00	0.00	0.00
2,400.00	28.58	236.28	2,330.84	2,572.16	-194.86	-292.01	-260.00	0.00	0.00	0.00
2,500.00	28.58	236.28	2,418.65	2,484.35	-221.41	-331.80	-295.43	0.00	0.00	0.00
2,600.00	28.58	236.28	2,506.46	2,396.54	-247.97	-371.60	-330.87	0.00	0.00	0.00
2,700.00	28.58	236.28	2,594.27	2,308.73	-274.53	-411.40	-366.30	0.00	0.00	0.00
2,800.00	28.58	236.28	2,682.08	2,220.92	-301.08	-451.20	-401.74	0.00	0.00	0.00
2,900.00	28.58	236.28	2,769.90	2,133.10	-327.64	-490.99	-437.17	0.00	0.00	0.00
3,000.00	28.58	236.28	2,857.71	2,045.29	-354.20	-530.79	-472.61	0.00	0.00	0.00
3,100.00	28.58	236.28	2,945.52	1,957.48	-380.75	-570.59	-508.04	0.00	0.00	0.00
3,200.00	28.58	236.28	3,033.33	1,869.67	-407.31	-610.38	-543.48	0.00	0.00	0.00
3,300.00	28.58	236.28	3,121.14	1,781.86	-433.87	-650.18	-578.91	0.00	0.00	0.00
3,400.00	28.58	236.28	3,208.96	1,694.04	-460.42	-689.98	-614.35	0.00	0.00	0.00
Richard Sandstone										
3,492.29	28.58	236.28	3,290.00	1,613.00	-484.93	-726.71	-647.05	0.00	0.00	0.00
3,500.00	28.58	236.28	3,296.77	1,606.23	-486.98	-729.78	-649.78	0.00	0.00	0.00
3,600.00	28.58	236.28	3,384.58	1,518.42	-513.54	-769.57	-685.22	0.00	0.00	0.00
Parkman Sandstone										
3,646.03	28.58	236.28	3,425.00	1,478.00	-525.76	-787.89	-701.53	0.00	0.00	0.00
3,700.00	28.58	236.28	3,472.39	1,430.61	-540.09	-809.37	-720.65	0.00	0.00	0.00
3,800.00	28.58	236.28	3,560.20	1,342.80	-566.65	-849.17	-756.09	0.00	0.00	0.00
3,900.00	28.58	236.28	3,648.02	1,254.98	-593.21	-888.96	-791.52	0.00	0.00	0.00
4,000.00	28.58	236.28	3,735.83	1,167.17	-619.76	-928.76	-826.96	0.00	0.00	0.00

Planning Report



Database:	Database 1	Local Co-ordinate Reference:	Well AF 1
Company:	MALLARD EXPLORATION	TVD Reference:	KB 25' @ 4903.00usft (Original Well Elev)
Project:	WELD COUNTY, COLORADO (NAD 83)	MD Reference:	KB 25' @ 4903.00usft (Original Well Elev)
Site:	SE SW SEC. 31 T9N R59W 6th P.M.	North Reference:	True
Well:	AF 1	Survey Calculation Method:	Minimum Curvature
Wellbore:	ORIGINAL WELLBORE		
Design:	PROPOSAL #1		

Planned Survey										
MD (usft)	Inc (°)	Azi (°)	TVD (usft)	SS (usft)	+N/-S (usft)	+E/-W (usft)	Vertical Section (usft)	Dogleg Rate (°/100usft)	Build Rate (°/100usft)	Turn Rate (°/100usft)
4,100.00	28.58	236.28	3,823.64	1,079.36	-646.32	-968.56	-862.39	0.00	0.00	0.00
4,200.00	28.58	236.28	3,911.45	991.55	-672.88	-1,008.36	-897.83	0.00	0.00	0.00
4,300.00	28.58	236.28	3,999.26	903.74	-699.43	-1,048.15	-933.26	0.00	0.00	0.00
4,400.00	28.58	236.28	4,087.08	815.92	-725.99	-1,087.95	-968.70	0.00	0.00	0.00
Sussex Sandstone										
4,428.38	28.58	236.28	4,112.00	791.00	-733.53	-1,099.25	-978.76	0.00	0.00	0.00
4,500.00	28.58	236.28	4,174.89	728.11	-752.55	-1,127.75	-1,004.13	0.00	0.00	0.00
4,600.00	28.58	236.28	4,262.70	640.30	-779.10	-1,167.54	-1,039.57	0.00	0.00	0.00
4,700.00	28.58	236.28	4,350.51	552.49	-805.66	-1,207.34	-1,075.00	0.00	0.00	0.00
4,800.00	28.58	236.28	4,438.32	464.68	-832.22	-1,247.14	-1,110.44	0.00	0.00	0.00
4,900.00	28.58	236.28	4,526.13	376.87	-858.77	-1,286.94	-1,145.87	0.00	0.00	0.00
Shannon Sandstone										
4,960.20	28.58	236.28	4,579.00	324.00	-874.76	-1,310.89	-1,167.21	0.00	0.00	0.00
5,000.00	28.58	236.28	4,613.95	289.05	-885.33	-1,326.73	-1,181.31	0.00	0.00	0.00
5,100.00	28.58	236.28	4,701.76	201.24	-911.89	-1,366.53	-1,216.74	0.00	0.00	0.00
5,200.00	28.58	236.28	4,789.57	113.43	-938.44	-1,406.33	-1,252.18	0.00	0.00	0.00
5,300.00	28.58	236.28	4,877.38	25.62	-965.00	-1,446.12	-1,287.61	0.00	0.00	0.00
5,400.00	28.58	236.28	4,965.19	-62.19	-991.56	-1,485.92	-1,323.05	0.00	0.00	0.00
5,500.00	28.58	236.28	5,053.01	-150.01	-1,018.11	-1,525.72	-1,358.48	0.00	0.00	0.00
5,600.00	28.58	236.28	5,140.82	-237.82	-1,044.67	-1,565.52	-1,393.92	0.00	0.00	0.00
5,700.00	28.58	236.28	5,228.63	-325.63	-1,071.23	-1,605.31	-1,429.35	0.00	0.00	0.00
KOP (10°/100ft DGLG)										
5,760.06	28.58	236.28	5,281.37	-378.37	-1,087.17	-1,629.21	-1,450.63	0.00	0.00	0.00
5,800.00	25.51	230.67	5,316.94	-413.94	-1,097.93	-1,643.82	-1,463.49	10.00	-7.70	-14.06
TeePee Buttes										
5,834.07	23.09	224.82	5,348.00	-445.00	-1,107.33	-1,654.21	-1,472.38	10.00	-7.09	-17.16
5,900.00	19.24	209.91	5,409.51	-506.51	-1,125.93	-1,668.75	-1,484.01	10.00	-5.85	-22.61
6,000.00	16.84	178.13	5,504.82	-601.82	-1,154.76	-1,676.51	-1,487.43	10.00	-2.40	-31.79
6,100.00	19.78	147.27	5,599.97	-696.97	-1,183.55	-1,666.87	-1,473.63	10.00	2.94	-30.85
6,200.00	26.33	127.70	5,692.06	-789.06	-1,211.42	-1,640.11	-1,443.04	10.00	6.55	-19.57
6,300.00	34.48	116.15	5,778.31	-875.31	-1,237.52	-1,597.04	-1,396.59	10.00	8.15	-11.55
6,400.00	43.34	108.71	5,856.09	-953.09	-1,261.06	-1,538.98	-1,335.69	10.00	8.86	-7.44
6,500.00	52.54	103.42	5,923.04	-1,020.04	-1,281.33	-1,467.70	-1,262.20	10.00	9.20	-5.30
Sharon Springs										
6,563.53	58.49	100.70	5,959.00	-1,056.00	-1,292.22	-1,416.51	-1,209.96	10.00	9.36	-4.27
6,600.00	61.92	99.30	5,977.12	-1,074.12	-1,297.71	-1,385.35	-1,178.33	10.00	9.43	-3.85
Niobrara Top										
6,647.97	66.47	97.58	5,998.00	-1,095.00	-1,304.03	-1,342.64	-1,135.15	10.00	9.47	-3.58
6,700.00	71.41	95.85	6,016.69	-1,113.69	-1,309.70	-1,294.43	-1,086.64	10.00	9.51	-3.33
Niobrara A Chalk Target Top										
6,739.32	75.16	94.61	6,028.00	-1,125.00	-1,313.12	-1,256.94	-1,049.05	10.00	9.53	-3.16
6,800.00	80.95	92.77	6,040.55	-1,137.55	-1,316.93	-1,197.72	-989.92	10.00	9.55	-3.03
LP: 593ft FNL & 300ft FWL of Sec 6 - Niobrara A Chalk Target Center										
6,894.54	90.00	90.01	6,048.00	-1,145.00	-1,319.21	-1,103.62	-896.52	10.00	9.57	-2.92
6,900.00	90.00	90.01	6,048.00	-1,145.00	-1,319.21	-1,098.15	-891.11	0.00	0.00	0.00
7,000.00	90.00	90.01	6,048.00	-1,145.00	-1,319.23	-998.15	-792.21	0.00	0.00	0.00
7,100.00	90.00	90.01	6,048.00	-1,145.00	-1,319.25	-898.15	-693.30	0.00	0.00	0.00
7,200.00	90.00	90.01	6,048.00	-1,145.00	-1,319.27	-798.15	-594.40	0.00	0.00	0.00
7,300.00	90.00	90.01	6,048.00	-1,145.00	-1,319.29	-698.15	-495.49	0.00	0.00	0.00
7,400.00	90.00	90.01	6,048.00	-1,145.00	-1,319.31	-598.15	-396.59	0.00	0.00	0.00
7,500.00	90.00	90.01	6,048.00	-1,145.00	-1,319.33	-498.15	-297.68	0.00	0.00	0.00
7,600.00	90.00	90.01	6,048.00	-1,145.00	-1,319.35	-398.15	-198.78	0.00	0.00	0.00
7,700.00	90.00	90.01	6,048.00	-1,145.00	-1,319.38	-298.15	-99.87	0.00	0.00	0.00

Planning Report



Database:	Database 1	Local Co-ordinate Reference:	Well AF 1
Company:	MALLARD EXPLORATION	TVD Reference:	KB 25' @ 4903.00usft (Original Well Elev)
Project:	WELD COUNTY, COLORADO (NAD 83)	MD Reference:	KB 25' @ 4903.00usft (Original Well Elev)
Site:	SE SW SEC. 31 T9N R59W 6th P.M.	North Reference:	True
Well:	AF 1	Survey Calculation Method:	Minimum Curvature
Wellbore:	ORIGINAL WELLBORE		
Design:	PROPOSAL #1		

Planned Survey										
MD (usft)	Inc (°)	Azi (°)	TVD (usft)	SS (usft)	+N/-S (usft)	+E/-W (usft)	Vertical Section (usft)	Dogleg Rate (°/100usft)	Build Rate (°/100usft)	Turn Rate (°/100usft)
7,800.00	90.00	90.01	6,048.00	-1,145.00	-1,319.40	-198.15	-0.97	0.00	0.00	0.00
7,900.00	90.00	90.01	6,048.00	-1,145.00	-1,319.42	-98.15	97.94	0.00	0.00	0.00
8,000.00	90.00	90.01	6,048.00	-1,145.00	-1,319.44	1.85	196.84	0.00	0.00	0.00
8,100.00	90.00	90.01	6,048.00	-1,145.00	-1,319.46	101.85	295.75	0.00	0.00	0.00
8,200.00	90.00	90.01	6,048.00	-1,145.00	-1,319.48	201.85	394.65	0.00	0.00	0.00
8,300.00	90.00	90.01	6,048.00	-1,145.00	-1,319.50	301.85	493.56	0.00	0.00	0.00
8,400.00	90.00	90.01	6,048.00	-1,145.00	-1,319.52	401.85	592.46	0.00	0.00	0.00
8,500.00	90.00	90.01	6,048.00	-1,145.00	-1,319.54	501.85	691.37	0.00	0.00	0.00
8,600.00	90.00	90.01	6,048.00	-1,145.00	-1,319.56	601.85	790.27	0.00	0.00	0.00
8,700.00	90.00	90.01	6,048.00	-1,145.00	-1,319.58	701.85	889.18	0.00	0.00	0.00
8,800.00	90.00	90.01	6,048.00	-1,145.00	-1,319.61	801.85	988.08	0.00	0.00	0.00
8,900.00	90.00	90.01	6,048.00	-1,145.00	-1,319.63	901.85	1,086.98	0.00	0.00	0.00
9,000.00	90.00	90.01	6,048.00	-1,145.00	-1,319.65	1,001.85	1,185.89	0.00	0.00	0.00
9,100.00	90.00	90.01	6,048.00	-1,145.00	-1,319.67	1,101.85	1,284.79	0.00	0.00	0.00
9,200.00	90.00	90.01	6,048.00	-1,145.00	-1,319.69	1,201.85	1,383.70	0.00	0.00	0.00
9,300.00	90.00	90.01	6,048.00	-1,145.00	-1,319.71	1,301.85	1,482.60	0.00	0.00	0.00
9,400.00	90.00	90.01	6,048.00	-1,145.00	-1,319.73	1,401.85	1,581.51	0.00	0.00	0.00
9,500.00	90.00	90.01	6,048.00	-1,145.00	-1,319.75	1,501.85	1,680.41	0.00	0.00	0.00
9,600.00	90.00	90.01	6,048.00	-1,145.00	-1,319.77	1,601.85	1,779.32	0.00	0.00	0.00
9,700.00	90.00	90.01	6,048.00	-1,145.00	-1,319.79	1,701.85	1,878.22	0.00	0.00	0.00
9,800.00	90.00	90.01	6,048.00	-1,145.00	-1,319.81	1,801.85	1,977.13	0.00	0.00	0.00
9,900.00	90.00	90.01	6,048.00	-1,145.00	-1,319.84	1,901.85	2,076.03	0.00	0.00	0.00
10,000.00	90.00	90.01	6,048.00	-1,145.00	-1,319.86	2,001.85	2,174.94	0.00	0.00	0.00
10,100.00	90.00	90.01	6,048.00	-1,145.00	-1,319.88	2,101.85	2,273.84	0.00	0.00	0.00
10,200.00	90.00	90.01	6,048.00	-1,145.00	-1,319.90	2,201.85	2,372.75	0.00	0.00	0.00
10,300.00	90.00	90.01	6,048.00	-1,145.00	-1,319.92	2,301.85	2,471.65	0.00	0.00	0.00
10,400.00	90.00	90.01	6,048.00	-1,145.00	-1,319.94	2,401.85	2,570.56	0.00	0.00	0.00
10,500.00	90.00	90.01	6,048.00	-1,145.00	-1,319.96	2,501.85	2,669.46	0.00	0.00	0.00
10,600.00	90.00	90.01	6,048.00	-1,145.00	-1,319.98	2,601.85	2,768.37	0.00	0.00	0.00
10,700.00	90.00	90.01	6,048.00	-1,145.00	-1,320.00	2,701.85	2,867.27	0.00	0.00	0.00
10,800.00	90.00	90.01	6,048.00	-1,145.00	-1,320.02	2,801.85	2,966.18	0.00	0.00	0.00
10,900.00	90.00	90.01	6,048.00	-1,145.00	-1,320.04	2,901.85	3,065.08	0.00	0.00	0.00
11,000.00	90.00	90.01	6,048.00	-1,145.00	-1,320.07	3,001.85	3,163.99	0.00	0.00	0.00
11,100.00	90.00	90.01	6,048.00	-1,145.00	-1,320.09	3,101.85	3,262.89	0.00	0.00	0.00
11,200.00	90.00	90.01	6,048.00	-1,145.00	-1,320.11	3,201.85	3,361.80	0.00	0.00	0.00
11,300.00	90.00	90.01	6,048.00	-1,145.00	-1,320.13	3,301.85	3,460.70	0.00	0.00	0.00
11,400.00	90.00	90.01	6,048.00	-1,145.00	-1,320.15	3,401.85	3,559.60	0.00	0.00	0.00
11,500.00	90.00	90.01	6,048.00	-1,145.00	-1,320.17	3,501.85	3,658.51	0.00	0.00	0.00
11,600.00	90.00	90.01	6,048.00	-1,145.00	-1,320.19	3,601.85	3,757.41	0.00	0.00	0.00
11,700.00	90.00	90.01	6,048.00	-1,145.00	-1,320.21	3,701.85	3,856.32	0.00	0.00	0.00
11,800.00	90.00	90.01	6,048.00	-1,145.00	-1,320.23	3,801.85	3,955.22	0.00	0.00	0.00
11,900.00	90.00	90.01	6,048.00	-1,145.00	-1,320.25	3,901.85	4,054.13	0.00	0.00	0.00
12,000.00	90.00	90.01	6,048.00	-1,145.00	-1,320.27	4,001.85	4,153.03	0.00	0.00	0.00
12,100.00	90.00	90.01	6,048.00	-1,145.00	-1,320.29	4,101.85	4,251.94	0.00	0.00	0.00
12,200.00	90.00	90.01	6,048.00	-1,145.00	-1,320.32	4,201.85	4,350.84	0.00	0.00	0.00
12,300.00	90.00	90.01	6,048.00	-1,145.00	-1,320.34	4,301.85	4,449.75	0.00	0.00	0.00
12,400.00	90.00	90.01	6,048.00	-1,145.00	-1,320.36	4,401.85	4,548.65	0.00	0.00	0.00
12,500.00	90.00	90.01	6,048.00	-1,145.00	-1,320.38	4,501.85	4,647.56	0.00	0.00	0.00
12,600.00	90.00	90.01	6,048.00	-1,145.00	-1,320.40	4,601.85	4,746.46	0.00	0.00	0.00
12,700.00	90.00	90.01	6,048.00	-1,145.00	-1,320.42	4,701.85	4,845.37	0.00	0.00	0.00
12,800.00	90.00	90.01	6,048.00	-1,145.00	-1,320.44	4,801.85	4,944.27	0.00	0.00	0.00
12,900.00	90.00	90.01	6,048.00	-1,145.00	-1,320.46	4,901.85	5,043.18	0.00	0.00	0.00
13,000.00	90.00	90.01	6,048.00	-1,145.00	-1,320.48	5,001.85	5,142.08	0.00	0.00	0.00
13,100.00	90.00	90.01	6,048.00	-1,145.00	-1,320.50	5,101.85	5,240.99	0.00	0.00	0.00

Planning Report



Database:	Database 1	Local Co-ordinate Reference:	Well AF 1
Company:	MALLARD EXPLORATION	TVD Reference:	KB 25' @ 4903.00usft (Original Well Elev)
Project:	WELD COUNTY, COLORADO (NAD 83)	MD Reference:	KB 25' @ 4903.00usft (Original Well Elev)
Site:	SE SW SEC. 31 T9N R59W 6th P.M.	North Reference:	True
Well:	AF 1	Survey Calculation Method:	Minimum Curvature
Wellbore:	ORIGINAL WELLBORE		
Design:	PROPOSAL #1		

Planned Survey										
MD (usft)	Inc (°)	Azi (°)	TVD (usft)	SS (usft)	+N/-S (usft)	+E/-W (usft)	Vertical Section (usft)	Dogleg Rate (°/100usft)	Build Rate (°/100usft)	Turn Rate (°/100usft)
13,200.00	90.00	90.01	6,048.00	-1,145.00	-1,320.52	5,201.85	5,339.89	0.00	0.00	0.00
13,300.00	90.00	90.01	6,048.00	-1,145.00	-1,320.55	5,301.85	5,438.80	0.00	0.00	0.00
13,400.00	90.00	90.01	6,048.00	-1,145.00	-1,320.57	5,401.85	5,537.70	0.00	0.00	0.00
13,500.00	90.00	90.01	6,048.00	-1,145.00	-1,320.59	5,501.85	5,636.61	0.00	0.00	0.00
13,600.00	90.00	90.01	6,048.00	-1,145.00	-1,320.61	5,601.85	5,735.51	0.00	0.00	0.00
13,700.00	90.00	90.01	6,048.00	-1,145.00	-1,320.63	5,701.85	5,834.41	0.00	0.00	0.00
13,800.00	90.00	90.01	6,048.00	-1,145.00	-1,320.65	5,801.85	5,933.32	0.00	0.00	0.00
13,900.00	90.00	90.01	6,048.00	-1,145.00	-1,320.67	5,901.85	6,032.22	0.00	0.00	0.00
14,000.00	90.00	90.01	6,048.00	-1,145.00	-1,320.69	6,001.85	6,131.13	0.00	0.00	0.00
14,100.00	90.00	90.01	6,048.00	-1,145.00	-1,320.71	6,101.85	6,230.03	0.00	0.00	0.00
14,200.00	90.00	90.01	6,048.00	-1,145.00	-1,320.73	6,201.85	6,328.94	0.00	0.00	0.00
14,300.00	90.00	90.01	6,048.00	-1,145.00	-1,320.75	6,301.85	6,427.84	0.00	0.00	0.00
14,400.00	90.00	90.01	6,048.00	-1,145.00	-1,320.78	6,401.85	6,526.75	0.00	0.00	0.00
14,500.00	90.00	90.01	6,048.00	-1,145.00	-1,320.80	6,501.85	6,625.65	0.00	0.00	0.00
14,600.00	90.00	90.01	6,048.00	-1,145.00	-1,320.82	6,601.85	6,724.56	0.00	0.00	0.00
14,700.00	90.00	90.01	6,048.00	-1,145.00	-1,320.84	6,701.85	6,823.46	0.00	0.00	0.00
14,800.00	90.00	90.01	6,048.00	-1,145.00	-1,320.86	6,801.85	6,922.37	0.00	0.00	0.00
14,900.00	90.00	90.01	6,048.00	-1,145.00	-1,320.88	6,901.85	7,021.27	0.00	0.00	0.00
15,000.00	90.00	90.01	6,048.00	-1,145.00	-1,320.90	7,001.85	7,120.18	0.00	0.00	0.00
15,100.00	90.00	90.01	6,048.00	-1,145.00	-1,320.92	7,101.85	7,219.08	0.00	0.00	0.00
15,200.00	90.00	90.01	6,048.00	-1,145.00	-1,320.94	7,201.85	7,317.99	0.00	0.00	0.00
15,300.00	90.00	90.01	6,048.00	-1,145.00	-1,320.96	7,301.85	7,416.89	0.00	0.00	0.00
15,400.00	90.00	90.01	6,048.00	-1,145.00	-1,320.98	7,401.85	7,515.80	0.00	0.00	0.00
15,500.00	90.00	90.01	6,048.00	-1,145.00	-1,321.01	7,501.85	7,614.70	0.00	0.00	0.00
15,600.00	90.00	90.01	6,048.00	-1,145.00	-1,321.03	7,601.85	7,713.61	0.00	0.00	0.00
15,700.00	90.00	90.01	6,048.00	-1,145.00	-1,321.05	7,701.85	7,812.51	0.00	0.00	0.00
15,800.00	90.00	90.01	6,048.00	-1,145.00	-1,321.07	7,801.85	7,911.42	0.00	0.00	0.00
15,900.00	90.00	90.01	6,048.00	-1,145.00	-1,321.09	7,901.85	8,010.32	0.00	0.00	0.00
16,000.00	90.00	90.01	6,048.00	-1,145.00	-1,321.11	8,001.85	8,109.23	0.00	0.00	0.00
16,100.00	90.00	90.01	6,048.00	-1,145.00	-1,321.13	8,101.85	8,208.13	0.00	0.00	0.00
16,200.00	90.00	90.01	6,048.00	-1,145.00	-1,321.15	8,201.85	8,307.03	0.00	0.00	0.00
16,300.00	90.00	90.01	6,048.00	-1,145.00	-1,321.17	8,301.85	8,405.94	0.00	0.00	0.00
16,400.00	90.00	90.01	6,048.00	-1,145.00	-1,321.19	8,401.85	8,504.84	0.00	0.00	0.00
16,500.00	90.00	90.01	6,048.00	-1,145.00	-1,321.21	8,501.85	8,603.75	0.00	0.00	0.00
16,600.00	90.00	90.01	6,048.00	-1,145.00	-1,321.24	8,601.85	8,702.65	0.00	0.00	0.00
16,700.00	90.00	90.01	6,048.00	-1,145.00	-1,321.26	8,701.85	8,801.56	0.00	0.00	0.00
16,800.00	90.00	90.01	6,048.00	-1,145.00	-1,321.28	8,801.85	8,900.46	0.00	0.00	0.00
BHL: 592ft FNL & 300ft FEL of Sec 5										
16,839.57	90.00	90.01	6,048.00	-1,145.00	-1,321.29	8,841.42	8,939.60	0.00	0.00	0.00

Planning Report



Database:	Database 1	Local Co-ordinate Reference:	Well AF 1
Company:	MALLARD EXPLORATION	TVD Reference:	KB 25' @ 4903.00usft (Original Well Elev)
Project:	WELD COUNTY, COLORADO (NAD 83)	MD Reference:	KB 25' @ 4903.00usft (Original Well Elev)
Site:	SE SW SEC. 31 T9N R59W 6th P.M.	North Reference:	True
Well:	AF 1	Survey Calculation Method:	Minimum Curvature
Wellbore:	ORIGINAL WELLBORE		
Design:	PROPOSAL #1		

Formations					
MD (usft)	TVD (usft)	Name	Lithology	Dip (°)	Dip Direction (°)
470.00	470.00	Fox Hills Base			
1,488.09	1,487.00	Pierre Shale Top			
3,492.29	3,290.00	Richard Sandstone			
3,646.03	3,425.00	Parkman Sandstone			
4,428.38	4,112.00	Sussex Sandstone			
4,960.20	4,579.00	Shannon Sandstone			
5,834.07	5,348.00	TeePee Buttes			
6,563.53	5,959.00	Sharon Springs			
6,647.97	5,998.00	Niobrara Top			
6,739.32	6,028.00	Niobrara A Chalk Target Top			
6,894.54	6,048.00	Niobrara A Chalk Target Center			

Plan Annotations				
MD (usft)	TVD (usft)	Local Coordinates		Comment
		+N/-S (usft)	+E/-W (usft)	
0.00	0.00	0.00	0.00	SHL: 742ft FSL & 1913ft FWL of Sec 31
1,200.00	1,200.00	0.00	0.00	START NUDGE (3°/100ft BUR)
2,152.79	2,113.76	-129.21	-193.62	EOB TO 28.58° INC
5,760.06	5,281.37	-1,087.17	-1,629.21	KOP (10°/100ft DGLG)
6,894.54	6,048.00	-1,319.21	-1,103.62	LP: 593ft FNL & 300ft FWL of Sec 6
16,839.57	6,048.00	-1,321.29	8,841.42	BHL: 592ft FNL & 300ft FEL of Sec 5