

March 1, 2019

Mr. Garrett Clemons  
Vice President, Environmental, Health & Safety  
NGL Energy Partners, LP  
3773 Cherry Creek North Drive, Suite 1000  
Denver, Colorado 80209

**RE: Soil Confirmation Sampling Activities Report  
Apollo 11 Facility  
Galeton, Weld County, Colorado**

Dear Mr. Clemons:

LT Environmental, Inc. (LTE) is pleased to present this report summarizing the results of soil sampling activities conducted at the NGL Energy Partners, LP (NGL) Apollo 11 Facility (Site) located near Galeton, Weld County, Colorado (Figure 1) following a release of produced water on February 16, 2019. Soil sampling was conducted to identify the presence or absence of residual soil impacts following cleanup of the release.

## **BACKGROUND**

The Site houses a salt water disposal (SWD) well used for offloading produced water. On February 16, 2019, NGL personnel identified a release of approximately 423 barrels of produced water from a mechanical failure on the injection pump, resulting in the pump leaking produced water as it operated. The fluid migrated south to a low spot on site.

Upon noticing the leak, operations were ceased until it was deemed safe to work. NGL personnel immediately removed the ponded water and visibly stained soil for offsite disposal. LTE was then contracted by NGL to conduct soil confirmation sampling.

## **FIELD ACTIVITIES**

LTE personnel arrived on the Site on February 27, 2019. LTE visually assessed the affected area to delineate the outer extent of impact soil based on visual observations. Disturbed soil and minor staining were still evident in the area affected by the release. The estimated extent of the affected area is depicted on the Site Map provided as Figure 2.

## **SOIL SAMPLING**

On February 27 and 28, 2019, LTE collected 22 discrete soil samples in the affected area at the surface and at depths between 0 and 6 inches below ground surface (bgs), and one background



soil sample from undisturbed soil 0 to 6 inches bgs. The presence or absence of hydrocarbon staining and petroleum odors were noted for each sample location, and the soil samples were field-screened for total volatile organic compounds using a photoionization detector (PID). The extent of the affected area and the soil confirmation sample locations for those submitted for laboratory analysis are depicted on Figure 2. The depth of each sample and PID readings are summarized in Table 1.

Sampling and analysis for confirmation of successful remediation were conducted to determine the nature and extent of the impacts and to confirm compliance with appropriate concentration levels in the Colorado Oil and Gas Conservation Commission (COGCC) Table 910-1. Nine soil samples plus one background sample were submitted for laboratory analysis based on initial PID readings. The soil samples were stored on ice and transported to Summit Scientific Laboratory (S<sub>2</sub>) in Golden Colorado, following strict chain-of-custody (COC) procedures. The date and time sampled, sample identifier, sampler's name, required analyses, and sampler's signature were included on the COC form. S<sub>2</sub> analyzed samples for:

- Total petroleum hydrocarbons (TPH)-gasoline range organics (GRO) by United States Environmental Protection Agency (EPA) Method SW8260B;
- TPH-diesel range organics (DRO) by EPA Method SW8015M;
- TPH-oil range organics (ORO) by EPA Method SW8015M;
- Volatile organic compounds (VOCs) by EPA Method SW8260B for:
  - Benzene
  - Ethylbenzene
  - Toluene
  - Xylenes, Total
- Soluble nutrients (calcium, magnesium, and sodium) by EPA 6020/USDA60 6(2,3A) - Dry Weight Basis;
- Electrical conductivity (EC) by United States Department of Agriculture (USDA) H60 MET Prep: USDA Method 20B 6/20/17;
- Sodium absorption ratio (SAR); and
- pH.

The background sample was only analyzed for EC.

## RESULTS

Sample results were compared to the allowable levels for chemicals of concern in the COGCC Table 910-1. No samples contained concentrations of the chemicals of concern exceeding the





allowable levels in Table 910-1, except for slightly elevated pH readings of 9.02, 9.03, and 9.14 detected for samples SS01, SS02, and SS04, respectively, and a slightly elevated EC reading of 4.91 millimhos per centimeter at SS19. The results are summarized in the attached Table 2, and the laboratory analytical report is presented in Attachment 1.

## CONCLUSIONS

The laboratory analytical results for the soil samples collected from the release footprint indicated no impacts exceeding the COGCC Table 910-1 allowable levels except for slightly elevated pH readings for samples SS01, SS02, and SS04, and a slightly elevated EC reading for sample SS19. No further actions are recommended.

LTE appreciates the opportunity to provide environmental services to NGL. If you have any questions regarding this report, please contact me at 303-962-5511.

Sincerely,

LT ENVIRONMENTAL, INC.

A handwritten signature in black ink that reads 'Patrick J. Garland'.

Patrick Garland, P.G., CSP  
Director Health and Safety Compliance

Cc: Eli Gordon, NGL Energy Partners, LP, Denver, Colorado

## Attachments:

Figure 1 – Site Location Map

Figure 2 – Site Map

Table 1 – Soil Sample Locations Summary

Table 2 – Soil Analytical Results

Attachment 1 –Laboratory Analytical Reports





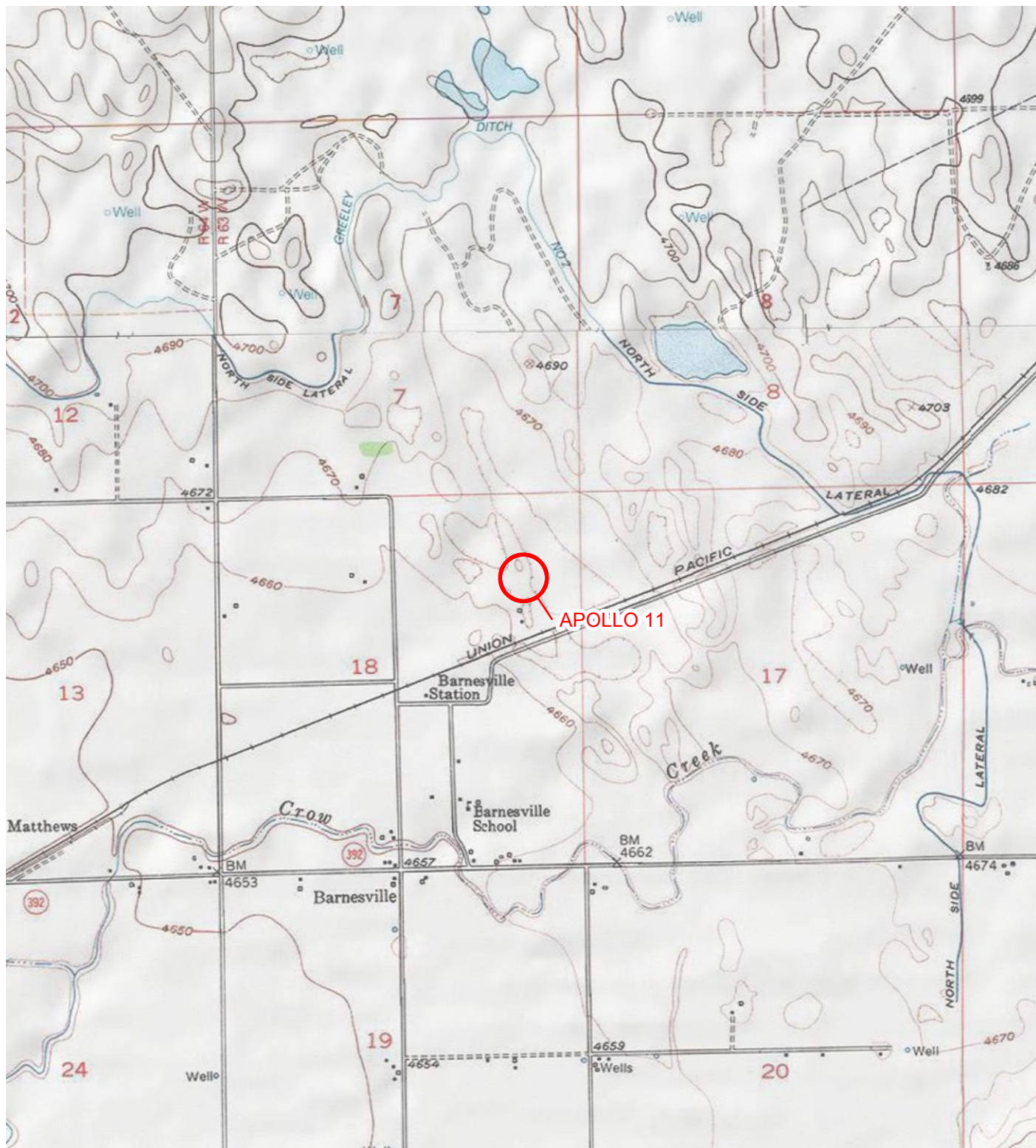
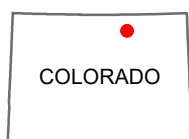
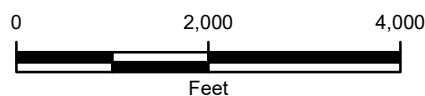

IMAGE COURTESY OF ESRI/USGS

# LEGEND

○ SITE LOCATION



**FIGURE 1**  
**SITE LOCATION MAP**  
**APOLLO 11**  
**NENE SEC 18 T6N R63W**  
**WELD COUNTY, COLORADO**  
**NGL ENERGY PARTNERS, LLC**







IMAGE COURTESY OF GOOGLE EARTH 2013

## LEGEND

- SOIL SAMPLE
- x — x FENCE
- - - EXCAVATION EXTENT

PER COLORADO OIL AND GAS CONSERVATION COMMISSION GUIDELINE, A BACKGROUND SAMPLE WAS COLLECTED OUTSIDE OF THE GATE AND AWAY FROM ANY DEVELOPMENT ON THE PAD.

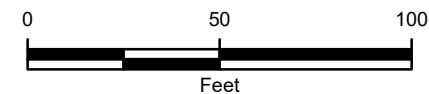

FIGURE 2  
SITE MAP  
APOLLO 11  
NENE SEC 18 T6N R63W  
WELD COUNTY, COLORADO  
NGL ENERGY PARTNERS, LLC





**TABLE 1**  
**SOIL SAMPLE LOCATIONS SUMMARY**

**APOLLO 11**  
**WELD COUNTY, COLORADO**  
**NGL ENERGY PARTNERS, LP**

Sample ID	Sample Depth (inches bgs)	Sample Date	Time	PID (ppm)
SS01	0-6"	2/27/2019	12:30	2.2
SS02	0-6"	2/27/2019	12:32	18
SS03	0-6"	2/27/2019	12:34	2
SS04	0-6"	2/27/2019	12:36	6.1
SS05	0-6"	2/27/2019	12:38	4.5
SS06	0-6"	2/27/2019	12:40	1.3
SS07	0-6"	2/27/2019	12:42	5.8
SS08	0-6"	2/27/2019	12:44	4
SS09	0-6"	2/27/2019	12:46	12.4
SS10	0-6"	2/27/2019	12:48	2.1
SS11	0-6"	2/27/2019	12:50	4.8
SS12	0-6"	2/27/2019	12:52	30
SS13	0-6"	2/27/2019	12:54	1.8
SS14	0-6"	2/27/2019	12:56	13.3
SS15	0-6"	2/27/2019	12:58	4.6
SS16	0-6"	2/27/2019	13:00	8.2
SS17	0-6"	2/27/2019	13:02	5.6
SS18	0-6"	2/27/2019	13:04	4.1
SS19	0-6"	2/27/2019	13:06	15.7
SS20	0-6"	2/27/2019	13:08	3.5
SS21	0-6"	2/27/2019	13:10	3.8
SS22	0-6"	2/27/2019	13:12	6
NGL A11 Background	6-8"	2/28/2019	14:08	NA

**Notes:**

inches bgs - Inches below ground surface

NA - not applicable

PID - photoionization detector

ppm - parts per million





TABLE 2  
SOIL ANALYTICAL RESULTS

APOLLO 11  
WELD COUNTY, COLORADO  
NGL ENERGY PARTNERS, LP

Sample ID	Sample Date	Benzene (mg/kg)	Toluene (mg/kg)	Ethyl Benzene (mg/kg)	Total Xylenes (mg/kg)	TPH-GRO (mg/kg)	TPH-DRO (mg/kg)	TPH-ORO (mg/kg)	Calcium (mg/kg)	Magnesium (mg/kg)	Sodium (mg/kg)	Sodium Adsorption Ratio (SAR)	Specific Conductance (EC) (mmhos/cm)	pH
SS01	2/27/2019	< 0.0020	< 0.0050	< 0.0050	< 0.010	< 0.50	< 50	< 50	462	203	629	6.14	2.46	<b>9.02</b>
SS02	2/27/2019	< 0.0020	0.0060	< 0.0050	0.023	4.2	150	< 50	522	199	1,110	10.5	3.51	<b>9.03</b>
SS04	2/27/2019	< 0.0020	0.0067	< 0.0050	0.016	< 0.5	< 50	< 50	690	149	1,130	10.2	3.72	<b>9.14</b>
SS05	2/27/2019	< 0.0020	< 0.0050	< 0.0050	< 0.010	< 0.5	< 50	< 50	400	155	1150	12.4	3.51	8.33
SS10	2/27/2019	< 0.0020	< 0.0050	< 0.0050	< 0.010	< 0.5	< 50	< 50	321	126	171	2.05	0.883	7.70
SS12	2/27/2019	< 0.0020	0.0062	< 0.0050	0.019	< 0.5	< 50	< 50	459	166	1,100	11.2	2.60	8.11
SS14	2/27/2019	0.0040	0.010	< 0.0050	0.016	< 0.5	< 50	< 50	1,350	364	947	5.91	3.62	8.82
SS19	2/27/2019	0.0064	0.018	< 0.0050	0.021	< 0.5	< 50	< 50	692	194	833	7.21	<b>4.91</b>	8.36
SS22	2/27/2019	0.0038	0.0089	< 0.0050	0.010	< 0.5	< 50	< 50	647	193	718	6.36	2.97	8.67
NGL A11 Background	2/28/2019	NA	NA	NA	NA	NA	NA	NA	NA	NA	NA	NA	0.184	NA
COGCC TABLE 910-1 CONCENTRATION LEVELS		<b>0.17</b>	<b>85</b>	<b>100</b>	<b>175</b>	<b>500</b>	<b>500</b>	<b>500</b>	<b>NA</b>	<b>NA</b>	<b>NA</b>	<b>&lt;12<sup>5</sup></b>	<b>&lt; 4 or 2 x Background</b>	<b>6-9</b>

**Notes:**

< - less than the laboratory detection limit

**bold** - exceeds COGCC Table 910-1 limits

COGCC - Colorado Oil and Gas Conservation Commission

mg/kg - milligram per kilogram

mmhos/cm- millimhos per centimeter

NA - not applicable





# Summit Scientific

---

4653 Table Mountain Drive, Golden, Colorado 80403

303.277.9310

February 27, 2019

Pat Garland

LT Environmental, Inc.

4600 West 60th Avenue

Arvada, CO 80003

RE: NEL Apollo II

Enclosed are the results of analyses for samples received by Summit Scientific on 02/26/19 16:48. If you have any questions concerning this report, please feel free to contact me.

Sincerely,

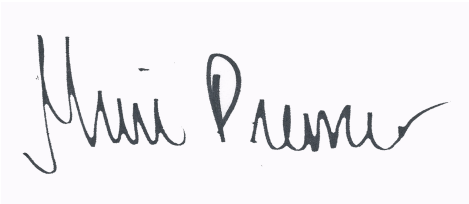
A handwritten signature in black ink, reading "Muri Premier", on a light blue background.

Muri Premier For Ben Shrewsbury

Laboratory Manager



LT Environmental, Inc.  
4600 West 60th Avenue  
Arvada CO, 80003

Project: NEL Apollo II

Project Number: [none]

Project Manager: Pat Garland

**Reported:**  
02/27/19 17:42

### ANALYTICAL REPORT FOR SAMPLES

Sample ID	Laboratory ID	Matrix	Date Sampled	Date Received
SS01	1902244-01	Soil	02/26/19 12:30	02/26/19 16:48
SS02	1902244-02	Soil	02/26/19 12:32	02/26/19 16:48
SS04	1902244-03	Soil	02/26/19 12:36	02/26/19 16:48
SS05	1902244-04	Soil	02/26/19 12:38	02/26/19 16:48
SS10	1902244-05	Soil	02/26/19 12:48	02/26/19 16:48
SS12	1902244-06	Soil	02/26/19 12:52	02/26/19 16:48
SS14	1902244-07	Soil	02/26/19 12:56	02/26/19 16:48
SS19	1902244-08	Soil	02/26/19 13:06	02/26/19 16:48
SS22	1902244-09	Soil	02/26/19 13:12	02/26/19 16:48

Summit Scientific

*The results in this report apply to the samples analyzed in accordance with the chain of custody document. This analytical report must be reproduced in its entirety.*

# Summit Scientific

S<sub>2</sub>

1902244

4653 Table Mountain Drive ♦ Golden, Colorado 80403

303-277-9310 ♦ 303-374-5933 (f)

Page

of

Client: NGL LT ENV.

Project Manager: PAT GARLAND

Address: 4600 W. 60th Ave

E-Mail: pgarland@LTEnv.com

City/State/Zip: ARVADA, CO 80003

Phone: 303 433-9788

Project Name: NGL Apollo 11

Sampler Name: Macy Kiel

Project Number:

ID	Sample Description	Date Sampled	Time Sampled	# of containers	Preservative				Matrix				Analysis Requested						Special Instructions	
					HCl	HNO <sub>3</sub>	None	Other	Water	Soil	Air-Canister #	Other	TPH	BTEX	EC	SAR	pH	Soluble nutrients		
1	SS01	2/26/19	1230	1						X				X	X	X	X	X	X	
2	SS02		1232																	
3	SS04		1236																	
4	SS05		1238																	
5	SS10		1248																	
6	SS12		1252																	
7	SS14		1256																	
8	SS19		1306																	
9	SS22	✓	1312	✓						✓				✓	✓	✓	✓	✓	✓	
10																				

Relinquished by: <u>[Signature]</u>	Date/Time: <u>2/26/19 16:48</u>	Received by: <u>[Signature]</u>	Date/Time: <u>2-26-19 16:48</u>	Turn Around Time (Check) Same Day <u>    </u> 72 hours <u>    </u> 24 hours <u>X</u> Standard <u>    </u> 48 hours <u>    </u>	Notes:
Relinquished by:	Date/Time:	Received by:	Date/Time:	Sample Integrity: Temperature Upon Receipt: <u>3.6</u> Samples Intact: <u>Yes</u> No	
Relinquished by:	Date/Time:	Received by:	Date/Time:		



# Sample Receipt Checklist

S2 Work Order 1902244

Client: LT ENV. Client Project ID: NEL Apollo #

Shipped Via: H.D./P.U./FedEx/UPS/USPS/Other Airbill #: \_\_\_\_\_

Matrix (check all that apply):      Air   X   Soil/Solid      Water      Other: \_\_\_\_\_  
(Describe)

Temp (°C)	<u>3.6</u>
-----------	------------

Thermometer ID: 61857155-K

	Yes	No	N/A	Comments (if any)
If samples require cooling, was the temperature at 4°C +/- 2°C <sup>(1)</sup> ?				
NOTE: If samples are delivered the same day of sampling, this requirement is met provided that there is evidence that cooling has begun.	X			
Were all samples received intact <sup>(1)</sup> ?	X			
Was adequate sample volume provided <sup>(1)</sup> ?	X			
If custody seals are present, are they intact <sup>(1)</sup> ?			X	
Are samples with holding times due within 48 hours sample due within 48 hours present?	X			24 TAT
Is a chain-of-custody (COC) form present and filled out completely <sup>(1)</sup> ?	X			
Does the COC agree with the number and type of sample bottles received <sup>(1)</sup> ?	X			
Do the sample IDs on the bottle labels match the COC <sup>(1)</sup> ?	X			
Is the COC properly relinquished by the client w/ date and time recorded <sup>(1)</sup> ?	X			
For volatiles in water – is there headspace present? If yes, contact client and note in narrative.			X	
Are samples preserved that require preservation (excluding cooling) <sup>(1)</sup> ?				
Note the type of preservative in the Comments column – HCl, H2SO4, NaOH, HNO3, ect			X	
If samples are acid preserved for metals, is the pH ≤ 2 <sup>(1)</sup> ?			X	
Record the pH in Comments.				
If dissolved metals are requested, were samples field filtered?			X	

Additional Comments (if any):

<sup>(1)</sup> If NO, then contact the client before proceeding with analysis and note in case narrative.

Muri  
Custodian Printed Name or Initials

[Signature] 2-26-19  
Signature of Custodian

16:53  
Date/Time



LT Environmental, Inc.  
4600 West 60th Avenue  
Arvada CO, 80003

Project: NEL Apollo II

Project Number: [none]  
Project Manager: Pat Garland

**Reported:**  
02/27/19 17:42

**SS01**  
**1902244-01 (Soil)**

**Summit Scientific**

**Volatile Organic Compounds by EPA Method 8260B**

Date Sampled: **02/26/19 12:30**

Analyte	Result	Reporting		Dilution	Batch	Prepared	Analyzed	Method	Notes
		Limit	Units						
Benzene	ND	0.0020	mg/kg	1	1902319	02/26/19	02/27/19	EPA 8260B	
Toluene	ND	0.0050	"	"	"	"	"	"	
Ethylbenzene	ND	0.0050	"	"	"	"	"	"	
Xylenes (total)	ND	0.010	"	"	"	"	"	"	
Gasoline Range Hydrocarbons	ND	0.50	"	"	"	"	"	"	

Date Sampled: **02/26/19 12:30**

Analyte	Result	Reporting		Dilution	Batch	Prepared	Analyzed	Method	Notes
		Limit	Units						
Surrogate: 1,2-Dichloroethane-d4		105 %	23-173		"	"	"	"	
Surrogate: Toluene-d8		103 %	20-170		"	"	"	"	
Surrogate: 4-Bromofluorobenzene		102 %	21-167		"	"	"	"	

**Extractable Petroleum Hydrocarbons by 8015**

Date Sampled: **02/26/19 12:30**

Analyte	Result	Reporting		Dilution	Batch	Prepared	Analyzed	Method	Notes
		Limit	Units						
C10-C28 (DRO)	ND	50	mg/kg	1	1902321	02/26/19	02/27/19	EPA 8015M	
C28-C36 (ORO)	ND	50	"	"	"	"	"	"	

Date Sampled: **02/26/19 12:30**

Analyte	Result	Reporting		Dilution	Batch	Prepared	Analyzed	Method	Notes
		Limit	Units						
Surrogate: o-Terphenyl		109 %	30-150		"	"	"	"	

**Soluble Nutrients by EPA 6020/USDA60 6(2, 3A) - Dry Weight Basis**

Date Sampled: **02/26/19 12:30**

Analyte	Result	Reporting		Dilution	Batch	Prepared	Analyzed	Method	Notes
		Limit	Units						
Calcium	462	10.5	mg/kg dry	1	1902314	02/26/19	02/26/19	EPA 6020B	

Summit Scientific

The results in this report apply to the samples analyzed in accordance with the chain of custody document. This analytical report must be reproduced in its entirety.



LT Environmental, Inc.  
4600 West 60th Avenue  
Arvada CO, 80003

Project: NEL Apollo II

Project Number: [none]  
Project Manager: Pat Garland

**Reported:**  
02/27/19 17:42

**SS01**  
**1902244-01 (Soil)**

**Summit Scientific**

**Soluble Nutrients by EPA 6020/USDA60 6(2, 3A) - Dry Weight Basis**

Magnesium	203	5.27	mg/kg dry	1	1902314	02/26/19	02/26/19	EPA 6020B
Sodium	629	5.27	"	"	"	"	"	"

**Calculated Analysis**

Date Sampled: **02/26/19 12:30**

Analyte	Result	Reporting Limit	Units	Dilution	Batch	Prepared	Analyzed	Method	Notes
Sodium Adsorption Ratio	6.14	0.100	units	1	1902328	02/27/19	02/27/19	Calculation	

**Physical Parameters by APHA/ASTM/EPA Methods**

Date Sampled: **02/26/19 12:30**

Analyte	Result	Reporting Limit	Units	Dilution	Batch	Prepared	Analyzed	Method	Notes
% Solids	94.9		%	1	1902323	02/27/19	02/27/19	Calculation	
pH	9.02		pH Units	"	1902324	02/27/19	02/27/19	EPA 9045D	

**Specific Conductance by EPA Method 120.1**

Date Sampled: **02/26/19 12:30**

Analyte	Result	Reporting Limit	Units	Dilution	Batch	Prepared	Analyzed	Method	Notes
Specific Conductance (EC)	2.46	0.0100	mmhos/cm	1	1902325	02/27/19	02/27/19	EPA 120.1	

Summit Scientific

*The results in this report apply to the samples analyzed in accordance with the chain of custody document. This analytical report must be reproduced in its entirety.*



LT Environmental, Inc.  
4600 West 60th Avenue  
Arvada CO, 80003

Project: NEL Apollo II

Project Number: [none]  
Project Manager: Pat Garland

**Reported:**  
02/27/19 17:42

**SS02**  
**1902244-02 (Soil)**

**Summit Scientific**

**Volatile Organic Compounds by EPA Method 8260B**

Date Sampled: **02/26/19 12:32**

Analyte	Result	Reporting Limit	Units	Dilution	Batch	Prepared	Analyzed	Method	Notes
Benzene	ND	0.0020	mg/kg	1	1902319	02/26/19	02/27/19	EPA 8260B	
<b>Toluene</b>	<b>0.0060</b>	0.0050	"	"	"	"	"	"	
Ethylbenzene	ND	0.0050	"	"	"	"	"	"	
<b>Xylenes (total)</b>	<b>0.023</b>	0.010	"	"	"	"	"	"	
<b>Gasoline Range Hydrocarbons</b>	<b>4.2</b>	0.50	"	"	"	"	"	"	

Date Sampled: **02/26/19 12:32**

Analyte	Result	Reporting Limit	Units	Dilution	Batch	Prepared	Analyzed	Method	Notes
Surrogate: 1,2-Dichloroethane-d4		101 %	23-173		"	"	"	"	
Surrogate: Toluene-d8		99.5 %	20-170		"	"	"	"	
Surrogate: 4-Bromofluorobenzene		97.4 %	21-167		"	"	"	"	

**Extractable Petroleum Hydrocarbons by 8015**

Date Sampled: **02/26/19 12:32**

Analyte	Result	Reporting Limit	Units	Dilution	Batch	Prepared	Analyzed	Method	Notes
<b>C10-C28 (DRO)</b>	<b>150</b>	50	mg/kg	1	1902321	02/26/19	02/27/19	EPA 8015M	
C28-C36 (ORO)	ND	50	"	"	"	"	"	"	

Date Sampled: **02/26/19 12:32**

Analyte	Result	Reporting Limit	Units	Dilution	Batch	Prepared	Analyzed	Method	Notes
Surrogate: o-Terphenyl		111 %	30-150		"	"	"	"	

**Soluble Nutrients by EPA 6020/USDA60 6(2, 3A) - Dry Weight Basis**

Date Sampled: **02/26/19 12:32**

Analyte	Result	Reporting Limit	Units	Dilution	Batch	Prepared	Analyzed	Method	Notes
<b>Calcium</b>	<b>522</b>	10.4	mg/kg dry	1	1902314	02/26/19	02/26/19	EPA 6020B	
<b>Magnesium</b>	<b>199</b>	5.19	"	"	"	"	"	"	

Summit Scientific

The results in this report apply to the samples analyzed in accordance with the chain of custody document. This analytical report must be reproduced in its entirety.



LT Environmental, Inc.  
4600 West 60th Avenue  
Arvada CO, 80003

Project: NEL Apollo II

Project Number: [none]  
Project Manager: Pat Garland

**Reported:**  
02/27/19 17:42

**SS02**  
**1902244-02 (Soil)**

**Summit Scientific**

**Soluble Nutrients by EPA 6020/USDA60 6(2, 3A) - Dry Weight Basis**

Sodium	1110	5.19	mg/kg dry	1	1902314	02/26/19	02/26/19	EPA 6020B
--------	------	------	-----------	---	---------	----------	----------	-----------

**Calculated Analysis**

Date Sampled: **02/26/19 12:32**

Analyte	Result	Reporting Limit	Units	Dilution	Batch	Prepared	Analyzed	Method	Notes
Sodium Adsorption Ratio	10.5	0.100	units	1	1902328	02/27/19	02/27/19	Calculation	

**Physical Parameters by APHA/ASTM/EPA Methods**

Date Sampled: **02/26/19 12:32**

Analyte	Result	Reporting Limit	Units	Dilution	Batch	Prepared	Analyzed	Method	Notes
% Solids	96.4		%	1	1902323	02/27/19	02/27/19	Calculation	
pH	9.03		pH Units	"	1902324	02/27/19	02/27/19	EPA 9045D	

**Specific Conductance by EPA Method 120.1**

Date Sampled: **02/26/19 12:32**

Analyte	Result	Reporting Limit	Units	Dilution	Batch	Prepared	Analyzed	Method	Notes
Specific Conductance (EC)	3.51	0.0100	mmhos/cm	1	1902325	02/27/19	02/27/19	EPA 120.1	

Summit Scientific

*The results in this report apply to the samples analyzed in accordance with the chain of custody document. This analytical report must be reproduced in its entirety.*





LT Environmental, Inc.  
4600 West 60th Avenue  
Arvada CO, 80003

Project: NEL Apollo II

Project Number: [none]  
Project Manager: Pat Garland

**Reported:**  
02/27/19 17:42

**SS04**  
**1902244-03 (Soil)**

**Summit Scientific**

**Volatile Organic Compounds by EPA Method 8260B**

Date Sampled: **02/26/19 12:36**

Analyte	Result	Reporting	Units	Dilution	Batch	Prepared	Analyzed	Method	Notes
		Limit							
Benzene	ND	0.0020	mg/kg	1	1902319	02/26/19	02/27/19	EPA 8260B	
<b>Toluene</b>	<b>0.0067</b>	0.0050	"	"	"	"	"	"	
Ethylbenzene	ND	0.0050	"	"	"	"	"	"	
<b>Xylenes (total)</b>	<b>0.016</b>	0.010	"	"	"	"	"	"	
Gasoline Range Hydrocarbons	ND	0.50	"	"	"	"	"	"	

Date Sampled: **02/26/19 12:36**

Analyte	Result	Reporting	Units	Dilution	Batch	Prepared	Analyzed	Method	Notes
		Limit							
Surrogate: 1,2-Dichloroethane-d4		106 %	23-173		"	"	"	"	
Surrogate: Toluene-d8		99.4 %	20-170		"	"	"	"	
Surrogate: 4-Bromofluorobenzene		100 %	21-167		"	"	"	"	

**Extractable Petroleum Hydrocarbons by 8015**

Date Sampled: **02/26/19 12:36**

Analyte	Result	Reporting	Units	Dilution	Batch	Prepared	Analyzed	Method	Notes
		Limit							
C10-C28 (DRO)	ND	50	mg/kg	1	1902321	02/26/19	02/27/19	EPA 8015M	
C28-C36 (ORO)	ND	50	"	"	"	"	"	"	

Date Sampled: **02/26/19 12:36**

Analyte	Result	Reporting	Units	Dilution	Batch	Prepared	Analyzed	Method	Notes
		Limit							
Surrogate: o-Terphenyl		106 %	30-150		"	"	"	"	

**Soluble Nutrients by EPA 6020/USDA60 6(2, 3A) - Dry Weight Basis**

Date Sampled: **02/26/19 12:36**

Analyte	Result	Reporting	Units	Dilution	Batch	Prepared	Analyzed	Method	Notes
		Limit							
<b>Calcium</b>	<b>690</b>	10.6	mg/kg dry	1	1902314	02/26/19	02/26/19	EPA 6020B	
<b>Magnesium</b>	<b>149</b>	5.32	"	"	"	"	"	"	

Summit Scientific

The results in this report apply to the samples analyzed in accordance with the chain of custody document. This analytical report must be reproduced in its entirety.



LT Environmental, Inc.  
4600 West 60th Avenue  
Arvada CO, 80003

Project: NEL Apollo II

Project Number: [none]

Project Manager: Pat Garland

**Reported:**  
02/27/19 17:42

**SS04**  
**1902244-03 (Soil)**

**Summit Scientific**

**Soluble Nutrients by EPA 6020/USDA60 6(2, 3A) - Dry Weight Basis**

Sodium	1130	5.32	mg/kg dry	1	1902314	02/26/19	02/26/19	EPA 6020B
--------	------	------	-----------	---	---------	----------	----------	-----------

**Calculated Analysis**

Date Sampled: **02/26/19 12:36**

Analyte	Result	Reporting Limit	Units	Dilution	Batch	Prepared	Analyzed	Method	Notes
Sodium Adsorption Ratio	10.2	0.100	units	1	1902328	02/27/19	02/27/19	Calculation	

**Physical Parameters by APHA/ASTM/EPA Methods**

Date Sampled: **02/26/19 12:36**

Analyte	Result	Reporting Limit	Units	Dilution	Batch	Prepared	Analyzed	Method	Notes
% Solids	94.0		%	1	1902323	02/27/19	02/27/19	Calculation	
pH	9.14		pH Units	"	1902324	02/27/19	02/27/19	EPA 9045D	

**Specific Conductance by EPA Method 120.1**

Date Sampled: **02/26/19 12:36**

Analyte	Result	Reporting Limit	Units	Dilution	Batch	Prepared	Analyzed	Method	Notes
Specific Conductance (EC)	3.72	0.0100	mmhos/cm	1	1902325	02/27/19	02/27/19	EPA 120.1	

Summit Scientific

*The results in this report apply to the samples analyzed in accordance with the chain of custody document. This analytical report must be reproduced in its entirety.*



LT Environmental, Inc.  
4600 West 60th Avenue  
Arvada CO, 80003

Project: NEL Apollo II

Project Number: [none]  
Project Manager: Pat Garland

**Reported:**  
02/27/19 17:42

**SS05**  
**1902244-04 (Soil)**

**Summit Scientific**

**Volatile Organic Compounds by EPA Method 8260B**

Date Sampled: **02/26/19 12:38**

Analyte	Result	Reporting	Units	Dilution	Batch	Prepared	Analyzed	Method	Notes
		Limit							
Benzene	ND	0.0020	mg/kg	1	1902319	02/26/19	02/27/19	EPA 8260B	
Toluene	ND	0.0050	"	"	"	"	"	"	
Ethylbenzene	ND	0.0050	"	"	"	"	"	"	
Xylenes (total)	ND	0.010	"	"	"	"	"	"	
Gasoline Range Hydrocarbons	ND	0.50	"	"	"	"	"	"	

Date Sampled: **02/26/19 12:38**

Analyte	Result	Reporting	Units	Dilution	Batch	Prepared	Analyzed	Method	Notes
		Limit							
Surrogate: 1,2-Dichloroethane-d4		99.6 %	23-173		"	"	"	"	
Surrogate: Toluene-d8		97.4 %	20-170		"	"	"	"	
Surrogate: 4-Bromofluorobenzene		100 %	21-167		"	"	"	"	

**Extractable Petroleum Hydrocarbons by 8015**

Date Sampled: **02/26/19 12:38**

Analyte	Result	Reporting	Units	Dilution	Batch	Prepared	Analyzed	Method	Notes
		Limit							
C10-C28 (DRO)	ND	50	mg/kg	1	1902321	02/26/19	02/27/19	EPA 8015M	
C28-C36 (ORO)	ND	50	"	"	"	"	"	"	

Date Sampled: **02/26/19 12:38**

Analyte	Result	Reporting	Units	Dilution	Batch	Prepared	Analyzed	Method	Notes
		Limit							
Surrogate: o-Terphenyl		113 %	30-150		"	"	"	"	

**Soluble Nutrients by EPA 6020/USDA60 6(2, 3A) - Dry Weight Basis**

Date Sampled: **02/26/19 12:38**

Analyte	Result	Reporting	Units	Dilution	Batch	Prepared	Analyzed	Method	Notes
		Limit							
Calcium	400	10.6	mg/kg dry	1	1902314	02/26/19	02/26/19	EPA 6020B	
Magnesium	155	5.28	"	"	"	"	"	"	

Summit Scientific

The results in this report apply to the samples analyzed in accordance with the chain of custody document. This analytical report must be reproduced in its entirety.



LT Environmental, Inc.  
4600 West 60th Avenue  
Arvada CO, 80003

Project: NEL Apollo II

Project Number: [none]  
Project Manager: Pat Garland

**Reported:**  
02/27/19 17:42

**SS05**  
**1902244-04 (Soil)**

**Summit Scientific**

**Soluble Nutrients by EPA 6020/USDA60 6(2, 3A) - Dry Weight Basis**

Sodium	1150	5.28	mg/kg dry	1	1902314	02/26/19	02/26/19	EPA 6020B
--------	------	------	-----------	---	---------	----------	----------	-----------

**Calculated Analysis**

Date Sampled: **02/26/19 12:38**

Analyte	Result	Reporting Limit	Units	Dilution	Batch	Prepared	Analyzed	Method	Notes
Sodium Adsorption Ratio	12.4	0.100	units	1	1902328	02/27/19	02/27/19	Calculation	

**Physical Parameters by APHA/ASTM/EPA Methods**

Date Sampled: **02/26/19 12:38**

Analyte	Result	Reporting Limit	Units	Dilution	Batch	Prepared	Analyzed	Method	Notes
% Solids	94.6		%	1	1902323	02/27/19	02/27/19	Calculation	
pH	8.33		pH Units	"	1902324	02/27/19	02/27/19	EPA 9045D	

**Specific Conductance by EPA Method 120.1**

Date Sampled: **02/26/19 12:38**

Analyte	Result	Reporting Limit	Units	Dilution	Batch	Prepared	Analyzed	Method	Notes
Specific Conductance (EC)	3.51	0.0100	mmhos/cm	1	1902325	02/27/19	02/27/19	EPA 120.1	

Summit Scientific

*The results in this report apply to the samples analyzed in accordance with the chain of custody document. This analytical report must be reproduced in its entirety.*



LT Environmental, Inc.  
4600 West 60th Avenue  
Arvada CO, 80003

Project: NEL Apollo II

Project Number: [none]  
Project Manager: Pat Garland

**Reported:**  
02/27/19 17:42

**SS10**  
**1902244-05 (Soil)**

**Summit Scientific**

**Volatile Organic Compounds by EPA Method 8260B**

Date Sampled: **02/26/19 12:48**

Analyte	Result	Reporting	Units	Dilution	Batch	Prepared	Analyzed	Method	Notes
		Limit							
Benzene	ND	0.0020	mg/kg	1	1902319	02/26/19	02/27/19	EPA 8260B	
Toluene	ND	0.0050	"	"	"	"	"	"	
Ethylbenzene	ND	0.0050	"	"	"	"	"	"	
Xylenes (total)	ND	0.010	"	"	"	"	"	"	
Gasoline Range Hydrocarbons	ND	0.50	"	"	"	"	"	"	

Date Sampled: **02/26/19 12:48**

Analyte	Result	Reporting	Units	Dilution	Batch	Prepared	Analyzed	Method	Notes
		Limit							
Surrogate: 1,2-Dichloroethane-d4		97.4 %	23-173		"	"	"	"	
Surrogate: Toluene-d8		98.6 %	20-170		"	"	"	"	
Surrogate: 4-Bromofluorobenzene		99.0 %	21-167		"	"	"	"	

**Extractable Petroleum Hydrocarbons by 8015**

Date Sampled: **02/26/19 12:48**

Analyte	Result	Reporting	Units	Dilution	Batch	Prepared	Analyzed	Method	Notes
		Limit							
C10-C28 (DRO)	ND	50	mg/kg	1	1902321	02/26/19	02/27/19	EPA 8015M	
C28-C36 (ORO)	ND	50	"	"	"	"	"	"	

Date Sampled: **02/26/19 12:48**

Analyte	Result	Reporting	Units	Dilution	Batch	Prepared	Analyzed	Method	Notes
		Limit							
Surrogate: o-Terphenyl		153 %	30-150		"	"	"	"	S-02

**Soluble Nutrients by EPA 6020/USDA60 6(2, 3A) - Dry Weight Basis**

Date Sampled: **02/26/19 12:48**

Analyte	Result	Reporting	Units	Dilution	Batch	Prepared	Analyzed	Method	Notes
		Limit							
Calcium	321	10.6	mg/kg dry	1	1902314	02/26/19	02/26/19	EPA 6020B	
Magnesium	126	5.28	"	"	"	"	"	"	

Summit Scientific

The results in this report apply to the samples analyzed in accordance with the chain of custody document. This analytical report must be reproduced in its entirety.





LT Environmental, Inc.  
4600 West 60th Avenue  
Arvada CO, 80003

Project: NEL Apollo II

Project Number: [none]  
Project Manager: Pat Garland

**Reported:**  
02/27/19 17:42

**SS10**  
**1902244-05 (Soil)**

**Summit Scientific**

**Soluble Nutrients by EPA 6020/USDA60 6(2, 3A) - Dry Weight Basis**

Sodium	171	5.28	mg/kg dry	1	1902314	02/26/19	02/26/19	EPA 6020B
--------	-----	------	-----------	---	---------	----------	----------	-----------

**Calculated Analysis**

Date Sampled: **02/26/19 12:48**

Analyte	Result	Reporting Limit	Units	Dilution	Batch	Prepared	Analyzed	Method	Notes
Sodium Adsorption Ratio	2.05	0.100	units	1	1902328	02/27/19	02/27/19	Calculation	

**Physical Parameters by APHA/ASTM/EPA Methods**

Date Sampled: **02/26/19 12:48**

Analyte	Result	Reporting Limit	Units	Dilution	Batch	Prepared	Analyzed	Method	Notes
% Solids	94.6		%	1	1902323	02/27/19	02/27/19	Calculation	
pH	7.70		pH Units	"	1902324	02/27/19	02/27/19	EPA 9045D	

**Specific Conductance by EPA Method 120.1**

Date Sampled: **02/26/19 12:48**

Analyte	Result	Reporting Limit	Units	Dilution	Batch	Prepared	Analyzed	Method	Notes
Specific Conductance (EC)	0.883	0.0100	mmhos/cm	1	1902325	02/27/19	02/27/19	EPA 120.1	

Summit Scientific

*The results in this report apply to the samples analyzed in accordance with the chain of custody document. This analytical report must be reproduced in its entirety.*



LT Environmental, Inc.  
4600 West 60th Avenue  
Arvada CO, 80003

Project: NEL Apollo II

Project Number: [none]  
Project Manager: Pat Garland

**Reported:**  
02/27/19 17:42

**SS12**  
**1902244-06 (Soil)**

**Summit Scientific**

**Volatile Organic Compounds by EPA Method 8260B**

Date Sampled: **02/26/19 12:52**

Analyte	Result	Reporting	Units	Dilution	Batch	Prepared	Analyzed	Method	Notes
		Limit							
Benzene	ND	0.0020	mg/kg	1	1902319	02/26/19	02/27/19	EPA 8260B	
<b>Toluene</b>	<b>0.0062</b>	0.0050	"	"	"	"	"	"	
Ethylbenzene	ND	0.0050	"	"	"	"	"	"	
<b>Xylenes (total)</b>	<b>0.019</b>	0.010	"	"	"	"	"	"	
Gasoline Range Hydrocarbons	ND	0.50	"	"	"	"	"	"	

Date Sampled: **02/26/19 12:52**

Analyte	Result	Reporting	Units	Dilution	Batch	Prepared	Analyzed	Method	Notes
		Limit							
Surrogate: 1,2-Dichloroethane-d4		96.6 %	23-173		"	"	"	"	
Surrogate: Toluene-d8		100 %	20-170		"	"	"	"	
Surrogate: 4-Bromofluorobenzene		98.1 %	21-167		"	"	"	"	

**Extractable Petroleum Hydrocarbons by 8015**

Date Sampled: **02/26/19 12:52**

Analyte	Result	Reporting	Units	Dilution	Batch	Prepared	Analyzed	Method	Notes
		Limit							
C10-C28 (DRO)	ND	50	mg/kg	1	1902321	02/26/19	02/27/19	EPA 8015M	
C28-C36 (ORO)	ND	50	"	"	"	"	"	"	

Date Sampled: **02/26/19 12:52**

Analyte	Result	Reporting	Units	Dilution	Batch	Prepared	Analyzed	Method	Notes
		Limit							
Surrogate: o-Terphenyl		106 %	30-150		"	"	"	"	

**Soluble Nutrients by EPA 6020/USDA60 6(2, 3A) - Dry Weight Basis**

Date Sampled: **02/26/19 12:52**

Analyte	Result	Reporting	Units	Dilution	Batch	Prepared	Analyzed	Method	Notes
		Limit							
<b>Calcium</b>	<b>459</b>	10.5	mg/kg dry	1	1902314	02/26/19	02/26/19	EPA 6020B	
<b>Magnesium</b>	<b>166</b>	5.23	"	"	"	"	"	"	

Summit Scientific

The results in this report apply to the samples analyzed in accordance with the chain of custody document. This analytical report must be reproduced in its entirety.



LT Environmental, Inc.  
4600 West 60th Avenue  
Arvada CO, 80003

Project: NEL Apollo II

Project Number: [none]  
Project Manager: Pat Garland

**Reported:**  
02/27/19 17:42

**SS12**  
**1902244-06 (Soil)**

**Summit Scientific**

**Soluble Nutrients by EPA 6020/USDA60 6(2, 3A) - Dry Weight Basis**

<b>Sodium</b>	<b>1100</b>	5.23	mg/kg dry	1	1902314	02/26/19	02/26/19	EPA 6020B
---------------	-------------	------	-----------	---	---------	----------	----------	-----------

**Calculated Analysis**

Date Sampled: **02/26/19 12:52**

Analyte	Result	Reporting Limit	Units	Dilution	Batch	Prepared	Analyzed	Method	Notes
<b>Sodium Adsorption Ratio</b>	<b>11.2</b>	0.100	units	1	1902328	02/27/19	02/27/19	Calculation	

**Physical Parameters by APHA/ASTM/EPA Methods**

Date Sampled: **02/26/19 12:52**

Analyte	Result	Reporting Limit	Units	Dilution	Batch	Prepared	Analyzed	Method	Notes
<b>% Solids</b>	<b>95.6</b>		%	1	1902323	02/27/19	02/27/19	Calculation	
<b>pH</b>	<b>8.11</b>		pH Units	"	1902324	02/27/19	02/27/19	EPA 9045D	

**Specific Conductance by EPA Method 120.1**

Date Sampled: **02/26/19 12:52**

Analyte	Result	Reporting Limit	Units	Dilution	Batch	Prepared	Analyzed	Method	Notes
<b>Specific Conductance (EC)</b>	<b>2.60</b>	0.0100	mmhos/cm	1	1902325	02/27/19	02/27/19	EPA 120.1	

Summit Scientific

*The results in this report apply to the samples analyzed in accordance with the chain of custody document. This analytical report must be reproduced in its entirety.*



LT Environmental, Inc.  
4600 West 60th Avenue  
Arvada CO, 80003

Project: NEL Apollo II

Project Number: [none]  
Project Manager: Pat Garland

**Reported:**  
02/27/19 17:42

**SS14**  
**1902244-07 (Soil)**

**Summit Scientific**

**Volatile Organic Compounds by EPA Method 8260B**

Date Sampled: **02/26/19 12:56**

Analyte	Result	Reporting	Units	Dilution	Batch	Prepared	Analyzed	Method	Notes
		Limit							
<b>Benzene</b>	<b>0.0040</b>	0.0020	mg/kg	1	1902319	02/26/19	02/27/19	EPA 8260B	
<b>Toluene</b>	<b>0.010</b>	0.0050	"	"	"	"	"	"	
Ethylbenzene	ND	0.0050	"	"	"	"	"	"	
<b>Xylenes (total)</b>	<b>0.016</b>	0.010	"	"	"	"	"	"	
Gasoline Range Hydrocarbons	ND	0.50	"	"	"	"	"	"	

Date Sampled: **02/26/19 12:56**

Analyte	Result	Reporting	Units	Dilution	Batch	Prepared	Analyzed	Method	Notes
		Limit							
Surrogate: 1,2-Dichloroethane-d4		97.6 %	23-173		"	"	"	"	
Surrogate: Toluene-d8		97.7 %	20-170		"	"	"	"	
Surrogate: 4-Bromofluorobenzene		97.2 %	21-167		"	"	"	"	

**Extractable Petroleum Hydrocarbons by 8015**

Date Sampled: **02/26/19 12:56**

Analyte	Result	Reporting	Units	Dilution	Batch	Prepared	Analyzed	Method	Notes
		Limit							
C10-C28 (DRO)	ND	50	mg/kg	1	1902321	02/26/19	02/27/19	EPA 8015M	
C28-C36 (ORO)	ND	50	"	"	"	"	"	"	

Date Sampled: **02/26/19 12:56**

Analyte	Result	Reporting	Units	Dilution	Batch	Prepared	Analyzed	Method	Notes
		Limit							
Surrogate: o-Terphenyl		108 %	30-150		"	"	"	"	

**Soluble Nutrients by EPA 6020/USDA60 6(2, 3A) - Dry Weight Basis**

Date Sampled: **02/26/19 12:56**

Analyte	Result	Reporting	Units	Dilution	Batch	Prepared	Analyzed	Method	Notes
		Limit							
<b>Calcium</b>	<b>1350</b>	10.8	mg/kg dry	1	1902314	02/26/19	02/26/19	EPA 6020B	
<b>Magnesium</b>	<b>364</b>	5.40	"	"	"	"	"	"	

Summit Scientific

The results in this report apply to the samples analyzed in accordance with the chain of custody document. This analytical report must be reproduced in its entirety.



LT Environmental, Inc.  
4600 West 60th Avenue  
Arvada CO, 80003

Project: NEL Apollo II

Project Number: [none]  
Project Manager: Pat Garland

**Reported:**  
02/27/19 17:42

**SS14**  
**1902244-07 (Soil)**

**Summit Scientific**

**Soluble Nutrients by EPA 6020/USDA60 6(2, 3A) - Dry Weight Basis**

Sodium	947	5.40	mg/kg dry	1	1902314	02/26/19	02/26/19	EPA 6020B
--------	-----	------	-----------	---	---------	----------	----------	-----------

**Calculated Analysis**

Date Sampled: **02/26/19 12:56**

Analyte	Result	Reporting Limit	Units	Dilution	Batch	Prepared	Analyzed	Method	Notes
Sodium Adsorption Ratio	5.91	0.100	units	1	1902328	02/27/19	02/27/19	Calculation	

**Physical Parameters by APHA/ASTM/EPA Methods**

Date Sampled: **02/26/19 12:56**

Analyte	Result	Reporting Limit	Units	Dilution	Batch	Prepared	Analyzed	Method	Notes
% Solids	92.5		%	1	1902323	02/27/19	02/27/19	Calculation	
pH	8.82		pH Units	"	1902324	02/27/19	02/27/19	EPA 9045D	

**Specific Conductance by EPA Method 120.1**

Date Sampled: **02/26/19 12:56**

Analyte	Result	Reporting Limit	Units	Dilution	Batch	Prepared	Analyzed	Method	Notes
Specific Conductance (EC)	3.62	0.0100	mmhos/cm	1	1902325	02/27/19	02/27/19	EPA 120.1	

Summit Scientific

*The results in this report apply to the samples analyzed in accordance with the chain of custody document. This analytical report must be reproduced in its entirety.*





LT Environmental, Inc.  
4600 West 60th Avenue  
Arvada CO, 80003

Project: NEL Apollo II

Project Number: [none]  
Project Manager: Pat Garland

**Reported:**  
02/27/19 17:42

**SS19**  
**1902244-08 (Soil)**

**Summit Scientific**

**Volatile Organic Compounds by EPA Method 8260B**

Date Sampled: **02/26/19 13:06**

Analyte	Result	Reporting Limit	Units	Dilution	Batch	Prepared	Analyzed	Method	Notes
<b>Benzene</b>	<b>0.0064</b>	0.0020	mg/kg	1	1902319	02/26/19	02/27/19	EPA 8260B	
<b>Toluene</b>	<b>0.018</b>	0.0050	"	"	"	"	"	"	
Ethylbenzene	ND	0.0050	"	"	"	"	"	"	
<b>Xylenes (total)</b>	<b>0.021</b>	0.010	"	"	"	"	"	"	
Gasoline Range Hydrocarbons	ND	0.50	"	"	"	"	"	"	

Date Sampled: **02/26/19 13:06**

Analyte	Result	Reporting Limit	Units	Dilution	Batch	Prepared	Analyzed	Method	Notes
Surrogate: 1,2-Dichloroethane-d4		99.0 %	23-173		"	"	"	"	
Surrogate: Toluene-d8		101 %	20-170		"	"	"	"	
Surrogate: 4-Bromofluorobenzene		99.8 %	21-167		"	"	"	"	

**Extractable Petroleum Hydrocarbons by 8015**

Date Sampled: **02/26/19 13:06**

Analyte	Result	Reporting Limit	Units	Dilution	Batch	Prepared	Analyzed	Method	Notes
C10-C28 (DRO)	ND	50	mg/kg	1	1902321	02/26/19	02/27/19	EPA 8015M	
C28-C36 (ORO)	ND	50	"	"	"	"	"	"	

Date Sampled: **02/26/19 13:06**

Analyte	Result	Reporting Limit	Units	Dilution	Batch	Prepared	Analyzed	Method	Notes
Surrogate: o-Terphenyl		115 %	30-150		"	"	"	"	

**Soluble Nutrients by EPA 6020/USDA60 6(2, 3A) - Dry Weight Basis**

Date Sampled: **02/26/19 13:06**

Analyte	Result	Reporting Limit	Units	Dilution	Batch	Prepared	Analyzed	Method	Notes
<b>Calcium</b>	<b>692</b>	10.8	mg/kg dry	1	1902314	02/26/19	02/26/19	EPA 6020B	
<b>Magnesium</b>	<b>194</b>	5.39	"	"	"	"	"	"	

Summit Scientific

The results in this report apply to the samples analyzed in accordance with the chain of custody document. This analytical report must be reproduced in its entirety.



LT Environmental, Inc.  
4600 West 60th Avenue  
Arvada CO, 80003

Project: NEL Apollo II

Project Number: [none]

Project Manager: Pat Garland

**Reported:**  
02/27/19 17:42

**SS19**  
**1902244-08 (Soil)**

**Summit Scientific**

**Soluble Nutrients by EPA 6020/USDA60 6(2, 3A) - Dry Weight Basis**

Sodium	833	5.39	mg/kg dry	1	1902314	02/26/19	02/26/19	EPA 6020B
--------	-----	------	-----------	---	---------	----------	----------	-----------

**Calculated Analysis**

Date Sampled: **02/26/19 13:06**

Analyte	Result	Reporting Limit	Units	Dilution	Batch	Prepared	Analyzed	Method	Notes
Sodium Adsorption Ratio	7.21	0.100	units	1	1902328	02/27/19	02/27/19	Calculation	

**Physical Parameters by APHA/ASTM/EPA Methods**

Date Sampled: **02/26/19 13:06**

Analyte	Result	Reporting Limit	Units	Dilution	Batch	Prepared	Analyzed	Method	Notes
% Solids	92.8		%	1	1902323	02/27/19	02/27/19	Calculation	
pH	8.36		pH Units	"	1902324	02/27/19	02/27/19	EPA 9045D	

**Specific Conductance by EPA Method 120.1**

Date Sampled: **02/26/19 13:06**

Analyte	Result	Reporting Limit	Units	Dilution	Batch	Prepared	Analyzed	Method	Notes
Specific Conductance (EC)	4.91	0.0100	mmhos/cm	1	1902325	02/27/19	02/27/19	EPA 120.1	

Summit Scientific

*The results in this report apply to the samples analyzed in accordance with the chain of custody document. This analytical report must be reproduced in its entirety.*



LT Environmental, Inc.  
4600 West 60th Avenue  
Arvada CO, 80003

Project: NEL Apollo II

Project Number: [none]  
Project Manager: Pat Garland

**Reported:**  
02/27/19 17:42

**SS22**  
**1902244-09 (Soil)**

**Summit Scientific**

**Volatile Organic Compounds by EPA Method 8260B**

Date Sampled: **02/26/19 13:12**

Analyte	Result	Reporting Limit	Units	Dilution	Batch	Prepared	Analyzed	Method	Notes
<b>Benzene</b>	<b>0.0038</b>	0.0020	mg/kg	1	1902319	02/26/19	02/27/19	EPA 8260B	
<b>Toluene</b>	<b>0.0089</b>	0.0050	"	"	"	"	"	"	
Ethylbenzene	ND	0.0050	"	"	"	"	"	"	
<b>Xylenes (total)</b>	<b>0.010</b>	0.010	"	"	"	"	"	"	
Gasoline Range Hydrocarbons	ND	0.50	"	"	"	"	"	"	

Date Sampled: **02/26/19 13:12**

Analyte	Result	Reporting Limit	Units	Dilution	Batch	Prepared	Analyzed	Method	Notes
Surrogate: 1,2-Dichloroethane-d4		99.1 %	23-173		"	"	"	"	
Surrogate: Toluene-d8		99.1 %	20-170		"	"	"	"	
Surrogate: 4-Bromofluorobenzene		99.4 %	21-167		"	"	"	"	

**Extractable Petroleum Hydrocarbons by 8015**

Date Sampled: **02/26/19 13:12**

Analyte	Result	Reporting Limit	Units	Dilution	Batch	Prepared	Analyzed	Method	Notes
C10-C28 (DRO)	ND	50	mg/kg	1	1902321	02/26/19	02/27/19	EPA 8015M	
C28-C36 (ORO)	ND	50	"	"	"	"	"	"	

Date Sampled: **02/26/19 13:12**

Analyte	Result	Reporting Limit	Units	Dilution	Batch	Prepared	Analyzed	Method	Notes
Surrogate: o-Terphenyl		106 %	30-150		"	"	"	"	

**Soluble Nutrients by EPA 6020/USDA60 6(2, 3A) - Dry Weight Basis**

Date Sampled: **02/26/19 13:12**

Analyte	Result	Reporting Limit	Units	Dilution	Batch	Prepared	Analyzed	Method	Notes
<b>Calcium</b>	<b>647</b>	10.8	mg/kg dry	1	1902314	02/26/19	02/26/19	EPA 6020B	
<b>Magnesium</b>	<b>193</b>	5.39	"	"	"	"	"	"	

Summit Scientific

The results in this report apply to the samples analyzed in accordance with the chain of custody document. This analytical report must be reproduced in its entirety.



LT Environmental, Inc.  
4600 West 60th Avenue  
Arvada CO, 80003

Project: NEL Apollo II

Project Number: [none]  
Project Manager: Pat Garland

**Reported:**  
02/27/19 17:42

**SS22**  
**1902244-09 (Soil)**

**Summit Scientific**

**Soluble Nutrients by EPA 6020/USDA60 6(2, 3A) - Dry Weight Basis**

Sodium	718	5.39	mg/kg dry	1	1902314	02/26/19	02/26/19	EPA 6020B
--------	-----	------	-----------	---	---------	----------	----------	-----------

**Calculated Analysis**

Date Sampled: **02/26/19 13:12**

Analyte	Result	Reporting Limit	Units	Dilution	Batch	Prepared	Analyzed	Method	Notes
Sodium Adsorption Ratio	6.36	0.100	units	1	1902328	02/27/19	02/27/19	Calculation	

**Physical Parameters by APHA/ASTM/EPA Methods**

Date Sampled: **02/26/19 13:12**

Analyte	Result	Reporting Limit	Units	Dilution	Batch	Prepared	Analyzed	Method	Notes
% Solids	92.8		%	1	1902323	02/27/19	02/27/19	Calculation	
pH	8.67		pH Units	"	1902324	02/27/19	02/27/19	EPA 9045D	

**Specific Conductance by EPA Method 120.1**

Date Sampled: **02/26/19 13:12**

Analyte	Result	Reporting Limit	Units	Dilution	Batch	Prepared	Analyzed	Method	Notes
Specific Conductance (EC)	2.97	0.0100	mmhos/cm	1	1902325	02/27/19	02/27/19	EPA 120.1	

Summit Scientific

*The results in this report apply to the samples analyzed in accordance with the chain of custody document. This analytical report must be reproduced in its entirety.*



LT Environmental, Inc.  
4600 West 60th Avenue  
Arvada CO, 80003

Project: NEL Apollo II

Project Number: [none]  
Project Manager: Pat Garland

**Reported:**  
02/27/19 17:42

## Volatile Organic Compounds by EPA Method 8260B - Quality Control

### Summit Scientific

Analyte	Reporting			Spike	Source		%REC		RPD	
	Result	Limit	Units	Level	Result	%REC	Limits	RPD	Limit	Notes

#### Batch 1902319 - EPA 5030 Soil MS

##### Blank (1902319-BLK1)

Prepared: 02/26/19 Analyzed: 02/27/19

Benzene	ND	0.0020	mg/kg							
Toluene	ND	0.0050	"							
Ethylbenzene	ND	0.0050	"							
Xylenes (total)	ND	0.010	"							
Gasoline Range Hydrocarbons	ND	0.50	"							
Surrogate: 1,2-Dichloroethane-d4	0.0382		"	0.0400		95.6	23-173			
Surrogate: Toluene-d8	0.0395		"	0.0400		98.8	20-170			
Surrogate: 4-Bromofluorobenzene	0.0406		"	0.0400		101	21-167			

##### LCS (1902319-BS1)

Prepared: 02/26/19 Analyzed: 02/27/19

Benzene	0.0977	0.0020	mg/kg	0.100		97.7	70-130			
Toluene	0.0962	0.0050	"	0.100		96.2	70-130			
Ethylbenzene	0.0867	0.0050	"	0.100		86.7	70-130			
m,p-Xylene	0.166	0.010	"	0.200		82.8	70-130			
o-Xylene	0.0928	0.0050	"	0.100		92.8	70-130			
Surrogate: 1,2-Dichloroethane-d4	0.0327		"	0.0400		81.8	23-173			
Surrogate: Toluene-d8	0.0421		"	0.0400		105	20-170			
Surrogate: 4-Bromofluorobenzene	0.0397		"	0.0400		99.3	21-167			

##### Matrix Spike (1902319-MS1)

Source: 1902247-01

Prepared: 02/26/19 Analyzed: 02/27/19

Benzene	0.0796	0.0020	mg/kg	0.100	ND	79.6	70-130			
Toluene	0.0875	0.0050	"	0.100	0.0135	74.0	70-130			
Ethylbenzene	0.0813	0.0050	"	0.100	0.0103	71.0	70-130			
m,p-Xylene	0.329	0.010	"	0.200	0.161	83.7	70-130			
o-Xylene	0.119	0.0050	"	0.100	0.0380	80.5	70-130			
Surrogate: 1,2-Dichloroethane-d4	0.0358		"	0.0400		89.5	23-173			
Surrogate: Toluene-d8	0.0389		"	0.0400		97.2	20-170			
Surrogate: 4-Bromofluorobenzene	0.0462		"	0.0400		116	21-167			

Summit Scientific

The results in this report apply to the samples analyzed in accordance with the chain of custody document. This analytical report must be reproduced in its entirety.



LT Environmental, Inc.  
4600 West 60th Avenue  
Arvada CO, 80003

Project: NEL Apollo II

Project Number: [none]

Project Manager: Pat Garland

**Reported:**  
02/27/19 17:42

## Volatile Organic Compounds by EPA Method 8260B - Quality Control

### Summit Scientific

Analyte	Reporting			Spike	Source		%REC		RPD	
	Result	Limit	Units	Level	Result	%REC	Limits	RPD	Limit	Notes

#### Batch 1902319 - EPA 5030 Soil MS

Matrix Spike Dup (1902319-MSD1)		Source: 1902247-01			Prepared: 02/26/19 Analyzed: 02/27/19					
Benzene	0.0720	0.0020	mg/kg	0.100	ND	72.0	70-130	9.93	30	
Toluene	0.0790	0.0050	"	0.100	0.0135	65.5	70-130	10.3	30	QM-07
Ethylbenzene	0.0722	0.0050	"	0.100	0.0103	61.9	70-130	11.9	30	QM-07
m,p-Xylene	0.253	0.010	"	0.200	0.161	45.6	70-130	26.2	30	QM-07
o-Xylene	0.100	0.0050	"	0.100	0.0380	62.1	70-130	16.8	30	QM-07
Surrogate: 1,2-Dichloroethane-d4		0.0358	"	0.0400		89.6	23-173			
Surrogate: Toluene-d8		0.0386	"	0.0400		96.4	20-170			
Surrogate: 4-Bromofluorobenzene		0.0466	"	0.0400		116	21-167			

Summit Scientific

The results in this report apply to the samples analyzed in accordance with the chain of custody document. This analytical report must be reproduced in its entirety.



LT Environmental, Inc.  
4600 West 60th Avenue  
Arvada CO, 80003

Project: NEL Apollo II

Project Number: [none]  
Project Manager: Pat Garland

**Reported:**  
02/27/19 17:42

**Extractable Petroleum Hydrocarbons by 8015 - Quality Control**  
**Summit Scientific**

Analyte	Result	Reporting		Spike Level	Source		%REC		RPD	
		Limit	Units		Result	%REC	Limits	RPD	Limit	Notes

**Batch 1902321 - EPA 3550A**

**Blank (1902321-BLK1)**

Prepared: 02/26/19 Analyzed: 02/27/19

C10-C28 (DRO)	ND	50	mg/kg							
C28-C36 (ORO)	ND	50	"							

**LCS (1902321-BS1)**

Prepared: 02/26/19 Analyzed: 02/27/19

C10-C28 (DRO)	414	50	mg/kg	500	82.8	81.4-129				
---------------	-----	----	-------	-----	------	----------	--	--	--	--

**Matrix Spike (1902321-MS1)**

Source: 1902247-01

Prepared: 02/26/19 Analyzed: 02/27/19

C10-C28 (DRO)	491	50	mg/kg	500	28.3	92.5	77.8-133			
---------------	-----	----	-------	-----	------	------	----------	--	--	--

**Matrix Spike Dup (1902321-MSD1)**

Source: 1902247-01

Prepared: 02/26/19 Analyzed: 02/27/19

C10-C28 (DRO)	507	50	mg/kg	500	28.3	95.7	77.8-133	3.22	8.48	
---------------	-----	----	-------	-----	------	------	----------	------	------	--

Summit Scientific

*The results in this report apply to the samples analyzed in accordance with the chain of custody document. This analytical report must be reproduced in its entirety.*





LT Environmental, Inc.  
4600 West 60th Avenue  
Arvada CO, 80003

Project: NEL Apollo II

Project Number: [none]

Project Manager: Pat Garland

**Reported:**  
02/27/19 17:42

**Soluble Nutrients by EPA 6020/USDA60 6(2, 3A) - Dry Weight Basis - Quality Control**

**Summit Scientific**

Analyte	Reporting			Spike	Source		%REC		RPD	
	Result	Limit	Units	Level	Result	%REC	Limits	RPD	Limit	Notes

**Batch 1902314 - General Preparation**

**Blank (1902314-BLK1)**

Prepared & Analyzed: 02/26/19

Calcium	ND	10.0	mg/kg wet
Magnesium	ND	5.00	"
Sodium	ND	5.00	"

**LCS (1902314-BS1)**

Prepared & Analyzed: 02/26/19

Calcium	526	10.0	mg/kg wet	500	105	70-130
Magnesium	522	5.00	"	500	104	70-130
Sodium	515	5.00	"	500	103	70-130

**Duplicate (1902314-DUP1)**

Source: 1902236-04

Prepared & Analyzed: 02/26/19

Calcium	439	10.8	mg/kg dry	464	5.51	20
Magnesium	111	5.40	"	117	4.79	20
Sodium	20.3	5.40	"	17.3	15.9	20

**Matrix Spike (1902314-MS1)**

Source: 1902236-04

Prepared & Analyzed: 02/26/19

Calcium	880	10.8	mg/kg dry	540	464	77.0	70-130
Magnesium	642	5.40	"	540	117	97.2	70-130
Sodium	543	5.40	"	540	17.3	97.4	70-130

**Matrix Spike Dup (1902314-MSD1)**

Source: 1902236-04

Prepared & Analyzed: 02/26/19

Calcium	868	10.8	mg/kg dry	540	464	74.8	70-130	1.36	25
Magnesium	658	5.40	"	540	117	100	70-130	2.47	25
Sodium	551	5.40	"	540	17.3	98.8	70-130	1.34	25

Summit Scientific

*The results in this report apply to the samples analyzed in accordance with the chain of custody document. This analytical report must be reproduced in its entirety.*



LT Environmental, Inc.  
4600 West 60th Avenue  
Arvada CO, 80003

Project: NEL Apollo II

Project Number: [none]

Project Manager: Pat Garland

**Reported:**  
02/27/19 17:42

### Physical Parameters by APHA/ASTM/EPA Methods - Quality Control

#### Summit Scientific

Analyte	Result	Reporting			Spike	Source	%REC		RPD		
		Limit	Units	Level	Result	%REC	Limits	RPD	Limit	Notes	

#### Batch 1902323 - General Preparation

##### Duplicate (1902323-DUP1)

Source: 1902236-04

Prepared & Analyzed: 02/27/19

% Solids	92.8	%		92.6		0.216	20
----------	------	---	--	------	--	-------	----

#### Batch 1902324 - General Preparation

##### LCS (1902324-BS1)

Prepared & Analyzed: 02/27/19

pH	9.24	pH Units		9.23	100	95-105
----	------	----------	--	------	-----	--------

##### Duplicate (1902324-DUP1)

Source: 1902224-01

Prepared & Analyzed: 02/27/19

pH	7.75	pH Units		7.73		0.258	20
----	------	----------	--	------	--	-------	----

Summit Scientific

*The results in this report apply to the samples analyzed in accordance with the chain of custody document. This analytical report must be reproduced in its entirety.*



LT Environmental, Inc.  
4600 West 60th Avenue  
Arvada CO, 80003

Project: NEL Apollo II

Project Number: [none]

Project Manager: Pat Garland

**Reported:**

02/27/19 17:42

### Specific Conductance by EPA Method 120.1 - Quality Control

#### Summit Scientific

Analyte	Result	Reporting		Spike Level	Source		%REC		RPD	
		Limit	Units		Result	%REC	Limits	RPD	Limit	Notes

#### Batch 1902325 - General Preparation

##### Blank (1902325-BLK1)

Prepared & Analyzed: 02/27/19

Specific Conductance (EC) ND 0.0100 mmhos/cm

##### LCS (1902325-BS1)

Prepared & Analyzed: 02/27/19

Specific Conductance (EC) 0.762 0.0100 mmhos/cm 0.750 102 90-110

##### Duplicate (1902325-DUP1)

Source: 1902224-01

Prepared & Analyzed: 02/27/19

Specific Conductance (EC) 0.387 0.0100 mmhos/cm 0.364 6.05 20

Summit Scientific

*The results in this report apply to the samples analyzed in accordance with the chain of custody document. This analytical report must be reproduced in its entirety.*



LT Environmental, Inc.  
4600 West 60th Avenue  
Arvada CO, 80003

Project: NEL Apollo II

Project Number: [none]  
Project Manager: Pat Garland

**Reported:**  
02/27/19 17:42

### Notes and Definitions

S-02      The surrogate recovery for this sample cannot be accurately quantified due to interference from coeluting organic compounds present in the sample extract.

QM-07      The spike recovery was outside acceptance limits for the MS and/or MSD. The batch was accepted based on acceptable LCS/LCSD recovery.

DET      Analyte DETECTED

ND      Analyte NOT DETECTED at or above the reporting limit

NR      Not Reported

dry      Sample results reported on a dry weight basis

RPD      Relative Percent Difference

# Summit Scientific

---

4653 Table Mountain Drive, Golden, Colorado 80403

303.277.9310

March 01, 2019

Pat Garland

LT Environmental, Inc.

4600 West 60th Avenue

Arvada, CO 80003

RE: NGL Apollo 11

Enclosed are the results of analyses for samples received by Summit Scientific on 02/28/19 17:35. If you have any questions concerning this report, please feel free to contact me.

Sincerely,

A handwritten signature in black ink, appearing to read 'P. Shrewsbury', with a stylized, cursive script.

Paul Shrewsbury For Ben Shrewsbury

Laboratory Manager



LT Environmental, Inc.  
4600 West 60th Avenue  
Arvada CO, 80003

Project: NGL Apollo 11

Project Number: 068719001  
Project Manager: Pat Garland

**Reported:**  
03/01/19 15:48

### ANALYTICAL REPORT FOR SAMPLES

Sample ID	Laboratory ID	Matrix	Date Sampled	Date Received
NGL A11 Background	1902297-01	Soil	02/28/19 14:08	02/28/19 17:35

Summit Scientific

*The results in this report apply to the samples analyzed in accordance with the chain of custody document. This analytical report must be reproduced in its entirety.*

# Summit Scientific

1902297

S<sub>2</sub>

4653 Table Mountain Drive ♦ Golden, Colorado 80403  
303-277-9310 ♦ 303-374-5933 (f)

Page 1 of 1

Client: LT Environmental Project Manager: Pat Garland  
Address: 4600 West 60th Avenue E-Mail: pgarland@ltenv.com  
City/State/Zip: Arvada, CO 80003  
Phone: 303-433-9788 Project Name: NGL Apollo 11  
Sampler Name: Brian Podobnic Project Number: 068719001

ID	Sample Description	Date Sampled	Time Sampled	# of containers	Preservative				Matrix				Analysis Requested								Special Instructions	
					HCl	HNO <sub>3</sub>	None	Other	Water	Soil	Air-Canister #	Other	Specific Conductance (EC)									
1	NGL A11 Background	2/28/19	14:08	1			x			x				x								
2																						
3																						
4																						
5																						
6																						
7																						
8																						
9																						
10																						

Relinquished by: Brian Podobnic	Date/Time: 2/28/19 4:38pm	Received by: Kyle White	Date/Time: 2/28/19 16:30	Turn Around Time (Check)	Notes:
Relinquished by: Kyle White	Date/Time: 2/28/19 17:40	Received by: [Signature]	Date/Time: 2-28-19 17:35	Same Day <input type="checkbox"/> 72 hours <input type="checkbox"/> 24 hours <input checked="" type="checkbox"/> Standard <input type="checkbox"/> 48 hours <input type="checkbox"/>	Sample Integrity: 13.2° Temperature Upon Receipt: 13.2° Samples Intact: <input checked="" type="radio"/> Yes <input type="radio"/> No
Relinquished by:	Date/Time:	Received by:	Date/Time:		

www.s2scientific.com

# Sample Receipt Checklist

S2 Work Order 1902297

Client: LTE

Client Project ID: NGL Apollo 11

Shipped Via: H.D./P.U./FedEx/UPS/USPS/Other

Airbill #: \_\_\_\_\_

Matrix (check all that apply): \_\_\_\_\_ Air

☒ Soil/Solid

\_\_\_\_\_ Water

\_\_\_\_\_ Other:

(Describe)

Temp (°C)

13.2°

Thermometer ID: 61857155-K

	Yes	No	N/A	Comments (if any)
If samples require cooling, was the temperature at 4°C +/- 2°C <sup>(1)</sup> ?	<input checked="" type="checkbox"/>			<u>on ice</u>
NOTE: If samples are delivered the same day of sampling, this requirement is met provided that there is evidence that cooling has begun.				
Were all samples received intact <sup>(1)</sup> ?	<input checked="" type="checkbox"/>			
Was adequate sample volume provided <sup>(1)</sup> ?	<input checked="" type="checkbox"/>			
If custody seals are present, are they intact <sup>(1)</sup> ?			<input checked="" type="checkbox"/>	
Are samples with holding times due within 48 hours sample due within 48 hours present?	<input checked="" type="checkbox"/>			<u>24hr</u>
Is a chain-of-custody (COC) form present and filled out completely <sup>(1)</sup> ?	<input checked="" type="checkbox"/>			
Does the COC agree with the number and type of sample bottles received <sup>(1)</sup> ?	<input checked="" type="checkbox"/>			
Do the sample IDs on the bottle labels match the COC <sup>(1)</sup> ?	<input checked="" type="checkbox"/>			
Is the COC properly relinquished by the client w/ date and time recorded <sup>(1)</sup> ?	<input checked="" type="checkbox"/>			
For volatiles in water – is there headspace present? If yes, contact client and note in narrative.			<input checked="" type="checkbox"/>	
Are samples preserved that require preservation (excluding cooling) <sup>(1)</sup> ?			<input checked="" type="checkbox"/>	
Note the type of preservative in the Comments column – HCl, H2SO4, NaOH, HNO3, ect				
If samples are acid preserved for metals, is the pH ≤ 2 <sup>(1)</sup> ?			<input checked="" type="checkbox"/>	
Record the pH in Comments.				
If dissolved metals are requested, were samples field filtered?			<input checked="" type="checkbox"/>	

Additional Comments (if any):

<sup>(1)</sup> If NO, then contact the client before proceeding with analysis and note in case narrative.

AT  
Custodian Printed Name or Initials

Ant K  
Signature of Custodian

2-28-19, 7:35  
Date/Time





LT Environmental, Inc.  
4600 West 60th Avenue  
Arvada CO, 80003

Project: NGL Apollo 11

Project Number: 068719001  
Project Manager: Pat Garland

**Reported:**  
03/01/19 15:48

**NGL A11 Background**  
**1902297-01 (Soil)**

**Summit Scientific**

**Specific Conductance by EPA Method 120.1**

Date Sampled: **02/28/19 14:08**

Analyte	Result	Reporting		Units	Dilution	Batch	Prepared	Analyzed	Method	Notes
		Limit								
Specific Conductance (EC)	<b>0.184</b>	0.0100		mmhos/cm	1	1903003	03/01/19	03/01/19	EPA 120.1	

Summit Scientific

*The results in this report apply to the samples analyzed in accordance with the chain of custody document. This analytical report must be reproduced in its entirety.*



LT Environmental, Inc.  
4600 West 60th Avenue  
Arvada CO, 80003

Project: NGL Apollo 11

Project Number: 068719001  
Project Manager: Pat Garland

**Reported:**  
03/01/19 15:48

### Specific Conductance by EPA Method 120.1 - Quality Control

#### Summit Scientific

Analyte	Result	Reporting		Spike Level	Source		%REC		RPD	
		Limit	Units		Result	%REC	Limits	RPD	Limit	Notes

#### Batch 1903003 - General Preparation

##### Blank (1903003-BLK1)

Prepared & Analyzed: 03/01/19

Specific Conductance (EC) ND 0.0100 mmhos/cm

##### LCS (1903003-BS1)

Prepared & Analyzed: 03/01/19

Specific Conductance (EC) 0.758 0.0100 mmhos/cm 0.750 101 90-110

##### Duplicate (1903003-DUP1)

Source: 1902292-09

Prepared & Analyzed: 03/01/19

Specific Conductance (EC) 1.25 0.0100 mmhos/cm 1.17 6.36 20

Summit Scientific

*The results in this report apply to the samples analyzed in accordance with the chain of custody document. This analytical report must be reproduced in its entirety.*



LT Environmental, Inc.  
4600 West 60th Avenue  
Arvada CO, 80003

Project: NGL Apollo 11

Project Number: 068719001  
Project Manager: Pat Garland

**Reported:**  
03/01/19 15:48

### Notes and Definitions

DET	Analyte DETECTED
ND	Analyte NOT DETECTED at or above the reporting limit
NR	Not Reported
dry	Sample results reported on a dry weight basis
RPD	Relative Percent Difference