



FORM F-106



00216907

R. 51W

RECEIVED

NOV - 2 1981

COLO. OIL &amp; GAS COM.

N

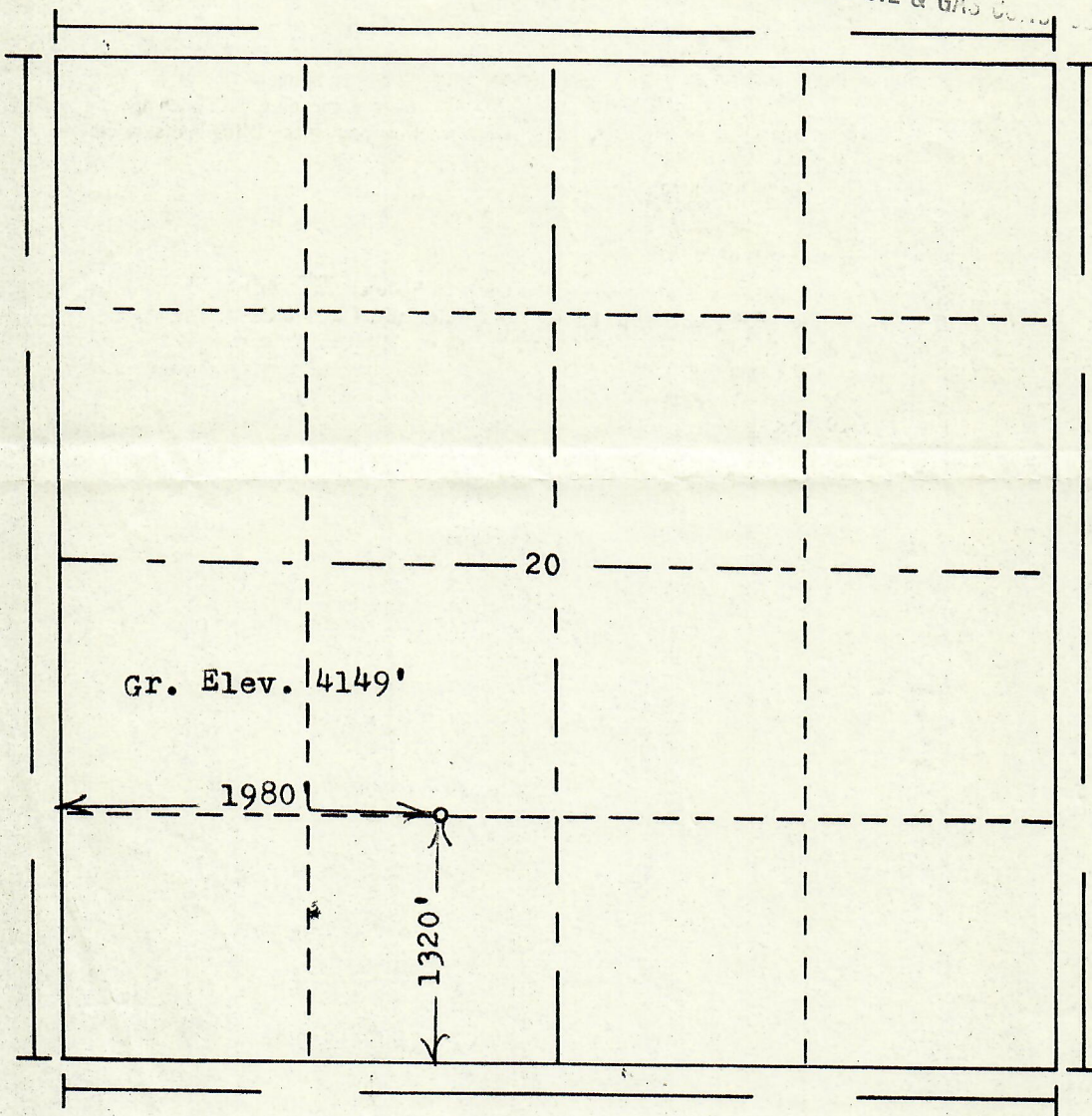
T.  
8  
N

Scale... 1" = 1000'

**Powers Elevation of Denver, Colorado**

has in accordance with a request from Mr. Gear  
for Stream, Inc.

determined the location of No. 1 6387 State  
to be CE 1/4 SW 1/4 Section 20 Township 8N  
Range 5W of the 6th Principal Meridian  
Logan County, Colorado

I hereby certify that this plat is an  
accurate representation of a correct  
survey showing the location of

Date: 10-20-81

B. J. Hall  
Licensed Land Surveyor No. 2853  
State of Colorado