

T 7 N, R 90 W, 6th P.M.

PROJECT
CHANDLER & ASSOCIATES, INC.

Well location, NE CRAIG STATE
7-16, located as shown in the
SW 1/4 NE 1/4 Section 16, T7N, R90W,
6th P.M. Moffat County, Colorado.

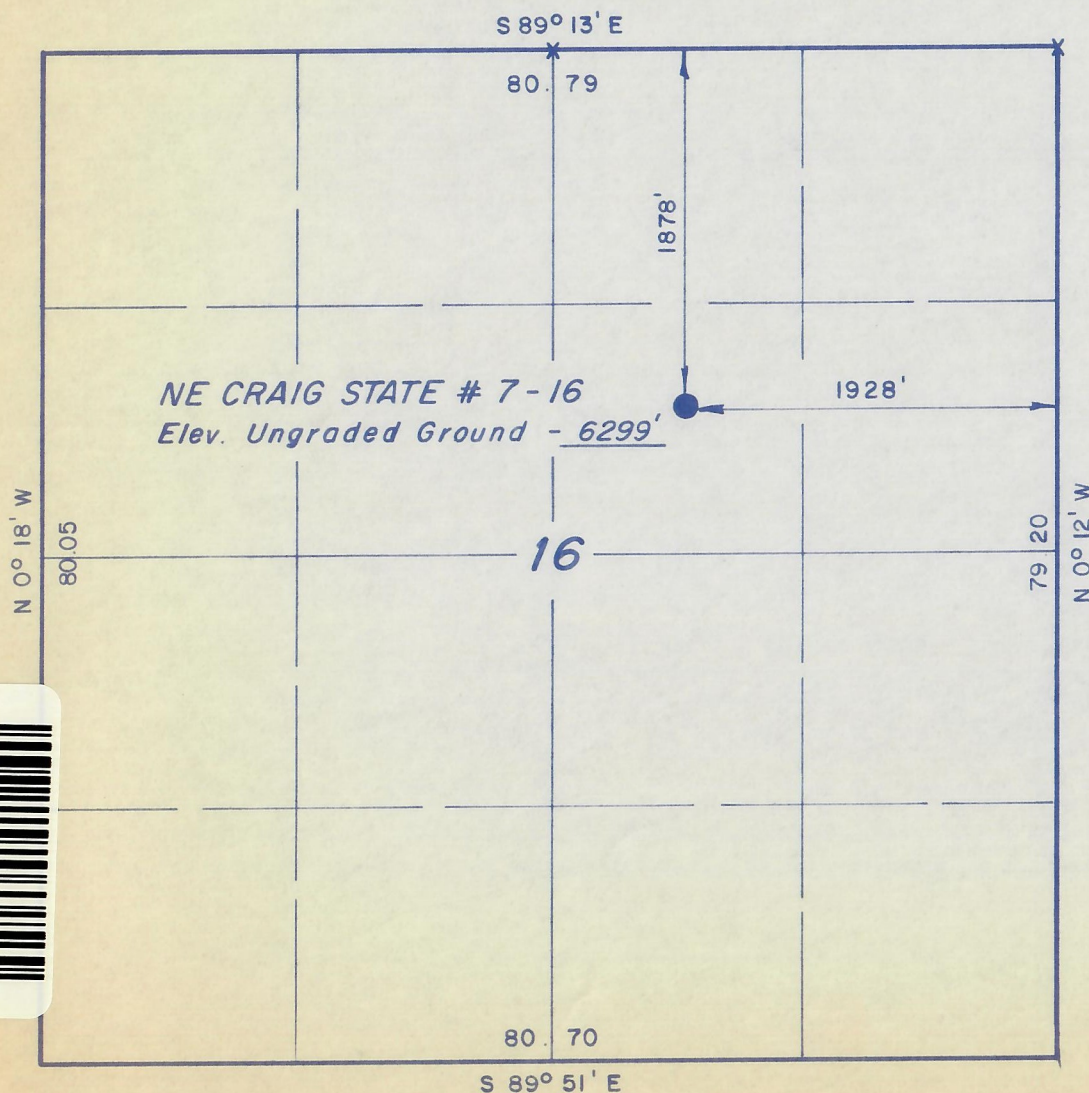

X = Section Corners Located



CERTIFICATE

THIS IS TO CERTIFY THAT THE ABOVE PLAT WAS PREPARED FROM
FIELD NOTES OF ACTUAL SURVEYS MADE BY ME OR UNDER MY
SUPERVISION AND THAT THE SAME ARE TRUE AND CORRECT
TO THE BEST OF MY KNOWLEDGE AND BELIEF.

Lawrence J. Chandler

REGISTERED LAND SURVEYOR
REGISTRATION NO 9019
STATE OF COLORADO

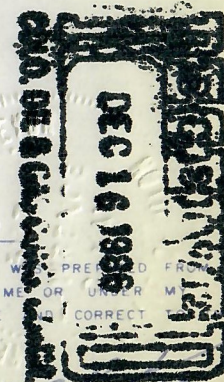

UINTAH ENGINEERING & LAND SURVEYING
P.O. BOX Q - 85 SOUTH - 200 EAST
VERNAL, UTAH - 84078

SCALE 1" = 1000'	DATE 12 / 11 / 86
PARTY LDT DM BFW	REFERENCES GLO Plat
WEATHER Cold	FILE CHANDLER

