



Form PS-102

R. 91 W

RECEIVED

NOV 07 1989

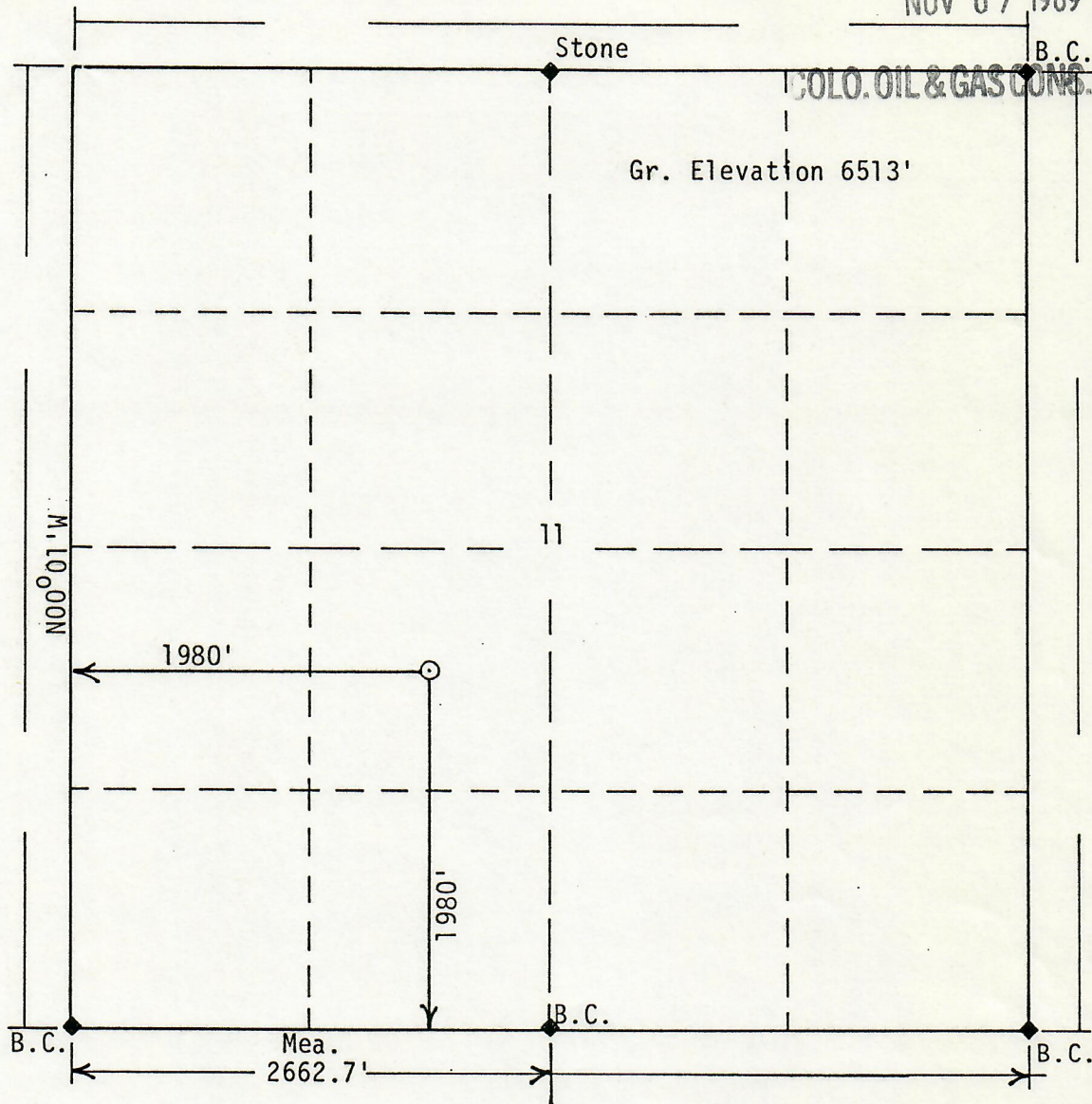

Scale: 1"=1000'

Powers Elevation, Inc. of Denver, Colorado has in accordance with a request from Sally DuVall for Meridian Oil Inc. determined the location of 23-11 Kline to be 1980fs1, 1980fw1 Section 11, Township 7 N Range 91 W of the 6th Principal Meridian,

Moffat County, Colorado

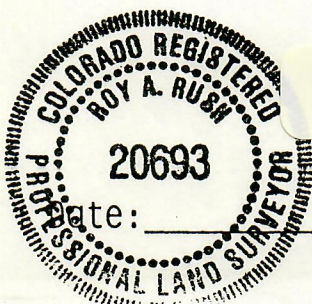

I hereby certify that this plat is an accurate representation of a correct survey showing the location of 23-11 Kline

[Signature of Roy A. Rush]

Licensed Land Surveyor No. 20693
State of Colorado