

Reclamation Inspection

December 17, 2019

Operator: PAINTED PEGASUS PETROLEUM LLC - 10711

API #: 05-123-05046

Inspection Document #: 697500933

Weld County, CO

NWSE Section 25 T2N R63W

Chris Binschus
Reclamation Specialist, COGCC



COLORADO
Oil & Gas Conservation
Commission

Department of Natural Resources

Inspection Photos
Location Name: SARGENT FARMS "A" #1-A
API # 05-123-05046



Photo 1. Photo taken from the well location, facing North. Photo illustrates the wellhead and Operator sign.

This well is currently located in the SESE section of 25, not NWSE.

Inspection Photos
Location Name: SARGENT FARMS "A" #1-A
API # 05-123-05046



Photo 2. Close up photo taken of the Operator sign.

Operator sign needs to be updated to read: Sargent Farms "A" 2-A, SESE section 25

Inspection Photos
Location Name: SARGENT FARMS "A" #1-A
API # 05-123-05046

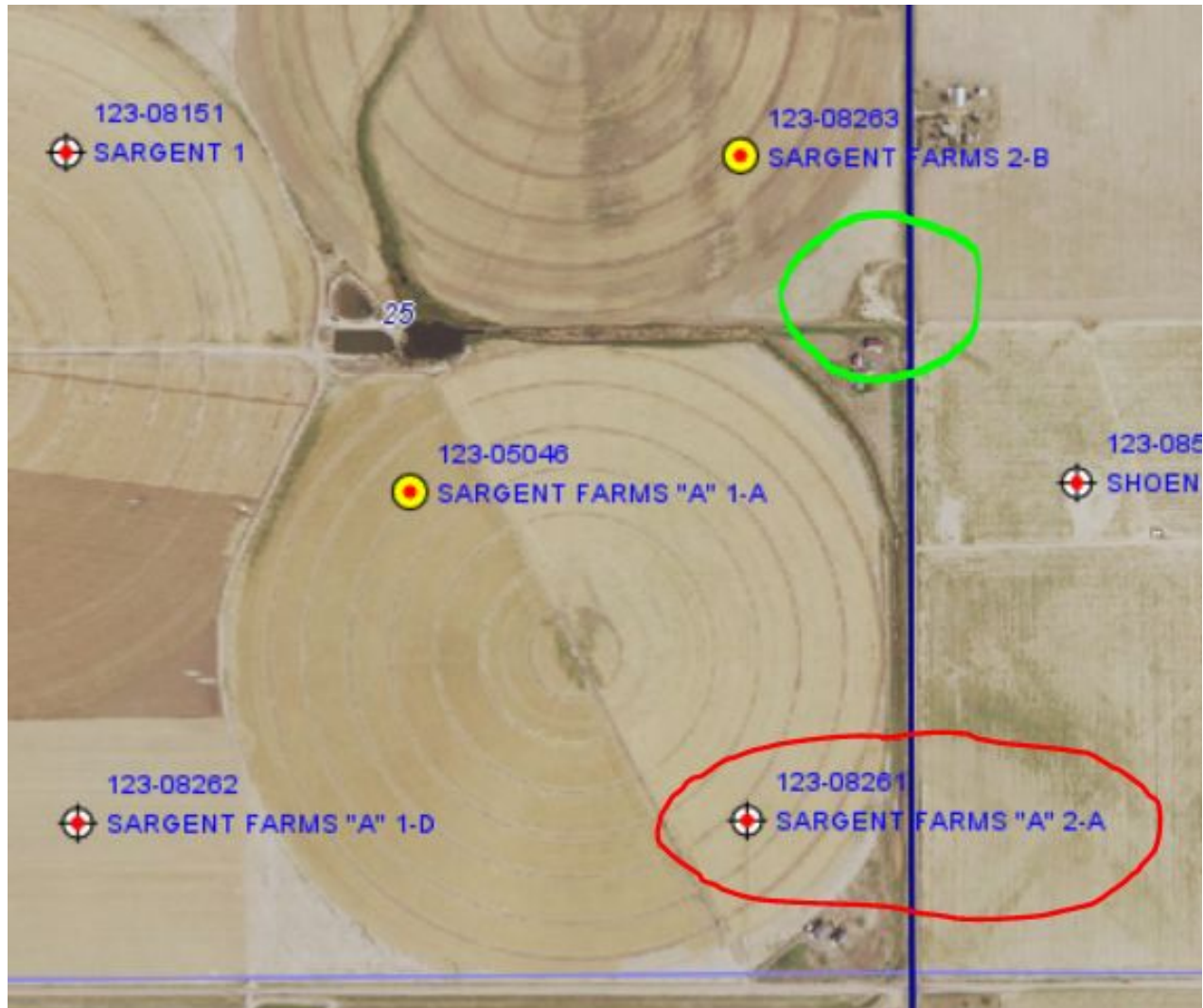

Photo 3. This is current COGCC GISOnline map status. This inspection was conducted at the wellhead circled in red. Operator indicated the tank battery is in the SENE section of 25 circled in lime.