



FORM F-106

RECEIVED

OCT 25 1974

COLO. OIL &amp; GAS CONS. COMM.



R. 52W

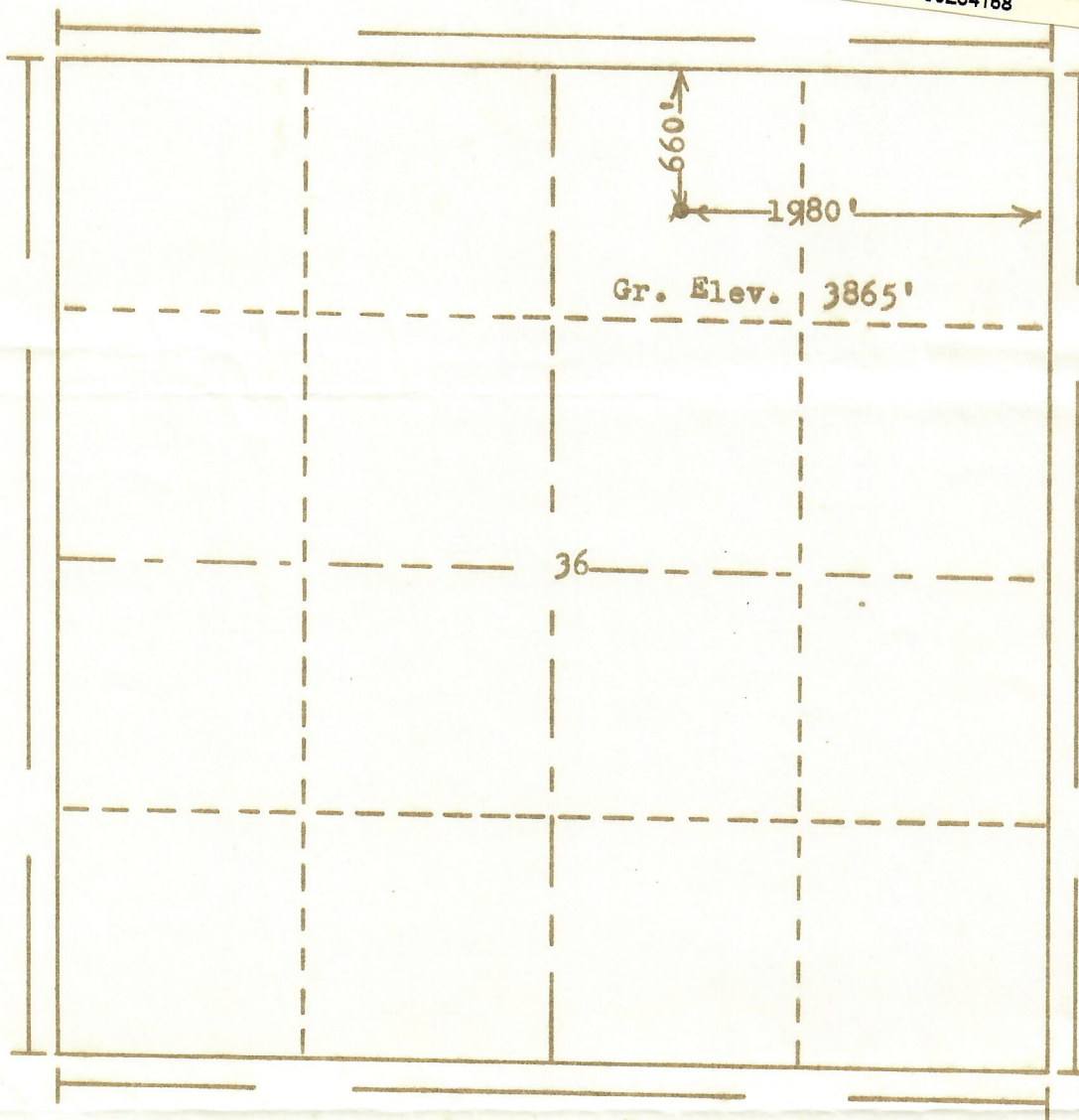

Scale... 1" = 1000'

Powers Elevation Company, Inc. of Denver, Colorado  
has in accordance with a request from Mr. Young  
for Zoller & Danneberg, Inc.

determined the location of No. 1-36 State  
to be CNW NE Section 36 Township 9N  
Range 52W of the 6th Principal Meridian  
Logan County, Colorado

74 914

I hereby certify that this plat is an  
accurate representation of a correct  
survey showing the location of

Date: 10-6-74

B. J. H. H. H.  
Licensed Land Surveyor No. 2853  
State of Colorado