

CRYSTAL-RUBY PAD  
MULTI-WELL PLAN

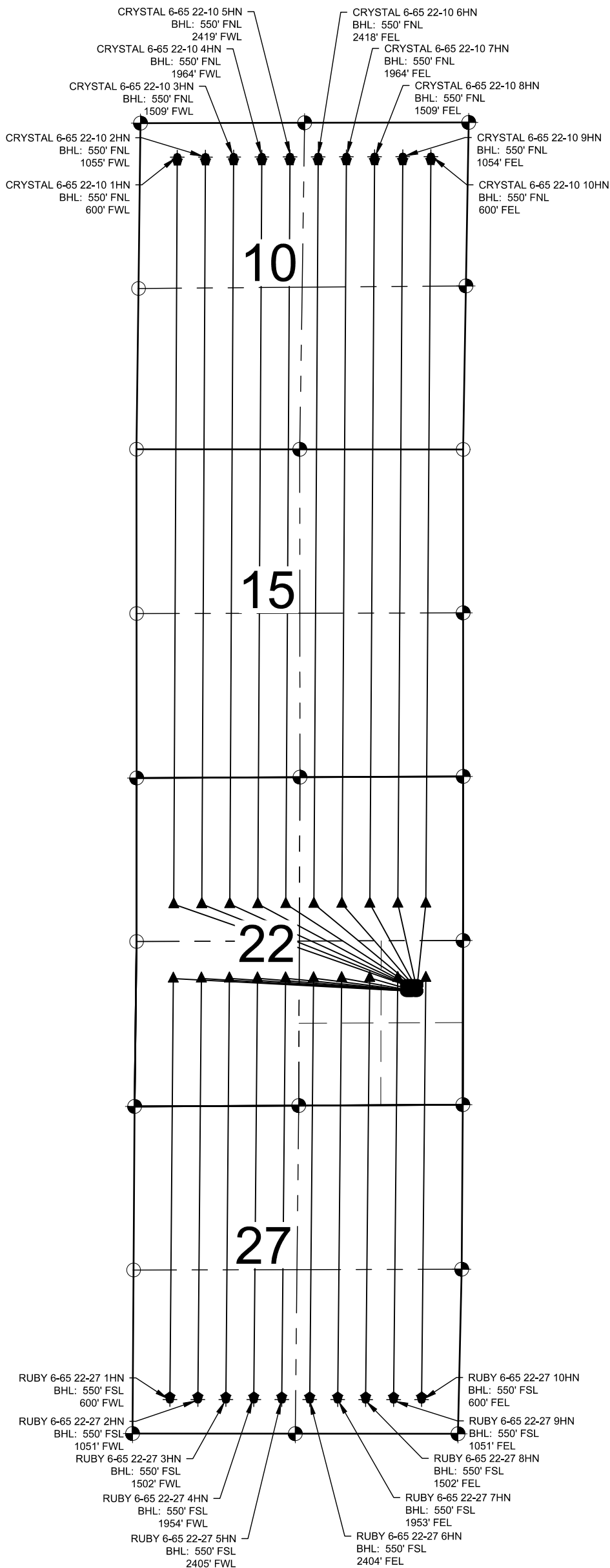

NOTES:

1. THIS FIELD SURVEY CONFORMS TO THE MINIMUM STANDARDS SET BY THE COGCC, RULE NO. 215
2. ALL BEARINGS ARE GRID BEARINGS OF THE COLORADO STATE PLANE COORDINATE SYSTEM, CENTRAL ZONE, NORTH AMERICAN DATUM 1983/2011. THE LINEAL DIMENSIONS AS SHOWN HEREIN ARE GRID DISTANCES BASED UPON THE "U.S. SURVEY FOOT." TO GET GROUND DISTANCES MULTIPLY SHOWN DISTANCE BY 1.0003323.
3. FIELD VERIFICATION OF MONUMENTS COMPLETED WITHIN 1 YEAR OF SIGNATURE DATE, UNLESS OTHERWISE NOTED.

NOTES:

- CRYSTAL 6-65 22-10 1HN TO BE AT 1932' FSL & 918' FEL.  
BOTTOM HOLE AT 550' FNL & 600' FWL, SEC. 10.
- CRYSTAL 6-65 22-10 2HN TO BE AT 1932' FSL & 898' FEL.  
BOTTOM HOLE AT 550' FNL & 1055' FWL, SEC. 10.
- CRYSTAL 6-65 22-10 3HN TO BE AT 1932' FSL & 878' FEL.  
BOTTOM HOLE AT 550' FNL & 1509' FWL, SEC. 10.
- CRYSTAL 6-65 22-10 4HN TO BE AT 1932' FSL & 858' FEL.  
BOTTOM HOLE AT 550' FNL & 1964' FWL, SEC. 10.
- CRYSTAL 6-65 22-10 5HN TO BE AT 1932' FSL & 838' FEL.  
BOTTOM HOLE AT 550' FNL & 2419' FWL, SEC. 10.
- CRYSTAL 6-65 22-10 6HN TO BE AT 1931' FSL & 818' FEL.  
BOTTOM HOLE AT 550' FNL & 2418' FEL, SEC. 10.
- CRYSTAL 6-65 22-10 7HN TO BE AT 1931' FSL & 798' FEL.  
BOTTOM HOLE AT 550' FNL & 1964' FEL, SEC. 10.
- CRYSTAL 6-65 22-10 8HN TO BE AT 1931' FSL & 778' FEL.  
BOTTOM HOLE AT 550' FNL & 1509' FEL, SEC. 10.
- CRYSTAL 6-65 22-10 9HN TO BE AT 1931' FSL & 758' FEL.  
BOTTOM HOLE AT 550' FNL & 1054' FEL, SEC. 10.
- CRYSTAL 6-65 22-10 10HN TO BE AT 1931' FSL & 738' FEL.  
BOTTOM HOLE AT 550' FNL & 600' FEL, SEC. 10.
- RUBY 6-65 22-27 1HN TO BE AT 1842' FSL & 918' FEL.  
BOTTOM HOLE AT 550' FSL & 600' FWL, SEC. 27.
- RUBY 6-65 22-27 2HN TO BE AT 1842' FSL & 898' FEL.  
BOTTOM HOLE AT 550' FSL & 1051' FWL, SEC. 27.
- RUBY 6-65 22-27 3HN TO BE AT 1842' FSL & 878' FEL.  
BOTTOM HOLE AT 550' FSL & 1502' FWL, SEC. 27.
- RUBY 6-65 22-27 4HN TO BE AT 1842' FSL & 858' FEL.  
BOTTOM HOLE AT 550' FSL & 1954' FWL, SEC. 27.
- RUBY 6-65 22-27 5HN TO BE AT 1842' FSL & 838' FEL.  
BOTTOM HOLE AT 550' FSL & 2405' FWL, SEC. 27.
- RUBY 6-65 22-27 6HN TO BE AT 1841' FSL & 818' FEL.  
BOTTOM HOLE AT 550' FSL & 2404' FEL, SEC. 27.
- RUBY 6-65 22-27 7HN TO BE AT 1841' FSL & 798' FEL.  
BOTTOM HOLE AT 550' FSL & 1953' FEL, SEC. 27.
- RUBY 6-65 22-27 8HN TO BE AT 1841' FSL & 778' FEL.  
BOTTOM HOLE AT 550' FSL & 1502' FEL, SEC. 27.
- RUBY 6-65 22-27 9HN TO BE AT 1841' FSL & 758' FEL.  
BOTTOM HOLE AT 550' FSL & 1051' FEL, SEC. 27.
- RUBY 6-65 22-27 10HN TO BE AT 1841' FSL & 738' FEL.  
BOTTOM HOLE AT 550' FSL & 600' FEL, SEC. 27.

LEGEND

- EXISTING MONUMENT
- CALCULATED POSITION
- PROPOSED WELL
- BOTTOM HOLE
- LANDING POINT
- LAST TAKE POINT
- LP = LANDING POINT
- BHL = BOTTOM HOLE

