

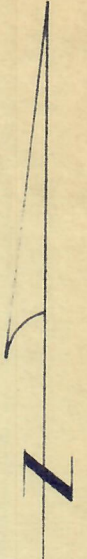

RECEIVED

OCT 14 1975

COLO. OIL & GAS CONS. COMM.



SCALE 1"=1000'

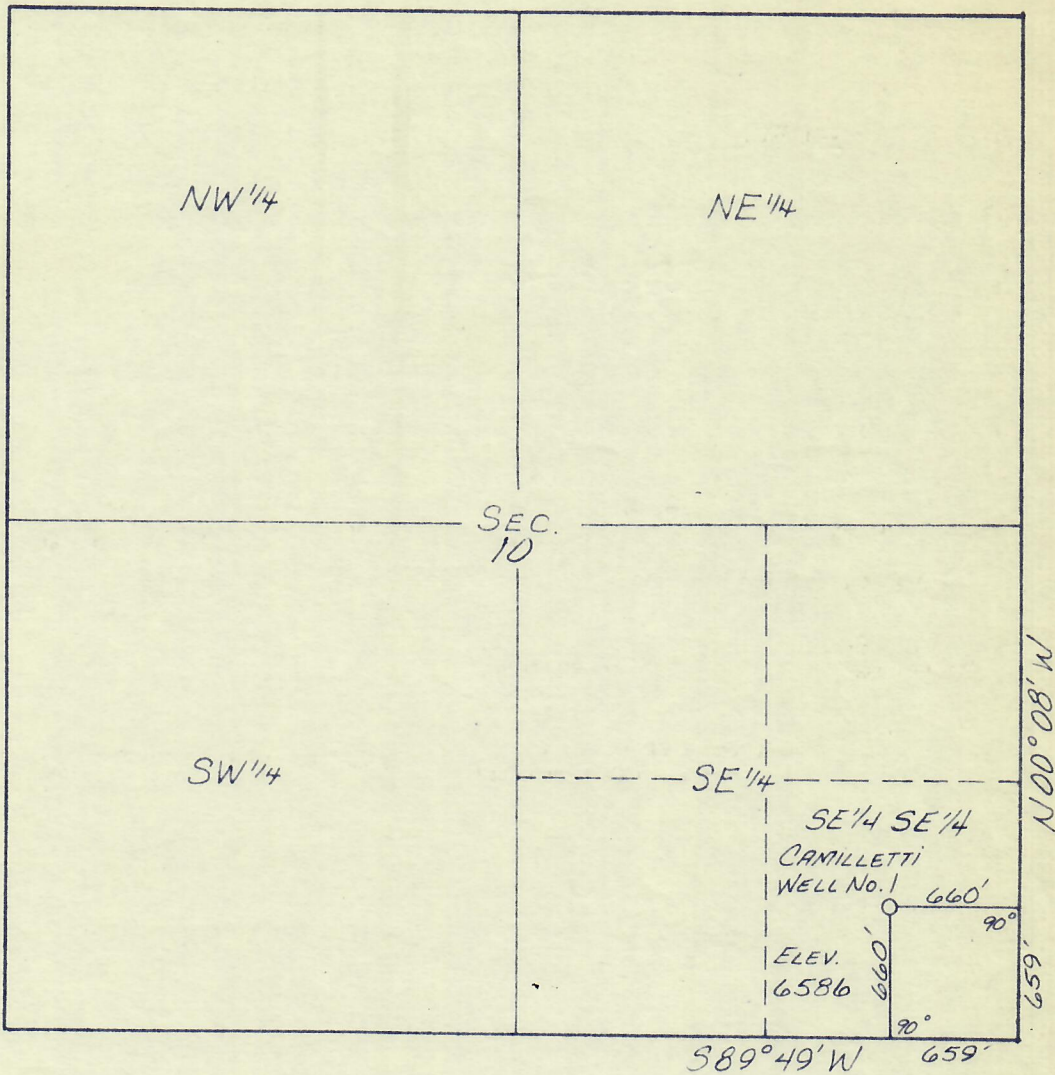

BEARINGS BASED PER G.L.D.

75 909

MAP OF CAMILLETTI WELL No. 1  
LOCATED IN THE SE 1/4 SE 1/4,  
SECTION 10, T6N, R86W OF THE  
6TH P.M., ROUTT COUNTY  
COLORADO

I, M.S. Dismuke, a registered Land Surveyor  
in the State of Colorado, do hereby certify  
that the Survey and above plot of CAMILLETTI  
WELL No. 1, was made under my  
supervision and that the accompanying plat  
accurately shows said CAMILLETTI WELL No. 1  
to the best of my knowledge and belief.

*M.S. Dismuke*  
L.S. No. 7736

APEXCO

**DISMUKE & DISMUKE**  
**ENGINEERING—SURVEYING**

STEAMBOAT SPRINGS  
COLORADO

Date: 10-3-75	Scale: 1"=1000'	File No.: 1302-1
------------------	--------------------	---------------------