



FORM F-106



00264633

R. 54W

RECEIVED

AUG 29 1977

COLO. OIL & GAS CONS. COMM.

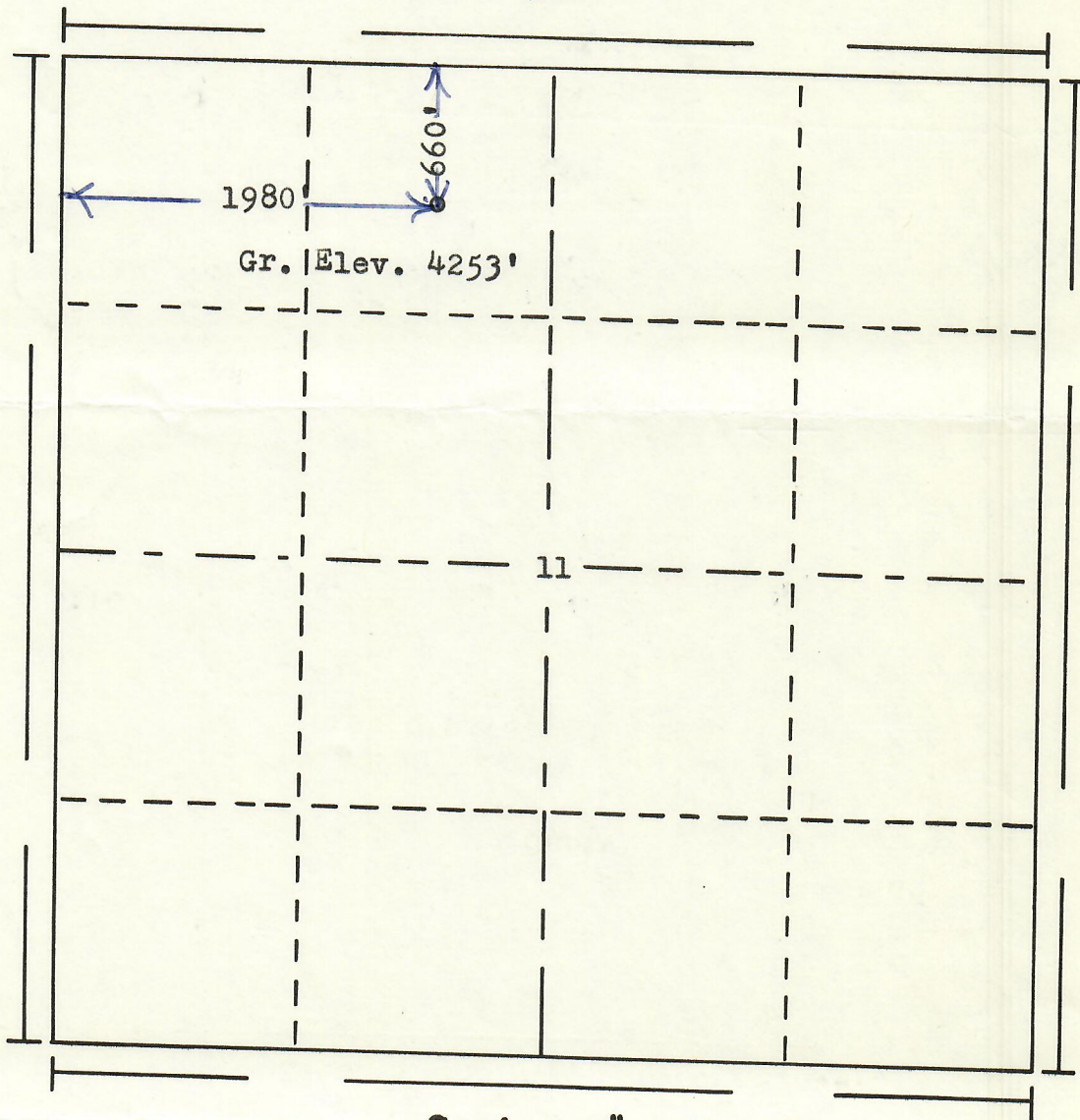

Scale... 1" = 1000'

Powers Elevation Company, Inc. of Denver, Colorado
has in accordance with a request from Michelle
for Ram Oil Co. & Exeter Drilg. & Exploration Co.,
determined the location of No. ? ? #1 KIEKE
to be CNE NW. Section 11 Township 9N
Range 54W of the 6th Principal Meridian
Logan County, Colorado

I hereby certify that this plat is an
accurate representation of a correct
survey showing the location of

Date: 8-17-77

Bill J. Hagan
Licensed Land Surveyor No. 2853
State of Colorado