

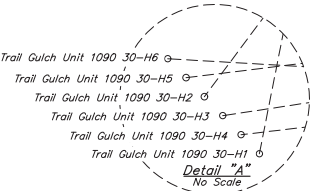

- LEGEND:**
- = PROPOSED WELLHEAD.
 - ⊠ = KICK OFF POINT
 - ⊠ = LANDING POINT
 - = TARGET BOTTOM HOLE.

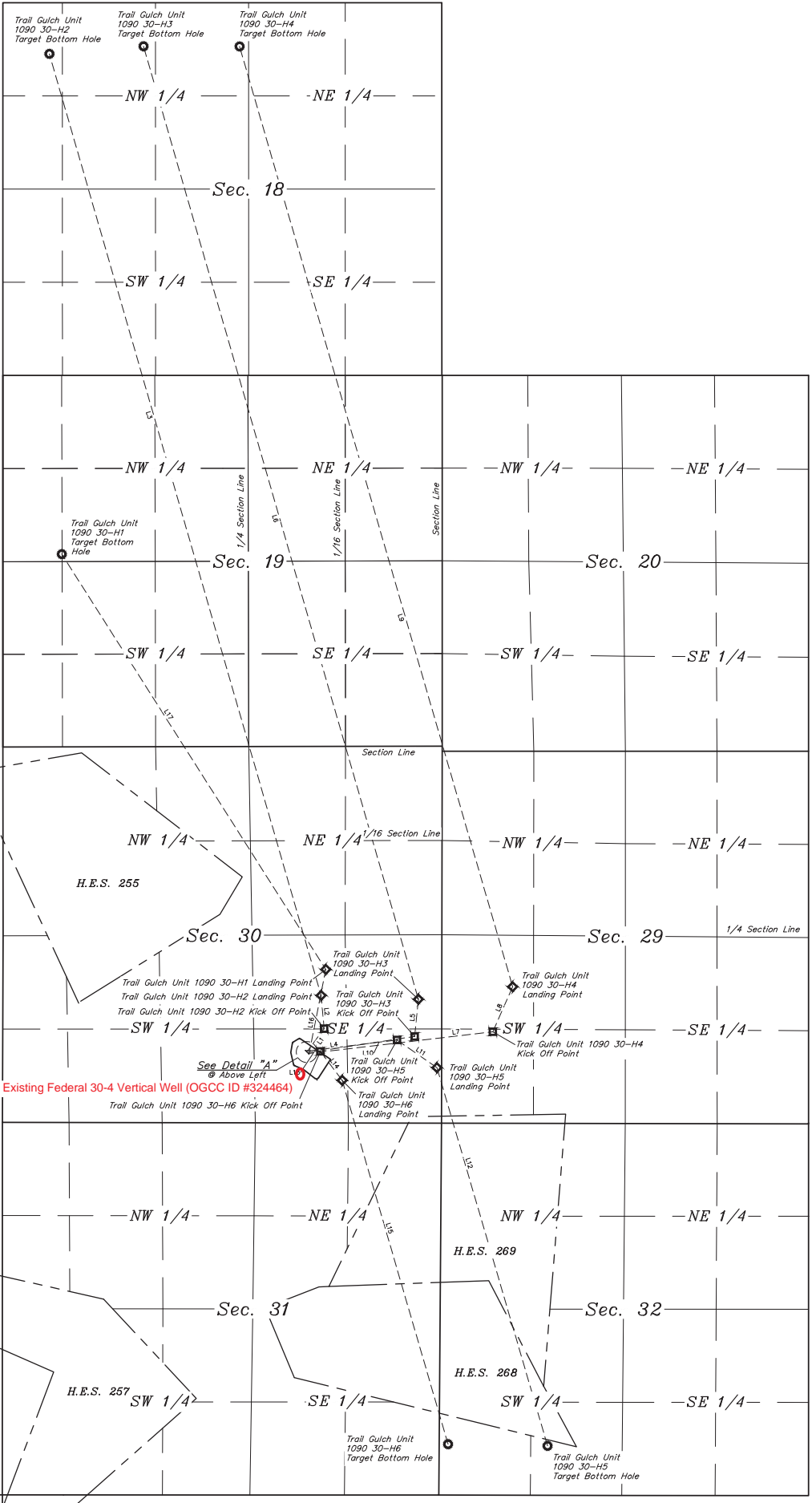

LINE	DIRECTION	LENGTH
L1	N36°44'29"E	413.10'
L2	N05°10'03"W	472.52'
L3	N16°06'22"W	13885.39'
L4	N81°20'34"E	1536.69'
L5	N05°43'25"E	529.61'
L6	N16°05'43"W	14053.01'
L7	N83°17'15"E	2635.39'
L8	N23°44'53"E	697.86'
L9	N16°12'09"W	13873.36'
L10	N82°57'22"E	1300.30'
L11	S55°17'23"E	688.42'
L12	S16°16'46"E	5583.29'
L13	S86°40'00"E	215.25'
L14	S36°54'25"E	514.81'
L15	S16°34'42"E	5368.25'
L16	N11°35'54"E	1225.74'
L17	N32°27'23"W	6973.79'



REV: 5 05-24-19 T.L.L. (LP & BHL CHANGE)

Gunnison Energy LLC

TRAIL GULCH UNIT 1090 30-H1 PAD
SW 1/4 SE 1/4, SECTION 30, T10S, R90W, 6th P.M.
GUNNISON COUNTY, COLORADO

SURVEYED BY	BART HUNTING, F.R.	10-16-17	SCALE
DRAWN BY	M.D.	10-19-17	1" = 1000'
MULTI-WELL PLAN		FIGURE #7	