



November 5, 2019

VIA ELECTRONIC TRANSMITTAL

Department of Natural Resources
Oil and Gas Conservation Commission
The Chancery Building
Attn: Jeff Robbins, Director
1120 Lincoln St., Suite 801
Denver, CO 80203

Re: **30-Day Certification Letter – Rule 318A.e**

<u>Well Name</u>	<u>Well Head Location (SHL)</u>			
Johnson 01N-65W-30-10H	230	FSL	1835	FWL

Dear COGCC Director,

Verdad Resources LLC (Verdad) herby certifies to the Director that that a thirty (30-day) notice has been given by certified mail to all owners in the proposed 400-acre wellbore spacing unit. This notice was received on 9/18/2019 The proposed 400-acre wellbore spacing unit for the Johnson 01N-65W-30-10H well consists of:

Township 1N, Range 65W
Section 19: SW4SE4, SWSE4
Section 30: E2W2, W2E2

We have not received any objections to such well location or proposed spacing unit, there Verdad herby requests the Director to approve the proposed well.

If you should have any questions or concerns regarding this permit, please contact the undersigned at 720-845-6909.

Sincerely,

A handwritten signature in black ink that reads "Allison Schieber".

Allison Schieber
Sr. Regulatory Analyst
Verdad Oil and Gas Corporation

JOHNSON 01N-65W-30-10H WELLBORE SPACING UNIT

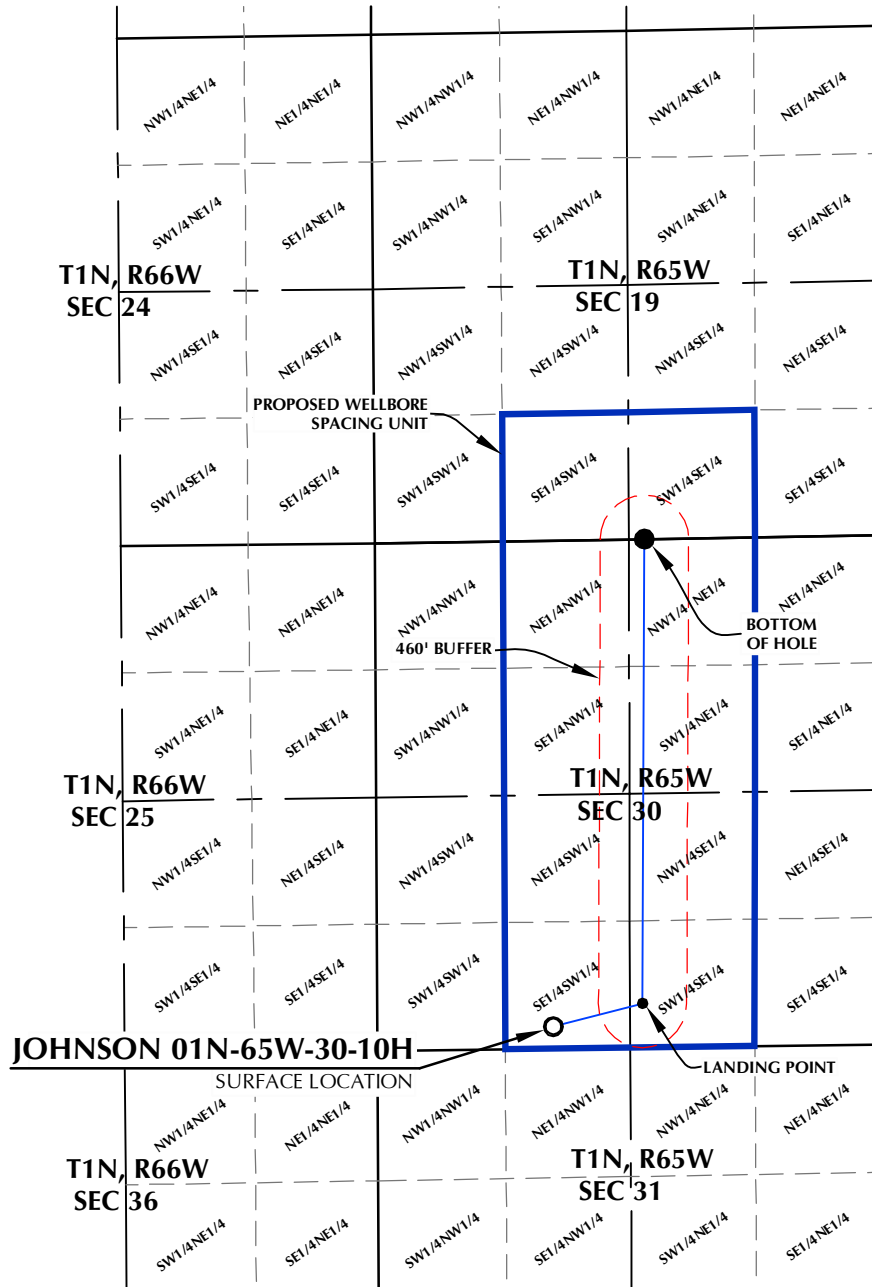

SURFACE LOCATION
GROUND ELEVATION= 4999.1'
LATITUDE= 40.015686°
LONGITUDE= -104.709598°
1/4 1/4: SE1/4 SW1/4

LANDING POINT
LATITUDE= 40.016325°
LONGITUDE= -104.706269°
1/4 1/4: SW1/4 SE1/4

BOTTOM HOLE LOCATION
LATITUDE= 40.029596°
LONGITUDE= -104.706046°
1/4 1/4: NW1/4 NE1/4

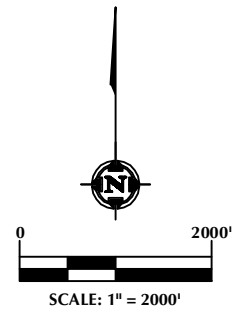

NOTES:

1. DRAWING LATITUDE AND LONGITUDE COORDINATES ARE NAD 83 (2011)(EPOCH:2010).
2. ELEVATION BASED ON NAVD88 (GEOID12B).
3. BASIS OF BEARING DERIVED FROM COLORADO COORDINATE SYSTEM OF 1983 NORTH ZONE.
4. ALL MEASURED DISTANCES ARE GRID.
COMBINED SCALE FACTOR: .99972845 CALCULATED FROM THE W. 1/4 CORNER OF SECTION 30, T1N, R65W.

WELL PAD - JOHNSON 01N-65W-30

JOHNSON 01N-65W-30-10H
WELLBORE SPACING UNIT
230' FSL & 1835' FWL (SESW) (SURFACE)
460' FSL & 2468' FEL (SWSE) (LANDING POINT)
1' FNL & 2468' FEL (NWNE) (BOTTOM)
LOCATED IN SECTION 30
T1N, R65W, 6TH P.M.
WELD COUNTY, COLORADO



5950 Cedar Springs Road, Suite 200
Dallas, Texas 75235



CONSULTING, LLC

SHERIDAN OFFICE
1095 Saberton Avenue
Sheridan, Wyoming 82801
Phone 307-674-0609

LOVELAND OFFICE
6706 North Franklin Avenue
Loveland, Colorado 80538
Phone 970-776-4331

DRAFTED BY:	LMO	CHECKED BY:	RKF
DATE DRAFTED:	1/30/18	DATE SURVEYED:	7/6/18
REVISED:	8/27/19	FILE NAME:	17-171