

SITE MAP  
FOR THE RAYMER COMPRESSOR STATION LOCATED IN THE  
E1/2 OF THE SE 1/4 OF SECTION 22, T7N, R58W OF THE 6TH P.M.,  
COUNTY OF WELD, STATE OF COLORADO

LEGEND

EXISTING CONTOURS

x

FENCE LINE

EDGE OF ROAD

PIPELINE

UGG

EXISTING GAS LINE

POWER POLE

Existing Structure List	
1	Compressor
2	Storage Tanks
3	Butane Gas Mix Tank
4	Air Storage Tank
5	Inlet Seperator
6	Electronic Flow Meter
7	Slug Catcher
8	Pig Launcher
9	Dehydrator Tank
10	Building
11	2 Phase Separator
12	Radiator
13	H2S Scavenger Tank
14	Above Ground Pipeline Corridor
15	Antifreeze Tank
16	Engine Oil Tank
17	Below Ground Tank
18	Tower
19	Slug Catching Vessel

N

SCALE: 1" = 20'

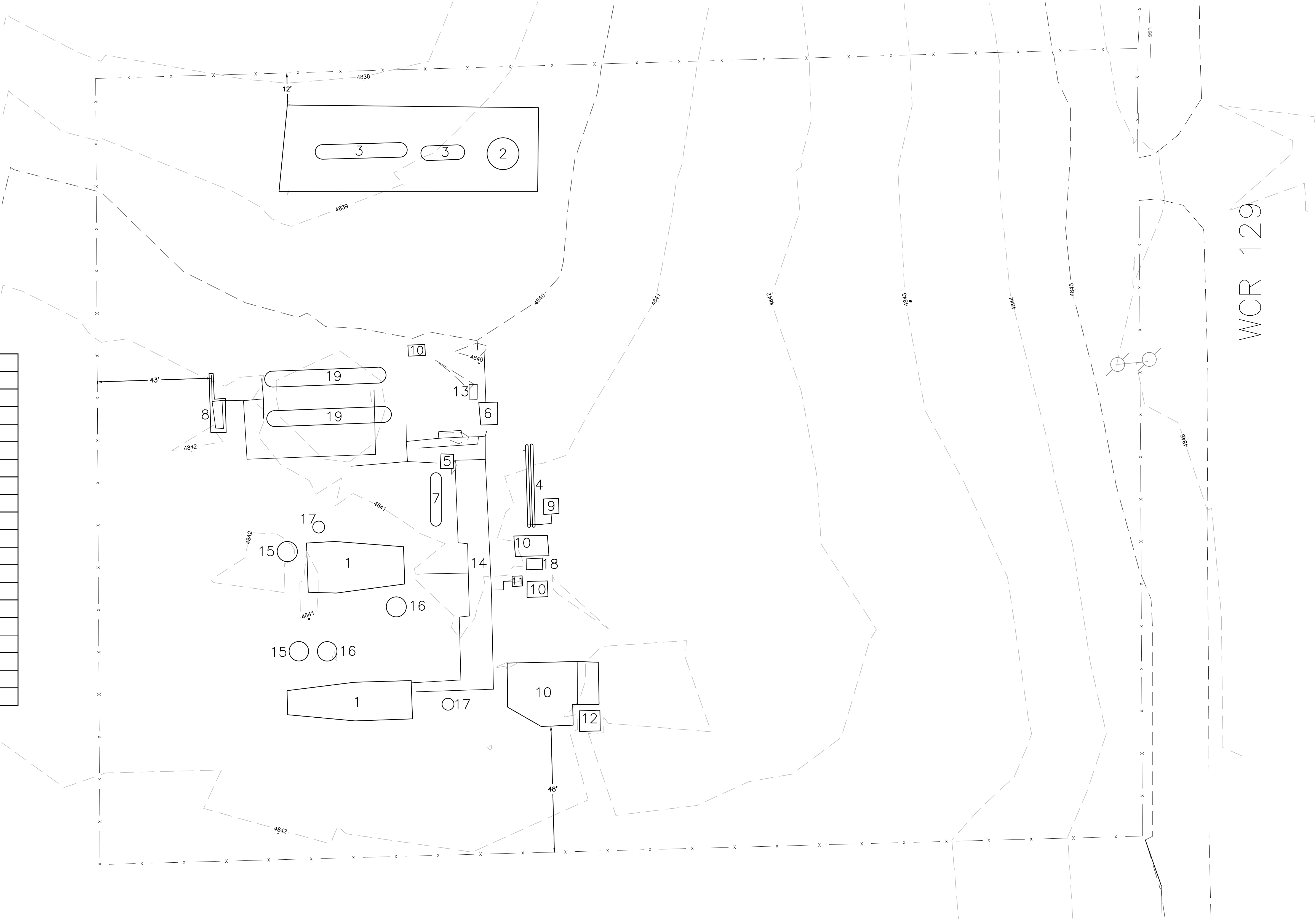

SITE MAP  
FOR THE RAYMER COMPRESSOR STATION LOCATED IN THE  
E1/2 OF THE SE 1/4 OF SECTION 22, T7N, R58W OF THE 6TH P.M.,  
COUNTY OF WELD, STATE OF COLORADO

LEGEND

EXISTING CONTOURS

x

FENCE LINE

EDGE OF ROAD

PIPELINE

UGG

EXISTING GAS LINE

POWER POLE

Existing Structure List	
1	Compressor
2	Storage Tanks
3	Butane Gas Mix Tank
4	Air Storage Tank
5	Inlet Seperator
6	Electronic Flow Meter
7	Slug Catcher
8	Pig Launcher
9	Dehydrator Tank
10	Building
11	2 Phase Separator
12	Radiator
13	H2S Scavenger Tank
14	Above Ground Pipeline Corridor
15	Antifreeze Tank
16	Engine Oil Tank
17	Below Ground Tank
18	Tower
19	Slug Catching Vessel

N

SCALE: 1" = 20'

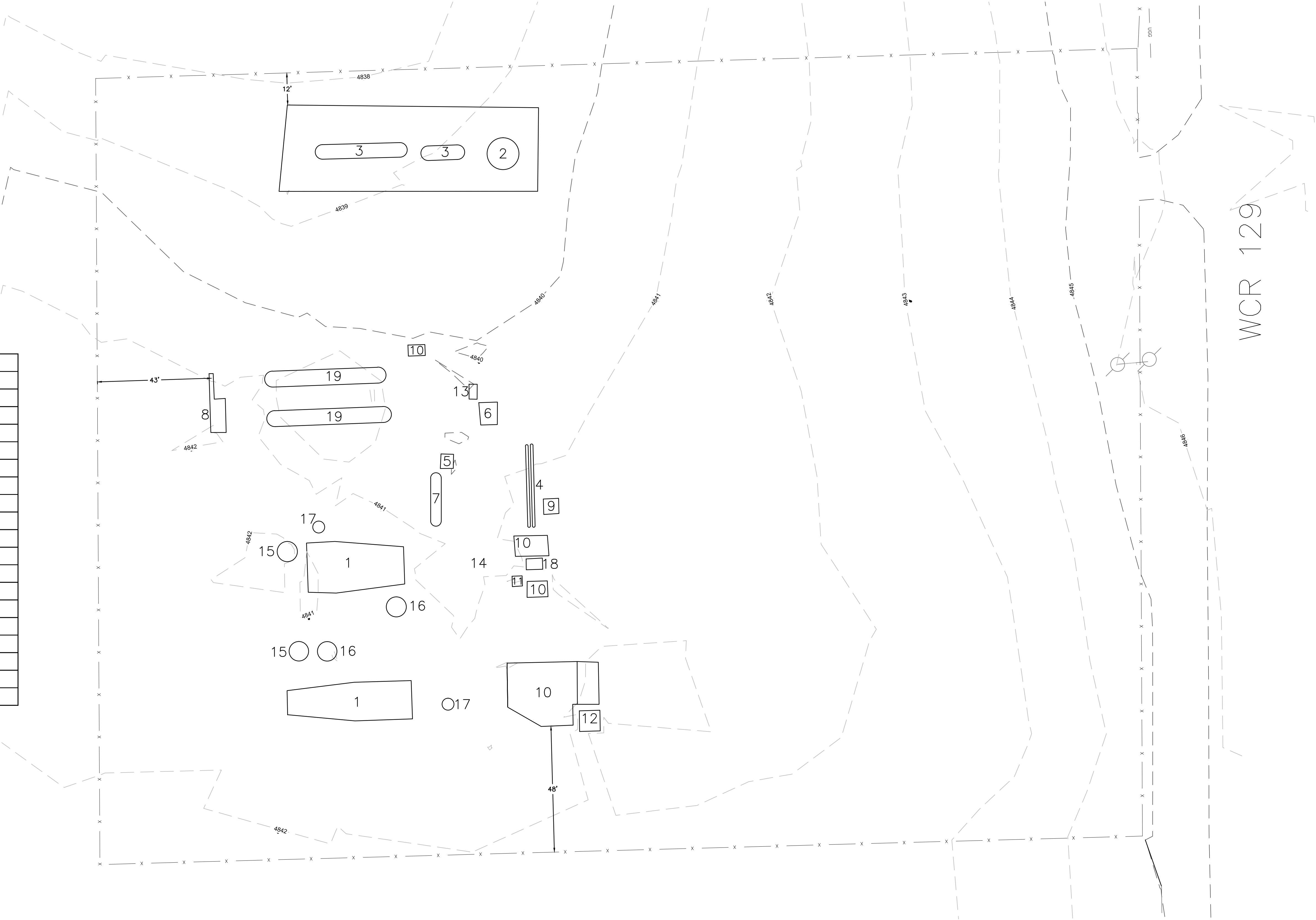

811

Know what's below.  
Call before you dig.

NO.	DATE:	REVISION DESCRIPTION	NAME

PREPARED FOR:

STERLING

ENERGY COMPANY

STERLING ENERGY COMPANY

PREPARED BY:

PFS

Petroleum Field Services, LLC

7535 Hilltop Circle

Denver, CO 80221

RAYMER COMPRESSOR STATION

DRAWING DATE:  
07-01-15

DRAWN BY:  
JWJ

CHECK BY:  
SWW

OWNER NAME:  
JOHN JOHNSON

SURFACE LOCATION:

SECTION 22, TOWNSHIP 7 NORTH

RANGE 58 WEST, 6TH P.M.

WELD COUNTY, COLORADO

SHEET 2 OF 3

SITE MAP  
FOR THE RAYMER COMPRESSOR STATION LOCATED IN THE  
E1/2 OF THE SE 1/4 OF SECTION 22, T7N, R58W OF THE 6TH P.M.,  
COUNTY OF WELD, STATE OF COLORADO

LEGEND

EXISTING CONTOURS

x

FENCE LINE

EDGE OF ROAD

PIPELINE

UGG

EXISTING GAS LINE

POWER POLE

Existing Structure List	
1	Compressor
2	Storage Tanks
3	Butane Gas Mix Tank
4	Air Storage Tank
5	Inlet Seperator
6	Electronic Flow Meter
7	Slug Catcher
8	Pig Launcher
9	Dehydrator Tank
10	Building
11	2 Phase Separator
12	Radiator
13	H2S Scavenger Tank
14	Above Ground Pipeline Corridor
15	Antifreeze Tank
16	Engine Oil Tank
17	Below Ground Tank
18	Tower
19	Slug Catching Vessel

N

SCALE: 1" = 20'

